

STATE CORPORATION COMMISSION OF KANSAS  
OIL & GAS CONSERVATION DIVISION  
WELL COMPLETION OR RECOMPLETION FORM  
ACO-1 WELL HISTORY  
DESCRIPTION OF WELL AND LEASE

15-067-20803, 00.00

API NO. 15-.....

County.....Grant.....

approx. C. NE Sec. 6 Twp. 30 Rge. 36 X West

4051' Ft North from Southeast Corner of Section  
1250' Ft West from Southeast Corner of Section  
(Note: Locate well in section plat below)

Operator: License # 04824  
Name MESA OPERATING LIMITED PARTNERSHIP  
Address P.O. BOX 2009  
AMARILLO, TX 79189  
City/State/Zip .....

Lease Name.....McCLAREN.....Well #.....3-6.....

Purchaser.....NA.....

Field Name.....Hugoton Infill.....

Operator Contact Person W. Riddle  
Phone (316) 356-3026

Producing Formation.....NA.....

Elevation: Ground.....3062'.....KB.....3072'.....

Contractor: License # 5987  
Name Service Drilling Co.

Wellsite Geologist.....  
Phone.....

Designate Type of Completion  
New Well Re-Entry Workover  
Oil SWD Temp Abd  
Gas Inj Delayed Completion  
X Dry Other (Core, Water Supply, etc.)

RECEIVED  
STATE CORPORATION COMMISSION

OCT 6 1988

CONSERVATION DIVISION  
Wichita, Kansas

If OWO: old well info as follows:  
Operator .....,  
Well Name .....,  
Comp. Date ....., Old Total Depth.....

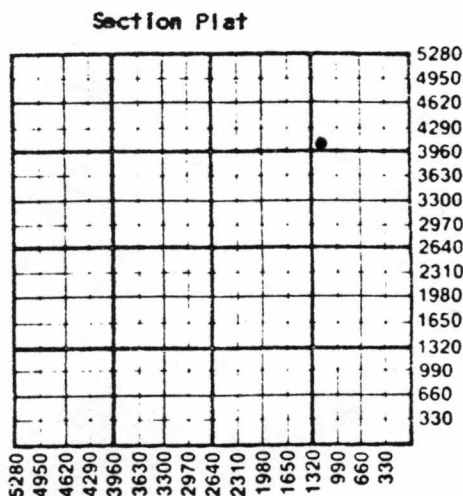

WATER SUPPLY INFORMATION  
Disposition of Produced Water: \_\_\_\_\_ Disposal  
Docket # ..... \_\_\_\_\_ Repressuring

WELL HISTORY  
Drilling Method:  
X Mud Rotary Air Rotary Cable  
6/9/88 6/12/88 P&A 9/23/88  
Spud Date Date Reached TD Completion Date  
2940' surface  
Total Depth PBTD  
Amount of Surface Pipe Set and Cemented at 696' feet  
Multiple Stage Cementing Collar Used? Yes No  
If yes, show depth set.....feet  
If alternate 2 completion, cement circulated from.....feet depth to.....w/.....SX cmt  
Cement Company Name .....,  
Invoice # .....

Questions on this portion of the ACO-1 call:  
Water Resources Board (913) 296-3717  
Source of Water:  
Division of Water Resources Permit #.....  
Groundwater.....Ft North from Southeast Corner  
(Well) .....Ft West from Southeast Corner of  
Sec Twp Rge East West  
Surface Water.....Ft North from Southeast Corner  
(Stream, pond etc).....Ft West from Southeast Corner  
Sec Twp Rge East West  
X Other (explain) Commercial Source.....  
(purchased from city, R.W.D. #)

INSTRUCTIONS: This form shall be completed in triplicate and filed with the Kansas Corporation Commission, 200 Colorado Derby Building, Wichita, Kansas 67202, within 120 days of the spud date of any well. Rule 82-3-130, 82-3-107 and 82-3-106 apply. Information on side two of this form will be held confidential for a period of 12 months if requested in writing and submitted with the form. See rule 82-3-107 for confidentiality in excess of 12 months. One copy of all wireline logs and drillers time log shall be attached with this form. Submit CP-4 form with all plugged wells. Submit CP-111 form with all temporarily abandoned wells.

All requirements of the statutes, rules and regulations promulgated to regulate the oil and gas industry have been fully complied with and the statements herein are complete and correct to the best of my knowledge.

Signature *Carol L. McKee*  
Title Regulatory Analyst Date 9/30/88

Subscribed and sworn to before me this 30th day of September 1988  
Notary Public *Dwaina Pitts*

Date Commission Expires.....

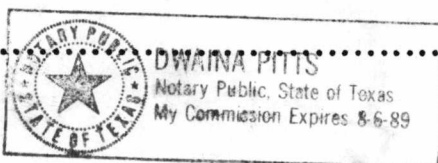

K.C.C. OFFICE USE ONLY  
F Letter of Confidentiality Attached  
C Wireline Log Received  
C Drillers Timelog Received  
Distribution  
KCC SWD/Rep NGPA  
KGS Plug Other (Specify)  
10-6-88  
Form ACO-1 (5-86)

Sec. 10, Twp. 30, Rge. 36, E. 34

SIDE TWO

Operator Name ..... Mesa Operating Limited Partnership ..... Lease Name ..... McClaren ..... Well # ..... 3-6

Sec ..... 6 ..... Twp ..... 30 ..... Rge ..... 36 .....  East  West ..... County ..... Grant .....

WELL LOG

INSTRUCTIONS: Show important tops and base of formations penetrated. Detail all cores. Report all drill stem tests giving interval tested, time tool open and closed, flowing and shut-in pressures, whether shut-in pressure reached static level, hydrostatic pressures, bottom hole temperature, fluid recovery, and flow rates if gas to surface during test. Attach extra sheet if more space is needed. Attach copy of log.

Drill Stem Tests Taken  Yes  No  
 Samples Sent to Geological Survey  Yes  No  
 Cores Taken  Yes  No

Formation Description  
 Log  Sample

Name	Top	Bottom
Stone Corral	1710'	
Wellington	2262'	
Chase	2460'	
Council Grove	2800'	

CASING RECORD  New  Used  
 Report all strings set-conductor, surface, intermediate, production, etc.

Purpose of String	Size Hole Drilled	Size Casing Set (in O.D.)	Weight Lbs/Ft.	Setting Depth	Type of Cement	#Sacks Used	Type and Percent Additives
Surface	12 1/4"	8 5/8"	24#	696'	DS LW	300	3% CaCl
Production	7 7/8"	5 1/2"	15.5#	2940'	DS LW	480	3% KCl

PERFORATION RECORD		Acid, Fracture, Shot, Cement Squeeze Record	
Shots Per Foot	Specify Footage of Each Interval Perforated	(Amount and Kind of Material Used)	Depth
	None	None	

TUBING RECORD Size NA Set At Packer at Liner Run  Yes  No

Date of First Production NA Producing Method  Flowing  Pumping  Gas Lift  Other (explain).....

Estimated Production Per 24 Hours	Oil	Gas	Water	Gas-Oil Ratio	Gravity
	Bbls	MCF	Bbls	CFPB	

METHOD OF COMPLETION Production Interval

Disposition of gas:  Vented  Open Hole  Perforation  
 Sold  Other (Specify) .....  
 Used on Lease  Dually Completed .....  
 Commingled .....