

STATE CORPORATION COMMISSION OF KANSAS  
OIL & GAS CONSERVATION DIVISION  
WELL COMPLETION OR RECOMPLETION FORM  
ACO-1 WELL HISTORY  
DESCRIPTION OF WELL AND LEASE

S API NO. 15-113-21,210:0000  
County McPherson  
SW NE NW Sec 12 Twp 21 Rge 3 East X West

Operator: License # 3667  
Name Source Petroleum  
Address 200 W Douglas  
Suite 820  
City/State/Zip Wichita, KS 67202

2970 Ft North from Southeast Corner of Section  
3630 Ft West from Southeast Corner of Section  
(Note: Locate well in section plat below)

Purchaser

Lease Name Goering "E" Well # 1  
Field Name

Operator Contact Person John D. Howard, Jr.  
Phone (316) 262-7397

Producing Formation  
Elevation: Ground 1473 KB 1478

Contractor: License # 5418  
Name Allen Drilling Company

Wellsite Geologist Steve Davis  
Phone 316-267-9115

Designate Type of Completion  
X New Well Re-Entry Workover  
Oil SWD Temp Abd  
Gas Inj Delayed Comp.  
X Dry Other (Core, Water Supply etc.)

RECEIVED  
STATE CORPORATION COMMISSION  
SEP - 6 1988  
CONSERVATION DIVISION  
Wichita, Kansas

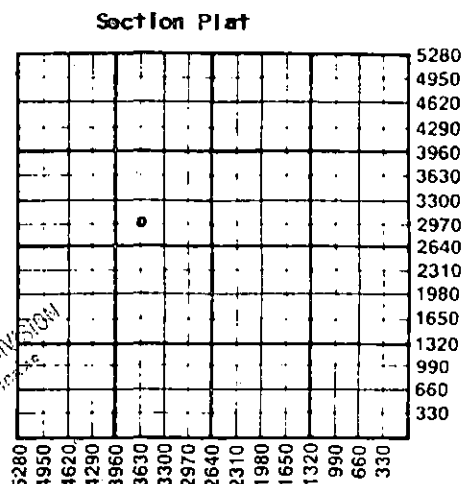

If OWN: old well info as follows:  
Operator  
Well Name  
Comp. Date Old Total Depth

WATER SUPPLY INFORMATION

Disposition of Produced Water: Disposal  
Docket # Repressuring

WELL HISTORY

Drilling Method:  
X Mud Rotary Air Rotary Cable  
8/2/88 8/7/88 8-8-88  
Spud Date Date Reached TD Completion Date  
3730  
Total Depth PBTD

Questions on this portion of the ACO-1 call:  
Water Resources Board (913) 296-3717

Source of Water:  
Division of Water Resources Permit # T88-248  
X Groundwater Ft North from Southeast Corner (Well) Ft West from Southeast Corner of Sec Twp Rge East West  
1320' south of location  
Surface Water Ft North from Southeast Corner (Stream, pond etc) Ft West from Southeast Corner Sec Twp Rge East West  
Other (explain) (purchased from city, R.W.D. #)

Amount of Surface Pipe Set and Cemented at 224 feet  
Multiple Stage Cementing Collar Used? Yes No  
If yes, show depth set feet  
If alternate 2 completion, cement circulated from feet depth to w/ SX cmt  
Cement Company Name  
Invoice #  
A/I I DKO

INSTRUCTIONS: This form shall be completed in triplicate and filed with the Kansas Corporation Commission, 200 Colorado Derby Building, Wichita, Kansas 67202, within 120 days of the spud date of any well. Rule 82-3-130, 82-3-107 and 82-3-106 apply. Information on side two of this form will be held confidential for a period of 12 months if requested in writing and submitted with the form. See rule 82-3-107 for confidentiality in excess of 12 months. One copy of all wireline logs and drillers time log shall be attached with this form. Submit CP-4 form with all plugged wells. Submit CP-111 form with all temporarily abandoned wells.

All requirements of the statutes, rules and regulations promulgated to regulate the oil and gas industry have been fully complied with and the statements herein are complete and correct to the best of my knowledge.

Signature John D. Howard, Jr.  
Title General Manager Date 9-02-88

Subscribed and sworn to before me this 2nd day of September 1988  
Notary Public Traci Grant  
Date Commission Expires January 24, 1992

K.C.C. OFFICE USE ONLY  
Letter of Confidentiality Attached  
Wireline Log Received  
Drillers Time Log Received  
Distribution: KCC SWD/Rep NGPA  
KGS Plug Other (Specify)  
9-6-88  
Form ACO-1 (5-86)



TRACI GRANT  
Notary Public  
State of Kansas  
My Appt. Exp.

Operator Name Source Petroleum Lease Name Goering "E" Well # 1

Sec. 12 Twp. 21 Rge. 3  East  West County McPherson

RELEASED

MAR 0 6 1990

WELL LOG

FROM CONFIDENTIAL

INSTRUCTIONS: Show important tops and base of formations penetrated. Detail all cores. Report all drill stem tests giving interval tested, time tool open and closed, flowing and shut-in pressures, whether shut-in pressure reached static level, hydrostatic pressures, bottom hole temperature, fluid recovery, and flow rates if gas to surface during test. Attach extra sheet if more space is needed. Attach copy of log.

Drill Stem Tests Taken  Yes  No  
Samples Sent to Geological Survey  Yes  No  
Cores Taken  Yes  No

See attached sheet.

Formation Description

Log  Sample

Name	Top	Bottom
Heebner	-2161	-2167
Lansing Kansas City	-2416	-2853
Mississippi	-3108	-3332
Simpson	-3624	-3640
Arbuckle	-3684	-----

CASING RECORD <input type="checkbox"/> New <input type="checkbox"/> Used							
Report all strings set-conductor, surface, intermediate, production, etc.							
Purpose of String	Size Hole Drilled	Size Casing Set (in O.D.)	Weight Lbs/Ft.	Setting Depth	Type of Cement	#Sacks Used	Type and Percent Additives
Surface.....	12.1/4"	8.5/8"	20#	224'	60/40 Pz	170	3%GR, 2%BE
.....	.....	.....	.....	.....	.....	.....	.....
.....	.....	.....	.....	.....	.....	.....	.....

PERFORATION RECORD		Acid, Fracture, Shot, Cement Squeeze Record	
Shots Per Foot	Specify Footage of Each Interval Perforated	(Amount and Kind of Material Used)	Depth
.....	.....	.....	.....
.....	.....	.....	.....
.....	.....	.....	.....
.....	.....	.....	.....

TUBING RECORD			
Size	Set At	Packer at	Liner Run <input type="checkbox"/> Yes <input type="checkbox"/> No
.....	.....	.....	.....

Date of First Production	Producing Method				
.....	<input type="checkbox"/> Flowing <input type="checkbox"/> Pumping <input type="checkbox"/> Gas Lift <input type="checkbox"/> Other (explain).....				
.....	Oil	Gas	Water	Gas-Oil Ratio	Gravity
Estimated Production Per 24 Hours	Bbls	MCF	Bbls	CFPB	

METHOD OF COMPLETION

Production Interval

Disposition of gas:  Vented  Open Hole  Perforation  
 Sold  Other (Specify) .....  
 Used on Lease  Dually Completed .....  
 Commingled .....

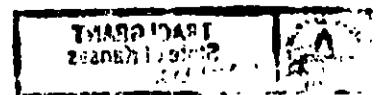

oring "E" #1  
SW SE NW, 12-21S-3W  
McPherson County, Kansas

Attached to ACO-I.

RELEASED

MAR 06 1990

FROM CONFIDENTIAL

DST #1 3605'-3624' Simpson Dolomite  
30/30/30/30  
1st open - very weak surface blow died in 30 sec.  
2nd open - no blow, flush tool, no blow  
Rec.: 5' slightly oil specked mud  
IHP: 1798.6 FHP: 1752.4  
IFP: 16.1-16.1 FFP: 16.1-16.1  
ISIP: 479.3 FSIP: 451.2

DST #2 3603'-3630' Simpson Sand  
30/60/45/60  
1st open - 1" blow building to bottom of bucket in 8 mins.; blow back on shut in very weak and died in 15 mins.  
2nd open - 1/2" blow building to bottom of bucket in 10 mins.; weak 1/8" blow back on shut in  
Rec.: 240' muddy water  
560' gassy water with oil scum in tool  
IHP: 1839.6 FHP: 1750.8 BHT: 112 deg.  
IFP: 55.1-161.3 FFP: 219.6-341.9  
ISIP: 510.2 FSIP: 511.4

DST #3 3654'-3669' Simpson  
Misrun tool wouldn't go to bottom

DST #4 3654'-3669' Simpson  
30/60/30/30  
1st open - very weak blow died in 1 min.; flush tool, no blow after surge  
2nd open - no blow, flushed tool 3 times, no help  
Rec.: 6' mud with oil specks in tool  
IHP: 1977.5 FHP: 1759.8 BHT: 112 deg.  
IFP: 9.100001-9.100001 FFP: 17.4-17.4  
ISIP: 1171.6 FSIP: 920.1

RECEIVED  
STATE CORPORATION COMMISSION

SEP - 6 1988

QUALITY CONTROL DIVISION  
Wichita, Kansas

been fully complied with and the statements herein are complete and correct to the best of my knowledge.

Signature John D. Howard, Jr.  
Title General Manager Date 9-02-88

Subscribed and sworn to before me this 2nd day of September  
1988  
Notary Public Traci Grant  
Date, Commission Expires January 24, 1992

K.C.C. OFFICE USE ONLY					
<input checked="" type="checkbox"/>	Letter of Confidentiality Attached	Sec. 12, Imp. 21, Reg. 30			
<input checked="" type="checkbox"/>	Wireline Log Received				
<input checked="" type="checkbox"/>	Drillers Timelog Received				
Distribution					
<input checked="" type="checkbox"/>	KCC	<input type="checkbox"/>	SWD/Rep	<input type="checkbox"/>	NGPA
<input checked="" type="checkbox"/>	KGS	<input type="checkbox"/>	Plug	<input type="checkbox"/>	Other
(Specify)					
.....					
.....					

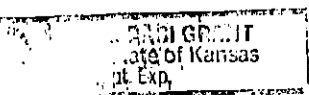

SEP 08 1988

Form ACO-1 (5-86)

KANSAS GEOLOGICAL SURVEY  
WICHITA BRANCH