

KANSAS DRILLERS LOG

IMPORTANT
 Kans. Geo. Survey record
 sample on this well.

S. 11 T. 28 R. 16 ^{EX} _W

API No. 15 — 097 — 20,588 — 0000
 County Number

Loc. C E 1/2 NW NW

County KIOWA

Operator
Imperial Oil Co.

Address
720 4th Financial Center, Wichita, KS 67202

Well No. 1-11 Lease Name Rinkel

Footage Location
660 feet from (N) (S) line 990 feet from (E) (W) line

Principal Contractor Red Tiger Drlg. Co. Geologist Peter J. Stubbs

Spud Date 12/22/79 Total Depth RTD 4675 P.B.T.D.

Date Completed 1/8/80 Oil Purchaser Permian

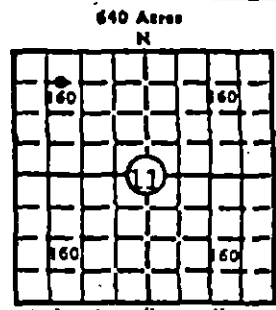

Locate well correctly
 Elev. Gr. 2118
 DP 2120 KB 2123

CASING RECORD

Report of all strings set — surface, intermediate, production, etc.

Purpose of string	Size hole drilled	Size casing set (in O.D.)	Weight lbs/ft.	Setting depth	Type cement	Sacks	Type and percent additives
Surface	12 1/2"	8 5/8"		362'	LW Common	175 125	
Production		5 1/2"	148	4664'	LW Common	75 125	

LINER RECORD

PERFORATION RECORD

Top, ft.	Bottom, ft.	Sacks cement	Shots per ft.	Size & type	Depth interval

TUBING RECORD

Size	Setting depth	Packer set at

ACID, FRACTURE, SHOT, CEMENT SQUEEZE RECORD

Amount and kind of material used	Depth interval treated
250 gals. 15% MCA & 500 gals. 7 1/2% MCA.	4672-75'
Foam frac'd & flushed with 110,000 SCF nitro	

INITIAL PRODUCTION

Date of first production <u>2/9/80</u>	Producing method (flowing, pumping, gas lift, etc.) <u>Pumping</u>	City <u>Wichita, Kansas</u>
BATE OF PRODUCTION PER 24 HOURS	Oil <u>100</u> bbls.	Gas <u>MCF</u> bbls.
Disposition of gas (vented, used on lease or sold)	Water <u>MCF</u> bbls.	Gas-oil ratio <u>CFPS</u>
	Producing interval(s) <u>4672-75'</u>	

INSTRUCTIONS: As provided in KCC Rule 82-2-125, within 90 days after completion of a well, one completed copy of this Drillers Log shall be transmitted to the State Geological Survey of Kansas, 4150 Monroe Street, Wichita, Kansas 67209. Copies of this form are available from the Conservation Division, State Corporation Commission, 3830 So. Meridian (P.O. Box 17027), Wichita, Kansas 66217. Phone AC 316-522-2206. If confidential custody is desired, please note Rule 82-2-125. Drillers Logs will be on an open file in the Oil and Gas Division, State Geological Survey of Kansas, Lawrence, Kansas 66044.