

STATE CORPORATION COMMISSION OF KANSAS
OIL & GAS CONSERVATION DIVISION
WELL COMPLETION OR RECOMPLETION FORM
ACO-1 WELL HISTORY
DESCRIPTION OF WELL AND LEASE

API NO. 15-009-24,157-0000
County Barton
NW NE Sec. 15 Twp. 20S Rge. 14W East West
4950 Ft North from Southeast Corner of Section
2310 Ft West from Southeast Corner of Section
(Note: Locate well in section plat below)

Lease Name Unruh Well # 1-15
Field Name Wildcat Moses NW
Producing Formation ARB/CONG
Elevation: Ground 1884 KB 1889

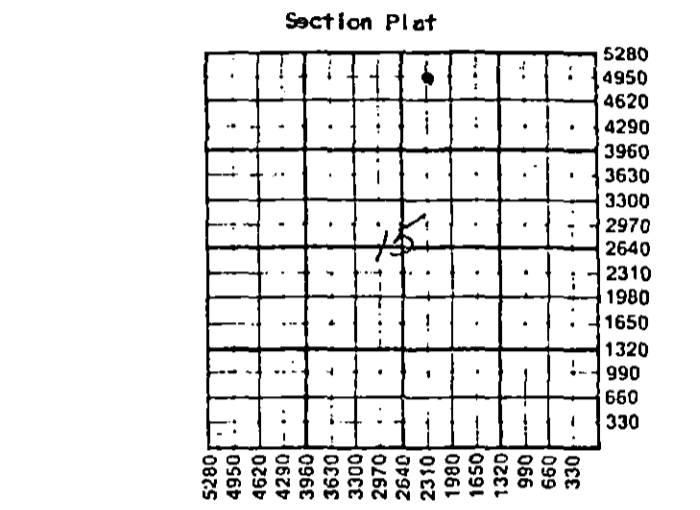

WATER SUPPLY INFORMATION
Disposition of Produced Water: Disposal
Docket # Repressuring

Questions on this portion of the ACO-1 call:
Water Resources Board (913) 296-3717
Source of Water:
Division of Water Resources Permit #
Groundwater.....Ft North from Southeast Corner (Well)Ft West from Southeast Corner of Sec Twp Rge East West
Surface Water.....Ft North from Southeast Corner (Stream, pond etc).....Ft West from Southeast Corner Sec Twp Rge East West
Other (explain).....
(purchased from city, R.W.D. #)

Operator: License # 6033
Name Murfin Drilling Co.
Address 250 N. Water, Suite 300
City/State/Zip Wichita, KS 67202

Purchaser none

Operator Contact Person Larry M. Jack
Phone Eastern Div. Prod. Mgr.

Contractor: License # 6033
Name Murfin Drilling Company

Wellsite Geologist Chuck Schmalz
Phone 316-262-2707

Designate Type of Completion
 New Well Re-Entry Workover
 Oil SWD Temp Abd
 Gas Inj Delayed Comp.
 Dry Other (Core, Water Supply etc.)
If OAWD: old well, info as follows:

Operator
Well Name
Comp. Date Old Total Depth

WELL HISTORY

Drilling Method:
 Mud Rotary Air Rotary Cable
Spud Date 2/7/86 Date Reached TD 2/18/86 Completion Date 3/18/86
Total Depth 3700' PBDT 3650'

Amount of Surface Pipe Set and Cemented at 815 feet
Multiple Stage Cementing Collar Used? Yes No
If yes, show depth set.....feet
If alternate 2 completion, cement circulated from.....feet depth to.....w/.....SX cement Company Name
Invoice #

INSTRUCTIONS: This form shall be completed in triplicate and filed with the Kansas Corporation Commission, 200 Colorado Derby Building, Wichita, Kansas 67202, within 120 days of the spud date of any well. Rule 82-3-130, 82-3-107 and 82-3-106 apply.
Information on side two of this form will be held confidential for a period of 12 months if requested in writing and submitted with the form. See rule 82-3-107 for confidentiality in excess of 12 months.
One copy of all wireline logs and drillers time log shall be attached with this form. Submit CP-4 form with all plugged wells. Submit CP-111 form with all temporarily abandoned wells.

All requirements of the statutes, rules and regulations promulgated to regulate the oil and gas industry have been fully complied with and the statements herein are complete and correct to the best of my knowledge.

Signature BY: Larry M. Jack
Title Eastern Div. Prod. Mgr. Date 6/16/86

Subscribed and sworn to before me this 16 day of June 1986
Notary Public Kerran Redington
Date Commission Expires 2/6/90



K.C.C. OFFICE USE ONLY
 Letter of Confidentiality Attached
 Wireline Log Received
 Drillers Timelog Received
Distribution
 KCC SWD/Rep NGPA
 KGS Plug Other
(Specify)

6-17-86 JUN 17 1986

Sec. 15, Twp. 20S, Rge. 14W