

STATE CORPORATION COMMISSION OF KANSAS
OIL & GAS CONSERVATION DIVISION
WELL COMPLETION OR RECOMPLETION FORM
ACO-1 WELL HISTORY
DESCRIPTION OF WELL AND LEASE

Operator: License # 6588
Name Woodman-Iannitti Oil Company
Address P.O. Box 308
City/State/Zip Great Bend, KS, 67530

Purchaser Farmland Industries, Inc.

Operator Contact Person D. J. Iannitti
Phone (316) 792-2921

Contractor: License # 5122
Name Woodman-Iannitti Drilling Co.

Wellsite Geologist Todd Morgenstern
Phone (316) 564-2673

Designate Type of Completion
 New Well Re-Entry Workover

Oil SWD Temp Abd
 Gas Inj Delayed Comp.
 Dry Other (Core, Water Supply etc.)

If ~~OWO~~: old well info as follows:
Operator
Well Name
Comp. Date
Old Total Depth

WELL HISTORY

Drilling Method:
 Mud Rotary Air Rotary Cable

8/18/89 8/25/89 10/03/89
Spud Date Date Reached TD Completion Date

3935' 3820 1/2'
Total Depth PBTD

Amount of Surface Pipe Set and Cemented at 343 feet
Multiple Stage Cementing Collar Used? Yes No
If yes, show depth set 1098 feet
If alternate 2 completion, cement circulated from 1098 feet depth to 420 w/300 SX cmt
Cement Company Name BJ Titan Services
Invoice # ZL018 (510183)
KCC Supervised by Ed Schumacher, Hays Dist.

API NO. 15-009-24,384 . 0000
County Barton
SE SW NW 19 20s 15 East
Sec. Twp. Rge. XX West

2970 Ft North from Southeast Corner of Section
4290 Ft West from Southeast Corner of Section
(Note: Locate well in section plat below)

Lease Name IANNITTI OIL COMPANY Well # 2
Field Name UN-NAMED (new-pool-discovery)

Producing Formation Arbuckle

Elevation: Ground 2108 KB 2113

Section Plat

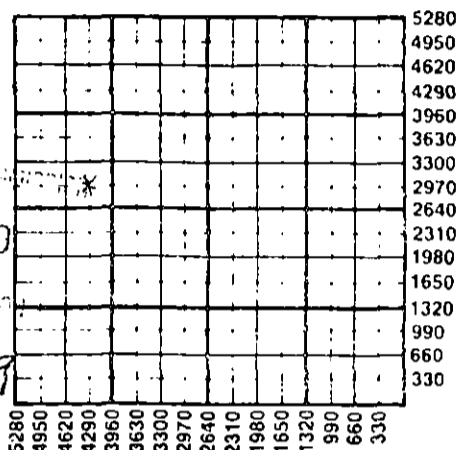

15-1800
CORPORATION OF
Wichita, Kansas
12-15-1989

WATER SUPPLY INFORMATION

Disposition of Produced Water: Disposal
Docket # Repressuring

Questions on this portion of the ACO-1 call:

Water Resources Board (913) 296-3717

Source of Water:
Division of Water Resources Permit #

Groundwater.....Ft North from Southeast Corner
(Well)Ft West from Southeast Corner of
Sec Twp Rge East West

Surface Water.....Ft North from Southeast Corner
(Stream,pond etc).....Ft West from Southeast Corner
Sec Twp Rge East West

Other (explain) Purchased City of Pawnee Rock
(purchased from city, R.W.D. #)

INSTRUCTIONS: This form shall be completed in triplicate and filed with the Kansas Corporation Commission, 200 Colorado Derby Building, Wichita, Kansas 67202, within 120 days of the spud date of any well. Rule 82-3-130, 82-3-107 and 82-3-106 apply.
Information on side two of this form will be held confidential for a period of 12 months if requested in writing and submitted with the form. See rule 82-3-107 for confidentiality in excess of 12 months.
One copy of all wireline logs and drillers time log shall be attached with this form. Submit CP-4 form with all plugged wells. Submit CP-111 form with all temporarily abandoned wells.

All requirements of the statutes, rules and regulations promulgated to regulate the oil and gas industry have been fully complied with and the statements herein are complete and correct to the best of my knowledge.

Signature D. J. Iannitti
Title Partner Date 12/14/89

Subscribed and sworn to before me this 14th day of December 1989
Notary Public Sharon K. Lingreen
Date Commission Expires May 12, 1992

K.C.C. OFFICE USE ONLY
 Letter of Confidentiality Attached
 Wireline Log Received
 Drillers Timelog Received
Distribution
 KEC SWD/Rep NGPA
 KGS Plug Other
(Specify)

X 91

Operator Name Woodman-Iannitti Oil Company Lease Name IANNITTI OIL COMPANY 2 Well #

Sec. 19 Twp. 20s Rge. 15 East West County BARTON

WELL LOG

INSTRUCTIONS: Show important tops and base of formations penetrated. Detail all cores. Report all drill stem tests giving interval tested, time tool open and closed, flowing and shut-in pressures, whether shut-in pressure reached static level, hydrostatic pressures, bottom hole temperature, fluid recovery, and flow rates if gas to surface during test. Attach extra sheet if more space is needed. Attach copy of log.

1-Comp. Neutron Formation Density

Drill Stem Tests Taken Yes No
 Samples Sent to Geological Survey Yes No
 Cores Taken Yes No

Formation Description KB2113'
 Log Sample

"DRILLERS LOG"

Interval	Description
0 - 20'	Clay
20 - 45'	Post Rock
45 - 343'	Shale
343 - 522'	Shale & sand strks.
522 - 670'	Sand
670 - 1120'	Shale
1120 - 1152'	Anhydrite
1152 - 1320'	Shale
1320 - 1912'	Shale & lime
1912 - 2850'	Lime & shale
2850 - 3817'	Lime
3817 - 3935'	Arbuckle
3935'	RTD

Name	Top	Bottom
Anhydrite	1123	+ 990
B/Anhydrite	1150	+ 963
Heebner	3426	-1313
Toronto	3443	-1330
Douglas	3454	-1341
Brown Lime	3513	-1400
Lansing/KC	3525	-1412
Base/KC	3753	-1640
Arbuckle	3808	-1695
TD	3935'	-1822

DST #1 3809' to 3817'
 30 - 45 - 30 - 45

IF: Strong blow, gas to surface in 4 min.
 FF: Strong blwo, gas too small to measure.
 Recovery: 1,140' gassy oil
 120' water

IHP 1923#; IFP 164#-141#, ISIP 955#,
 FFP 199#-282#, FSIP 931#, FHP 1923#

CASING RECORD S <input checked="" type="checkbox"/> New P <input checked="" type="checkbox"/> Used							
Report all strings set-conductor, surface, intermediate, production, etc.							
Purpose of String	Size Hole Drilled	Size Casing Set (in O.D.)	Weight Lbs/Ft.	Setting Depth	Type of Cement	#Sacks Used	Type and Percent Additives
Surface	12 1/4"	8 5/8"	23#	343'	POZMIX	165	3%CC+2%Gel
Production	7 7/8"	5 1/2"	14#	3934'	Common	100W/10% Salt Flush	20 lbs salt flush & 300 gal Mup Sweep.
PERFORATION RECORD				Acid, Fracture, Shot, Cement Squeeze Record			
Shots Per Foot	Specify Footage of Each Interval Perforated			(Amount and Kind of Material Used)		Depth	
3 SPF	3816' to 3818' 2 foot						
3 SPF	3823' to 3825' 2 foot						
TUBING RECORD		Size 2 7/8"	Set At 3812'	Packer at none	Liner Run <input type="checkbox"/> Yes <input checked="" type="checkbox"/> No		
Date of First Production	Producing Method <input type="checkbox"/> Flowing <input checked="" type="checkbox"/> Pumping <input type="checkbox"/> Gas Lift <input type="checkbox"/> Other (explain).....						
10/05/89							
Estimated Production Per 24 Hours	Oil	Gas	Water	Gas-Oil Ratio		Gravity	
	20 Bbls	-0- MCF	40 Bbls	CFPB		40	

METHOD OF COMPLETION

Production Interval

Disposition of gas: Vented Open Hole Perforation Sold Other (Specify) 3816'
 Used on Lease Dually Completed 3818'
 Commingled

BJ-TITAN SERVICES

P.O. BOX 4442 HOUSTON, TX 77210

CEMENTING LOG

15.009.24384.0000

STAGE NO.

Date 12-04 District GREAT BEND Ticket No. 510183
 Company ZANNI/KIDDI Co Rig KIRKMAN
 Lease 120000 Well No. 2
 County BARTON State KS
 Location MEYERSVILLE (H 30) 1 1/2 Field _____

CASING DATA: PTA Squeeze
 Surface Intermediate Production Liner
 Size _____ Type _____ Weight _____ Collar _____

Casing Depths: Top _____ Bottom _____

Drill Pipe: Size _____ Weight _____ Collars _____
 Open Hole: Size _____ T.D. _____ ft. P.B. to _____ ft.

CAPACITY FACTORS:

Casing: Bbls/Lin. ft. 0244 Lin. ft./Bbl. _____
 Open Holes: Bbls/Lin. ft. _____ Lin. ft./Bbl. _____
 Drill Pipe: Bbls/Lin. ft. _____ Lin. ft./Bbl. _____
 Annulus: Bbls/Lin. ft. _____ Lin. ft./Bbl. _____
TOBING Bbls/Lin. ft. 0059 Lin. ft./Bbl. _____
 Perforations: From _____ ft. to _____ ft. Amt. _____

CEMENT DATA:

Spacer Type: 65-35-6%
 Amt. 300 Skis Yield 1.80 ft³/sk Density 13.4 F

LEAD: Pump Time _____ hrs. Type _____
 Excess _____

Amt. _____ Skis Yield _____ ft³/sk Density _____ F

TAIL: Pump Time _____ hrs. Type _____
 Excess _____

Amt. 300 Skis Yield 1.80 ft³/sk Density 13 F

WATER: Lead 1 gals/sk Tail _____ gals/sk Total _____ B

Pump Trucks Used BSU 2540

Bulk Equip. BSU 2544

BSU 6264

Float Equip: Manufacturer _____

Shoe: Type _____ Depth _____

Float: Type _____ Depth _____

Centralizers: Quantity _____ Plugs Top _____ Btm. _____

Stage Collars _____

Special Equip. _____

Disp. Fluid Type _____ Amt. _____ Bbls. Weight _____ F

Mud Type _____ Weight _____

COMPANY REPRESENTATIVE Elmer J...

CEMENTER Ed + Howard

TIME	PRESSURES PSI		FLUID PUMPED DATA			REMARKS
	DRILL PIPE CASING	ANNULUS	TOTAL FLUID	Pumped Per Time Period	RATE Bbls Min	
12:00 PM						ARRIVE ON LOCATION
12:30						HAZE SAFETY MEETING
1:00						RIGUP PUMP TRUCK + SP. VALVE AND
1:00						
3:30						PAID HART SERVICES
3:30						Running tubing
4:30						RAW TEMPERATURE SURVEY
4:30						Set Bridge Plug and test to 750 PSI
5:30						12-05 FOUND CEMENT
5:30						Spot 254 Sand
						420' DOWN FROM SURFACE
						Shut down for drink
12:05						ARRIVE ON LOC 9:00 AM SAFETY MEET
9:15 AM						RUN TUBING AND TAPING PORT COLLAR
9:20						Pressure CGC + TUBING TO 750 PSI
9:25					3	OPER PORT COLLAR, PRESSURE CIRCULATE
9:35						START MIXING CEMENT - MIXED 300
						35-6 Lost Returns - Cement did not circ
10:03						FINISHED MIXING CEMENT
10:06						DISPENSE 5 BBL OUT OF USING
10:10						CLOSE PORT COLLAR
10:15						CIRCULATE CEMENT OUT OF HOLE
10:20						REPRESS CGC TO 750 PSI HOLD
10:25						RUN TUBING IN TO WASH SAND OFF PL
11:15						WASH SAND OFF PL
11:30						START PULLING TUBING
11:55						TUBING OUT
12:45 PM						Put GOC IN S/C CGC Press to 300 PSI



P.O. Box 4442, Houston, Tx. 77210
 REMIT TO: P.O. Box 200416, Houston, Tx. 77216

15.009.24384.0000
 TERMS NET 30 DAYS FROM DATE OF CONTRACT

DATE 12-5-89		SERVICE CONTRACT NO. 510183	
CUSTOMER ACCOUNT NO. 26570005		DIST NUMBER 3310	
CUSTOMER W & I OIL		NEW WELL <input type="checkbox"/> WELL OLD WELL <input checked="" type="checkbox"/> TYPE 0	
ADDRESS Box 308		JOB NUMBER 100031	
CITY Corbena		LEASE TARRANT	
STATE KS		WELL NO. #2	
ZIP		COUNTY BARIAN	
AUTHORIZED BY		CODE 009	
ORDER NO.		STATE KS	
STAGE NO.		FIELD NAME	
TYPE PORT COLLAR		WELL OWNER W & I OIL	
WORKING DEPTH 1200' FT		PUMPING EQUIPMENT	
SURFACE <input type="checkbox"/> INTERMEDIATE <input type="checkbox"/> PRODUCTION <input type="checkbox"/> REMEDIAL <input type="checkbox"/>		TIME (A OR P)	
TOTAL PREV. GALS.		TRUCK CALLED 12-04 11:00 AM	
SIZE HOLE 7 7/8		ARRIVED AT JOB 12:30 PM	
DEPTH FT		START OPERATION 12-05 9:30 AM	
SIZE & WT. CASING 5K 14		FINISH OPERATION 12:15 PM	
DEPTH FT		TIME RELEASED 12:30 PM 12-05-89	
SIZE & WT. DRILL PIPE OR TUBING		MILES FROM STATION TO WELL 34	
DEPTH FT		SALESMAN NUMBER	
PACKER DEPTH		REVENUE EQUIPMENT (UNIT NUMBERS)	
FLUID PUMPED		EMPLOYEES ON JOB (EMPLOYEE NUMBER)	
AVG. PSI. MAX. PSI.		MAX. BPM BSU-2540	
REVENUE EQUIPMENT (UNIT NUMBERS)		EMPLOYEES ON JOB (EMPLOYEE NUMBER)	
MAX. BPM BSU-2544 -6264		S/S EMPLOYEE NUMBER B.D.	
S/S EMPLOYEE NUMBER 34-3188		34-3188	

BLEND			CEMENT <input checked="" type="checkbox"/>			FRAC <input type="checkbox"/>			ACID <input type="checkbox"/>			SAND CONTROL <input type="checkbox"/>			
PRICE BOOK REF.	PART NO.	U/M	QTY.	PART NO.	U/M	QTY.	PART NO.	U/M	QTY.	PART NO.	U/M	QTY.	PART NO.	U/M	QTY.
10410504		SK	195												
10415018		SK	105												
10420148		CUT	156												
DEC 5 1989															

CONTRACT CONDITIONS: (This contract must be signed before the job is commenced or merchandise is delivered)
 The undersigned is authorized to execute this contract as an agent of the customer. As such, the undersigned agrees and acknowledges that this contract for services, material products, and/or supplies includes all of and only those terms and conditions appearing on the front and back of this document. No additional or substitute terms and/or conditions shall become a part of this contract without the written consent of an officer of BJ TITAN SERVICES.

PRICE BOOK	7	SIGNED: <i>Elmer Zimmerman</i>		(WELL OWNER, OPERATOR, CONTRACTOR OR AGENT)	
PRICE BOOK REF. NO.	QUANTITY	DESCRIPTION	UNIT PRICE	U/M	PRICE EXTENSION
10100303	1	PRICE OF JOB	375.00	SEP	375.00
10100325	900	DEPTH BELOW 300'	42	FT	378.00
10109005	34	PYM	1.10	RF	37.40
10415005	300	MITE WATER	4.69	SK	1407.00
10427510	2	SAND	10.00	SK	20.00
10488589	1	BEAUMONT HEAD	60.00	EA	60.00
101100303	1	SETUP CHARGE 10-04-89	375.00	EA	375.00
					2652.40
					557.80
					2094.50

SERVICE REPRESENTATIVE: *B.D. + Zimmerman*
 THE ABOVE MATERIAL AND SERVICE ORDERED BY CUSTOMER AND RECEIVED BY:

CHECK IF CONTINUATION IS USED (WELL OWNER, OPERATOR, CONTRACTOR OR AGENT)

CUSTOMER: This is not an invoice - This Service Operations Contract is subject to review and correction by our Accounting Department.

ZL018

JOB NUMBER	CONTRACT NUMBER	DATE	DISTRICT NAME
		12-4-89	CREAT BEND
CUSTOMER NAME AND ADDRESS		DIRECT SHIPMENT FROM	
W & J CO, 348		VENDOR NAME	
CREAT BEND, KANSAS		BOY TITAN PR AVE CREAT BEND, KS	

Item No.	Part Number	Description	UNIT OF MEASURE	AMOUNT LOADED	DIRECT SHIPPED	AMOUNT RETURNED
1	MS04	CHASS	SK	195	"	
2	5018	POZ	SK	105	"	
3	0145	GEL	CWT	15.66	"	
4						
5						
6						
7						
8						
9						
10						
11						
12						
13						
14						
15						
16						
17						
18						
19						
20						
21						
22						
23						
24	09600					
25						
26						
27						

COPY 1 - DISTRICT COPY COPY 2 - CUSTOMER COPY COPY 3 - HOUSTON	LOADED BY: <u>Hammer</u>	CUSTOMER: <u>Elmer J. Moore</u>	
		PRINTED	SIGNATURE
	<u>Hammer</u>	SIGNATURE	DATE: <u>12-4-89</u>