

WELL PLUGGING RECORD

Give All Information Completely
Make Required Affidavit
Mail or Deliver Report to:
Conservation Division
State Corporation Commission
211 No. Broadway
Wichita, Kansas

Barton County. Sec. 3 Twp. 20S Rge. 15W (X) ~~(XX)~~
Location as "NE/CNW%SW%" or footage from lines C-SE-SE-NE

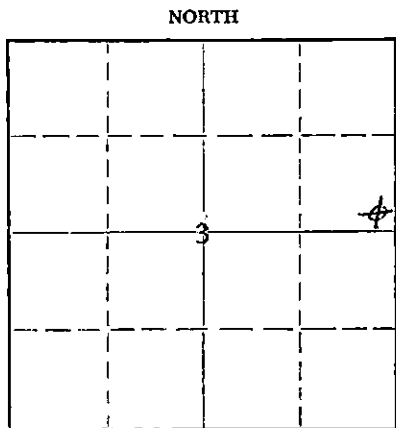

Locate well correctly on above
Section Plat

Lease Owner Woody Roberts
Lease Name G. S. Nichols Well No. 1
Office Address 1119 Cravens Building, Oklahoma City, Oklahoma
Character of Well (completed as Oil, Gas or Dry Hole) Dry Hole
Date well completed 7-15-63 19__
Application for plugging filed 19__
Application for plugging approved 7-15-63 19__
Plugging commenced 7-15-63 19__
Plugging completed 7-16-63 19__
Reason for abandonment of well or producing formation Dry Hole

If a producing well is abandoned, date of last production 19__
Was permission obtained from the Conservation Division or its agents before plugging was commenced? Yes

Name of Conservation Agent who supervised plugging of this well Mr. Hollis
Producing formation None Depth to top _____ Bottom _____ Total Depth of Well 3700 Feet
Show depth and thickness of all water, oil and gas formations.

OIL, GAS OR WATER RECORDS

CASING RECORD

FORMATION	CONTENT	FROM	TO	SIZE	PUT IN	PULLED OUT
Dakota Stringers	Wtr.	350	450	8 5/8"	885'	Left in Hole
No Oil or Gas Sands						

Describe in detail the manner in which the well was plugged, indicating where the mud fluid was placed and the method or methods used in introducing it into the hole. If cement or other plugs were used, state the character of same and depth placed, from _____ feet to _____ feet for each plug set.

Set 25 Sx cement by Howco @ 400' after hole first being filled w/rotary mud.

Ran 1/2 Sx hulls over plug, filled back w/rotary mud to 40'

Set 1/2 Sx hulls filled pipe 8 5/8" to surface w/cement by Howco
Dumped balance of cement in rat hole.

RECEIVED
STATE CORPORATION COMMISSION

SEP 3 1963

CONSERVATION DIVISION
Wichita, Kansas

(If additional description is necessary, use BACK of this sheet)

Name of Plugging Contractor Howco
Address Great Bend, Kansas

STATE OF _____, COUNTY OF _____, ss.

(employee of owner) or (owner or operator) of the above-described well, being first duly sworn on oath, says: That I have knowledge of the facts, statements, and matters herein contained and the log of the above-described well as filed and that the same are true and correct. So help me God.

(Signature) Woody Roberts

(Address)

SUBSCRIBED AND SWORN TO before me this 30th day of August, 1963

My commission expires August 9, 1967

Notary Public.

15.009.01540.0000

FARM NAME
WELL NO.
COUNTY
SEC.
TWP.
RGE.

(Mail to Corporation Commission, Oklahoma City, Oklahoma)
KANSAS CORPORATION COMMISSION
 OIL AND GAS CONSERVATION DEPARTMENT

FORMATION RECORD

Give detailed description and thickness of all formations drilled through, contents of sand, whether dry, water, oil or gas.

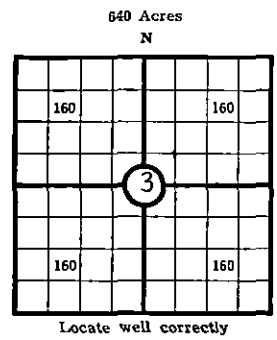

WELL RECORD
 COUNTY Barton, SEC. 3, TWP. 20S, RGE. 15W
 COMPANY OPERATING Woody's Quality Oil
 OFFICE ADDRESS 1119 Cravens Building
 FARM NAME G. Nichols WELL NO. 1
 DRILLING STARTED 7-3, 1963 DRILLING FINISHED 7-15, 1963
 DATE OF FIRST PRODUCTION None COMPLETED -----
 WELL LOCATED SE 1/4, SE 1/4, NE 1/4, 330' North of South
West East Line and 330' ft. East of West Line of Quarter Section
 Elevation (Relative to sea level) DERRICK FLOOR 1957 GROUND
 CHARACTER OF WELL (Oil, gas or dryhole) Dry Hole

OIL OR GAS SANDS OR ZONES

Name	From	To	Name	From	To
1 None			4		
2			5		
3			6		

Perforating Record If Any

Shot Record

Formation	From	To	No. of Shots	Formation	From	To	Size of Shot
None							

CASING RECORD

Amount Set								Amount Pulled		Packer Record	
Size	Wt.	Thds.	Make	Ft.	In.	Ft.	In.	Size	Length	Depth Set	Make
8 5/8	23#	8rd		885				Left in Hole			

Liner Record: Amount None Kind None Top None Bottom None

CEMENTING AND MUDDING

Size	Amount Set		Sacks Cement	Chemical		Method of Cementing	Amount	Mudding Method	Results (See Note)
	Ft.	In.		Gal.	Make				
8 5/8	885		400			Howco		Circ. to surface	

Note: What method was used to protect sands if outer strings were pulled?

NOTE: Were bottom hole plugs used? If so, state kind, depth set and results obtained

TOOLS USED

Rotary Tools were used from 0 feet to 3700' Cable tools were used from _____ feet to _____ feet, and from _____ feet to _____ feet, and from _____ feet to _____ feet.

Type Rig Rotary

INITIAL PRODUCTION TEST

Describe initial test: whether by flow through tubing or casing or by pumping dry hole

Amount of Oil Production _____ bbls. Size of choke, if any _____ Length of test _____ Water Production _____ bbls. Gravity of oil _____ Type of Pump if pump is used, describe _____

Formation	Top	Bottom	Formation	Top	Bottom
Sand-Shale & Lime Streaks	0	2688			
Tarkio Sand	2688	2710			
Willard Shale	2710	2746			
Elmont-Reading Ls	2746	2824			
Howard Ls.	2824	2884			
Topeka Ls.	2884	3220			
Heebner Shale	3220	3236			
Toronto Ls.	3236	3254			
Douglas Shale	3254	3308			
Brown Lime	3308	3320			
Lansing Lime	3320	3496			
Kansas City Lime	3496	3550			
Top Soeey Congl.	3550	3700			
No Arbuckle Dolo developed.					
Total Depth	3700'				

RECEIVED
 STATE CORPORATION COMMISSION

SEP 3 1963

CONSERVATION DIVISION
 Wichita, Kansas

I, the undersigned, being first duly sworn upon oath, state that this well record is true, correct and complete according to the records of this office and to the best of my knowledge and belief.

Woody Roberts
 Name and title of representative of company

Subscribed and sworn to before me this 30th day of August, 1963
 My Commission expires Aug 9, 1967
W. L. Harris
 Notary Public.