

STATE OF KANSAS  
STATE CORPORATION COMMISSION

WELL PLUGGING RECORD

Give All Information Completely  
Make Required Affidavit  
Mail or Deliver Report to  
Conservation Division  
State Corporation Comm.  
245 North Water  
Wichita, KS 67202

BARTON County. Sec. 27 Twp. 20S Rge. 14W ~~XXW~~  
Location as "NE/CNW/SW" or footage from lines  
SW SE SW

Lease Owner C-G DRILLING CO  
Lease Name KIRKMAN Well No. 1  
Office Address 1107 DOUGLAS BLDG, WICHITA, KS 67202  
Character of Well (Completed as Oil, Gas or Dry Hole)  
DRY HOLE

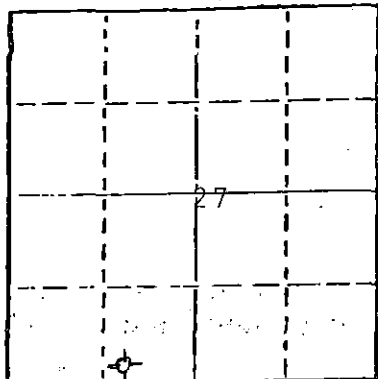

Locate well correctly on above  
Section Plot

Date Well completed 11/13/77 19  
Application for plugging filed 11/13/77 19  
Application for plugging approved 11/13/77 19  
Plugging commenced 11/13/77 19  
Plugging completed 11/13/77 19  
Reason for abandonment of well or producing formation  
TOO LOW STRUCTURALLY

If a producing well is abandoned, date of last production 19

Was permission obtained from the Conservation Division or  
its agents before plugging was commenced? YES

Name of Conservation Agent who supervised plugging of this well DUANE L RANKIN  
Producing formation Depth to top Bottom Total Depth of Well 3580'  
Show depth and thickness of all water, oil and gas formations.

OIL, GAS OR WATER RECORDS

CASING RECORD

FORMATION	CONTENT	FROM	TO	SIZE	PUT IN	PULLED OUT
				8 5/8"	834.92'	NONE

Describe in detail the manner in which the well was plugged, indicating where the mud fluid  
was placed and the method or methods used in introducing it into the hold. If cement or other  
plugs were used, state the character of same and depth placed, from feet to  
feet for each plug set.

FILLED WITH HEAVY MUD TO 360'  
SET PLUG. PUT IN 40 SACKS CEMENT.  
FILLED WITH HEAVY MUD TO 40'. SET PLUG.  
FILLED TO TOP WITH 10 SACKS 50/50 POZ 6% GEL.

RECEIVED  
STATE CORPORATION COMMISSION  
NOV 21 1977 11-21-1977

(If additional description is necessary, use BACK of this sheet)

Name of Plugging Contractor

STATE OF KANSAS COUNTY OF SEDGWICK ss:  
G F GALLOWAY

(employee of owner) or (owner or operator) of the above-described  
well, being first duly sworn on oath, says: That I have knowledge of the facts, statements, and matters herein contained and the log of the  
above-described well as filed and that the same are true and correct. So help me God

(Signature) *G F Galloway*  
G F GALLOWAY

1107 DOUGLAS BLDG  
WICHITA, KS 67202  
19 77

SUBSCRIBED AND SWORN TO before me this 18TH day of NOVEMBER

My commission expires MARCH 3, 1980

*Debra L Heersche*  
DEBRA L HEERSCHE Notary Public.

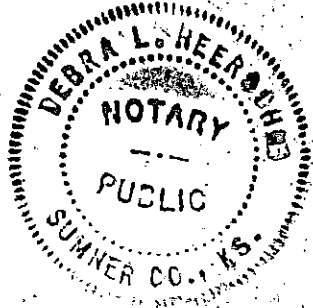

**KANSAS DRILLERS LOG**

S. 27 T. 20 R. 14 <sup>K</sup><sub>W</sub>  
 Loc. SW SE SW  
 County Barton

API No. 15 — 009 — 21,277 00001  
 County Number

Operator  
C-G Drilling Co.

Address  
1107 Douglas Building Wichita, Kansas 67202

Well No. #1 Lease Name Kirkman

Footage Location  
330 feet from (N) (S) line 1650 feet from (E) (W) line

Principal Contractor C-G DRILLING CO Geologist Jerry Jespersen

Spud Date 11/4/77 Total Depth 3580 P.B.T.D.

Date Completed 11/13/77 Oil Purchaser

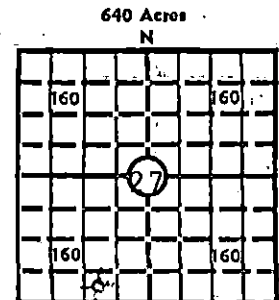

Locate well correctly  
 Elev.: Gr. \_\_\_\_\_  
 DF \_\_\_\_\_ KB 1908'

**CASING RECORD**

Report of all strings set—surface, intermediate, production, etc.

Purpose of string	Size hole drilled	Size casing set (in O.D.)	Weight lbs/ft.	Setting depth	Type cement	Sacks	Type and percent additives
SURFACE	12 1/4"	8 5/8"	28#	834.92'	Common	375	2% Gel 3% CC

**LINER RECORD**

**PERFORATION RECORD**

Top, ft.	Bottom, ft.	Sacks cement	Shots per ft.	Size & type	Depth Interval

**TUBING RECORD**

Size	Setting depth	Packer set at

**ACID, FRACTURE, SHOT, CEMENT SQUEEZE RECORD**

Amount and kind of material used	Depth interval treated

RECEIVED  
 STATE CORPORATION COMMISSION  
 NOV 21 1977  
 OIL AND GAS DIVISION  
 KANSAS

**INITIAL PRODUCTION**

Date of first production	Producing method (flowing, pumping, gas lift, etc.)			
RATE OF PRODUCTION PER 24 HOURS	Oil	Gas	Water	Gas-oil ratio
	bbls.	MCF	bbls.	CFPB
Disposition of gas (vented, used on lease or sold)		Producing interval(s)		

INSTRUCTIONS: As provided in KCC Rule 82-2-125, within 90 days after completion of a well, one completed copy of this Drillers Log shall be transmitted to the State Geological Survey of Kansas, 4150 Monroe Street, Wichita, Kansas 67209. Copies of this form are available from the Conservation Division, State Corporation Commission, 3830 So. Maridian (P.O. Box 17027), Wichita, Kansas 66217. Phone AC 316-522-2206. If confidential custody is desired, please note Rule 82-2-125. Drillers Logs will be on open file in the Oil and Gas Division, State Geological Survey of Kansas, Lawrence, Kansas 66044.

Operator C-G Drilling Co. DESIGNATE TYPE OF COMP. OIL, GAS, DRY HOLE, SWDW, ETC.: Dry Hole

Well No. 1 Lease Name Kirkman

S. 27 T20S R. 14 W

**WELL LOG**

Show all important zones of porosity and contents thereof; cored intervals, and all drill-stem tests, including depth interval tested, cushion used, time tool open, flowing and shut-in pressures, and recoveries.

SHOW GEOLOGICAL MARKERS, LOGS RUN, OR OTHER DESCRIPTIVE INFORMATION.

FORMATION DESCRIPTION, CONTENTS, ETC.	TOP	BOTTOM	NAME	DEPTH
SAND & SHALE	0	824		
ANHYDRITE	824	852		
SAND & SHALE	853	1245		
SHALE & LIME	1245	1730		
LIME & SHALE	1730	3280		
LIME & RTD	3280	3580		
<p>DST #1: 3306-3376 30-30-30-30. WEAK BLOW FOR 10 MIN IBHP 516#, FBHP 164#, IFP 93#, FFP 93#.</p> <p>DST #2: 3558-3580 MISS RUN-COULD NOT GET TO BOTTOM</p> <p>DST #3: 3558-3580' 30-30-30-30. SLID 6' TO BOTTOM. REC 210' MUD IBHP 627#, FBHP 467#, IFP 203#, FFP 203#</p>				

USE ADDITIONAL SHEETS, IF NECESSARY, TO COMPLETE WELL RECORD.

Date Received: \_\_\_\_\_

Signature: *Debra L Heersche*  
 Debra L Heersche  
 Office Manager

Title: \_\_\_\_\_

Date: 11/18/77