

Give All Information Completely
Make Required Affidavit
Mail or Deliver Report to:
Conservation Division
State Corporation Commission
800 Bittling Building
Wichita, Kansas

RECEIVED
OCT 14 1936
J.K.

10-14-36

15.009.14407.0000

WELL PLUGGING RECORD

FORMATION PLUGGING RECORD

Strike out upper line when reporting plugging of formations.

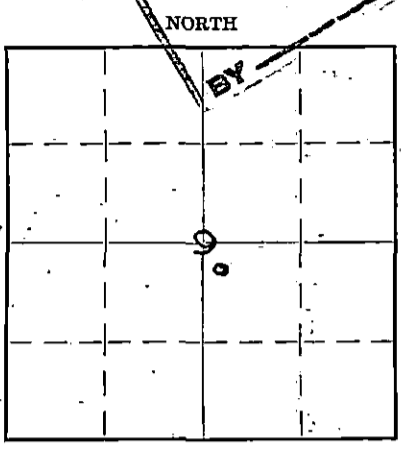

Location as "NE $\frac{1}{4}$ NW $\frac{1}{4}$ SW $\frac{1}{4}$ " or footage from lines... 1270' N. of E. Line 000 E. of T.

Lease Owner... Standard Oil and Gas Company
Lease Name... Rate School Corp Well No. 1

Office Address... Box 502, Tulsa, Oklahoma
Character of Well (Completed as Oil, Gas or Dry Hole)... Dry Hole

Date, well completed... March 30th 19 31
Application for plugging filed... April 27, 1936 193

Application for plugging approved... April 29 193 6
Plugging Commenced... April 30th 193 6

Plugging Completed... April 30th 193 6
Reason for abandonment of well or producing formation... Dry Hole

If a producing well is abandoned, date of last production... 193

Was permission obtained from the Conservation Division or its agents before plugging was commenced? Yes
Raymond Gear

Name of Conservation Agent who supervised plugging of this well...
Producing formation... Depth to top... Bottom... Total Depth of Well... 5200 Feet

OIL, GAS OR WATER RECORDS **CASING RECORD**

| Formation | Content | From | To | Size | Put In | Pulled Out |
|-----------|---------|------|----|-----------|-----------|------------|
| | | | | 1 3/8" OD | 163' 3" | None |
| | | | | 2-5/8" | 1628' 10" | 1200' |
| | | | | 5-1/2" | 3230' 11" | 2535' |

Describe in detail the manner in which the well was plugged, indicating where the mud fluid was placed and the method or methods used in introducing it into the hole. If cement or other plugs were used, state the character of same and depth placed, from...feet to...feet for each plug set.

Filled hole with mud then ripped 5-1/2" casing at 2535' and pulled 5-1/2" casing and filled hole with mud and ripped 2-5/8" casing at 1270' then pulled 2-5/8" casing and filled hole to bottom of surface pipe with mud and put in 10 sacks cement and then filled hole with mud to top. Put cap on top of well with 5 sacks of cement.

PLUGGING
FILE 35-9-20-11W
BOOK 43 PAGE 47

(If additional description is necessary use BACK of this sheet)

Correspondence regarding this well should be addressed to... Mr. J.L. Nichols Standard Oil and Gas Co
Address... Box 502, Tulsa, Oklahoma

STATE OF Oklahoma, COUNTY OF Stafford, ss.

... (employee of owner) or (owner or operator) of the above-described well, being first duly sworn on oath, says: That I have knowledge of the facts, statements, and matters herein contained and the log of the above-described well as filed and that the same are true and correct. So help me God.

(Signature) H.S. Nothing

(Address) 36

SUBSCRIBED AND SWORN to before me this 9 day of October 19 36

My commission expires May 7th 1940
[Signature]
Notary Public.

STANOLIND OIL AND GAS COMPANY WELL RECORD

640 Acres

11 W N

20 S

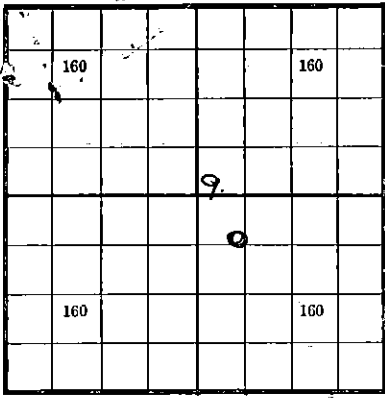

Locate Well Correctly

COUNTY Barton, SEC. 9, TWP. 20S, RGE. 11W
 COMPANY OPERATING Stanolind Oil and Gas Company
 OFFICE ADDRESS Philcade Bldg. Tulsa, Oklahoma
 FARM NAME P. Scheufler WELL NO. 3
 DRILLING STARTED 1-8-1935, DRILLING FINISHED 3-5-, 1935
 WELL LOCATED NW 1/4 SE 1/4 1950 ft. North of South
 Line and 660 ft. East of West Line of Quarter Section.
 ELEVATION (Relative to sea level) DERRICK FLR. 1773 GROUND 1770
 CHARACTER OF WELL (Oil, gas or dry hole) Dry Hole

OIL OR GAS SANDS OR ZONES

| | Name | From | To | | Name | From | To |
|---|----------------|------|------|---|------|------|----|
| 1 | Lansing Lime | 3059 | 3307 | 4 | | | |
| 2 | Siliceous Lime | 3307 | 3390 | 5 | | | |
| 3 | | | | 6 | | | |

WATER SANDS

| | Name | From | To | Water Level | | Name | From | To | Water Level |
|---|-----------------|------|------|-------------|--|------|------|----|-------------|
| 1 | Fort Riley Lime | 1595 | 1735 | 4 | | | | | |
| 2 | Siliceous Lie | 3307 | 3390 | 5 | | | | | |
| 3 | | | | 6 | | | | | |

CASING RECORD

| Size | Wt. | Thds. | Make | Amount Set | | Amount Pulled | | Packer Record | | | | |
|-------|-----|-------|------|------------|-----|---------------|-------|---------------|--------|-----------|------|--|
| | | | | Ft. | In. | Ft. | In. | Size | Length | Depth Set | Make | |
| 13 | 50 | 8 | LW | 198 | 3 | Set at | 199' | 3" | | | | |
| 8-5/8 | 32 | 8 | SS | 1602 | 10 | Set at | 1606' | 4" | | | | |
| 5 1/2 | 20 | 10 | SS | 3290 | 11 | Set at | 3293' | 8" | | | | |

Liner Record: Amount _____ Kind _____ Top _____ Bottom _____

CEMENTING AND MUDDING RECORD

| Size | Amount Set | | Sacks Cement | Chemical | | Method of Cementing | Amount | Mudding Method | Results (See Note) |
|-------|------------|-----|--------------|----------|------|---------------------|--------|----------------|--------------------|
| | Feet | In. | | Gal. | Make | | | | |
| 13 | 198 | 3 | 200 | | | Haliburton | | | |
| 8-5/8 | 1602 | 10 | 150 | | | Haliburton | | | |
| 5 1/2 | 3290 | 11 | 100 | | | Haliburton | | | |

PLUGGING

FILE SET 9 20 RMW

BOOK PAGE 43 LINE 47

NOTE: What method was used to protect sands when outer strings were pulled? _____

NOTE: Were bottom hole plugs used? _____ If so, state kind, depth set and results obtained _____

TOOLS USED

Rotary tools were used from Surface feet to 3311 feet, and from _____ feet to _____ feet

Cable tools were used from 3311 feet to 3390 feet, and from _____ feet to _____ feet

Type Rig Rotary

PRODUCTION DATA

Production first 24 hours _____ bbls. Gravity _____, Emulsion _____ per cent., Water _____ per cent

Production second 24 hours _____ bbls. Gravity _____, Emulsion _____ per cent., Water _____ per cent

If gas well, cubic feet per 24 hours _____ Rock Pressure, lbs. per square inch _____

I, the undersigned, being first duly sworn upon oath, state that this well record is true, correct and complete according to the records of this office and to the best of my knowledge and belief.

Name and Title _____

Subscribed and sworn to before me this the _____ day of _____, 1935.

My commission expires _____

Notary Public.

FORMATION RECORD

Give detailed description and thickness of all formations drilled through and contents of sand, whether dry, water, oil or gas.

| Formation | Top | Bottom | Formation | Top | Bottom |
|------------------|------|--------|--|------|---------|
| Sand | 0 | 70 | ROTARY CORING | | |
| Shale and Shells | 70 | 105 | | | |
| Sand | 105 | 120 | Dark Shale | 3042 | 3053 |
| Shale and Shells | 120 | 410 | Red Shale | 3053 | 3057 |
| Red Rock | 410 | 496 | Dark Shale | 3057 | 3059 |
| Anhydrite | 496 | 519 | Lime | 3059 | 3062 |
| Shale | 519 | 545 | Lime Drilled | 3062 | 3089 |
| Shale and Shells | 545 | 1050 | Lime Cored | 3089 | 3104 |
| Salt | 1050 | 1260 | Lime Drilled | 3104 | 3129 |
| Shale | 1260 | 1340 | Lime Cored | 3129 | 3144 |
| Red Rock and Gyp | 1340 | 1360 | Lime Drilled | 3144 | 3285 |
| Shale and Shells | 1360 | 1405 | Lime Cored | 3285 | 3295 |
| Broken Lime | 1405 | 1455 | Lime Cored | 3295 | 3302 |
| Shale and Shells | 1455 | 1500 | Show of Oil ---- | 3297 | |
| Lime | 1500 | 1570 | Lime Cored | 3302 | 3306 |
| Shale | 1570 | 1595 | Shale Cored | 3306 | 3307 |
| Shale and Shells | 1595 | 1607 | Dolomite and Chert | 3307 | 3311 |
| Lime | 1607 | 1650 | | | |
| Soft Lime | 1650 | 1716 | DRILLED WITH CABLE TOOLS | | |
| Hard Lime | 1716 | 1720 | | | |
| Lime | 1720 | 1730 | Chert | 3311 | 3332 |
| Red Rock | 1730 | 1740 | Dolomite | 3332 | 3390 TD |
| Shale and Shells | 1740 | 1835 | | | |
| Lime | 1835 | 1850 | | | |
| Shale and Shells | 1850 | 1875 | | | |
| Red Rock | 1875 | 1885 | T.D. 3390' 3-5-35 | | |
| Shale and Shells | 1885 | 2215 | | | |
| Shale | 2215 | 2261 | 5 bailers sulphur water per hour at 3385-3390 | | |
| Sticky shale | 2261 | 2275 | | | |
| Shale and Shells | 2275 | 2340 | | | |
| Sticky Shale | 2340 | 2370 | Hole Filled With Mud and Temporarily abandoned | | |
| Shale | 2370 | 2402 | | | |
| Lime | 2402 | 2420 | | | |
| Broken Lime | 2420 | 2480 | | | |
| Sticky Shale | 2480 | 2490 | | | |
| Lime | 2490 | 2510 | | | |
| Shale | 2510 | 2535 | | | |
| Lime | 2535 | 2615 | | | |
| Shale and Shells | 2615 | 2630 | | | |
| Lime | 2630 | 2690 | | | |
| Shale | 2690 | 2700 | | | |
| Lime | 2700 | 2930 | | | |
| Shale | 2930 | 2963 | | | |
| Lime | 2963 | 2970 | | | |
| Shale | 2970 | 3015 | | | |
| Broken Lime | 3015 | 3042 | | | |