

STATE OF KANSAS
STATE CORPORATION COMMISSION

WELL PLUGGING RECORD

Give All Information Completely
Make Required Affidavit
Mail or Deliver Report to:
Conservation Division
State Corporation Commission
800 Biting Building
Wichita, Kansas

Rice County, Sec. 14 Twp. 20 Rge. 8 (W)

Location as "NE/CNW/SW" or footage from lines SW/4 SW/4 SE/4
Lease Owner Thos. H. Allen, et al
Lease Name Blevins Well No. 2
Office Address 1221 Union National Bank Bldg., Wichita 2, Kansas
Character of Well (completed as Oil, Gas or Dry Hole) Dry Hole
Date well completed May 3 19 52
Application for plugging filed May 3 19 52
Application for plugging approved May 3 19 52
Plugging commenced May 3 19 52
Plugging completed May 3 19 52
Reason for abandonment of well or producing formation Dry Hole

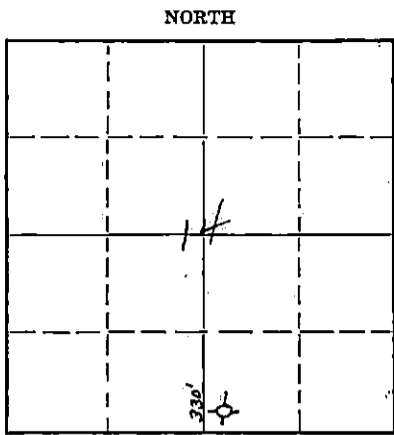

Locate well correctly on above Section Plat

If a producing well is abandoned, date of last production 19
Was permission obtained from the Conservation Division or its agents before plugging was commenced? Yes

Name of Conservation Agent who supervised plugging of this well Ruel Durkee
Producing formation Conglomerate Depth to top 3245' Bottom 3258' Total Depth of Well 3273 Feet
Show depth and thickness of all water, oil and gas formations.

OIL, GAS OR WATER RECORDS

CASING RECORD

Formation	Content	From	To	Size	Put In	Pulled Out
				8 5/8"	174'	None

Describe in detail the manner in which the well was plugged, indicating where the mud fluid was placed and the method or methods used in introducing it into the hole. If cement or other plugs were used, state the character of same and depth placed, from feet to feet for each plug set.

3273' - 165' Heavy Mud
165' - 15' Bridge, 20 sacks cement, and mud
15' - Surface Bridge and 5 sacks cement

RECEIVED
STATE CORPORATION COMMISSION
MAY 10 1952
CONSERVATION DIVISION
Wichita, Kansas

(If additional description is necessary, use BACK of this sheet)
Name of Plugging Contractor Thos. H. Allan
Address 1221 Union National Bank Building, Wichita 2, Kansas

STATE OF KANSAS, COUNTY OF SEDGWICK, ss.
Thos. H. Allan (employee of owner) or (owner or operator) of the above-described well,
being first duly sworn on oath, says: That I have knowledge of the facts, statements, and matters herein contained and the log of the above-described well as filed and that the same are true and correct. So help me God.

(Signature) Thos. H. Allan
1221 Union Nat'l Bank Bldg., Wichita 2, Kans.
(Address)

SUBSCRIBED AND SWORN to before me this 9th day of May, 19 52.
Orie M. Stewart
Notary Public.

My commission expires June 14, 1954

PLUGGING
FILE SEC 14 T 20 R 8W
BOOK PAGE 14 LINE 21

8 5/8" @ 174' - 150' sx

ALLAN & BROOKS #2 BLEVINS
 SW SW SE, 14-20-8W
 Rice County, Kansas
 COMM: 4/22/52 COMPL: 5/3/52
 CONTRACTOR: Tom Allan
 ELEVATION: 1647 RB
 I.P. D & A

Depth from Rotary Bushings

- 0 - 80 Surface Soil, sand & gravel
- 172 Red Beds
- 184 Anhydrite
- 510 Red Beds
- 760 Shale
- 1020 Salt & Shale
- 1120 Anhydrite
- 2370 Shale & Shells
- 2720 Lime & Shale Partings
- 2831 Shale
- 2838 Brown Lime
- 2860 Shale & Sand
- 2888 Lime
- 2893 Soft oolitic Lime
- 2964 Lime & Shale
- 2982 Soft oolitic Lime
- 3015 Lime
- 3026 Shale
- 3035 Cherty Lime
- 3050 Soft oolitic Lime
- 3056 Lime
- 3068 Shale
- 3093 Oolitic Lime & Shale
- 3132 Lime
- 3165 Cherty Lime & Shale
- 3233 Lime & Shale
- 3245 Varicolored Shale
- 3255 Red Shale Conglomerate
- 3257 Varicolored Chert
- 3273 (TD) Red & Green Shale

I certify that the above is a true and correct copy of the well log on the above test.

Tom Allan

Subscribed and sworn to before me this 17th day of May, 1952

Ocie M. Stewart
 Notary Public

My Commission expires June 14, 1954

FORMATIONS:

- Lansing 2860
- Conglomerate 3245
- Kinderhook 3258

D.S.T. 3217-72
 Tool open 10 min.
 Recovered 15' Rotary Mud
 BHP Shut in 30 min. 1125#

PLUGGING
 WEL 822-14T-20862
 BOOK PAGE 19 LINE 21

RECEIVED
 STATE CORPORATION COMMISSION
 MAY 10 1952
 CONSERVATION DIVISION
 Wichita, Kansas