

STATE OF KANSAS  
STATE CORPORATION COMMISSION

WELL PLUGGING RECORD

Give All Information Completely  
Make Required Affidavit  
Mail or Deliver Report to:  
Conservation Division  
State Corporation Commission  
212 No. Market  
Wichita, Kansas

BARTON County, Sec 10 Twp. 20S Rge. 12 (X) (W)

Location as "NE/CNW/SW" or footage from lines SW SE NE

Lease Owner PETROLEUM, INC.,

Lease Name ARK RIVER RANCH, INC., Well No. D-1

Office Address R. R. #2, GREAT BEND, KANSAS

Character of Well (completed as Oil, Gas or Dry Hole) OIL

Date well completed NOVEMBER 19 19 68

Application for plugging filed JULY 15 19 69

Application for plugging approved JULY 16 19 69

Plugging commenced JULY 17 19 69

Plugging completed JULY 20 19 69

Reason for abandonment of well or producing formation DEPLETION OF PRODUCING ZONE

If a producing well is abandoned, date of last production JANUARY 6 1969

Was permission obtained from the Conservation Division or its agents before plugging was commenced? YES

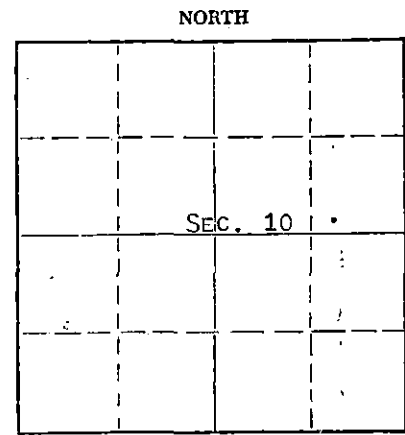

Locate well correctly on above Section Plat

Name of Conservation Agent who supervised plugging of this well DONALD TRUAN

Producing formation ARBUCKLE Depth to top 3363 Bottom 3408 Total Depth of Well 3408 Feet

Show depth and thickness of all water, oil and gas formations.

OIL, GAS OR WATER RECORDS

CASING RECORD

FORMATION	CONTENT	FROM	TO	SIZE	PUT IN	PULLED OUT
ARBUCKLE	SLIGHT AMOUNT OIL & WATER	3370'	3390'	8-5/8	209'	NONE
				5-1/2	3406'	2951'

Describe in detail the manner in which the well was plugged, indicating where the mud fluid was placed and the method or methods used in introducing it into the hole. If cement or other plugs were used, state the character of same and depth placed, from \_\_\_\_\_ feet to \_\_\_\_\_ feet for each plug set.

PLUGGED BACK TOTAL DEPTH 3402'. SAND IN HOLE FROM 3402' TO 3370'.  
PLACED 5 SACKS CEMENT FROM 3370' TO 3330'. HEAVY MUD FROM 3330' TO  
270', PUMPED 90 SACKS CEMENT FROM 270' TO BASE OF WELL CELLAR.

RECEIVED  
STATE CORPORATION COMMISSION  
AUG 8 1969  
CONSERVATION DIVISION  
Wichita, Kansas

8-8-69

(If additional description is necessary, use BACK of this sheet)

Name of Plugging Contractor SANTA FE PIPE & SUPPLY CO.

Address Box 562, GREAT BEND, KANSAS

STATE OF KANSAS, COUNTY OF BARTON, ss.

Monte Chadd (employee of owner) or (owner or operator) of the above-described well, being first duly sworn to, do oath, says: That I have knowledge of the facts, statements, and matters herein contained and the log of the above-described well as filed and that the same are true and correct. So help me God.

(Signature) Monte Chadd

R. R. #2, GREAT BEND, KANSAS (Address)

Subscribed and sworn to before me this 7 day of AUGUST, 1969

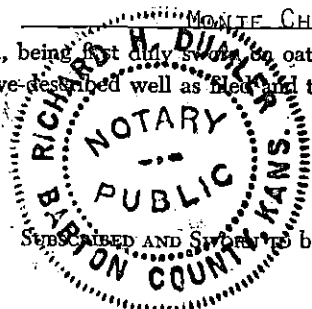

Richard H. Dunlap Notary Public.

My commission expires MAY 28, 1973

# WELL LOG

15.009.20291.0000

COMPANY Petroleum, Inc.

SEC. 10 T. 20S R. 12W

FARM Ark River Ranch, Inc. NO. D-1

LOC. SW SE NE

TOTAL DEPTH 3408'

COUNTY Barton Co., Kansas

COMM. 10-23-68

COMP. 11-1-68

CONTRACTOR Garvey Drilling Company



CASING 8 5/8" @ 209' w/300. sx  
5 1/2" @ 3406' w/100. sx

ELEVATION 1806' KB

PRODUCTION ARBUCKLE

FIGURES INDICATE BOTTOM OF FORMATIONS

- 160' Sand & Clay
- 209' Shale
- 609' Shells & Shale
- 620' Anhydrite
- 900' Shale
- 1578' Shale & Shells
- 2980' Lime & Shale
- 3388' Lime
- 3408' Arbuckle
- 3408' RTD.

RECEIVED  
STATE CORPORATION COMMISSION  
AUG 8 1969  
CONSERVATION DIVISION  
Wichita, Kansas

State of Kansas }  
County of Barton } SS

I, Eunice McEachern of Garvey Drilling Company  
upon oath state the above and foregoing is a true and correct copy of the log of the Ark River Ranch, Inc. D-1 well.

*Eunice McEachern*

Subscribed and sworn to before me this 8th day of November 19 68  
May 28, 1969

My Commission Expires November 5th 1969

NOTARY PUBLIC