

STATE CORPORATION COMMISSION OF KANSAS
OIL & GAS CONSERVATION DIVISION

WELL COMPLETION OR RECOMPLETION FORM
ACO-1 WELL HISTORY

DESCRIPTION OF WELL AND LEASE

Operator: license # 5692
name Fina Oil & Chemical Company
address 1401 N.W. Expressway
Ste. 900
City/State/Zip Oklahoma City, OK 73118

Operator Contact Person Raylene Smith
Phone (405) 840-0671

Contractor: license # _____
name ALLIED CEMENTING

Wellsite Geologist _____
Phone _____

PURCHASER _____

Designate Type of Completion
 New Well Re-Entry Workover

Oil SWD Temp Abd
 Gas Inj Delayed Comp.
 Dry Other (Core, Water Supply etc.)

If OWWO: old well info as follows:
Operator _____
Well Name _____
Comp. Date _____ Old Total Depth _____

WELL HISTORY

Drilling Method: Mud Rotary Air Rotary Cable
1-4-71 1-13-71 Plugged 8-4-87
Spud Date Date Reached TD Completion Date
3788'
Total Depth PBTD

Amount of Surface Pipe Set and Cemented at 1048' feet

Multiple Stage Cementing Collar Used? Yes No
If Yes, Show Depth Set _____ feet

If alternate 2 completion, cement circulated from _____ feet depth to _____ w/ _____ SX cmt

INSTRUCTIONS: This form shall be completed in duplicate and filed with the Kansas Corporation Commission, 200 Colorado Derby Building, Wichita, Kansas 67202, within 90 days after completion or recompletion of any well. Rules 82-3-130 and 82-3-107 apply.

Information on side two of this form will be held confidential for a period of 12 months if requested in writing and submitted with the form. See rule 82-3-107 for confidentiality in excess of 12 months.

One copy of all wireline logs and drillers time log shall be attached with this form. Submit CP-4 form with all plugged wells. Submit CP-111 form with all temporarily abandoned wells.

All requirements of the statutes, rules, and regulations promulgated to regulate the oil and gas industry have been fully complied with and the statements herein are complete and correct to the best of my knowledge.

Signature Raylene M. Smith
Title Production Tech. Date 8-17-87

Subscribed and sworn to before me this 17th day of August 1987

Notary Public William A. Smith
Date Commission Expires 2-20-88

15-145-20185
API NO. 15- 1-13-71 (API # unknown)
County Pawnee
C. 3/2 NW NW Sec 36 Twp 20S Rge 16 X West

4290 Ft North from Southeast Corner of Section
4620 Ft West from Southeast Corner of Section
(Note: locate well in section plat below)

Lease Name Deckert Well# 2
Field Name Pawnee Rock
Producing Formation Arbuckle
Elevation: Ground _____ KB 2047'

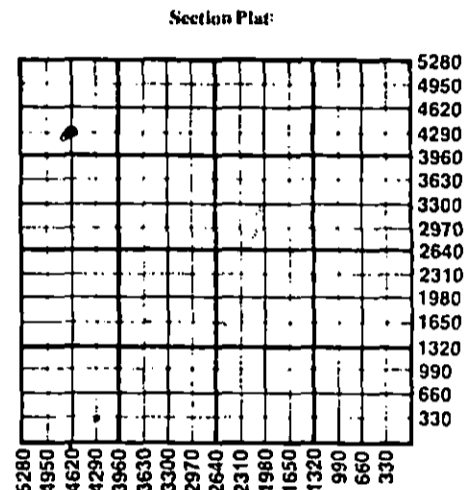

WATER SUPPLY INFORMATION

Source of Water: _____
Division of Water Resources Permit # _____
 Groundwater _____ Ft North From Southeast Corner and _____ Ft. West From Southeast Corner of (Well) Sec _____ Twp _____ Rge East West
 Surface Water _____ Ft North From Southeast Corner and _____ Ft West From Southeast Corner (Stream, Pond etc.) Sec _____ Twp _____ Rge East West
 Other (explain) _____ (purchased from city, R.W.D.#)

Disposition of Produced Water: Disposal Repressuring
Docket # _____

K.C.C. OFFICE USE ONLY
F Letter of Confidentiality Attached
C Wireline Log Received
C Drillers Timelog Received
Distribution
 KCC SWD/Rep NGPA
 KGS Plug Other (Specify)
AUG 18 1987

Sec. 36, Twp. 20S, Rge. 16W

Operator Name Fina Oil & Chemical Co. Lease Name Deckert Well# 2-36 SEC. 36 TWP. 20 RGE. 16 East West

WELL LOG

INSTRUCTIONS: Show important tops and base of formations penetrated. Detail all cores. Report all drill stem tests giving interval tested, time tool open and closed, flowing and shut-in pressures, whether shut-in pressure reached static level, hydrostatic pressures, bottom hole temperature, fluid recovery, and flow rates if gas to surface during test. Attach extra sheet if more space is needed. Attach copy of log.

Drill Stem Tests Taken Yes No
 Samples Sent to Geological Survey Yes No
 Cores Taken Yes No

Formation Description
 Log Sample

Name	Top	Bottom
Anhydrite	1043'	
Base Anhydrite	1075'	
Heebner Shale	3376'	
Douglas Shale	3405'	
Brown Lime	3464'	
Lansing	3474'	
Arbuckle	3782'	
T.D.	3790'	

CASING RECORD <input type="checkbox"/> new <input type="checkbox"/> used							
Report all strings set - conductor, surface, intermediate, production, etc.							
Purpose of string	size hole drilled	size casing set (in O.D.)	weight lbs/ft.	setting depth	type of cement	# sacks used	type and percent additives
Surface Prod.		8 5/8" 5 1/2"		1048' 3782'		4.50 1.75	

PERFORATION RECORD		Acid, Fracture, Shot, Cement Squeeze Record	
shots per foot	specify footage of each interval perforated	(amount and kind of material used)	Depth

TUBING RECORD			Liner Run <input type="checkbox"/> Yes <input type="checkbox"/> No	
size	set at	packer at		

Date of First Production	Producing method <input type="checkbox"/> flowing <input type="checkbox"/> pumping <input type="checkbox"/> gas lift <input type="checkbox"/> Other (explain)				
	Oil	Gas	Water	Gas-Oil Ratio	Gravity
Estimated Production Per 24 Hours	Bbls	MCF	Bbls	CFFB	

Disposition of gas: vented sold used on lease

METHOD OF COMPLETION open hole perforation other (specify) _____

PRODUCTION INTERVAL Dually Completed. Commingled