

WELL PLUGGING RECORD

Give All Information Completely
Make Required Affidavit
Mail or Deliver Report to:
Conservation Division
State Corporation Commission
211 No. Broadway
Wichita, Kansas

Barton County, Sec. 4 Twp. 20 Rge. 13 (E) W (W)

Location as "NE/CNW/SW" or footage from lines SW SW SE
Lease Owner Petroleum, Inc.
Lease Name Service Oil Co. Well No. 1
Office Address Route 2, Great Bend, Kansas
Character of Well (completed as Oil, Gas or Dry Hole) Oil
Date well completed September 7 19 55
Application for plugging filed August 18 19 58
Application for plugging approved August 19 19 58
Plugging commenced August 21 19 58
Plugging completed August 27 19 58
Reason for abandonment of well or producing formation Depletion of producible zones

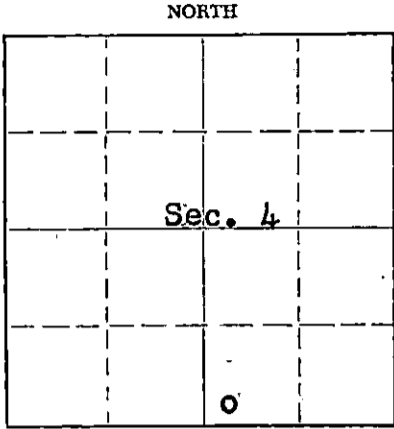

Locate well correctly on above Section Plat

If a producing well is abandoned, date of last production April 13 19 58
Was permission obtained from the Conservation Division or its agents before plugging was commenced? Yes

Name of Conservation Agent who supervised plugging of this well Donald Truan
Producing formation Kansas City Depth to top 3192' Bottom --- Total Depth of Well 3497 Feet
Show depth and thickness of all water, oil and gas formations.

OIL, GAS OR WATER RECORDS

CASING RECORD

FORMATION	CONTENT	FROM	TO	SIZE	PUT IN	PULLED OUT
				8 5/8"	230'	none
				4 1/2"	3446'	2800'
Kansas City	Little oil & water	3318'	3322'			
		3338'	3344'			

Describe in detail the manner in which the well was plugged, indicating where the mud fluid was placed and the method or methods used in introducing it into the hole. If cement or other plugs were used, state the character of same and depth placed, from _____ feet to _____ feet for each plug set.

(Plugged back to 3375')

Filled hole with crushed rock from 3375' to 3300'. Placed 5 sacks cement on top of rock. Globe Oil Well Cementing Co. pumped in 20 sacks gel and 100 sacks cement to base of well cellar.

RECEIVED
STATE CORPORATION COMMISSION

SEP 9 1958

CONSERVATION DIVISION

9-9-58

(If additional description is necessary, use BACK of this sheet)

Name of Plugging Contractor Morgan Well Plugging Service
Address 102 W. 18th Street, Hutchinson, Kansas

STATE OF Kansas COUNTY OF Barton ss.
Don Searle (employee of owner) or (MEMBER) of the above-described

well, being first duly sworn on oath, says: That I have knowledge of the facts, statements, and matters herein contained and the log of the above-described well as filed and that the same are true and correct. So help me God.

(Signature) Don Searle
Route 2, Great Bend, Kansas
(Address)

SUBSCRIBED AND SWORN to before me this 3rd day of September, 19 58

My commission expires July 11, 1960
Jed T. Brown Notary Public.

PLUGGING
FILE SEC A. T. 20 R 13W
BOOK PAGE 124 LINE 5

WELL LOG

15.009.15910.0000

COMPANY Petroleum, Inc.

SEC. 4 T. 20S R. 13W

FARM SERVICE OIL COMPANY NO. 1

LOC. SW SW SE
88' FSL
2459' FEL

TOTAL DEPTH 3497'

COUNTY Barton

COMM. August 17, 1955 COMP. September 1, 1955

CONTRACTOR Garvey Drilling Company

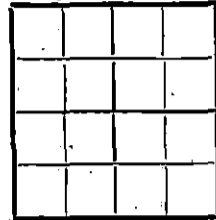

CASING 8-5/8" @ 252' w/175 sax
4-1/2" @ 3446' w/90 sax

ELEVATION 1856' DF
1858' KB

PRODUCTION Conglomerate

FIGURES INDICATE BOTTOM OF FORMATIONS

100	Sand
252	Sand & Shale
270	Sand
400	Red Bed
560	Sand
720	Red Bed & Shale
745	Anhydrite
1200	Shale & Shells
1560	Shale & Lime
1800	Lime
1865	Lime & Shale
2410	Broken Lime
2775	Lime & Shale
2838	Shale & Lime Streaks
2905	Lime & Shale
3395	Lime
3435	Lime & Conglomerate
3497	Conglomerate & Chert R.T.D. 3497'

Geological Tops

Heebner:	3065 (-1207)
Douglas:	3100 (-1242)
Brown Lime:	3180 (-1322)
Lansing:	3193 (-1335)
Conglomerate:	3420 (-1562)

PLUGGING

FILE SEC. 4 T. 20 R. 13W
BOOK PAGE 124 LINE 5

RECEIVED
STATE COMMISSION

SEP 9 1958

DIVISION

State of KANSAS }
County of SEDGWICK } SS:

I, Karl E. Becker of Petroleum, Inc.

upon oath state that the above and foregoing is a true and correct copy of the log of the SERVICE OIL CO. #1 well

Karl E. Becker

Subscribed and sworn to before me this 9th day of September 19 55

My Commission Expires: August 8, 1959

Alton Morrison
NOTARY PUBLIC