

STATE OF KANSAS
STATE CORPORATION COMMISSION

WELL PLUGGING RECORD

Give All Information Completely
Mails Required Affidavit
Mail or Deliver Report to:
Conservation Division
State Corporation Commission
800 Bitting Building
Wichita, Kansas

OR
FORMATION PLUGGING RECORD

Strike out upper line
when reporting plug-
ging of formations.

Barton County, Sec 35 Twp 20S Rge (E) 13 (W)
Location as "NE1/4NW1/4SW1/4" or footage from lines 330' from South & East lines
Lease Owner Skelly Oil Company
Lease Name A. Dohrman Well No. 1
Office Address Box 1650, Tulsa, Oklahoma
Character of Well (completed as Oil, Gas or Dry Hole) Dry Hole
Date well completed September 23, 19 48
Application for plugging filed September 24, 19 48
Application for plugging approved September 25, 19 48
Plugging commenced September 23, 19 48
Plugging completed September 23, 19 48
Reason for abandonment of well or producing formation Dry

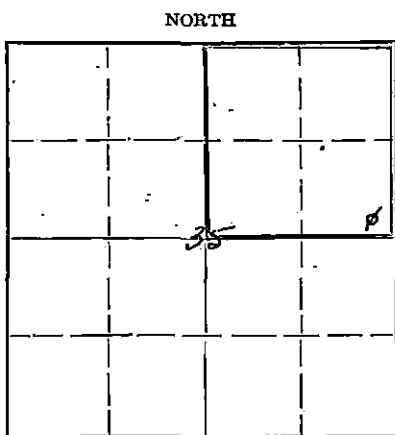

Locate well correctly on above
Section Plat

Name of Conservation Agent who supervised plugging of this well C. D. Stough
Producing formation Depth to top Bottom Total Depth of Well 3621 Feet
Show depth and thickness of all water, oil and gas formations.

OIL, GAS OR WATER RECORDS

CASING RECORD

Formation	Content	From	To	Size	Put In	Pulled Out
Lansing Lime	Dry	3244	3322	9"OD	502'	None
Simpson Shale	"	3582	3593			
Arbuckle Lime	"	3618	3621			

Describe in detail the manner in which the well was plugged, indicating where the mud fluid was placed and the method or methods used in introducing it into the hole. If cement or other plugs were used, state the character of same and depth placed, from _____ feet to _____ feet for each plug set.

20 sacks cement from 3621 to 3522
Mud laden fluid from 3522 to 3320
30 sacks cement from 3320 to 3221
Mud laden fluid from 3221 to 200
Halliburton plug set at 200
20 sacks cement from 200 to 135
Mud laden fluid from 135 to 40
10 sacks cement from 40 to 6
Surface soil from

RECEIVED

COMPTON

DEC 23 1948

STATE CORPORATION
COMMISSION
KANSAS

(If additional description is necessary, use BACK of this sheet)

Correspondence regarding this well should be addressed to Skelly Oil Company
Address Box 391, Hutchinson, Kansas

STATE OF Kansas, COUNTY OF Reno, ss.
H. E. Wamsley (employee of owner) or (owner) of the above-described well,
being first duly sworn on oath, says: That I have knowledge of the facts, statements, and matters herein contained and the log of the above-described well as filed and that the same are true and correct. So help me God.

(Signature)

Box 391, Hutchinson, Kansas
(Address)

SUBSCRIBED AND SWORN TO before me this 22nd day of December, 19 48

My commission expires April 7, 1951

Josephine L. Johnson
Notary Public.

SKELLY OIL COMPANY

NORTH		EAST	
SOUTH		WEST	

Lease Name and No. A. DUBOIS 13501 Well No. 1 Elev. 1237
 Lease Description 1/2 Section 35-30-23A Barton County, Kansas

Location made Sept 25, 1940 by G. A. Richter
530 feet from North line 530 feet from East line 12 1/4
530 feet from South line 530 feet from West line of Section 35

Work com'd Sept 3, 1940 Rig com'd Sept 3, 1940 Drig. com'd Sept 3, 1940 Drig. com'd Sept 23, 1940

Rig Contractor Claude Northworth Drilling Co.
 Drilling Contractor Claude Northworth Drilling Co., Tulsa, Oklahoma

Rotary Drilling from 0 to 3221 Cable Tool Drilling from to
 Commenced Producing Dry Hole 19

Dry Gas Well Press. Volume Cu. ft.
 Casing Head Gas Pressure Volume Cu. ft.
 Braden Head (Size) Gas Pressure Volume Cu. ft.
 Braden Head (Size) Gas Pressure Volume Cu. ft.

PRODUCING FORMATION (Name) Top Bottom TOTAL DEPTH

CASING RECORD

Size	Wt.	Thds.	Where Set	PULLED OUT			LEFT IN			KIND	Cond'n	CEMENTING	
				Jts.	Feet	In.	Jts.	Feet	In.			Sacks Used	Method Employed
40	13	437					12	302	4-5 3/4	1	370	Ballston	
(970 on line set 5 is collar)													

Liner Set at Length Perforated at
 Liner Set at Length Perforated at
 Packer Set at Size and Kind
 Packer Set at Size and Kind

SHOT OR ACID TREATMENT RECORD

Date	FIRST		SECOND		THIRD		FOURTH	
	Gals. Qts.	Ft. and Ft.	Gals. Qts.	Ft. and Ft.	Gals. Qts.	Ft. and Ft.	Gals. Qts.	Ft. and Ft.

SIGNIFICANT GEOLOGICAL FORMATIONS

NAME	Top	Bottom	GAS		OIL		REMARKS
			From	To	From	To	
Pepper Shale	3115						
Tender Line	3244				3274	3290	light oil stain, poor porosity
					3317	3302	oil, quantity & oil stain
							oil quantity & oil stain w/ gas
							black oil saturation
					3310	3313	poor porosity w/ black oil stain
					3315	3321	trace of black asphaltic oil stain

CLEANING OUT RECORDS

	DATE COMMENCED	DATE COMPLETED	PROD. BEFORE	PROD. AFTER	REMARKS
1st					See Reverse for other details.
2nd					" " " " " "
3rd					" " " " " "
4th					" " " " " "

PLUGGING BACK AND DEEPENING RECORDS

	Date Commenced	Date Completed	No. Feet Plugged Back or Deepened	Prod. Before	Prod. After	REMARKS
1st						See Reverse for other details.
2nd						" " " " " "
3rd						" " " " " "
4th						" " " " " "

(See Reverse for Record of Formation)

