

STATE CORPORATION COMMISSION OF KANSAS  
OIL & GAS CONSERVATION DIVISION  
WELL COMPLETION OR RECOMPLETION FORM  
ACO-1 WELL HISTORY  
DESCRIPTION OF WELL AND LEASE

API NO. 15-135-23,282-0000  
County ~~McPherson~~ **Ness**  
NE NE SE 5 20 23 East  
..... Sec..... Twp..... Rge..... X West

Operator: License # 5663  
Name Hess Oil Company  
Address P.O. Box 1009  
City/State/Zip McPherson, KS 67460

2310 Ft North from Southeast Corner of Section  
330 Ft West from Southeast Corner of Section  
(Note: Locate well in section plat below)

Purchaser.....

Lease Name Stum Well # 1

Operator Contact Person Bryan Hess  
Phone 316-241-4640

Field Name.....

Producing Formation.....

Contractor: License # 4958  
Name Mallard JV, Inc.

Elevation: Ground 2296' KB 2304'

Wellsite Geologist James C. Hess  
Phone 316-263-2243

RECEIVED  
STATE CORPORATION COMMISSION  
OCT 13 1988  
CONSERVATION DIVISION  
Wichita, Kansas

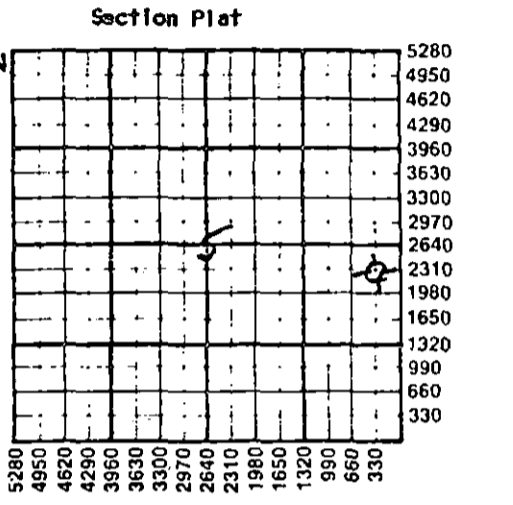

Designate Type of Completion  
 New Well  Re-Entry  Workover  
 Off  SWD  Temp Abd  
 Gas  Inj  Delayed Comp.  
 Dry  Other (Core, Water Supply etc.)

If OWO: old well info as follows:  
Operator.....  
Well Name.....  
Comp. Date..... Old Total Depth.....

WATER SUPPLY INFORMATION  
Disposition of Produced Water: \_\_\_\_\_ Disposal  
Docket # ..... \_\_\_\_\_ Repressuring

WELL HISTORY  
Drilling Method:  
 Mud Rotary  Air Rotary  Cable  
..9-21-88... ..9-27-88... ..9-27-88...  
Spud Date Date Reached TD Completion Date  
..4440'.....  
Total Depth PBTD

Questions on this portion of the ACO-1 call:  
Water Resources Board (913) 296-3717  
Source of Water:  
Division of Water Resources Permit #.....  
 Groundwater.....Ft North from Southeast Corner  
(Well) .....Ft West from Southeast Corner of  
Sec Twp Rge East West  
 Surface Water.....Ft North from Southeast Corner  
(Stream, pond etc).....Ft West from Southeast Corner  
Sec Twp Rge East West  
 Other (explain) Hauled by Fritzier Trucking  
(purchased from city, R.W.D. #)

Amount of Surface Pipe Set and Cemented at 225 feet  
Multiple Stage Cementing Collar Used?  Yes  No  
If yes, show depth set.....feet  
If alternate 2 completion, cement circulated  
from.....feet depth to.....w/.....SX cmt  
Cement Company Name.....  
Invoice # .....  
*Air II O&G*

INSTRUCTIONS: This form shall be completed in triplicate and filed with the Kansas Corporation Commission, 200 Colorado Derby Building, Wichita, Kansas 67202, within 120 days of the spud date of any well. Rule 82-3-130, 82-3-107 and 82-3-106 apply. Information on side two of this form will be held confidential for a period of 12 months if requested in writing and submitted with the form. See rule 82-3-107 for confidentiality in excess of 12 months. One copy of all wireline logs and drillers time log shall be attached with this form. Submit CP-4 form with all plugged wells. Submit CP-111 form with all temporarily abandoned wells.

All requirements of the statutes, rules and regulations promulgated to regulate the oil and gas industry have been fully complied with and the statements herein are complete and correct to the best of my knowledge.

Signature *Bryan Hess*  
Bryan Hess  
Title Mgr. Date 10-5-88

Subscribed and sworn to before me this 12 day of October 1988.  
Notary Public *Don J. Reichberger*  
Date Commission Expires 11-15-89

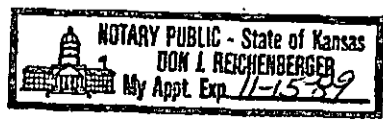

K.C.C. OFFICE USE ONLY  
F  Letter of Confidentiality Attached  
C  Wireline Log Received  
C  Drillers Time log Received  
Distribution  
 KCC  SWD/Rep  NGPA  
 KGS  Plug  Other  
(Specify)  
10-13-88  
Form ACO-1 (5-86)

Sec. 5, Twp. 20, Rge. 23

SIDE TWO

Operator Name Hess Oil Company Lease Name Stum Well # 1  
 Sec. 5 Twp. 20 Rge. 23  East  West County Ness

WELL LOG

INSTRUCTIONS: Show important tops and base of formations penetrated. Detail all cores. Report all drill stem tests giving interval tested, time tool open and closed, flowing and shut-in pressures, whether shut-in pressure reached static level, hydrostatic pressures, bottom hole temperature, fluid recovery, and flow rates if gas to surface during test. Attach extra sheet if more space is needed. Attach copy of log.

Drill Stem Tests Taken  Yes  No  
 Samples Sent to Geological Survey  Yes  No  
 Cores Taken  Yes  No

Formation Description  
 Log  Sample

Name	Top	Bottom
Anhydrite	1546'	1584'
Heebner	3728	
Lansing	3776	
Base Kansas City		4128
Pawnee	4215	
Fort Scott	4298	
Cherokee Shale	4326	
Miss. Dolomite	4410	
R.T.D.		4440

CASING RECORD <input type="checkbox"/> New <input checked="" type="checkbox"/> Used							
Report all strings set-conductor, surface, intermediate, production, etc.							
Purpose of String	Size Hole Drilled	Size Casing Set (In O.D.)	Weight Lbs/Ft.	Setting Depth	Type of Cement	#Sacks Used	Type and Percent Additives
Surface	12 1/2"	8-5/8"	32	225'	60/40Poz	140	2%gel, 3%cc

PERFORATION RECORD		Acid, Fracture, Shot, Cement Squeeze Record	
Shots Per Foot	Specify Footage of Each Interval Perforated	(Amount and Kind of Material Used)	Depth

TUBING RECORD	Size	Set At	Packer at	Liner Run <input type="checkbox"/> Yes <input type="checkbox"/> No

Date of First Production	Producing Method				
	<input type="checkbox"/> Flowing <input type="checkbox"/> Pumping <input type="checkbox"/> Gas Lift <input type="checkbox"/> Other (explain).....				
Estimated Production Per 24 Hours	Oil	Gas	Water	Gas-Oil Ratio	Gravity
	Bbls	MCF	Bbls	CFPB	

METHOD OF COMPLETION

Production Interval

Disposition of gas:  Vented  Open Hole  Perforation  
 Sold  Other (Specify) .....  
 Used on Lease  Dually Completed .....  
 Commingled .....

Mallard JV, Inc.  
P.O. Box 1009  
McPherson, KS 67460

DRILLERS' LOG

OPERATOR: Hess Oil Company  
P.O. Box 1009  
McPherson, KS 67460

WELL: Stum #1  
API#: 15-135-23,282

COMMENCED: September 21, 1988

LOCATION: NE NE SE  
2310 Ft. FSL, 330 Ft. FEL

COMPLETED: September 27, 1988

Sec. 5 Twp. 20 S Rge. 23 W

TOTAL DEPTH: 4440 Ft.

COUNTY: Ness

ELEVATION: 2296 Ft. G.L.

2304 Ft. K.B.

\*\*\*\*\*RECEIVED STATE CORPORATION COMMISSION\*\*\*\*\*

OCT 13 1988

CONSERVATION DIVISION  
Wichita, Kansas

<u>FORMATION</u>	<u>FROM</u>	<u>TO</u>
Surface	0'	227'
Shale	227	995
Cedar Hills	995	1197
Shale	1197	1526
Anhydrite	1526	1564
Shale	1564	2444
Shale, Lime	2444	4440 R.T.D. Mississippi

REMARKS

Cut 12 1/4" hole to 227' and ran 7 joints 8-5/8" x 32# x 216' surface casing. Set at 225' and cemented with 140 sx 60/40 Pozmix, 2% gel, 3% cc. Cement did circulate. P.D. @ 10:15 p.m. 9-21-88.

Ran electric log.

Plugged hole with 205 sx 60/40 Pozmix, 6% gel as follows: 50 sx @ 1560', 180 sx @ 900', 40 sx @ 270', 10 sx @ 40' w/wiper plug, 15 sx R.H., 10 sx M.H. P.D. @ 6:30 p.m. 9-27-88.

\*\*\*\*\*

STATE OF KANSAS )  
                          ) SS:  
COUNTY OF McPHERSON)

I, BRYAN HESS of MALLARD DRILLING, do hereby certify that this is a true and correct copy of the log of the Stum #1 well as reflected by the files of Mallard Drilling.

*Bryan Hess*  
Bryan Hess, Gen. Mgr.

Subscribed and sworn to before me this 5th day of October, 1988.

11-15-89  
My Commission Expires

*Don J. Reichenberger*  
Notary Public

