

WELL PLUGGING RECORD

Give All Information Completely
Make Required Affidavit
M. or De. Report to:
Conservation Division
State Corporation Commission
800 Baring Building
Wichita, Kansas

Barton County. Sec. 26 Twp. 20 Rge. 13 (E) W (W)

Location as "NE/CNW/SW" or footage from lines NE SW SW
Lease Owner PETROLEUM, INC.
Lease Name DENBO Well No. 1
Office Address Route 2, Great Bend, Kansas
Character of Well (completed as Oil, Gas or Dry Hole) Dry Hole
Date well completed October 15, 1956
Application for plugging filed October 15, 1956
Application for plugging approved October 15, 1956
Plugging commenced October 15, 1956
Plugging completed October 15, 1956
Reason for abandonment of well or producing formation No Producing Zones

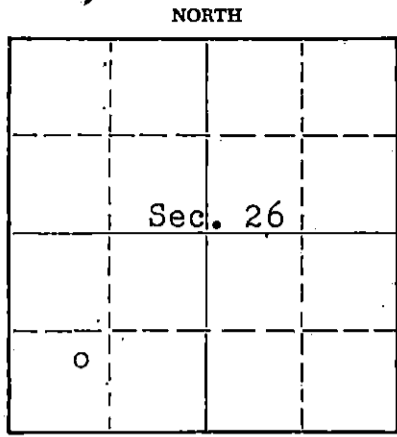

Locate well correctly on above Section Plat

If a producing well is abandoned, date of last production None 19__
Was permission obtained from the Conservation Division or its agents before plugging was commenced? Yes

Name of Conservation Agent who supervised plugging of this well R. M. Brundege Hoisington, Kansas
Producing formation ----- Depth to top ----- Bottom ----- Total Depth of Well 3600' Feet
Show depth and thickness of all water, oil and gas formations.

OIL, GAS OR WATER RECORDS

CASING RECORD

FORMATION	CONTENT	FROM	TO	SIZE	PUT IN	PULLED OUT
				8 5/8" OD	210'	None

Describe in detail the manner in which the well was plugged, indicating where the mud fluid was placed and the method or methods used in introducing it into the hole. If cement or other plugs were used, state the character of same and depth placed, from _____ feet to _____ feet for each plug set.

Mud up with heavy mud to 200' pushed down 1/4 sack hulls to 200' followed by wooden plug. Placed 20 sacks cement through dtill pipe on to plug. Mud up to 35' and placed 1/4 sack hulls at 35' followed by wooden plug and 10 sacks cement to base of well cellar.

(If additional description is necessary, use BACK of this sheet)

Name of Plugging Contractor Garvey Drilling Co.
Address _____

STATE OF KANSAS, COUNTY OF BARTON, ss.
Don Searle (employee of owner) or (~~owner or operator~~) of the above-described well, being first duly sworn on oath, says: That I have knowledge of the facts, statements, and matters herein contained and the log of the above-described well as filed and that the same are true and correct. So help me God.

(Signature) Don Searle
Route 2, Great Bend, Kansas
(Address)

SUBSCRIBED AND SWORN TO before me this 20th day of October, 1956

My commission expires July 11, 1960

Leda B. Brown
Notary Public.

RECEIVED
STATE CORPORATION COMMISSION

OCT 23 1956

CONSERVATION DIVISION
Wichita, Kansas

PLUGGING
FILE SEC 26 T. 20 R. 13 W
BOOK PAGE 107 LINE 38

WELL LOG

15.009.00674.0000

COMPANY **PETROLEUM, INCORPORATED**

SEC. 26 T. 20S R. 13W

FARM **Denbo**

NO. **1**

LOC. **NE, SW, SW**

TOTAL DEPTH **3600'**

COUNTY **Barton Co., Kansas**

COMM. **October 5, 1956**

COMP. **October 15, 1956**

CONTRACTOR **GARVEY DRILLING CO.**

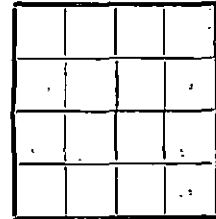

CASING **8 5/8" @ 210' W/200 sax.**

ELEVATION **1874' DF**

PRODUCTION **D & A**

FIGURES INDICATE BOTTOM OF FORMATIONS

120	Clay & sand	Anhydrite	725-755
130	Hard sand	Hebn.	3130
190	Yellow clay	Toronto	3154
305	Blue shale	B. L.	3252
735	Red bed	Lansing	3264
755	Anhydrite		
825	Shale		
1495	Red bed, shale & shells		
2565	Lime & shale		
2710	Lime		
2940	Lime & shale		
3018	Lime		
3264	Lime & shale		
3535	Lime		
3556	Cherty lime		
3600	Lime		
3600	T. D.		

State of KANSAS

County of BARTON

RECEIVED
PLUGGING
 FILE SEC. 26 T. 20 R. 13W
 BOOK PAGE 107 LINE 38

REGISTRATION COMMISSION
 DIVISION
 Wichita, Kansas

I, Verne A. Morris of Garvey Drilling Co.

upon oath state that the above and foregoing is a true and correct copy of the log of the #1 Denbo well

Verne A. Morris

Subscribed and sworn to before me this 18th day of October 19 56

My Commission Expires: November 12, 1958

Branchberry
NOTARY PUBLIC