

STATE OF KANSAS
STATE CORPORATION COMMISSION

Form CP-4

WELL PLUGGING RECORD

Give All Information Completely
Make Required Affidavit
Mail or Deliver Report to:
Conservation Division
State Corporation Commission
212 No. Market
Wichita, Kansas

RICE County. Sec. 26 Twp. 18S Rge. 9 (E) (W)

Location as "NE/CNW/SW" or footage from lines C NE NE
Lease Owner PETROLEUM, INC.,
Lease Name BRYANT "G" Well No. 1
Office Address R.R. #2, GREAT BEND, KANSAS
Character of Well (completed as Oil, Gas or Dry Hole) DRY HOLE
Date well completed JUNE 30 1966
Application for plugging filed JUNE 30 1966
Application for plugging approved JUNE 30 1966
Plugging commenced JUNE 30 1966
Plugging completed JUNE 30 1966
Reason for abandonment of well or producing formation NO PRODUCIBLE ZONE

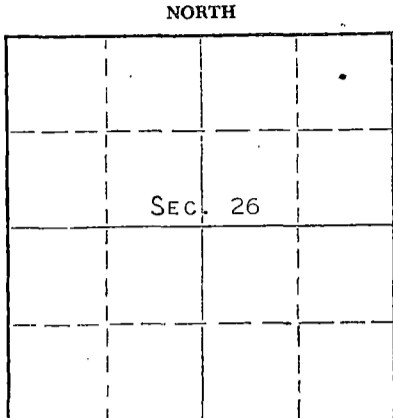

Locate well correctly on above Section Plat

If a producing well is abandoned, date of last production NONE 19
Was permission obtained from the Conservation Division or its agents before plugging was commenced? YES

Name of Conservation Agent who supervised plugging of this well HUGH SCOTT
Producing formation _____ Depth to top _____ Bottom _____ Total Depth of Well 2800' Feet
Show depth and thickness of all water, oil and gas formations.

OIL, GAS OR WATER RECORDS

CASING RECORD

FORMATION	CONTENT	FROM	TO	SIZE	PUT IN	PULLED OUT
				8-5/8"	250'	NONE

Describe in detail the manner in which the well was plugged, indicating where the mud fluid was placed and the method or methods used in introducing it into the hole. If cement or other plugs were used, state the character of same and depth placed, from _____ feet to _____ feet for each plug set.

MUDDED UP WITH HEAVY DRILLING MUD TO 240', FOLLOWED BY WOODEN PLUG, PLACED 1/4 SACK HULLS AND 20 SACKS CEMENT ON TOP OF PLUG. MUDDED UP WITH HEAVY DRILLING MUD TO 40' FOLLOWED BY WOODEN PLUG, PLACED 1/2 SACK HULLS AND 10 SACKS CEMENT ON TOP OF PLUG TO BASE OF WELL CELLAR.

RECEIVED
STATE CORPORATION COMMISSION
JUL 10 1966
7-18-1966

(If additional description is necessary, use BACK of this sheet)
Name of Plugging Contractor GARVEY DRILLING CO.
Address R.R. #2, GREAT BEND, KANSAS

STATE OF KANSAS COUNTY OF BARTON, ss.

LAWRENCE PROFFITT (employee of owner) or (owner/operator) of the above-described well, being first duly sworn on oath, says: That I have knowledge of the facts, statements, and matters herein contained and the log of the above-described well as filed and that the same are true and correct. So help me God. LAWRENCE PROFFITT, DIST. PROD. FOREMAN

(Signature) Lawrence Proffitt
R.R. #2, GREAT BEND, KANSAS
(Address)

SUBSCRIBED AND SWORN TO before me this 15 day of JULY, 19 66

My commission expires MAY 28, 1969
Richard W. Decker
Notary Public.

WELL LOG

COMPANY Petroleum, Inc.

SEC. 26 T. 18S R. 9W

FARM Bryant

NO. G-1

LOC. NE NE

TOTAL DEPTH 2800'

COUNTY Rice

COMM. 6-26-66

COMP. 6-30-66

CONTRACTOR Garvey Drilling Company

CASING 8 5/8" @ 250' w/175 sx

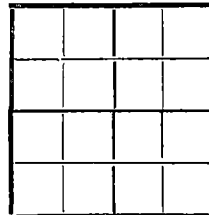

ELEVATION 1731' DF

PRODUCTION D & A

FIGURES INDICATE BOTTOM OF FORMATIONS

- 250' Shale
- 380' Shale and Shells
- 405' Anhydrite
- 650' Shale
- 1100' Red Bed and Shale
- 1960' Lime and Shale
- 2690' Shale and Lime
- 2800' Lime and Shale
- 2800' RTD

RECEIVED
 STATE CORPORATION COMMISSION
 JUL 18 1966
 CONSERVATION DIVISION
 WASHINGTON, KANSAS

State of Kansas }
 County of Barton } SS

I, Sam N. Stephens of Garvey Drilling Company

upon oath state the above and foregoing is a true and correct copy of the log of the Bryant G-1 well.

Sam N. Stephens

Subscribed and sworn to before me this 13th day of July 19 66

My Commission Expires: May 28, 1969

Richard H. Dumble
 NOTARY PUBLIC