

For KCC Use: 9-8-03
Effective Date: 9-8-03
District # 1
SGA? Yes No

KANSAS CORPORATION COMMISSION
OIL & GAS CONSERVATION DIVISION

^{first}
CORRECTED Form C-1
September 1999
Form must be Typed
Form must be Signed
All blanks must be Filled

NOTICE OF INTENT TO DRILL

SEP 02 2003

Must be approved by the K.C.C. five (5) days prior to commencing well

KCC WICHITA

Expected Spud Date SEPTEMBER 8 2003
month day year

Spot East West
SW - SE Sec 25 Twp 30 S, Rg 20
660 feet from SOUTH Line of Section
1980 feet from EAST Line of Section

OPERATOR: License # 3842
LARSON OPERATING COMPANY
A DIVISION OF LARSON ENGINEERING, INC.
Name: _____
Address: 562 WEST HIGHWAY 4
City/State/Zip: OLMITZ, KS 67564-8561
Contact Person: TOM LARSON
Phone: (620) 653-7368

Is SECTION X Regular _____ Irregular? _____
(Note: Locate well on the Section Plat on Reverse Side)

CONTRACTOR: License # 5929
Name: DUKE DRILLING CO., INC.

County: KIOWA
Lease Name: LIGGETT Well #: 1-25
Field Name: W/C

Is this a Prorated / Spaced Field? Yes No

Target Formation(s): MISSISSIPPI

Nearest Lease or unit boundary: 660'

Ground Surface Elevation: 2161' feet MSL

Water well within one-quarter mile: Yes No

Public water supply well within one mile: Yes No

Depth to bottom of fresh water: 150

Depth to bottom of usable water: 200

Surface Pipe by Alternate: X 1 _____ 2 _____

Length of Surface Pipe Planned to be set: 600

Length of Conductor pipe required: NONE

Projected Total Depth: 5200

Formation at Total Depth: MISSISSIPPI

Water Source for Drilling Operations:

Well _____ Farm Pond _____ Other X

DWR Permit #: _____ (Note: Apply for Permit with DWR)

Will Cores Be Taken? Yes No

If yes, proposed zone: _____

Well Drilled For: Oil Gas OWWO Seismic; Other
 Enh Rec Storage Disposal # of Holes _____
Well Class: Infield Pool Ext. Wildcat Other
Type Equipment: Mud Rotary Air Rotary Cable

If OWWO: old well information as follows:

Operator: _____
Well Name: _____
Original Completion Date: _____ Original Total Depth: _____

Directional, Deviated or Horizontal wellbore? Yes No

If yes, true vertical depth: _____

Bottom Hole Location: _____

KCC DKT#: _____

AFFIDAVIT *WAS: 15-097-21732-00-00

The undersigned hereby affirms that the drilling, completion and eventual plugging of this well will comply with K.S.A. 55-101, et. seq.

It is agreed that the following minimum requirements will be met:

1. Notify the appropriate district office **prior** to spudding of well;
2. A copy of the approved Notice of Intent to Drill **shall be** posted on each drilling rig;
3. The **minimum amount of surface pipe as specified below shall be set** by circulating cement to the top; in all cases surface pipe **shall be set** through all unconsolidated materials plus a minimum of 20 feet into the underlying formation;
4. If the well is a dry hole, an agreement between the operator and the district office on plug length and placement is necessary **prior to plugging**;
5. The appropriate district office will be notified before well is either plugged or production casing is cemented in;
6. If an ALTERNATE II COMPLETION, production pipe shall be cemented from below any usable water to surface within **120 days** of spud date. **In all cases, NOTIFY district office** prior to any cementing.

IS: 15.097.21520.00-00

I hereby certify that the statements made herein are true and to the best of my knowledge and belief.

Date: 08/28/2003 Signature of Operator or Agent: Carol Lan Title: SECRETARY/TREASURER

For KCC use ONLY

API # 15 - 097-21520-0000

Conductor pipe required None feet

Minimum surface pipe required 220 feet per Alt 1

Approved by: RSP 9-3-03 / 9-5-04

This authorization expires: 3-3-04

(This authorization void if drilling not started within 6 months of effective date.)

Spud date: _____ Agent: _____

Remember to:

- File Drill-Pit Application (Form CDP-1) with Intent to Drill;
- File Completion Form ACO-1 within 120 days of spud date;
- File acreage attribution plat according to field proration orders;
- Notify appropriate district office 48 hours prior to workover or re-entry;
- Submit plugging report (CP-4) after plugging is completed;
- Obtain written approval before disposing or injecting salt water.

25
30
2004

IN ALL CASES PLOT THE INTENDED WELL ON THE PLAT BELOW

Plat of Acreage attributable to a well in a prorated or spaced field

If the intended well is in a prorated or spaced field, please fully complete this side of the form. If the intended well is in a prorated or spaced field complete the plat below showing that the well will be properly located in relationship to other wells producing from the common source of supply. Please show all the wells and within 1 mile of the boundaries of the proposed acreage attribution unit for gas wells and within 1/2 mile of the boundaries of the proposed acreage attribution unit for oil wells.

API No. 15 - _____

LARSON OPERATING COMPANY

Operator: A DIVISION OF LARSON ENGINEERING, INC. _____

Lease: LIGGETT _____

Well Number: 1-25 _____

Field: _____

Number of Acres attributable to well: _____

QTR / QTR / QTR of acreage: _____ - _____ - _____

Location of Well: County: KIOWA _____

_____ 660 _____ feet from SOUTH Line of Section

_____ 1980 _____ feet from EAST Line of Section

Sec. 25 Twp. 30 S. R. 20 East West

Is Section _____ Regular or _____ Irregular

If Section is Irregular, locate well from nearest corner boundary.

Section corner used: _____ NE _____ NW _____ SE _____ SW

PLAT

(Show location of the well and shade attributable acreage for prorated or spaced wells.)

(Show footage to the nearest lease or unit boundary line.)

KIOWA CO.

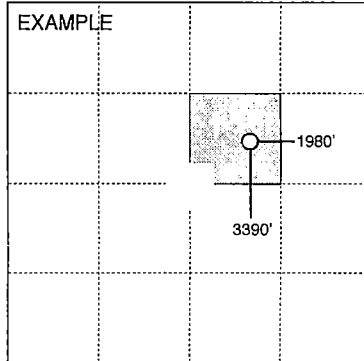
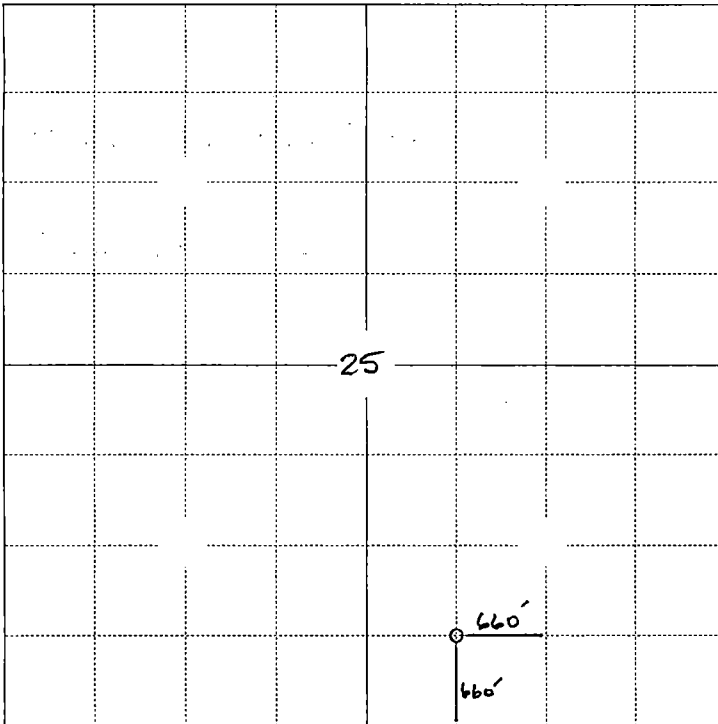

SEWARD CO.

NOTE: In all cases locate the spot of the proposed drilling location.

In plotting the proposed location of the well, you must show:

1. The manner in which you are using the depicted plat by identifying section lines, i.e. 1 section, 1 section with 8 surrounding sections, 4 sections, etc.
2. The distance of the proposed drilling location from the section's south / north and east / west.
3. The distance to the nearest lease or unit boundary line.
4. If proposed location is located within a prorated or spaced field a certificate of acreage attribution plat must be attached: (CO-7 for oil wells; CG-8 for gas wells).