

EFFECTIVE DATE: 8-24-91

State of Kansas

DISTRICT # 1

NOTICE OF INTENTION TO DRILL

SEAT... Yes No

Must be approved by the K.C.C. five (5) days prior to commencing well

Expected Spud Date ... September 15, 1991
month day year

Spot 90' south & 10' east of: East
NW SW SE Sec 14 Twp 31 S. Rg 32 West

OPERATOR: License # 03908
Name: Parker & Parsley Development Company
Address: 9400N. Broadway Suite 640
City/State/Zip: Oklahoma City, OK 73114
Contact Person: Mike Stafford
Phone: 405-478-4914

..... 900 feet from South / North line of Section
..... 2300 feet from East / West line of Section
IS SECTION X REGULAR _____ IRRREGULAR? _____

(NOTE: Locate well on the Section Plat on Reverse Side)
County: Seward

CONTRACTOR: License #: _____
Name: Will specify on ACQ1

Lease Name: Clark Well #: 1A
Field Name: Unnamed

Well Drilled For: Well Class: Type Equipment:

- ... Oil ... Enh Res ... Infield .X Mud Rotary
- X Gas ... Storage X Pool Ext. ... Air Rotary
- ... OWM ... Disposal ... Wildcat ... Cable
- ... Seismic; ... # of Holes ... Other
- ... Other

Is this a Prorated/Spaced Field? ... yes .X. no
Target Formation(s): Morrow

If OWM: old well information as follows:

Nearest lease or unit boundary: 900
Ground Surface Elevation: 2847 feet MSL

Operator: N/A
Well Name: _____
Comp. Date: _____ Old Total Depth _____

Water well within one-quarter mile: ... yes .X. no
Public water supply well within one mile: ... yes .X. no

Directional, Deviated or Horizontal wellbore? ... yes .X. no

Depth to bottom of fresh water: 505'
Depth to bottom of usable water: 550'

If yes, true vertical depth: n/a

Surface Pipe by Alternate: .X. 1 ... 2
Length of Surface Pipe Planned to be set: 1700'

Bottom Hole Location: n/a

Length of Conductor pipe required: 0
Projected Total Depth: 5550'

Formation at Total Depth: Chester
Water Source for Drilling Operations:

... well ... farm pond .X. other
DWR Permit #: n/a

Will Cores Be Taken? ... yes .X. no
If yes, proposed zone: n/a

AFFIDAVIT

The undersigned hereby affirms that the drilling, completion and eventual plugging of this well will comply with K.S.A. 55-101, et. seq.

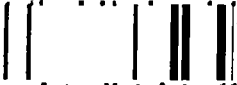

6. IF AN ALTERNATE IS COMPLETION, PRODUCTION PIPE SHALL BE CEMENTED FROM BELOW ANY USABLE WATER TO SURFACE WITHIN 120 DAYS OF SPUD DATE. IN ALL CASES, NOTIFY DISTRICT OFFICE PRIOR TO ANY CEMENTING.

I hereby certify that the statements made herein are true and to the best of my knowledge and belief.

Date: 8/16/91 Signature of Operator or Agent: Mike Stafford Title: Sr. Operations Engineer

FOR KCC USE:
 API # 15- 175-2195-0000
 Conductor pipe required None feet
 Minimum surface pipe required 550 feet per Alt. ①
 Approved by: MWS 8-19-91

This authorization expires: 2-19-92
 (This authorization void if drilling not started within 6 months of effective date.)
 Spud date: _____ Agent: _____

RECEIVED
STATE CORPORATION COMMISSION

AUG 19 1991

Conservation Division
Wichita, Kansas

REMEMBER TO:

- File Drill Pit Application (form CDP-1) with Intent to Drill;
- File Completion Form ACQ-1 within 120 days of spud date;
- File acreage attribution plat according to field proration orders;
- Notify appropriate district office 48 hours prior to workover or re-entry;
- Submit plugging report (CP-4) after plugging is completed;
- Obtain written approval before disposing or injecting salt water.

Mail to: Conservation Division, 200 Colorado Derby Building, 202 W. First St., Wichita, Kansas 67202-1286.

14
31
324

IN ALL CASES PLOT THE INTENDED WELL ON THE PLAT BELOW

PLAT OF ACREAGE ATTRIBUTABLE TO A WELL IN A PRORATED OR SPACED FIELD

If the intended well is in a prorated or spaced field, please fully complete this side of the form. If the intended well is in a prorated or spaced field complete the plat below showing that the well will be properly located in relationship to other wells producing from the common source of supply. Please show all the wells within 1 mile of the boundaries of the proposed acreage attribution unit for gas wells and within 1/2 mile of the boundaries of the proposed acreage attribution unit for oil wells.

API NO. 15- _____
 OPERATOR Parker & Parsley Development Co
 LEASE Clark
 WELL NUMBER #1A
 FIELD unnamed

LOCATION OF WELL: COUNTY Seward
900 feet from south north line of section
2300 feet from east west line of section
 SECTION 14 TWP 31 S RG 32 W

NUMBER OF ACRES ATTRIBUTABLE TO WELL _____
 QTR/QTR/QTR OF ACREAGE _____

IS SECTION X REGULAR or _____ IRREGULAR
 IF SECTION IS IRREGULAR, LOCATE WELL FROM NEAREST
 CORNER BOUNDARY.

Section corner used: _____ NE _____ NW _____ SE _____ SW

PLAT

(Show location of the well and shade attributable acreage for prorated or spaced wells.)
 (Show footage to the nearest lease or unit boundary line.)

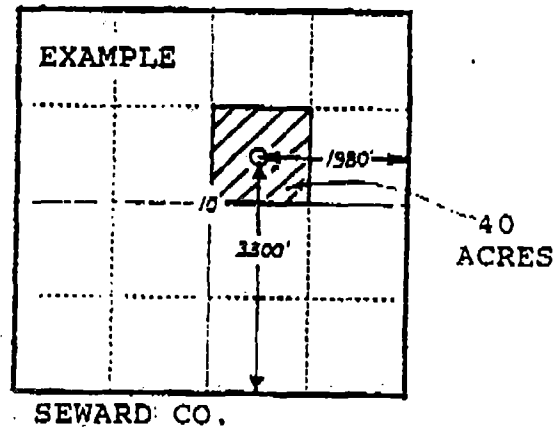
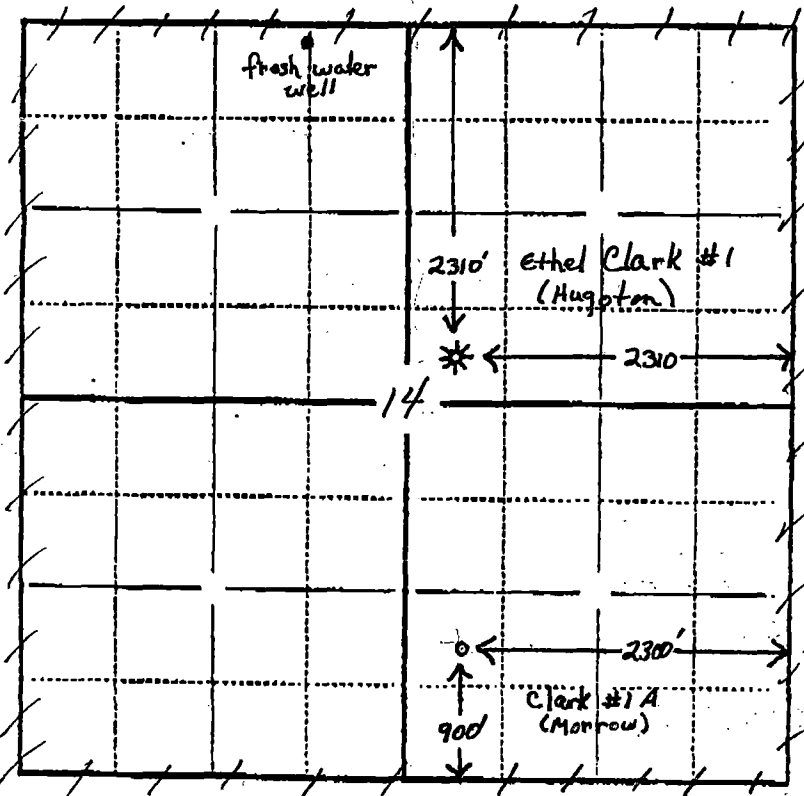

In plotting the proposed location of the well, you must show:

- 1) The manner in which you are using the depicted plat by identifying section lines, i.e. 1 section, 1 section with 8 surrounding sections, 4 sections, etc.;
- 2) the distance of the proposed drilling location from the section's south/north and east/west lines; and
- 3) the distance to the nearest lease or unit boundary line.