

KCC Dist #1

ONROKE NGL Pipeline LLC

CD-16MDS
99976
KCC WICHITA

KGS-13

KCC API #

KCC License 33659

MP 92 #1

15-097-21785000

20' FSL, 2766 FEL 26-T275-1220W

FEB 19 2014

BIG BEND GROUNDWATER MANAGEMENT DISTRICT NO. 5

RECEIVED

125 S. Main
Stafford, Kansas 67578
(620) 234-5352 Fax (620) 234-5718

RECEIVED

**FORM CP-10
APPLICATION FOR PERMIT TO DRILL AND CONSTRUCT
A CASED CATHODIC PROTECTION BOREHOLE
Referencing Kansas Corporation Commission Regulations
K.A.R. 82-3-700 through K.A.R. 82-3-710**

FEB 12 2014

Big Bend GMD #5

Permit Application Number CPB-14-01

To the Big Bend Groundwater Management District No. 5:

Applicant: ONEOK NGL PIPELINE, L.L.C. KCC Lic #33659

Address: P.O. BOX 29 MEDFORD OK 73759-0029
(P.O. Box or Street) (City) (State) (Zip Code)

Telephone: (620) 834-2211
(Area Code) (Telephone)

Application to the Big Bend Groundwater Management District No. 5 for a permit to drill and construct a cathodic protection borehole in and through the Big Bend aquifer in the county of Kiowa state of Kansas, to the extent and in accordance with the following:

- The location of the proposed cathodic protection borehole is in the NW quarter of the NW quarter of the NE quarter of Section 26, Township 27 south, Range 20 west and more particularly described as being near a point 20 feet north and 2,766 feet west of the apparent southeast corner of said section.
- The proposed use of the cathodic protection borehole is to provide cathodic protection of the applicant's NGL PIPELINE facility from electrochemical corrosion.
- The land surface elevation is 2,291 feet above mean sea level and the method of measurement used was (a) surveyed, (b) topographic map or (c) other DOLAR CALCULATED VALUE.
- The depth to surface or top of bedrock or shale is 147 feet below land surface (bls).
- The depth to the water table of the fresh water aquifer is 55 feet bls.
- Aquifer salinity as indicated by chloride concentration is 100 mg/L and was determined by: (a) published report, (b) test well data, or (c) other Water District 5 Manager
- The total depth of the cathodic protection borehole is 300 feet bls.
- A non metallic surface casing equipped with centralizers will be installed in the surface casing borehole when drilling has penetrated 167 feet bls, which is a minimum of 20 feet below bedrock or shale surface as listed in paragraph #4.
- Casing centralizers will be installed on the surface casing beginning at the surface casing's total depth and at 40 feet intervals along the complete length of the surface

casing at depths of 3, 40, 80, 100, 140, _____, _____, _____ feet bls.

- 10. The diameter of the surface casing borehole will be a minimum of six inches larger than the outside diameter of the surface casing. The diameter of the borehole containing the surface casing will be 14 inches and the outside diameter of the surface casing will be 8 inches.
- 11. The standard dimension ratio (SDR) of the surface casing calculated by dividing the surface casing's outside diameter (OD) of 8.625 inches by its minimum wall thickness (MWT) of 0.41 inches equals 21.04.
- 12. A pitless surface casing adapter will be installed in the surface casing 5 feet bls.
- 13. The annular space between the surface casing and the borehole will be grouted using: (a) cement, (b) neat cement, (c) bentonite clay grout, (d) bentonite cement or (e) other _____ from a total surface casing depth of 3 feet bls to 172 feet bls.
- 14. The top of the surface casing will be fitted with a watertight cap and will: (a) terminate _____ feet above land surface, (b) terminate in a water resistant and structurally sound vault _____ feet bls or (c) be buried 3 feet bls.
- 15. The anodes will be installed beginning at a depth of 177 feet bls to a total depth of 300 feet bls.
- 16. Anode conductor (backfill) material will be installed beginning at a depth of 172 feet bls to a total depth of 300 feet bls.
- 17. An anode vent pipe will be installed and completed 3 feet above land surface.
- 18. A concrete base or pad will / will not be constructed around the above ground surface casing or vault.
- 19. Will the use of a drilling pit threaten to contaminate fresh and usable groundwater?
 Yes No. If Yes complete sections (a) and (b).
 - (a) The pit will be: (i) constructed so that the bottom and sides have a hydraulic conductivity no greater than 1×10^{-7} cm/sec., (ii) constructed above ground, or (iii) a portable above ground tank, and
 - (b) The applicant has submitted a surface pond application to the Director, Conservation Division, Kansas Corporation Commission. Yes No.
- 20. Has the applicant filed a completed Form KSONA-1 and plat map with this application? Yes No.
- 21. Does the Form KSONA-1 indicate that the applicant has provided the surface owner with a copy of this application, including the Form KSONA-1 and plat map?
 Yes No.
- 22. A construction plan is submitted with the application and shows or illustrates the information contained in paragraphs #4 through #18.
- 23. The cathodic protection borehole will be abandoned and plugged if it: (a) is not completed due to unforeseen circumstances, (b) either contaminates or threatens to contaminate a fresh water aquifer, (c) encounters uncontrollable artesian flow, (d)

1509721785-0000

BIG BEND GROUNDWATER MANAGEMENT DISTRICT NO. 5 CATHODIC PROTECTION BOREHOLE ILLUSTRATION

Cased Borehole Construction Features (Refer to K.A.R. 82-3-708 for specific standards)

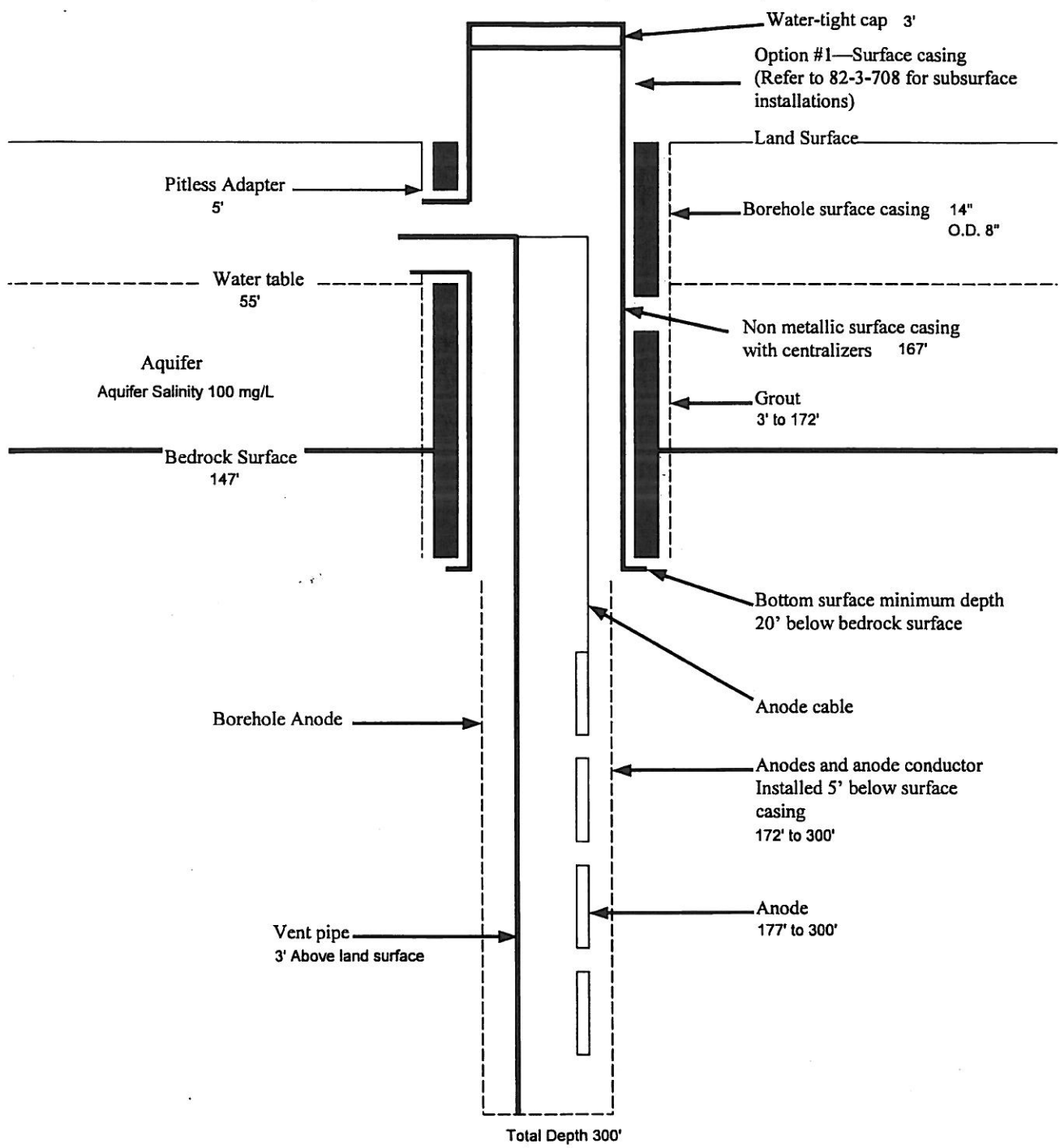

has exhausted its anodes and replacement anodes are not installed within one year, or (e) has not been used for one year and the applicant does not demonstrate intentions to use it.

24. The applicant understands and agrees to comply with K.A.R. 82-3-700 through 82-3-710. Further, the applicant may request an exception to these regulations pursuant to K.A.R. 82-3-100(b).

25. Dated at _____, Kansas, this 10th day of February, 2014

Wendy Berndt

(Applicant)

By 
(Signature)

Environmental Engineer, Pipelines

(Title)

APPLICANT DO NOT CONTINUE BELOW DOUBLE LINE
For Big Bend Groundwater Management District #5 Use

1) Application received on 02/12/14.

2) Application review by JOHN HILDEBRAND / ORRIN FERIL
CONSERVATION SPECIALIST / MANAGER
(Title)

3) The application is hereby denied. The denial was based on the following findings:

4) The application meets or exceeds Cathodic Regulations K.A.R. 82-3-700 through K.A.R. 82-3-710 and is hereby approved by the Big Bend Groundwater Management District No. 5 this 14th day of FEBRUARY, 20 14



Orrin Feril, Manager
Big Bend Groundwater Management District No. 5

IN ALL CASES, PLEASE FULLY COMPLETE THIS FORM.

Operator: ONEOK NGL PIPELINE, L.L.C.
Facility Name: MP 92
Borehole Number: 1

Location of Well: 20 feet from N / S Line of Section
2,514 feet from E / W Line of Section
Sec. 26 Twp. 27 S Rng. 20 E W

Is Section: Regular or Irregular

If Section is Irregular, locate well from nearest corner boundary.

Section corner used: NE NW SE SW

RECEIVED

JAN 17 2014

Big Bend GMD #5

PLAT

Show location of the Cathodic Borehole. Show footage to the nearest lease or unit boundary line. Show the predicted locations of lease roads, tank batteries, pipelines, and electrical lines, as required by the Kansas Surface Owner Notice Act (House Bill 2032). You may attach a separate plat if desired.

LEGEND

- Well Location
- Tank Battery Location
- Pipeline Location
- Electric Line Location
- Lease Road Location

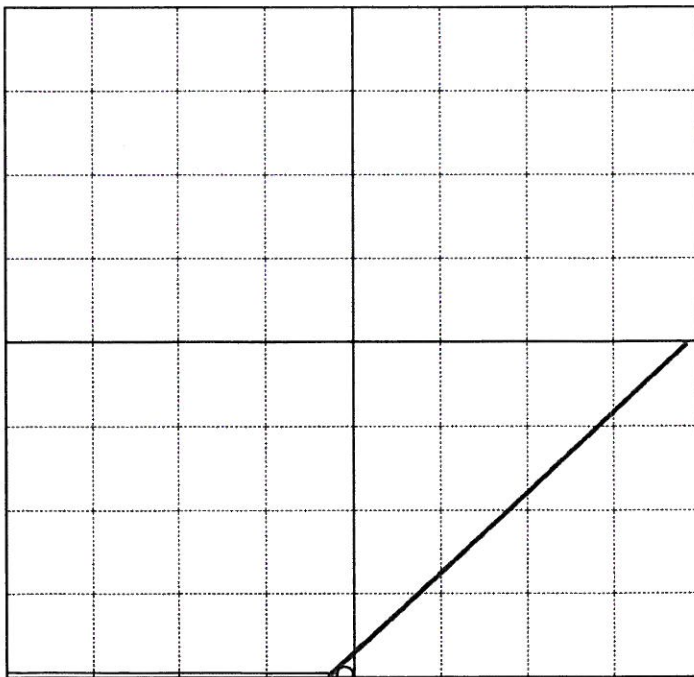

NOTE: In all cases, locate the spot of the proposed drilling location.

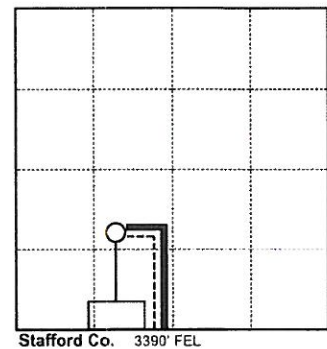

1. The manner in which you are using the depicted plat by identifying section lines, i.e. 1 section, 1 section with 8 surrounding sections, 4 sections, etc.;
2. The distance of the proposed drilling location from the section's south / north and east / west line;
3. The predicted locations of lease roads, tank batteries, pipelines, and electrical lines.

RECEIVED

JAN 17 2014

KANSAS CORPORATION COMMISSION
OIL & GAS CONSERVATION DIVISION

15-097-21785-0000

Form CDP-1
May 2010
Form must be Typed

Big Bend GMD #5

APPLICATION FOR SURFACE PIT

Submit in Duplicate

Operator Name: ONEOK NGL PIPELINE, L.L.C.		License Number: 33659
Operator Address: P.O. BOX 29		
Contact Person: Troy Prose		Phone Number: 620-834-2211
Lease Name & Well No.: MP 92 1		Pit Location (QQQQ): NW NW NW NE Sec. 26 Twp. 27 R. 20 <input type="checkbox"/> East <input checked="" type="checkbox"/> West 20 Feet from <input type="checkbox"/> North / <input checked="" type="checkbox"/> South Line of Section 2,514 Feet from <input type="checkbox"/> East / <input checked="" type="checkbox"/> West Line of Section KIOWA County
Type of Pit: <input type="checkbox"/> Emergency Pit <input type="checkbox"/> Burn Pit <input type="checkbox"/> Settling Pit <input type="checkbox"/> Drilling Pit <input type="checkbox"/> Workover Pit <input type="checkbox"/> Haul-Off Pit <i>(If WP Supply API No. or Year Drilled)</i>	Pit is: <input type="checkbox"/> Proposed <input type="checkbox"/> Existing If Existing, date constructed: Pit capacity: (bbls)	
Is the pit located in a Sensitive Ground Water Area? <input checked="" type="checkbox"/> Yes <input type="checkbox"/> No		Chloride concentration: mg/l <i>(For Emergency Pits and Settling Pits only)</i>
Is the bottom below ground level? <input type="checkbox"/> Yes <input type="checkbox"/> No	Artificial Liner? <input type="checkbox"/> Yes <input type="checkbox"/> No	How is the pit lined if a plastic liner is not used? Steel pit, no liner
Pit dimensions (all but working pits): Length (feet) Width (feet) Depth from ground level to deepest point: (feet)		<input checked="" type="checkbox"/> N/A: Steel Pits <input type="checkbox"/> No Pit
If the pit is lined give a brief description of the liner material, thickness and installation procedure. Steel pit, no liner		Describe procedures for periodic maintenance and determining liner integrity, including any special monitoring. Steel pit, no liner; material in pit will be removed offsite for disposal. No maintenance conducted.
Distance to nearest water well within one-mile of pit: feet Depth of water well feet		Depth to shallowest fresh water feet. Source of information: <input type="checkbox"/> measured <input type="checkbox"/> well owner <input type="checkbox"/> electric log <input type="checkbox"/> KDWR
Emergency, Settling and Burn Pits ONLY: Producing Formation: Number of producing wells on lease: Barrels of fluid produced daily: Does the slope from the tank battery allow all spilled fluids to flow into the pit? <input type="checkbox"/> Yes <input type="checkbox"/> No		Drilling, Workover and Haul-Off Pits ONLY: Type of material utilized in drilling/workover: Number of working pits to be utilized: Abandonment procedure: Drill pits must be closed within 365 days of spud date.
I hereby certify that the above statements are true and correct to the best of my knowledge and belief. 1-16-14 Date  Signature of Applicant or Agent		

KCC OFFICE USE ONLY			
Date Received:	Permit Number:	Permit Date:	Lease Inspection: <input type="checkbox"/> Yes <input type="checkbox"/> No
		<input type="checkbox"/> Liner <input type="checkbox"/> Steel Pit <input type="checkbox"/> RFAC <input type="checkbox"/> RFAS	

RECEIVED

JAN 17 2014

Big Bend GMD #5

KANSAS CORPORATION COMMISSION
OIL & GAS CONSERVATION DIVISION
APPLICATION FOR SURFACE PIT

Form CDP-1
May 2010
Form must be Typed

15-097-21785-0000

Submit in Duplicate

Operator Name: ONEOK NGL PIPELINE, L.L.C. License Number: 33659
Operator Address: P.O. BOX 29
Contact Person: Troy Prose Phone Number: 620-834-2211
Lease Name & Well No.: MP 92 1 Pit Location (QQQQ): NW - NW - NW - NE
Type of Pit: Emergency Pit, Burn Pit, Settling Pit, Drilling Pit, Workover Pit, Haul-Off Pit
Pit is: Proposed, Existing
If Existing, date constructed:
Pit capacity: (bbbls)
Is the pit located in a Sensitive Ground Water Area? [X] Yes [] No
Chloride concentration: mg/l
Is the bottom below ground level? [] Yes [] No Artificial Liner? [] Yes [] No
How is the pit lined if a plastic liner is not used? Steel pit, no liner
Pit dimensions (all but working pits): Length (feet) Width (feet) [X] N/A: Steel Pits
Depth from ground level to deepest point: (feet) [] No Pit
If the pit is lined give a brief description of the liner material, thickness and installation procedure. Describe procedures for periodic maintenance and determining liner integrity, including any special monitoring.
Steel pit, no liner Steel pit, no liner; material in pit will be removed offsite for disposal. No maintenance conducted.
Distance to nearest water well within one-mile of pit: Depth to shallowest fresh water feet. Source of information: [] measured [] well owner [] electric log [] KDWR
Emergency, Settling and Burn Pits ONLY: Producing Formation: Number of producing wells on lease: Barrels of fluid produced daily: Does the slope from the tank battery allow all spilled fluids to flow into the pit? [] Yes [] No
Drilling, Workover and Haul-Off Pits ONLY: Type of material utilized in drilling/workover: Number of working pits to be utilized: Abandonment procedure: Drill pits must be closed within 365 days of spud date.
I hereby certify that the above statements are true and correct to the best of my knowledge and belief.
1-16-14 Date Signature of Applicant or Agent
KCC OFFICE USE ONLY [] Liner [] Steel Pit [] RFAC [] RFAS
Date Received: Permit Number: Permit Date: Lease Inspection: [] Yes [] No

Mail to: KCC - Conservation Division, 130 S. Market - Room 2078, Wichita, Kansas 67202

15-09721785-0000

RECEIVED

JAN 17 2014

KANSAS CORPORATION COMMISSION
OIL & GAS CONSERVATION DIVISION

Form KSONA-1
July 2010
Form Must Be Typed
Form must be Signed
All blanks must be Filled

**CERTIFICATION OF COMPLIANCE WITH THE
Big Bend GMD #5 KANSAS SURFACE OWNER NOTIFICATION ACT**

This form must be submitted with all Forms C-1 (Notice of Intent to Drill); CB-1 (Cathodic Protection Borehole Intent); T-1 (Request for Change of Operator Transfer of Injection or Surface Pit Permit); and CP-1 (Well Plugging Application). Any such form submitted without an accompanying Form KSONA-1 will be returned.

Select the corresponding form being filed: C-1 (Intent) CB-1 (Cathodic Protection Borehole Intent) T-1 (Transfer) CP-1 (Plugging Application)

OPERATOR: License # 33659
Name: ONEOK NGL PIPELINE, L.L.C.
Address 1: P.O. BOX 29
Address 2:
City: MEDFORD State: OK Zip: 73759 + 0029
Contact Person: Troy Prose
Phone: (620) 834-2211 Fax: ()
Email Address:

Well Location:
NW NW NW NE Sec. 26 Twp. 27 S. R. 20 East West
County: KIOWA
Lease Name: MP 92 Well #: 1

If filing a Form T-1 for multiple wells on a lease, enter the legal description of the lease below:

Surface Owner Information:

Name: Four F Farms, L.L.C.
Address 1: 1497 50th Ave.
Address 2:
City: Offerly State: KS Zip: 67563 +

When filing a Form T-1 involving multiple surface owners, attach an additional sheet listing all of the information to the left for each surface owner. Surface owner information can be found in the records of the register of deeds for the county, and in the real estate property tax records of the county treasurer.

If this form is being submitted with a Form C-1 (Intent) or CB-1 (Cathodic Protection Borehole Intent), you must supply the surface owners and the KCC with a plat showing the predicted locations of lease roads, tank batteries, pipelines, and electrical lines. The locations shown on the plat are preliminary non-binding estimates. The locations may be entered on the Form C-1 plat, Form CB-1 plat, or a separate plat may be submitted.

Select one of the following:

- I certify that, pursuant to the Kansas Surface Owner Notice Act: (House Bill 2032), I have provided the following to the surface owner(s) of the land upon which the subject well is or will be located: 1) a copy of the Form C-1, Form CB-1, Form T-1, or Form CP-1 that I am filing in connection with this form; 2) if the form being filed is a Form C-1 or Form CB-1, the plat(s) required by this form; and 3) my operator name, address, phone number, fax, and email address.
- I have not provided this information to the surface owner(s). I acknowledge that, because I have not provided this information, the KCC will be required to send this information to the surface owner(s). To mitigate the additional cost of the KCC performing this task, I acknowledge that I am being charged a \$30.00 handling fee, payable to the KCC, which is enclosed with this form.

If choosing the second option, submit payment of the \$30.00 handling fee with this form. If the fee is not received with this form, the KSONA-1 form and the associated Form C-1, Form CB-1, Form T-1, or Form CP-1 will be returned.

I hereby certify that the statements made herein are true and correct to the best of my knowledge and belief.

Date: 1-16-14 Signature of Operator or Agent:  Title: Environmental Engineer, Pipelines