

KCC LICENSE: 35587 ROSE ROCK MIDSTREAM CRUDE, L. P.
KCC API: 15-145-21838-00-00
WELL NAME: MP 32.8 #1
NWNWSWSW 1295' FSL, 5076' FEL SEC.6-T23S-R16W, PAWNEE CO.
KCC DIST. 1

CB-1, GMD5

BIG BEND GROUNDWATER MANAGEMENT DISTRICT NO. 5

125 S. Main
Stafford, Kansas 67578
(620) 234-5352 Fax (620) 234-5718

KCC WICHITA

AUG 21 2018

RECEIVED

RECEIVED

Aug 20 2018

Big Bend GMD #5

FORM CP-10
APPLICATION FOR PERMIT TO DRILL AND CONSTRUCT
A CASED CATHODIC PROTECTION BOREHOLE
Referencing Kansas Corporation Commission Regulations
K.A.R. 82-3-700 through K.A.R. 82-3-710

Permit Application Number CPB- 18-18

To the Big Bend Groundwater Management District No. 5:

Applicant: MESA
Address: 4445 S 74TH E AVE TULSA OK 74145
(P.O. Box or Street) (City) (State) (Zip Code)
Telephone: (918) 627-3188
(Area Code) (Telephone)

Application to the Big Bend Groundwater Management District No. 5 for a permit to drill and construct a cathodic protection borehole in and through the Big Bend aquifer in the county of Pawnee state of Kansas, to the extent and in accordance with the following:

1. The location of the proposed cathodic protection borehole is in the NE quarter of the SW quarter of the SW quarter of Section 6, Township 23 south, Range 16 west and more particularly described as being near a point 1,295 feet north and 5,076 feet west of the apparent southeast corner of said section.
2. The proposed use of the cathodic protection borehole is to provide cathodic protection of the applicant's Hanston to Larned Jct. M facility from electrochemical corrosion.
3. The land surface elevation is 2,062 feet above mean sea level and the method of measurement used was (a) surveyed, (b) topographic map or (c) other estimated.
4. The depth to surface or top of bedrock or shale is 110 feet below land surface (bls).
5. The depth to the water table of the fresh water aquifer is 35 feet bls.
6. Aquifer salinity as indicated by chloride concentration is <300 mg/L and was determined by: (a) published report, (b) test well data, or (c) other _____.
7. The total depth of the cathodic protection borehole is 350 feet bls.
8. A non metallic surface casing equipped with centralizers will be installed in the surface casing borehole when drilling has penetrated 130 feet bls, which is a minimum of 20 feet below bedrock or shale surface as listed in paragraph #4.
9. Casing centralizers will be installed on the surface casing beginning at the surface casing's total depth and at 40 feet intervals along the complete length of the surface

has exhausted its anodes and replacement anodes are not installed within one year, or (e) has not been used for one year and the applicant does not demonstrate intentions to use it.

24. The applicant understands and agrees to comply with K.A.R. 82-3-700 through 82-3-710. Further, the applicant may request an exception to these regulations pursuant to K.A.R. 82-3-100(b).

25. Dated at 10:00AM, Kansas, this 14 day of AUGUST, 2018

Lacy Williams

(Applicant)

By *Lacy Williams*

Digitally signed by Lacy Williams
Date: 2018.08.20 12:10:32
-05'00'

(Signature)

Project Manager

(Title)

KCC WICHITA

AUG 21 2018

RECEIVED

APPLICANT DO NOT CONTINUE BELOW DOUBLE LINE
For Big Bend Groundwater Management District #5 Use

1) Application received on 8 / 20 / 2018.

2) Application review by John Hildebrand

Conservation Specialist

(Title)

3) The application is hereby denied. The denial was based on the following findings:

Recommend approval following application review.

4) The application meets or exceeds Cathodic Regulations K.A.R. 82-3-700 through K.A.R. 82-3-710 and is hereby approved by the Big Bend Groundwater Management District No. 5, this 20th day of August, 2018



Orrin Feril, Manager

Big Bend Groundwater Management District No. 5

KCC WICHITA
AUG 21 2018
RECEIVED

KANSAS CORPORATION COMMISSION
OIL & GAS CONSERVATION DIVISION

Form KSONA-1
July 2014
Form Must Be Typed
Form must be Signed
All blanks must be Filled

**CERTIFICATION OF COMPLIANCE WITH THE
KANSAS SURFACE OWNER NOTIFICATION ACT**

This form must be submitted with all Forms C-1 (Notice of Intent to Drill); CB-1 (Cathodic Protection Borehole Intent); T-1 (Request for Change of Operator Transfer of Injection or Surface Pit Permit); and CP-1 (Well Plugging Application). Any such form submitted without an accompanying Form KSONA-1 will be returned.

Select the corresponding form being filed C-1 (Intent) CB-1 (Cathodic Protection Borehole Intent) T-1 (Transfer) CP-1 (Plugging Application)

OPERATOR: License # 35587
Name: Rose Rock Midstream Crude, L.P.
Address 1: TWO WARREN PLACE
Address 2: 6120 S YALE SUITE 1500
City: TULSA State: OK Zip: 74136 + _____
Contact Person: JOHN CHRISTENSEN
Phone: (405) 945-6337 Fax: (_____) _____
Email Address: _____

Well Location:
NW NW SW SW Sec. 6 Twp. 23 S. R. 16 East West
County: Pawnee
Lease Name: MP 32.8 Well # 1

If filing a Form T-1 for multiple wells on a lease, enter the legal description of the lease below.

**KCC WICHITA
AUG 21 2018
RECEIVED**

Surface Owner Information:

Name: Frick Farm Properties, LP
Address 1: 1017 G Rd.
Address 2: _____
City: Lamed State: KS Zip: 67550 + _____

When filing a Form T-1 involving multiple surface owners, attach an additional sheet listing all of the information to the left for each surface owner. Surface owner information can be found in the records of the register of deeds for the county, and in the real estate property tax records of the county treasurer.

If this form is being submitted with a Form C-1 (Intent) or CB-1 (Cathodic Protection Borehole Intent), you must supply the surface owners and the KCC with a plat showing the predicted locations of lease roads, tank batteries, pipelines, and electrical lines. The locations shown on the plat are preliminary non-binding estimates. The locations may be entered on the Form C-1 plat, Form CB-1 plat, or a separate plat may be submitted.

Select one of the following:

- I certify that, pursuant to the Kansas Surface Owner Notice Act (House Bill 2032), I have provided the following to the surface owner(s) of the land upon which the subject well is or will be located: 1) a copy of the Form C-1, Form CB-1, Form T-1, or Form CP-1 that I am filing in connection with this form; 2) if the form being filed is a Form C-1 or Form CB-1, the plat(s) required by this form; and 3) my operator name, address, phone number, fax, and email address.
- I have not provided this information to the surface owner(s). I acknowledge that, because I have not provided this information, the KCC will be required to send this information to the surface owner(s). To mitigate the additional cost of the KCC performing this task, I acknowledge that I must provide the name and address of the surface owner by filling out the top section of this form and that I am being charged a \$30.00 handling fee, payable to the KCC, which is enclosed with this form.

If choosing the second option, submit payment of the \$30.00 handling fee with this form. If the fee is not received with this form, the KSONA-1 form and the associated Form C-1, Form CB-1, Form T-1, or Form CP-1 will be returned.

I hereby certify that the statements made herein are true and correct to the best of my knowledge and belief.

Date: 8/14/2018 Signature of Operator or Agent: Lacy Williams Title: Project Manager

IN ALL CASES, PLEASE FULLY COMPLETE THIS FORM.

Operator: ROSE ROCK MIDSTREAM CRUDE, L.P.
 Facility Name: MP 32.8
 Borehole Number: 1





Location of Well: 1,295 feet from N / S Line of Section
13 feet from E / W Line of Section
 Sec. 6 Twp. 23 S Rng. 16 E W
 Is Section: Regular or Irregular
 If Section is Irregular, locate well from nearest corner boundary.
 Section corner used: NE NW SE SW

KCC WICHITA
AUG 21 2018
RECEIVED

PLAT

Show location of the Cathodic Borehole. Show footage to the nearest lease or unit boundary line. Show the predicted locations of lease roads, tank batteries, pipelines, and electrical lines, as required by the Kansas Surface Owner Notice Act (House Bill 2032). You may attach a separate plat if desired.

LEGEND

-  Well Location
-  Tank Battery Location
-  Pipeline Location
-  Electric Line Location
-  Lease Road Location

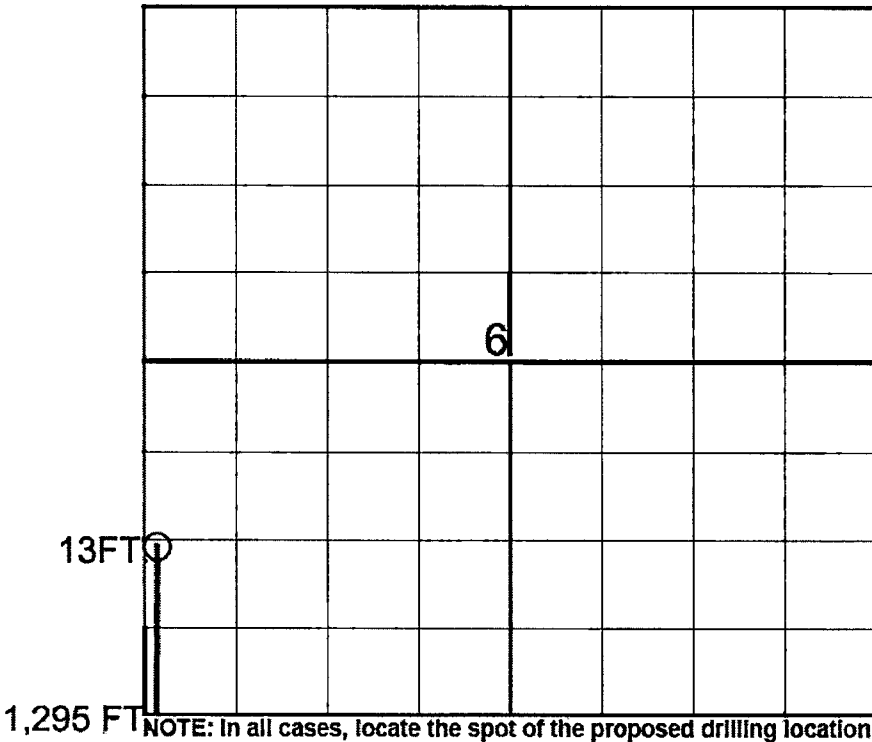

NOTE: In all cases, locate the spot of the proposed drilling location.

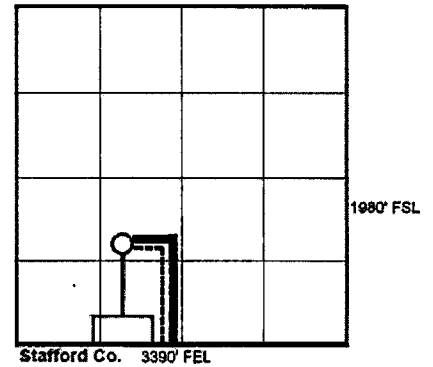

1. The manner in which you are using the depicted plat by identifying section lines, i.e. 1 section, 1 section with 8 surrounding sections, 4 sections, etc.;
2. The distance of the proposed drilling location from the section's south / north and east / west line;
3. The predicted locations of lease roads, tank batteries, pipelines, and electrical lines.

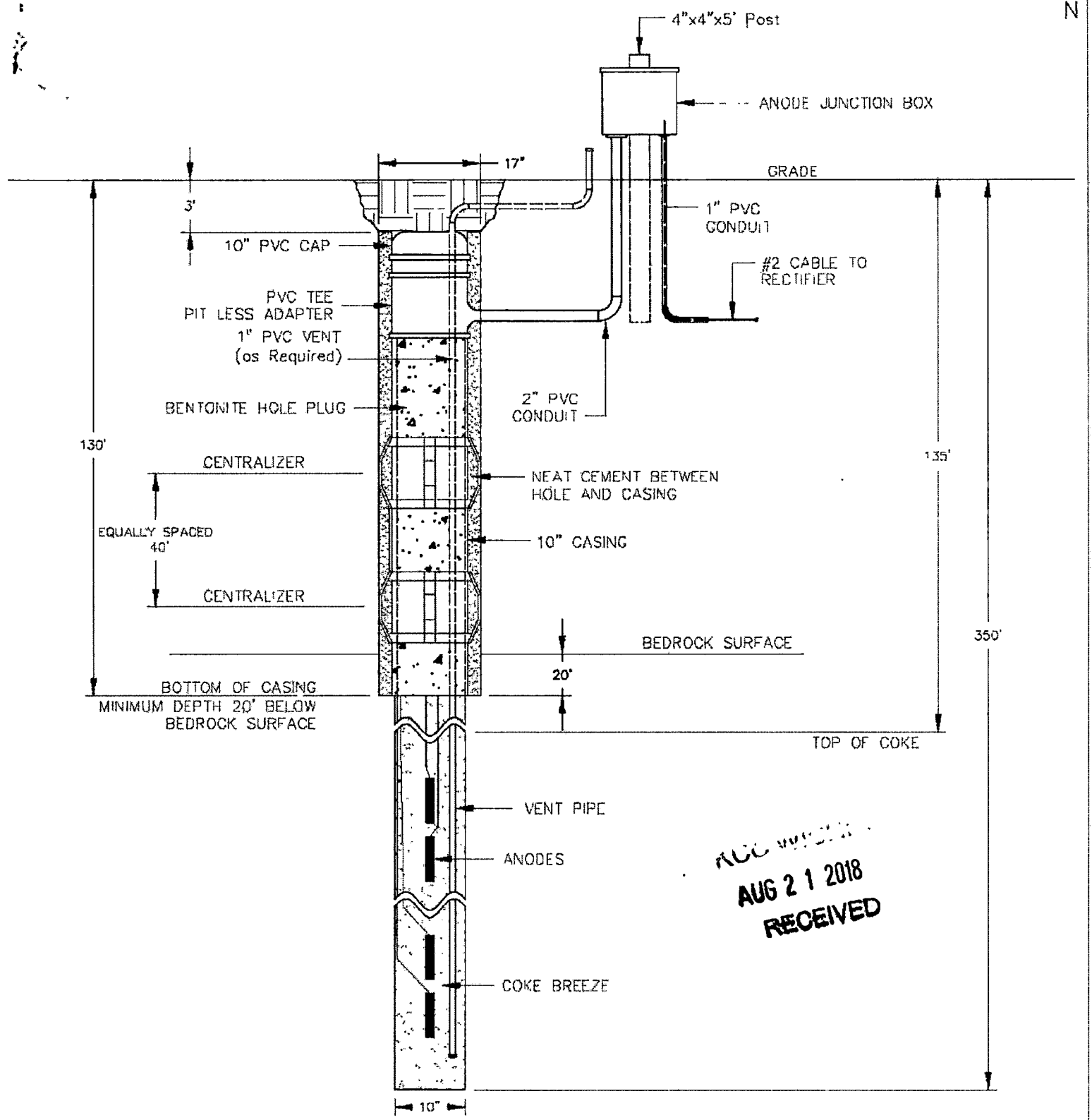

REC'D
AUG 21 2018
RECEIVED

NOTES:

REV	DESCRIPTION	DATE	BY	CHK
2	CUSTOMER SPECIFIC	8/14/2018	LW	LW
1	CUSTOMER SPECIFIC	10/7/2018	LW	RG
0	ORIGINAL	12/17/2014	MM	

REVISION

MESA

TULSA, OK | Dallas-Ft. Worth, TX | Houston, TX | Indianapolis, IN | Jacksonville, FL

THIS DOCUMENT AND THE INFORMATION CONTAINED HEREIN ARE THE PROPERTY OF MESA, AND HAS BEEN PRODUCED SOLELY FOR THE USE OF OUR CLIENT. THIS DRAWING IS CONFIDENTIAL AND PROPRIETARY AND SHALL NOT BE USED DIRECTLY OR INDIRECTLY, FOR ANY REASON OTHER THAN THAT WHICH IT IS INTENDED, OR IN ANY WAY DETRIMENTAL TO OUR INTERESTS.

CLIENT NAME & ADDRESS:
MESA

DESCRIPTION:
DEEP GROUND BED INSTALLATION
BELOW GRADE COMPLETION
W/CASING & TEE

JOB NO.: NONE	SCALE: DO NOT SCALE	SHEET: 1 OF 1
DRAWN BY: LAW	DRAWN DATE: 08/14/18	CHK'D BY: CHK'D DATE:
DWG NO.: TYP-00117-1		REV: 2

**KANSAS CORPORATION COMMISSION
OIL & GAS CONSERVATION DIVISION
APPLICATION FOR SURFACE PIT**

Form GDP-1
July 2014
Form must be Typed

Submit in Duplicate

Operator Name Rose Rock Midstream Crude, L.P.		License Number: 35587
Operator Address: TWO WARREN PLACE		6120 S YALE SUITE 1500 TULSA OK 74136
Contact Person: JOHN CHRISTENSEN		Phone Number: 405-945-6337
Lease Name & Well No.:		Pit Location (QQQQ): NW - NW - SW - SW Sec. 6 Twp. 23 R. 16 <input type="checkbox"/> East <input checked="" type="checkbox"/> West 1295 Feet from <input type="checkbox"/> North / <input checked="" type="checkbox"/> South Line of Section 13 Feet from <input type="checkbox"/> East / <input checked="" type="checkbox"/> West Line of Section Pawnee County
Type of Pit: <input type="checkbox"/> Emergency Pit <input type="checkbox"/> Burn Pit <input type="checkbox"/> Settling Pit <input checked="" type="checkbox"/> Drilling Pit <input type="checkbox"/> Workover Pit <input type="checkbox"/> Haul-Off Pit <i>(If WP Supply API No. or Year Drilled)</i>	Pit is: <input checked="" type="checkbox"/> Proposed <input type="checkbox"/> Existing If Existing, date constructed: _____ Pit capacity: 45 (bbls)	
Is the pit located in a Sensitive Ground Water Area? <input checked="" type="checkbox"/> Yes <input type="checkbox"/> No		Chloride concentration _____ mg/l <i>(For Emergency Pits and Settling Pits only)</i>
Is the bottom below ground level? <input checked="" type="checkbox"/> Yes <input type="checkbox"/> No	Artificial Liner <input checked="" type="checkbox"/> Yes <input type="checkbox"/> No	How is the pit lined if a plastic liner is not used?
Pit dimensions (all but working pits): 8 Length (feet) 4 Width (feet) <input type="checkbox"/> N/A: Steel Pits Depth from ground level to deepest point: 8 (feet) <input type="checkbox"/> No Pit		
If the pit is lined give a brief description of the liner material, thickness and installation procedure. 6 MIL POLY LINER		Describe procedures for periodic maintenance and determining liner integrity, including any special monitoring. SECURED WITH WEIGHTS AND VISUALLY INSPECTED DAILY
Distance to nearest water well within one-mile of pit: 1001 feet Depth of water well 70 feet		Depth to shallowest fresh water 22 feet. Source of information: <input type="checkbox"/> measured <input type="checkbox"/> well owner <input type="checkbox"/> electric log <input checked="" type="checkbox"/> KDWR
Emergency, Settling and Burn Pits ONLY: Producing Formation: _____ Number of producing wells on lease: _____ Barrels of fluid produced daily _____ Does the slope from the tank battery allow all spilled fluids to fl w into the pit? <input type="checkbox"/> Yes <input type="checkbox"/> No		Drilling, Workover and Haul-Off Pits ONLY: Type of material utilized in drilling/workover: MUD/CUTTINGS Number of working pits to be utilized: 1 Abandonment procedure: REMOVE EXCESS WATER AND BACKFILL ALLOW FOR SETTLING Drill pits must be closed within 365 days of spud date.
I hereby certify that the above statements are true and correct to the best of my knowledge and belief.		KCC WICHITA AUG 21 2018 RECEIVED
8/14/2018 Date	<i>Lacy Williams</i> Signature of Applicant or Agent	

KCC OFFICE USE ONLY			
Date Received: _____	Permit Number: _____	Permit Date: _____	Lease Inspection: <input type="checkbox"/> Yes <input checked="" type="checkbox"/> No
<input type="checkbox"/> Liner <input type="checkbox"/> Steel Pit <input type="checkbox"/> RFAC <input type="checkbox"/> RFAS			