

* Correction

For KCC Use: Effective Date: 12-9-2012 District #: 3 SGA? Yes No

KANSAS CORPORATION COMMISSION OIL & GAS CONSERVATION DIVISION

Form C-1 March 2010

Form must be Typed Form must be Signed Form must be Filled

NOTICE OF INTENT TO DRILL

CORRECTED

Must be approved by KCC five (5) days prior to commencing well Form KSONA-1, Certification of Compliance with the Kansas Surface Owner Notification Act, MUST be submitted with this form.

Expected Spud Date: September 4 2013 month day year

Spot Description: The East 1/2 of the SE 1/4 of Sec 25 T28S R18E SW SE NE SE Sec. 25 Twp. 28 S R. 18 E W 1.550 feet from N / S Line of Section 100 feet from E / W Line of Section Is SECTION: Regular Irregular?

OPERATOR: License# 34353 Name: Multiplex Resources, Inc Address 1: 1300 Rollingbrook Dr., Suite 605 Address 2: City: Baytown State: TX Zip: 77521 Contact Person: Brandon L Giles Phone: 2814243242

County: Neosho Lease Name: Dale Cox Well #: WSW-1 Field Name: Urbana

CONTRACTOR: License# Must be licensed by KCC Name: Advise on ACO-1

Is this a Prorated / Spaced Field? Yes No Target Formation(s): Mississippi Nearest Lease or unit boundary line (in footage): 100 feet MSL

Well Drilled For: Oil Gas Seismic; # of Holes Other: Water Supply Well (WSW) Well Class: Infield Pool Ext. Wildcat Other Type Equipment: Mud Rotary Air Rotary Cable If OWWO: old well information as follows:

Ground Surface Elevation: 900 feet MSL Water well within one-quarter mile: Yes No Public water supply well within one mile: Yes No Depth to bottom of fresh water: 50 Depth to bottom of usable water: 150 Surface Pipe by Alternate: I II Length of Surface Pipe Planned to be set: 20' Length of Conductor Pipe (if any): Projected Total Depth: 1050 Formation at Total Depth: Mississippi

Operator: Well Name: Original Completion Date: Original Total Depth:

Water Source for Drilling Operations: Well Farm Pond Other: Driller Supplied DWR Permit #: (Note: Apply for Permit with DWR

Directional, Deviated or Horizontal wellbore? Yes No If Yes, true vertical depth: Bottom Hole Location: KCC DKT #:

Will Cores be taken? Yes No If Yes, proposed zone:

* WAS: Oil, SW-SE-NE-SE 1350' FSL 465' FSL, NLUB: 456' IS: WSW, SE-SE-NE-SE 1550' FSL 100' FSL, NLUB: 100' AFFIDAVIT

RECEIVED KANSAS CORPORATION COMMISSION

AUG 28 2013

CONSERVATION DIVISION WICHITA, KS

The undersigned hereby affirms that the drilling, completion and eventual plugging of this well will comply with K.S.A. 55 et. seq. It is agreed that the following minimum requirements will be met:

- 1. Notify the appropriate district office prior to spudding of well;
2. A copy of the approved notice of intent to drill shall be posted on each drilling rig;
3. The minimum amount of surface pipe as specified below shall be set by circulating cement to the top; in all cases surface pipe shall be set through all unconsolidated materials plus a minimum of 20 feet into the underlying formation.
4. If the well is dry hole, an agreement between the operator and the district office on plug length and placement is necessary prior to plugging;
5. The appropriate district office will be notified before well is either plugged or production casing is cemented in;
6. If an ALTERNATE II COMPLETION, production pipe shall be cemented from below any usable water to surface within 120 DAYS of spud date. Or pursuant to Appendix "B" - Eastern Kansas surface casing order #133,891-C, which applies to the KCC District 3 area, alternate II cementing must be completed within 30 days of the spud date or the well shall be plugged. In all cases, NOTIFY district office prior to any cementing.

I hereby certify that the statements made herein are true and to the best of my knowledge and belief.

Date: 8-26-13 Signature of Operator or Agent: Title: President

For KCC Use ONLY API # 133-27614-00-00 Conductor pipe required None feet Minimum surface pipe required 20 feet per ALT. Approved by: This authorization expires: 12-4-2013 Spud date: Agent:

- Remember to: - File Certification of Compliance with the Kansas Surface Owner Notification Act (KSONA-1) with Intent to Drill; - File Drill Pit Application (form CDP-1) with Intent to Drill; - File Completion Form ACO-1 within 120 days of spud date; - File acreage attribution plat according to field proration orders; - Notify appropriate district office 48 hours prior to workover or re-entry; - Submit plugging report (CP-4) after plugging is completed (within 60 days); - Obtain written approval before disposing or injecting salt water; - If well will not be drilled or permit has expired (See: authorized expiration date) please check the box below and return to the address below

Well will not be drilled or Permit Expired Date: Signature of Operator or Agent:

Mail to: KCC - Conservation Division, 130 S. Market - Room 2078, Wichita, Kansas 67202

25 28 18 E W

- Correction -

CORRECTED

For KCC Use ONLY

API # 15 - 133-27614-0000

IN ALL CASES PLOT THE INTENDED WELL ON THE PLAT BELOW

In all cases, please fully complete this side of the form. Include items 1 through 5 at the bottom of this page.

Operator: Multiplex Resources, Inc
Lease: Dale Cox
Well Number: WSW-1
Field: Urbana

Location of Well: County: Neosho
1,550 feet from N / S Line of Section
100 feet from E / W Line of Section
Sec. 25 Twp. 28 S. R. 18 E W

Number of Acres attributable to well:
QTR/QTR/QTR/QTR of acreage: SW - SE - NE - SE
52

Is Section: Regular or Irregular

If Section is Irregular, locate well from nearest corner boundary.
Section corner used: NE NW SE SW

PLAT

Show location of the well. Show footage to the nearest lease or unit boundary line. Show the predicted locations of lease roads, tank batteries, pipelines and electrical lines, as required by the Kansas Surface Owner Notice Act (House Bill 2032). You may attach a separate plat if desired.

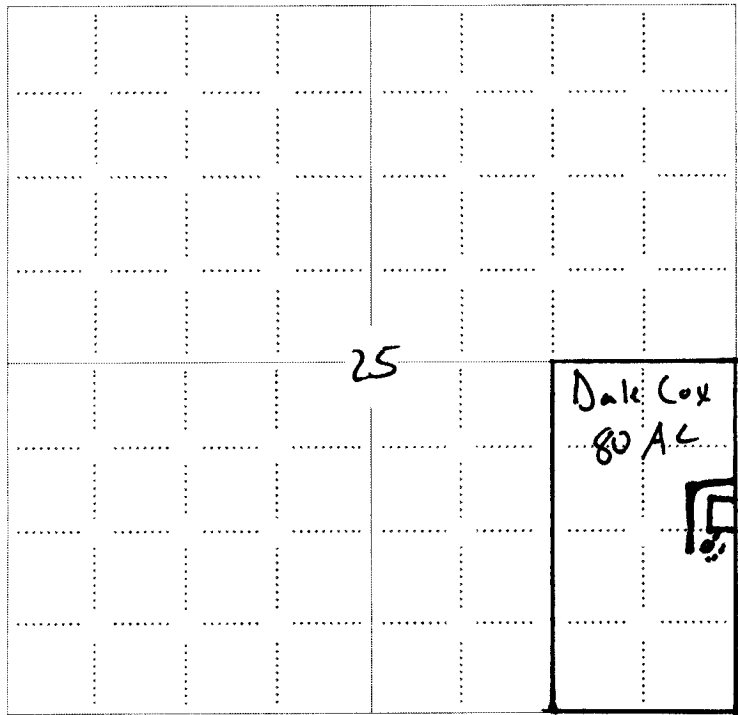

LEGEND

- Well Location
- Tank Battery Location
- Pipeline Location
- Electric Line Location
- Lease Road Location

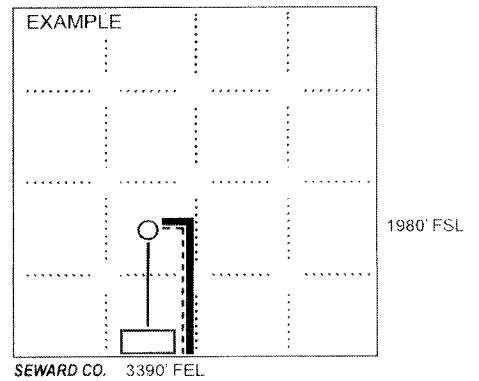

NOTE: In all cases locate the spot of the proposed drilling locaton.

In plotting the proposed location of the well, you must show:

- The manner in which you are using the depicted plat by identifying section lines, i.e. 1 section, 1 section with 8 surrounding sections, 4 sections, etc.
- The distance of the proposed drilling location from the south / north and east / west outside section lines.
- The distance to the nearest lease or unit boundary line (in footage).
- If proposed location is located within a prorated or spaced field a certificate of acreage attribution plat must be attached: (CO-7 for oil wells; CG-8 for gas wells).
- The predicted locations of lease roads, tank batteries, pipelines, and electrical lines.

RECEIVED
KANSAS CORPORATION COMMISSION

AUG 28 2013

CONSERVATION DIVISION
WICHITA, KS

- Correction -

KANSAS CORPORATION COMMISSION
OIL & GAS CONSERVATION DIVISION

Form KSONA-1
July 2010
Form Must Be Typed
Form must be Signed
All blanks must be Filled

CERTIFICATION OF COMPLIANCE WITH THE
KANSAS SURFACE OWNER NOTIFICATION ACT

This form must be submitted with all Forms C-1 (Notice of Intent to Drill); CB-1 (Cathodic Protection Borehole Intentional); T-1 (Request for Change of Operator Transfer of Injection or Surface Pit Permit); and CP-1 (Well Plugging Application). Any such form submitted without an accompanying Form KSONA-1 will be returned.

15-133-27614-0000

CORRECTED

Select the corresponding form being filed: C-1 (Intent) CB-1 (Cathodic Protection Borehole Intent) T-1 (Transfer) CP-1 (Plugging Application)

OPERATOR: License # 34353
Name: Multiplex Resources, Inc
Address 1: 1300 Rollingbrook Dr., Suite 604
Address 2:
City: Baytown State: TX Zip: 77521
Contact Person: Brandon L Guiles
Phone: (281) 4243242 Fax: ()
Email Address:

Well Location:
SW SE NE SE Sec. 25 Twp. 28 S. R. 18 East West
County: Neosho
Lease Name: Dale Cox Well #: WSW-1

If filing a Form T-1 for multiple wells on a lease, enter the legal description of the lease below.

Surface Owner Information:

Name: Allen Cox
Address 1: Route 2, Box 211
Address 2:
City: Chanute State: KS Zip: 66720

When filing a Form T-1 involving multiple surface owners, attach an additional sheet listing all of the information to the left for each surface owner. Surface owner information can be found in the records of the register of deeds for the county, and in the real estate property tax records of the county treasurer.

If this form is being submitted with a Form C-1 (Intent) or CB-1 (Cathodic Protection Borehole Intent), you must supply the surface owners and the KCC with a plat showing the predicted locations of lease roads, tank batteries, pipelines, and electrical lines. The locations shown on the plat are preliminary non-binding estimates. The locations may be entered on the Form C-1 plat, Form CB-1 plat, or a separate plat may be submitted.

Select one of the following:

- I certify that, pursuant to the Kansas Surface Owner Notice Act (House Bill 2032), I have provided the following to the surface owner(s) of the land upon which the subject well is or will be located: 1) a copy of the Form C-1, Form CB-1, Form T-1, or Form CP-1 that I am filing in connection with this form; 2) if the form being filed is a Form C-1 or Form CB-1, the plat(s) required by this form; and 3) my operator name, address, phone number, fax, and email address.
- I have not provided this information to the surface owner(s). I acknowledge that, because I have not provided this information, the KCC will be required to send this information to the surface owner(s). To mitigate the additional cost of the KCC performing this task, I acknowledge that I am being charged a \$30.00 handling fee, payable to the KCC, which is enclosed with this form.

If choosing the second option, submit payment of the \$30.00 handling fee with this form. If the fee is not received with this form, the KSONA-1 form and the associated Form C-1, Form CB-1, Form T-1, or Form CP-1 will be returned.

I hereby certify that the statements made herein are true and correct to the best of my knowledge and belief.

Date: 8/28/2013 Signature of Operator or Agent: [Signature] Title: President

RECEIVED
KANSAS CORPORATION COMMISSION

AUG 28 2013

- Correction -

KANSAS CORPORATION COMMISSION
OIL & GAS CONSERVATION DIVISION
APPLICATION FOR SURFACE PIT

Form CDP-1
May 2010
Form must be Typed

Submit in Duplicate

Operator Name: Multiplex Resources, Inc		License Number: 34353	
Operator Address: 1300 Rollingbrook Dr., Suite 604		Baytown TX 77521	
Contact Person: Brandon L Guiles		Phone Number: 2814243242	
Lease Name & Well No.: Dale Cox WSW-1		Pit Location (QQQQ): SE SE NE SE Sec. 25 Twp. 28 R. 18 <input checked="" type="checkbox"/> East <input type="checkbox"/> West 1,550 Feet from <input type="checkbox"/> North / <input checked="" type="checkbox"/> South Line of Section 100 Feet from <input checked="" type="checkbox"/> East / <input type="checkbox"/> West Line of Section Neosho County	
Type of Pit: <input type="checkbox"/> Emergency Pit <input type="checkbox"/> Burn Pit <input type="checkbox"/> Settling Pit <input checked="" type="checkbox"/> Drilling Pit <input type="checkbox"/> Workover Pit <input type="checkbox"/> Haul-Off Pit <small>(if WP Supply API No. or Year Drilled)</small>	Pit is: <input checked="" type="checkbox"/> Proposed <input type="checkbox"/> Existing If Existing, date constructed: Pit capacity: 200 (bbls)	Is the pit located in a Sensitive Ground Water Area? <input type="checkbox"/> Yes <input checked="" type="checkbox"/> No Chloride concentration: _____ mg/l <small>(For Emergency Pits and Settling Pits only)</small>	
Is the bottom below ground level? <input checked="" type="checkbox"/> Yes <input type="checkbox"/> No	Artificial Liner? <input type="checkbox"/> Yes <input checked="" type="checkbox"/> No	How is the pit lined if a plastic liner is not used? Natural	
Pit dimensions (all but working pits): 10 Length (feet) 8 Width (feet) <input type="checkbox"/> N/A. Steel Pits Depth from ground level to deepest point: 4 (feet) <input type="checkbox"/> No Pit			
If the pit is lined give a brief description of the liner material, thickness and installation procedure.		Describe procedures for periodic maintenance and determining liner integrity, including any special monitoring. RECEIVED KANSAS CORPORATION COMMISSION AUG 28 2013 CONSERVATION DIVISION WICHITA, KS	
Distance to nearest water well within one-mile of pit: NA 5280 feet Depth of water well 100 feet		Depth to shallowest fresh water 50 Source of information: <input type="checkbox"/> measured <input type="checkbox"/> well owner <input type="checkbox"/> electric log <input checked="" type="checkbox"/> KDWR	
Emergency, Settling and Burn Pits ONLY: Producing Formation: _____ Number of producing wells on lease: _____ Barrels of fluid produced daily: _____ Does the slope from the tank battery allow all spilled fluids to flow into the pit? <input type="checkbox"/> Yes <input type="checkbox"/> No		Drilling, Workover and Haul-Off Pits ONLY: Type of material utilized in drilling/workover: Fresh Water Number of working pits to be utilized: 1 Abandonment procedure: Evaporation and refill/w top soil Drill pits must be closed within 365 days of spud date.	
I hereby certify that the above statements are true and correct to the best of my knowledge and belief. 8/28/2013 Date  Signature of Applicant or Agent			

CORRECTED

15-133-27614-0000

KCC OFFICE USE ONLY			
Date Received: 8-28-13	Permit Number: _____	Permit Date: 8-28-13	Lease Inspection: <input type="checkbox"/> Yes <input checked="" type="checkbox"/> No

Mail to: KCC - Conservation Division, 130 S. Market - Room 2078, Wichita, Kansas 67202