

15-153-20364-00-00

STATE OF KANSAS
STATE CORPORATION COMMISSION

WELL PLUGGING RECORD

Give All Information Completely
Make Required Affidavit
Mail or Deliver Report to
Conservation Division
State Corporation Comm.
245 North Water
Wichita, KS 67202

Rawlins County. Sec. 26 Twp. 1S Rge. 34W E/W
Location as "NE/CNW $\frac{1}{4}$ SW $\frac{1}{4}$ " or footage from lines
C NW SE

Lease Owner Moble C. Hoover & Abercrombie Drilling
Lease Name HEBLE Well No. 1
Office Address 801 Union Center, Wichita, Kansas
Character of Well (Completed as Oil, Gas or Dry Hole)
Dry Hole

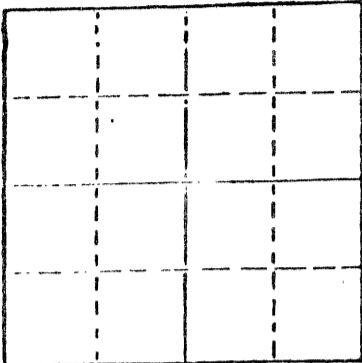

Locate well correctly on above
Section Plat

Date Well completed Nov. 2 19 79
Application for plugging filed (verbally) Nov. 2 19 79
Application for plugging approved (verbally) Nov. 2 19 79
Plugging commenced Nov. 2 19 79
Plugging completed Nov. 2 19 79

Reason for abandonment of well or producing formation
No commercial quantity of oil or gas encountered
If a producing well is abandoned, date of last production
19

Was permission obtained from the Conservation Division or
its agents before plugging was commenced? Yes

Name of Conservation Agent who supervised plugging of this well Gilbert Balthazor
Producing formation _____ Depth to top _____ Bottom _____ Total Depth of Well 4265'
Show depth and thickness of all water, oil and gas formations.

OIL, GAS OR WATER RECORDS

CASING RECORD

FORMATION	CONTENT	FROM	TO	SIZE	PUT IN	PULLED OUT

Describe in detail the manner in which the well was plugged, indicating where the mud fluid
was placed and the method or methods used in introducing it into the hold. If cement or other
plugs were used, state the character of same and depth placed, from _____ feet to
_____ feet for each plug set.

T.D. 4265'
Set 1st plug at 1800' with 70 sacks
2nd plug at 300' with 20 sacks
3rd plug at 40' solid bridge with 10 sacks
rathole with 5 sacks.
Cemented with 50/50 posmix, 6% gel.
Plug was down at 6:15 p.m., 11-02-79.

(If additional description is necessary, use BACK of this sheet)

Name of Plugging Contractor Abercrombie Drilling, Inc.

STATE OF Kansas COUNTY OF Sedgwick, ss.
Jack L. Partridge, Asst. Sec.-Treas. (employee of owner) or (owner or operator)
of the above-described well, being first duly sworn on oath, says: That I have knowledge of
the facts, statements, and matters herein contained and the log of the above-described well
as filed and that the same are true and correct. So help me God.

(Signature) Jack L. Partridge
801 Union Center, Wichita, Kansas
(Address)

SUBSCRIBED AND SWORN TO before me this 9th day of November, 1979



Sherrie L. Brooks
Sherrie L. Brooks Notary Public.

My commission expires 08-21-82

RECEIVED
STATE CORPORATION COMMISSION
11-19-1979
NOV 19 1979

CONSERVATION DIVISION
Wichita, Kansas

KANSAS DRILLERS LOG

API No. 15 — 153 — 20,364-00-00
 County Number

S. 26 T. 1S R. 34W ^E/_W
 Loc. C NW SE
 County Rawlins

Operator
Moble C. Hoover & Abercrombie Drilling, Inc.

Address
801 Union Center, Wichita, Kansas 67202

Well No. 1 Lease Name Heble

Footage Location
1980 feet from (N) XX line 1980' feet from XX (W) line

Principal Contractor Abercrombie Drilling, Inc Geologist Orlin R. Phelps

Spud Date October 25, 1979 Total Depth 4265' P.B.T.D. 4600'

Date Completed November 2, 1979 Oil Purchaser

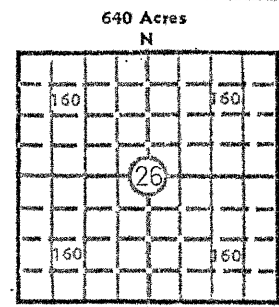

Elev.: Gr. 3052'
 DF 3055' KB 3057'

CASING RECORD

Report of all strings set — surface, intermediate, production, etc.

Purpose of string	Size hole drilled	Size casing set (in O.D.)	Weight lbs/ft.	Setting depth	Type cement	Sacks	Type and percent additives
Surface	12 1/4"	8-5/8"	20#	299'	60/40 posmix	235	3% Ca.Cl. 2% gel.

LINER RECORD

PERFORATION RECORD

Top, ft.	Bottom, ft.	Sacks cement	Shots per ft.	Size & type	Depth interval

TUBING RECORD

Size	Setting depth	Packer set at

ACID, FRACTURE, SHOT, CEMENT SQUEEZE RECORD

Amount and kind of material used	Depth interval treated

RECEIVED
 STATE CORPORATION COMMISSION
 11-19-1979
 NOV 19 1979
 CONSERVATION DIVISION
 Wichita, Kansas

INITIAL PRODUCTION

Date of first production	Producing method (flowing, pumping, gas lift, etc.)
RATE OF PRODUCTION PER 24 HOURS	Oil bbls. Gas MCF Water bbls. Gas-oil ratio CFPB
Disposition of gas (vented, used on lease or sold)	Producing interval(s)

INSTRUCTIONS: As provided in KCC Rule 82-2-125, within 90 days after completion of a well, one completed copy of this Drillers Log shall be transmitted to the State Geological Survey of Kansas, 4150 Monroe Street, Wichita, Kansas 67209. Copies of this form are available from the Conservation Division, State Corporation Commission, 3830 So. Meridian (P.O. Box 17027), Wichita, Kansas 66217. Phone AC 316-522-2206. If confidential custody is desired, please note Rule 82-2-125. Drillers Logs will be on open file in the Oil and Gas Division, State Geological Survey of Kansas, Lawrence, Kansas 66044.

Operator
 Mobile C. Hoover & Abercrombie Drilling, Inc.

DESIGNATE TYPE OF COMP.: OIL, GAS,
 DRY HOLE, SWDW, ETC.:
 Dry Hole

Well No. 1

Lease Name
 Heble

S 26 T1S R34W E W

WELL LOG

Show all important zones of porosity and contents thereof; cored intervals, and all drill-stem tests, including depth interval tested, cushion used, time tool open, flowing and shut-in pressures, and recoveries.

SHOW GEOLOGICAL MARKERS, LOGS RUN, OR OTHER DESCRIPTIVE INFORMATION.

FORMATION DESCRIPTION, CONTENTS, ETC.	TOP	BOTTOM	NAME	DEPTH
Clay, sand and shale	0	300	SAMPLE TOPS	
Shale and sand	300	2240		
Shale	2240	2690	Anhydrite	2912' (+ 145
Shale with sand	2690	2912	B/Anhydrite	2947' (+ 110
Anhydrite	2912	2947	Heebner	3955' (- 898
Shale	2947	3051	Lansing	4004' (- 947
Lime and shale	3051	4108	B/KC	4246' (-1189
Lime	4108	4120		
Lime and shale	4120	4212		
Lime	4212	4265		
Rotary Total Depth		4265		
<p>DST #1 (4019-4074') 30", 45", 60" 45" Rec. 185' socwm, 2% oil, 40% water IFP 44-76, IBHP 1233, FFP 87-131 FBHP 1190. Temp. 132°</p>				
<p>DST #2 (4074-4120') 30", 30", 30" 30" Rec. 20' mud. IFP 33-33, IBHP 33, FFP 44-44, FBHP 44. Temp. 120°</p>				
<p>DST #3 (4120-4212') 30", 30", 30" 30" Rec. 1' free oil, 63' ocm, 3% oil. IFP 76-87, IBHP 922, FFP 87-98, FBHP 718. Temp. 123°</p>				

USE ADDITIONAL SHEETS, IF NECESSARY, TO COMPLETE WELL RECORD.

Date Received

Jack L. Partridge
 Signature
 Jack L. Partridge, Asst. Sec.-Treas.
 Title
 November 9, 1979
 Date