

\* Amended

STATE CORPORATION COMMISSION OF KANSAS  
OIL & GAS CONSERVATION DIVISION  
WELL COMPLETION OR RECOMPLETION FORM  
ACO-1 WELL HISTORY  
DESCRIPTION OF WELL AND LEASE

SIDE ONE

SX

724

API NO. 15-153-20-714-00-00

County.....Rawlins.....  
C.....NE.....NE.....Sec. 36.....Twp. 1S.....Rge. 34.....East  
.....X.....West

.....4620'..... Ft North from Southeast Corner of Section  
.....660'..... Ft West from Southeast Corner of Section  
(Note: Locate well in section plat below)

Lease Name.....Horinek.....Well # 1-36

Field Name.....Vap Southwest

Producing Formation.....Lansing

Elevation: Ground.....3020'.....KB.....3025'

Section Plat

RECEIVED  
STATE CORPORATION COMMISSION  
11-02-1988  
NOV 2 1988  
CONSERVATION DIVISION  
Wichita, Kansas

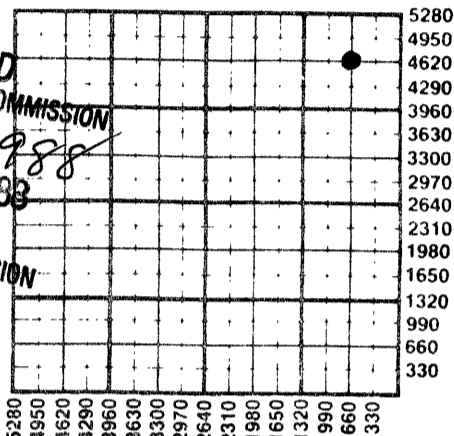

WATER SUPPLY INFORMATION

Disposition of Produced Water: \_\_\_\_\_ Disposal  
Docket # ..... \_\_\_\_\_ Repressuring

Questions on this portion of the ACO-1 call:

Water Resources Board (913) 296-3717  
Source of Water: Hauled  
Division of Water Resources Permit #.....

\_\_\_\_\_ Groundwater.....Ft North from Southeast Corner  
(Well) .....Ft West from Southeast Corner of  
Sec Twp Rge East West

\_\_\_\_\_ Surface Water.....Ft North from Southeast Corner  
(Stream,pond etc).....Ft West from Southeast Corner  
Sec Twp Rge East West

\_\_\_\_\_ Other (explain).....  
(purchased from city, R.W.D. #)

Operator: License # 3750  
Name Turnpike Oil Company  
Address 5810 W. 38th Ave. Ste. 12  
Denver, CO 80212  
City/State/Zip

Purchaser Clear Creek, Inc.

Operator Contact Person Virgil E. Balke  
Phone 303 431-4842

Contractor: License # 6033  
Name Murfin Drilling Company

Wellsite Geologist Ric Morgan  
Phone 303 988-1439

Designate Type of Completion  
 New Well \_\_\_\_\_ Re-Entry \_\_\_\_\_ Workover  
 Oil \_\_\_\_\_ SWD \_\_\_\_\_ Temp Abd  
\_\_\_\_\_ Gas \_\_\_\_\_ Inj \_\_\_\_\_ Delayed Comp.  
\_\_\_\_\_ Dry \_\_\_\_\_ Other (Core, Water Supply etc.)

If OWWO: old well info as follows:  
Operator .....  
Well Name .....  
Comp. Date ..... Old Total Depth.....

WELL HISTORY

Drilling Method:  
 Mud Rotary \_\_\_\_\_ Air Rotary \_\_\_\_\_ Cable  
8-3-88 8-10-88 9-1-88  
Spud Date Date Reached TD Completion Date  
4250' 4233'  
Total Depth PBTD

Amount of Surface Pipe Set and Cemented at 304 feet  
Multiple Stage Cementing Collar Used? Yes  No  
If yes, show depth set.....feet  
If alternate 2 completion, cement circulated  
from 4249 feet depth to 1735 w/ 385 SX cmt  
Cement Company Name Halliburton Services  
Invoice # 614643

INSTRUCTIONS: This form shall be completed in triplicate and filed with the Kansas Corporation Commission, 200 Colorado Derby Building, Wichita, Kansas 67202, within 120 days of the spud date of any well. Rule 82-3-130, 82-3-107 and 82-3-106 apply. Information on side two of this form will be held confidential for a period of 12 months if requested in writing and submitted with the form. See rule 82-3-107 for confidentiality in excess of 12 months. One copy of all wireline logs and drillers time log shall be attached with this form. Submit CP-4 form with all plugged wells. Submit CP-111 form with all temporarily abandoned wells.

All requirements of the statutes, rules and regulations promulgated to regulate the oil and gas industry have been fully complied with and the statements herein are complete and correct to the best of my knowledge.

Signature Virgil E. Balke  
Title Vice President Date 10-31-88

Subscribed and sworn to before me this 31st day of October 1988  
Notary Public Mary B. Clark, Notary Public  
Date Commission Expires 6-20-89

K.C.C. OFFICE USE ONLY  
F Letter of Confidentiality Attached  
C  Wireline Log Received  
C  Drillers Time log Received  
Distribution  
 KCC \_\_\_\_\_ SWD/Rep \_\_\_\_\_ NGPA  
 KGS \_\_\_\_\_ Plug \_\_\_\_\_ Other  
(Specify)  
11-2-88 X 14

Sec 36 Twp 1 S Rge 34 E

SIDE TWO

Operator Name Turnpike Oil Company Lease Name Horinek Well # 1-36

Sec. 36 Twp. 1S Rge. 34W  East  West County Rawlins

WELL LOG

INSTRUCTIONS: Show important tops and base of formations penetrated. Detail all cores. Report all drill stem tests giving interval tested, time tool open and closed, flowing and shut-in pressures, whether shut-in pressure reached static level, hydrostatic pressures, bottom hole temperature, fluid recovery, and flow rates if gas to surface during test. Attach extra sheet if more space is needed. Attach copy of log.

Drill Stem Tests Taken  Yes  No  
 Samples Sent to Geological Survey  Yes  No  
 Cores Taken  Yes  No

Formation Description  
 Log  Sample

DST #1: 3920-3984' 30-60-60-120  
 Rec 100' wtry M - 60' mdy W & 120' W  
 IHP 2026 FHP 2026 IFP 47-85 FFP 104-152  
 ISI 1203 FSI 1193

| Name       | Top  | Bottom |
|------------|------|--------|
| Anhydrite  | 2868 | 2903   |
| Topeka     | 3793 |        |
| Deer Creek | 3825 |        |
| Oread      | 3900 |        |
| Lansing    | 3973 |        |

DST #2 3986-4036' 30-60-60-120  
 Rec 80' GIP - 80' cl. 0 - 80' OCM (40% 0) - 60' OC  
 wtry M (10% 0) - 120' 0 sptd mdy W  
 IHP 2103 FHP 2084 IFP 47-85 FFP 104-152 ISI 1126  
 FSI 1097

DST #3 4040-4085' 30-60-60-120  
 Rec 80' GIP - 35' 0 - 65' OCM (15% 0) - 60' OCM  
 2% 0)  
 IHP 2123 FHP 2123 IFP 28-38 FFP 47-66 ISI 1279  
 FSI 1270

DST #4 4120-4170' 30-60-30-90  
 Rec 80' 0 sptd mdy wtr IHP 2152 FHP 2142 IFP 19-28  
 FFP 47-57 ISI 1289 FSI 1279

| CASING RECORD <input checked="" type="checkbox"/> New <input type="checkbox"/> Used |                   |                           |                |               |                  |             |                            |
|---|-------------------|---------------------------|----------------|---------------|------------------|-------------|----------------------------|
| Report all strings set-conductor, surface, intermediate, production, etc.           |                   |                           |                |               |                  |             |                            |
| Purpose of String   | Size Hole Drilled | Size Casing Set (in O.D.) | Weight Lbs/Ft. | Setting Depth | Type of Cement   | #Sacks Used | Type and Percent Additives |
| Surface   | 12 1/4"           | 8 5/8"                    |                | 304'          | 60-40 POZ        | 200         | 3% CC                      |
| Production  | 7 7/8"            | 4 1/2"                    | 10.5#          | 4249'         | 60-40 POZ<br>HDL | 200<br>185  | 2% gel 18% salt            |

| PERFORATION RECORD |   | Acid, Fracture, Shot, Cement Squeeze Record |          |
|--------------------|---|---|----------|
| Shots Per Foot     | Specify Footage of Each Interval Perforated | (Amount and Kind of Material Used)          | Depth    |
| 4                  | 4158-4161'                                  | 1850 gals 15% HCL NE                        | 4158-61' |
| 4                  | 4070-4077'                                  | 1350 gals 15% HCL NE                        | 4070-77' |

| TUBING RECORD |        |           |   |
|---------------|--------|-----------|---|
| Size          | Set At | Packer at | Liner Run <input type="checkbox"/> Yes <input checked="" type="checkbox"/> No |
| 2 3/8"        | 4151'  | None      |   |

| Date of First Production | Producing Method   |  |  |  |
|--------------------------|--|--|--|--|
| 9/1/88                   | <input type="checkbox"/> Flowing <input checked="" type="checkbox"/> Pumping <input type="checkbox"/> Gas Lift <input type="checkbox"/> Other (explain)..... |  |  |  |

| Estimated Production Per 24 Hours | Oil    | Gas   | Water  | Gas-Oil Ratio | Gravity |
|-----------------------------------|--------|-------|--------|---------------|---------|
|                                   | 8 Bbls | 0 MCF | 9 Bbls | CFPB 31.3°    |         |

METHOD OF COMPLETION

Production Interval

Disposition of gas:  Vented  Open Hole  Perforation 4070-4161'  
 Sold  Other (Specify) .....  
 Used on Lease  Dually Completed .....  
 Commingled