

STATE OF KANSAS
STATE CORPORATION COMMISSION

15-153-20304-00-00

WELL PLUGGING RECORD

Give All Information Completely
Make Required Affidavit
Mail or Deliver Report to
Conservation Division
State Corporation Comm.
245 North Water
Wichita, KS 67202

Rawlins County. Sec. 34 Twp. 1 S Rge. 36 ~~E/W~~
Location as "NE/CNW $\frac{1}{4}$ SW $\frac{1}{4}$ " or footage from lines
C NE NW

Lease Owner Abercrombie Drilling, Inc.
Lease Name WILKINSON Well No. 1
Office Address 801 Union Center, Wichita, Kansas 67202
Character of Well (Completed as Oil, Gas or Dry Hole)
Dry Hole

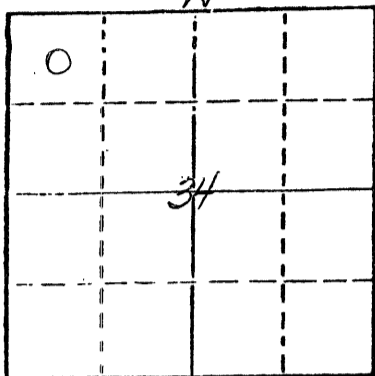

Locate well correctly on above
Section Plat

Date Well completed Oct. 28, 1977
Application for plugging filed (verbally) Oct. 28, 1977
Application for plugging approved (verbally) Oct. 28, 1977
Plugging commenced Oct. 28, 1977
Plugging completed Oct. 28, 1977
Reason for abandonment of well or producing formation
No commercial quantity of oil or gas encountered
If a producing well is abandoned, date of last production
19

Was permission obtained from the Conservation Division or
its agents before plugging was commenced? Yes

Name of Conservation Agent who supervised plugging of this well Gilbert Balthazor
Producing formation _____ Depth to top _____ Bottom _____ Total Depth of Well 4938
Show depth and thickness of all water, oil and gas formations.

OIL, GAS OR WATER RECORDS

CASING RECORD

FORMATION	CONTENT	FROM	TO	SIZE	PUT IN	PULLED OUT

Describe in detail the manner in which the well was plugged, indicating where the mud fluid
was placed and the method or methods used in introducing it into the hold. If cement or other
plugs were used, state the character of same and depth placed, from _____ feet to
_____ feet for each plug set.

Set 1st plug at 2000' with 70 sacks
2nd plug at 240' with 20 sacks
3rd plug at 40' with 10 sacks
Cemented with 50/50 posmix, 6% gel.
Plug was down at 5:00 pm, October 28, 1977

RECEIVED
OCT 31 1977
NOV 01 1977
CONSERVATION DIVISION
WICHITA, KANSAS

(If additional description is necessary, use BACK of this sheet)

Name of Plugging Contractor Abercrombie Drilling, Inc.

STATE OF Kansas COUNTY OF Sedgwick, ss.
Jack L. Partridge, Ass't. Secretary-Treasurer (employee of owner) or (owner or operator)
of the above-described well, being first duly sworn on oath, says: That I have knowledge of
the facts, statements, and matters herein contained and the log of the above-described well
as filed and that the same are true and correct. So help me God.

(Signature) Jack L. Partridge
801 Union Center, Wichita, Kansas 67202
(Address)

SUBSCRIBED AND SWORN TO before me this 31st day of October, 1977



Sandra Richman
Sandra Richman Notary Public.

My commission expires July 21, 1979

KANSAS DRILLERS LOG

API No. 15 — 153-20304-00-00
County Number

S. 34 T. 1S R. 36 ^W
 Loc. C NE NW
 County Rawlins

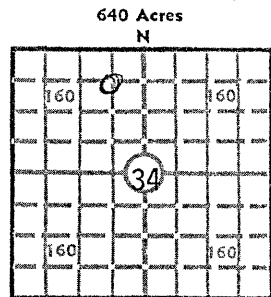

640 Acres
 N
 Locate well correctly
 Elev.: Gr. 3232
 DF 3235 KB 3237

Operator
Abercrombie Drilling, Inc.

Address
801 Union Center, Wichita, Kansas 67202

Well No. 1 Lease Name WILKINSON

Footage Location
feet from (N) (S) line feet from (E) (W) line

Principal Contractor Abercrombie Drilling, Inc. Geologist Jerry A. Langrehr

Spud Date October 18, 1977 Total Depth 4938 P.B.T.D.
 Date Completed October 28, 1977 Oil Purchaser -----

CASING RECORD

Report of all strings set — surface, intermediate, production, etc.

Purpose of string	Size hole drilled	Size casing set (in O.D.)	Weight lbs/ft.	Setting depth	Type cement	Sacks	Type and percent additives
Surface	12 1/4"	8-5/8"		254 KB	Common	200	2% gel 3% CaCl

LINER RECORD

PERFORATION RECORD

Top, ft.	Bottom, ft.	Sacks cement	Shots per ft.	Size & type	Depth interval

TUBING RECORD

Size	Setting depth	Packer set at

ACID, FRACTURE, SHOT, CEMENT SQUEEZE RECORD

Amount and kind of material used	Depth interval treated

RECEIVED
 STATE CORPORATION COMMISSION
 NOV 01 1977
 CONSERVATION DIVISION

INITIAL PRODUCTION

Date of first production _____ Producing method (flowing, pumping, gas lift, etc.) _____

RATE OF PRODUCTION PER 24 HOURS	Oil	Gas	Water	Gas-oil ratio
	bbls.	MCF	bbls.	CFPB

Disposition of gas (vented, used on lease or sold) _____ Producing interval (s) _____

INSTRUCTIONS: As provided in KCC Rule 82-2-125, within 90 days after completion of a well, one completed copy of this Drillers Log shall be transmitted to the State Geological Survey of Kansas, 4150 Monroe Street, Wichita, Kansas 67209. Copies of this form are available from the Conservation Division, State Corporation Commission, 3830 So. Meridian (P.O. Box 17027), Wichita, Kansas 66217. Phone AC 316-522-2206. If confidential custody is desired, please note Rule 82-2-125. Drillers Logs will be on open file in the Oil and Gas Division, State Geological Survey of Kansas, Lawrence, Kansas 66044.

Operator

Abercrombie Drilling, Inc.

15-153-20304-00-00

DESIGNATE TYPE OF COMP.: OIL, GAS,
DRY HOLE, SWDW, ETC.:

Dry Hole

Well No.

1

Lease Name

S 34 T 15 R 36 ^{EX}_W

WELL LOG

Show all important zones of porosity and contents thereof; cored intervals, and all drill-stem tests, including depth interval tested, cushion used, time tool open, flowing and shut-in pressures, and recoveries.

SHOW GEOLOGICAL MARKERS, LOGS RUN,
OR OTHER DESCRIPTIVE INFORMATION.

FORMATION DESCRIPTION, CONTENTS, ETC.	TOP	BOTTOM	NAME	DEPTH
Surface clay	0	135	SAMPLE TOPS:	
Sand & clay	135	230		
Shale	230	2010	Anhydrite	3000 (+327)
Shale & sand	2010	2470	B/Anhydrite	3029 (+208)
Sand & shale	2470	2526	Oread	4061 (-834)
Shale & sand	2526	3000	Lansing	4185 (-948)
Anhydrite	3000	3029	B/KC	4466 (-1229)
Shale & lime	3029	3221	Fort Scott	4598 (-1361)
Lime & shale	3221	3470	Cherokee	4629 (-1392)
Shale & lime	3470	3705		
Lime & shale	3705	3975	ELECTRIC LOG TOPS:	
Lime	3975	4395		
Lime & shale	4395	4461	Anhydrite	3146 (+91)
Lime	4461	4638	B/Anhydrite	3176 (+61)
Lime & shale	4638	4754	Oread	4094 (-857)
Lime	4754	4938	Lansing	4184 (-947)
Rotary Total Depth		4938	B/KC	4471 (-1234)
			Fort Scott	4599 (-1362)
DST#1 (4130-4200) 30", 45", 60", 45". Fair blow. slightly oil specked mud, 186' muddy water. IFP IBHP 1212, FFP 120-163, FBHP 970.		Rec. 62' 65-109,	Cherokee	4626 (-1389)
DST#2 (4208-4255) 30", 45", 60", 45". Strong blow. 2250' gc&socsw. IFP 272-651, IBHP 1338, FFP 682-FBHP 1317.		Rec. 1086,	Mississippi	4859 (-1622)
DST#3 (4348-4395) 30", 45", 60", 45". Fair blow. gip, 15' free oil, 60' hocm - 25% oil, 75% mud, 5% oil, 95% mud. IFP 32-43, IBHP 1317, FFP 54-87, FBHP 1264.		Rec. 124' 62' ocm -	ELTD	4938 (-1701)
			RTD	4938 (-1701)

USE ADDITIONAL SHEETS, IF NECESSARY, TO COMPLETE WELL RECORD.

Date Received

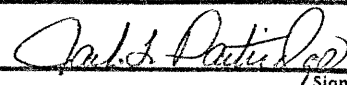

Signature

Jack L. Partridge, Ass't. Secretary-Treasurer

Title

October 31, 1977

Date

RECEIVED
STATE CORPORATION COMMISSION
NOV 01 1977
CONSERVATION DIVISION
Wichita, Kansas