

STATE CORPORATION COMMISSION OF KANSAS
OIL & GAS CONSERVATION DIVISION

WELL COMPLETION OR RECOMPLETION FORM
ACO-1 WELL HISTORY

DESCRIPTION OF WELL AND LEASE

API NO. 15-147-20-481-00-00
County Phillips
SE NE NW Sec. 24 Twp. 2S Rge. 19 East West
4290 Ft North from Southeast Corner of Section
2970 Ft West from Southeast Corner of Section
(Note: Locate well in section plat below)
Lease Name BACH "A" Well # 1
Field Name Huffstutler
Producing Formation L-KC "I" "F" "C" & Toronto
Elevation: Ground 2126' KB 2131'

Operator: License # 5171
Name TXO PRODUCTION CORP.
Address 155 N. Market Suite 1000
City/State/Zip Wichita, KS 67202

Operator Contact Person Eldon S. West III
Phone (316) 265-9441 Ext. 278

Contractor: License # 5122
Name Woodman-Jannitti

Wellsite Geologist Gary Holstin
Phone (316) 788-4570

PURCHASER Permian Oil
Houston, Texas

Designate Type of Completion
 New Well Re-Entry Workover
 Oil Gas Dry
 SWD Inj Other (Core, Water Supply etc.)
 Temp Abd Delayed Comp.

If OWWO: old well info as follows:
Operator N/A
Well Name N/A
Comp. Date N/A Old Total Depth N/A

WELL HISTORY

Drilling Method: Mud Rotary Air Rotary Cable
7-24-85 7-29-85 8-23-85
Spud Date Date Reached TD Completion Date
3516' 3485'
Total Depth PBTD
Amount of Surface Pipe Set and Cemented at 217 feet
Multiple Stage Cementing Collar Used? Yes No
If yes, show depth set 1696 feet
If alternate 2 completion, cement circulated from 1696 feet depth to Surf w/ 450 SX cmt

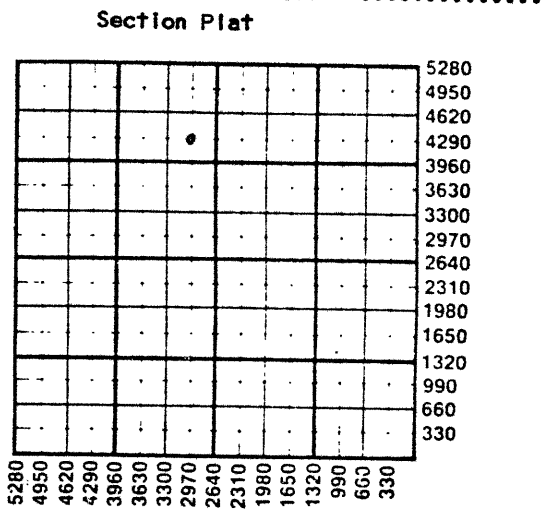

WATER SUPPLY INFORMATION

Source of Water:
Division of Water Resources Permit # N/A
 Groundwater N/A Ft North from Southeast Corner (Well) N/A Ft West from Southeast Corner of Sec Twp Rge East West
 Surface Water Ft North from Southeast Corner (Stream, pond etc) Ft West from Southeast Corner Sec Twp Rge East West
 Other (explain) N/A (purchased from city, R.W.D.#)
Disposition of Produced Water: Disposal Repressuring
Docket # N/A

INSTRUCTIONS: This form shall be completed in duplicate and filed with the Kansas Corporation Commission, 200 Colorado Derby Building, Wichita, Kansas 67202, within 90 days after completion or recompletion of any well. Rule 82-3-130 and 82-3-107 apply. Information on side two of this form will be held confidential for a period of 12 months if requested in writing and submitted with the form. See rule 82-3-107 for confidentiality in excess of 12 months. One copy of all wireline logs and drillers time log shall be attached with this form. Submit CP-4 form with all plugged wells. Submit CP-111 form with all temporarily abandoned wells.

All requirements of the statutes, rules and regulations promulgated to regulate the oil and gas industry have been fully complied with and the statements herein are complete and correct to the best of my knowledge.

Signature Bill Coffey
Title District Geologist Date 5-16-86

Subscribed and sworn to before me this 16th day of May 1986

Notary Public Carolyn J. Huston
Date Commission Expires 3-5-90
STATE CORPORATION COMMISSION

K.C.C. OFFICE USE ONLY
 Letter of Confidentiality Attached
 Wireline Log Received
 Drillers Timelog Received
Distribution
 KCC SWD/Rep NGPA
 KGS Plug Other (Specify)

MAY 19 1986
5-19-86
CONSERVATION DIVISION
Wichita, Kansas

SIDE TWO

Operator Name TXO PRODUCTION Lease Name BACH "A" Well# 1 SEC. 24 TWP. 2S RGE. 19 East West

WELL LOG

INSTRUCTIONS: Show important tops and base of formations penetrated. Detail all cores. Report all drill stem tests giving interval tested, time tool open and closed, flowing and shut-in pressures, whether shut-in pressure reached static level, hydrostatic pressures, bottom hole temperature, fluid recovery, and flow rates if gas to surface during test. Attach extra sheet if more space is needed. Attach copy of log.

Drill Stem Tests Taken Yes No
 Samples Sent to Geological Survey Yes No
 Cores Taken Yes No

Formation Description
 Log Sample

DST #1, 3243-55', (Toronto) w/results:
 IFP/30"=21-31#, fair blow
 ISIP/60"=1019#
 FFP/45"=54-96#, good blow
 FSIP/90"=1019#
 Rec: 216' GIP + 174' CO + 42' MCO

Ran O.H. Logs

Name	Top	Bottom
Heebner	3214	-1083
Toronto	3241	-1110
"A"	3260	-1129
"C"	3295	-1164
"D"	3314	-1183
"F"	3330	-1199
"G"	3349	-1218
"H"	3386	-1255
"I"	3409	-1278
"J"	3426	-1295
"K"	3451	-1320
"L"	3473	-1342
LTD	3516'	
DTD	3516'	
PBD	3485'	

CASING RECORD New Used
 Report all strings set-conductor, surface, intermediate, production, etc.

Purpose of String	Size Hole Drilled	Size Casing Set (in O.D.)	Weight Lbs/Ft.	Setting Depth	Type of Cement	#Sacks Used	Type and Percent Additives
Surface	12-1/4"	8-5/8"	23#	217'	Class A	175 sx	
Production		4-1/2"	10.5#	3315'	Class A	175 sx	75% CFR-2 dens

Shots Per Foot	Specify Footage of Each Interval Perforated	Acid, Fracture, Shot, Cement Squeeze Record (Amount and Kind of Material Used)	Depth
4/JSPF	3413-16 & 3334-38'	Acidized w/500 gals. @ 1/2 BPM	3413-16
4/JSPF	3296-98 & 3243-46'		3296-98
		Treated "C" zone w/500 gals. 15% MCA acid	

TUBING RECORD Size 2-3/8" Set At 3472 Packer at
 Liner Run Yes No

Date of First Production 8-24-85
 Producing Method Flowing Pumping Gas Lift Other (explain).....

Estimated Production Per 24 Hours	Oil Bbls	Gas MCF	Water Bbls	Gas-Oil Ratio	Gravity
	157 BO	N/A	0 BW		

METHOD OF COMPLETION Production Interval

Disposition of gas: Vented Open Hole Perforation
 Sold Other (Specify) 3413-16'
 Used on Lease Dually Completed 3334-38'
 Commingled 3296-98'
 3243-46'