

For KCC Use: 6-23-04
Effective Date: _____
District # _____
SGA? Yes No

KANSAS CORPORATION COMMISSION
OIL & GAS CONSERVATION DIVISION

Form C-1

December 2002

Form must be Typed

Form must be Signed

All blanks must be Filled

NOTICE OF INTENT TO DRILL

Must be approved by KCC five (5) days prior to commencing well

Expected Spud Date September 13 2004
month day year

Spot NW SE SW Sec. 10 Twp. 22 S. R. 32 East West
1250 feet from N / S Line of Section
1650 feet from E / W Line of Section

OPERATOR: License# 5317 632105
Name: Russell Freeman d/b/a Continental Energy
Address: P.O. Box 918
City/State/Zip: Garden City, KS 67846
Contact Person: Russell Freeman/Jeff Kidd
Phone: (620) 276-8710

RECEIVED

JUN 22 2004

CONTRACTOR: License# 5382-33375 KCC WICHITA
Name: Cheyenne Drilling

Is SECTION Regular Irregular?
(Note: Locate well on the Section Plat on reverse side)

County: Finney
Lease Name: Anna Miller Well #: 1-10
Field Name: Hugoton

Is this a Prorated / Spaced Field? Yes No

Target Formation(s): Chase

Nearest Lease or unit boundary: 1250'

Ground Surface Elevation: 2933' feet MSL

Water well within one-quarter mile: Yes No

Public water supply well within one mile: Yes No

Depth to bottom of fresh water: 200

Depth to bottom of usable water: 1280

Surface Pipe by Alternate: 1 2 1280' min

Length of Surface Pipe Planned to be set: please advise of required depth

Length of Conductor Pipe required: NONE

Projected Total Depth: 2760'

Formation at Total Depth: Chase (Winfield)

Water Source for Drilling Operations: Well Farm Pond Other Trucked

DWR Permit #: _____

(Note: Apply for Permit with DWR)

Will Cores be taken? Yes No

If Yes, proposed zone: _____

Well Drilled For: Well Class: Type Equipment
 Oil Enh Rec Infield Mud Rotary
 Gas Storage Pool Ext. Air Rotary
 QWO Disposal Wildcat Cable
 Seismic; # of Holes Other
 Other Replacement well

If OWWO: old well information as follows:
Operator: _____
Well Name: _____
Original Completion Date: _____ Original Total Depth: ✓

Directional, Deviated or Horizontal wellbore? Yes No

If Yes, true vertical depth: _____

Bottom Hole Location: _____

KCC DKT #: _____

* Prorated & Spaced Hugoton

AFFIDAVIT

The undersigned hereby affirms that the drilling, completion and eventual plugging of this well will comply with K.S.A. 55 et. seq.

It is agreed that the following minimum requirements will be met:

1. Notify the appropriate district office **prior** to spudding of well;
2. A copy of the approved notice of intent to drill **shall be** posted on each drilling rig;
3. The minimum amount of surface pipe as specified below **shall be set** by circulating cement to the top; in all cases surface pipe **shall be set** through all unconsolidated materials plus a minimum of 20 feet into the underlying formation.
4. If the well is dry hole, an agreement between the operator and the district office on plug length and placement is necessary **prior to plugging**;
5. The appropriate district office will be notified before well is either plugged or production casing is cemented in;
6. If an ALTERNATE II COMPLETION, production pipe shall be cemented from below any usable water to surface within **120 days** of spud date. Or pursuant to Appendix "B" - Eastern Kansas surface casing order #133,891-C, which applies to the KCC District 3 area, alternate II cementing must be completed within 30 days of the spud date or the well shall be plugged. **In all cases, NOTIFY district office** prior to any cementing.

I hereby certify that the statements made herein are true and to the best of my knowledge and belief.

Date: 6-18-04 Signature of Operator or Agent: [Signature] Title: Production Supervisor

For KCC Use ONLY
API # 15 - 055-21841-00-00
Conductor pipe required NONE feet
Minimum surface pipe required 1280 feet per Alt. ①
Approved by: RJP 6-23-04
This authorization expires: 12-23-04
(This authorization void if drilling not started within 6 months of effective date.)
Spud date: _____ Agent: _____

Remember to:

- File Drill Pit Application (form CDP-1) with Intent to Drill;
- File Completion Form ACO-1 within 120 days of spud date;
- File acreage attribution plat according to field proration orders;
- Notify appropriate district office 48 hours prior to workover or re-entry;
- Submit plugging report (CP-4) after plugging is completed;
- Obtain written approval before disposing or injecting salt water.
- If this permit has expired (See: authorized expiration date) please check the box below and return to the address below.

Well Not Drilled - Permit Expired

Signature of Operator or Agent: _____

Date: _____

Mail to: KCC - Conservation Division, 130 S. Market - Room 2078, Wichita, Kansas 67202

10
22
32W

IN ALL CASES PLOT THE INTENDED WELL ON THE PLAT BELOW

Plat of acreage attributable to a well in a prorated or spaced field

If the intended well is in a prorated or spaced field, please fully complete this side of the form. If the intended well is in a prorated or spaced field complete the plat below showing that the well will be properly located in relationship to other wells producing from the common source of supply. Please show all the wells and within 1 mile of the boundaries of the proposed acreage attribution unit for gas wells and within 1/2 mile of the boundaries of the proposed acreage attribution unit for oil wells.

API No. 15 - _____
 Operator: Russell Freeman d/b/a Continental Energy
 Lease: Anna Miller
 Well Number: 1-10
 Field: Hugoton

Location of Well: County: Finney
 1250 _____ feet from N / S Line of Section
 1650 _____ feet from E / W Line of Section
 Sec. 10 Twp. 22 S. R. 32 East West

Number of Acres attributable to well: 642.8
 QTR / QTR / QTR of acreage: NW SE SW

Is Section: Regular or Irregular

If Section is Irregular, locate well from nearest corner boundary.

Section corner used: NE NW SE SW

RECEIVED
 JUN 22 2004
 KCC WICHITA

*Now Contiguous Unit
 Granted 04-Cons-129-CALL 3-26-04
 PLAT*

*(Show location of the well and shade attributed acreage for prorated or spaced wells.)
 (Show footage to the nearest lease or unit boundary line.)*

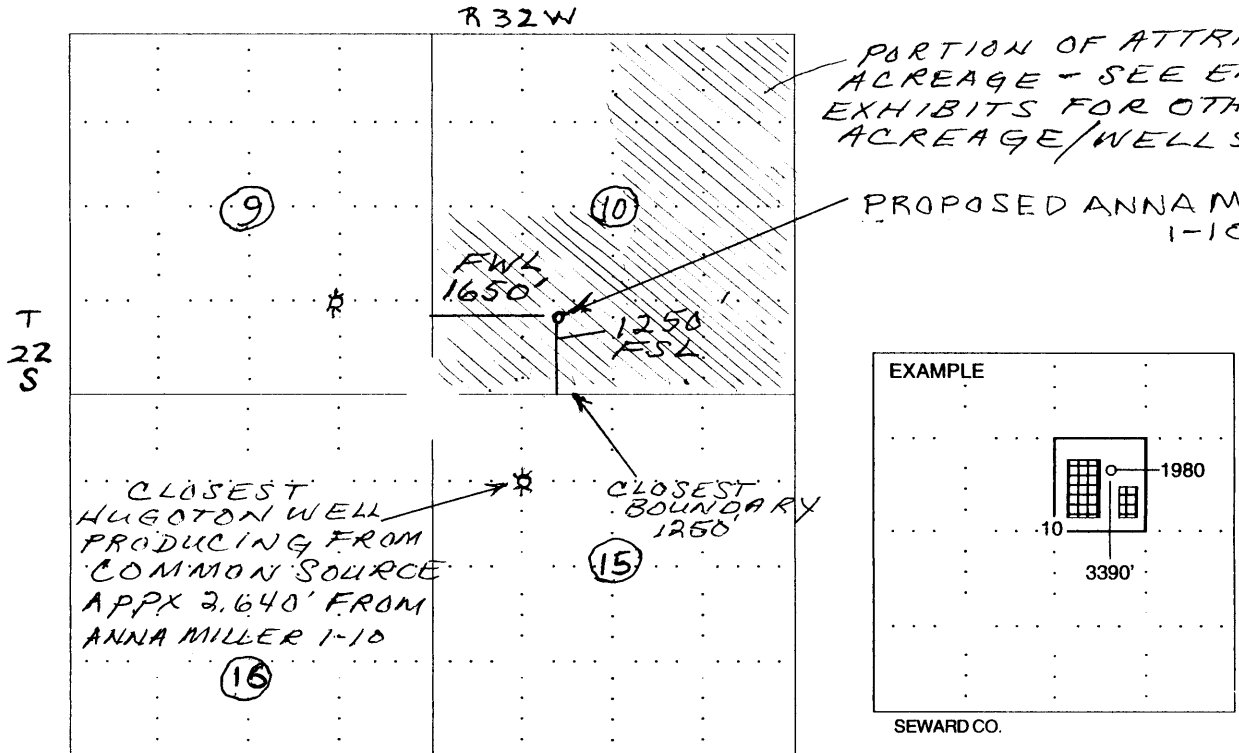

NOTE: In all cases locate the spot of the proposed drilling location.

In plotting the proposed location of the well, you must show:

1. The manner in which you are using the depicted plat by identifying section lines, i.e. 1 section, 1 section with 8 surrounding sections, 4 sections, etc.
2. The distance of the proposed drilling location from the section's south / north and east / west.
3. The distance to the nearest lease or unit boundary line.
4. If proposed location is located within a prorated or spaced field a certificate of acreage attribution plat must be attached: (CO-7 for oil wells; CG-8 for gas wells).