

LOCATION RESURVEYED <sup>F1257</sup> **CORRECTED**

RECEIVED

For KCC Use: 12.5.03  
Effective Date: 3  
District #: 3  
SGA?  Yes  No

KANSAS CORPORATION COMMISSION  
OIL & GAS CONSERVATION DIVISION

DEC 03 2003

Form C-1  
December 2002  
Form must be Typed  
Form must be Signed  
blanks must be Filled

**NOTICE OF INTENT TO DRILL KCC WICHITA**

Must be approved by KCC five (5) days prior to commencing well

Expected Spud Date December 10, 2003  
month day year

Spot SE NE SE SE Sec. 36 Twp. 32 S. R. 10  East  West  
770 feet from  N /  S Line of Section  
65 feet from  E /  W Line of Section  
Is SECTION  Regular  Irregular?

OPERATOR: License# 31834  
Name: Consolidated Gas and Energy  
Address: c/o Rte 2 Box 225  
City/State/Zip: Neodesha, Ks 66757  
Contact Person: J.J. Hanke  
Phone: 620) 325-5212

(Note: Locate well on the Section Plat on reverse side)  
County: Chautauqua  
Lease Name: Arrington "5" Well #: CGEV#1  
Field Name: Floyd Landon

CONTRACTOR: License# 8736  
Name: James D. Dixon

Is this a Prorated / Spaced Field?  Yes  No  
Target information(s): Mississippi  
Nearest Lease or unit boundary: 2700' (Unit Aft)

Well Drilled For: Well Class: Type Equipment:  
 Oil  Enh Rec  Infield  Mud Rotary  
 Gas  Storage  Pool Ext.  Air Rotary  
 OWWO  Disposal  Wildcat  Cable  
 Seismic; # of Holes  Other  
 Other

Ground Surface Elevation: 1120' feet MSL  
Water well within one-quarter mile:  Yes  No  
Public water supply well within one mile:  Yes  No

If OWWO: old well information as follows:  
Operator: \_\_\_\_\_  
Well Name: \_\_\_\_\_  
Original Completion Date: \_\_\_\_\_ Original Total Depth: \_\_\_\_\_

Depth to bottom of fresh water: 120'  
Depth to bottom of usable water: ~~200~~ 300'  
Surface Pipe by Alternate:  1  2  
Length of Surface Pipe Planned to be set: 65'

Directional, Deviated or Horizontal wellbore?  Yes  No

Length of Conductor Pipe required: - -  
Projected Total Depth: 2500'  
Formation at Total Depth: Mississippi

If Yes, true vertical depth: \_\_\_\_\_

Water Source for Drilling Operations:  
 Well  Farm Pond Other \_\_\_\_\_

Bottom Hole Location: \_\_\_\_\_

DWR Permit #: \_\_\_\_\_

KCC DKT #: \_\_\_\_\_

(Note: Apply for Permit with DWR )  
Will Cores be taken?  Yes  No

WELLNAME  
WAS: CGEH#1 IS: CGEV#1

If Yes, proposed zone: \_\_\_\_\_

AFFIDAVIT \* LOCATION WAS: 10' FSL, 10' FEL  
IS: 770' FSL, 65' FEL

The undersigned hereby affirms that the drilling, completion and eventual plugging of this well will comply with K.S.A. 55 et. seq.

SPOT WAS: SE SE SE  
SPOTS: SE NE SE SE

It is agreed that the following minimum requirements will be met:

1. Notify the appropriate district office **prior** to spudding of well;
2. A copy of the approved notice of intent to drill **shall be** posted on each drilling rig;
3. The minimum amount of surface pipe as specified below **shall be set** by circulating cement to the top; in all cases surface pipe **shall be set** through all unconsolidated materials plus a minimum of 20 feet into the underlying formation.
4. If the well is dry hole, an agreement between the operator and the district office on plug length and placement is necessary **prior to plugging**;
5. The appropriate district office will be notified before well is either plugged or production casing is cemented in;
6. If an ALTERNATE II COMPLETION, production pipe shall be cemented from below any usable water to surface within **120 days** of spud date. Or pursuant to Appendix "B" - Eastern Kansas surface casing order #133,891-C, which applies to the KCC District 3 area, alternate II cementing must be completed within 30 days of the spud date or the well shall be plugged. **In all cases, NOTIFY district office** prior to any cementing.

I hereby certify that the statements made herein are true and to the best of my knowledge and belief.

Date: Dec 1, 03 Signature of Operator or Agent: J. Hanke Title: Consultant

**For KCC Use ONLY**  
API # 15 - 019-26615-00-00  
Conductor pipe required NONE feet  
Minimum surface pipe required 40 feet per Alt. \* (2)  
Approved by: RJP 12.5.03/KSP 6.17.04  
This authorization expires: 6.5.04  
(This authorization void if drilling not started within 6 months of effective date.)  
Spud date: \_\_\_\_\_ Agent: \_\_\_\_\_

- Remember to:
- File Drill Pit Application (form CDP-1) with Intent to Drill;
  - File Completion Form ACO-1 within 120 days of spud date;
  - File acreage attribution plat according to field proration orders;
  - Notify appropriate district office 48 hours prior to workover or re-entry;
  - Submit plugging report (CP-4) after plugging is completed;
  - Obtain written approval before disposing or injecting salt water.
- If this permit has expired (See: authorized expiration date) please check the box below and return to the address below.  
 Well Not Drilled - Permit Expired  
Signature of Operator or Agent: \_\_\_\_\_  
Date: \_\_\_\_\_

36  
32  
10E

Mail to: KCC - Conservation Division, 130 S. Market - Room 2078, Wichita, Kansas 67202

\* LOCATION RE-SURVEY PER KCCDIST.3 REQUEST \*

**IN ALL CASES PLOT THE INTENDED WELL ON THE PLAT BELOW**

*Plat of acreage attributable to a well in a prorated or spaced field*

**If the intended well is in a prorated or spaced field, please fully complete this side of the form.** If the intended well is in a prorated or spaced field complete the plat below showing that the well will be properly located in relationship to other wells producing from the common source of supply. Please show all the wells and within 1 mile of the boundaries of the proposed acreage attribution unit for gas wells and within 1/2 mile of the boundaries of the proposed acreage attribution unit for oil wells.

API No. 15 - \_\_\_\_\_  
 Operator: Consolidated Gas and Energy  
 Lease: Arrington "5"  
 Well Number: ~~CGEV#1~~ CGEV#1  
 Field: Floyd Landon  
 Number of Acres attributable to well: 80  
 QTR / QTR / QTR of acreage: SE SE SE

Location of Well: County: Chautauqua  
10 feet from  N /  S Line of Section  
10 feet from  E /  W Line of Section  
 Sec. 36 Twp. 32 S. R. 10  East  West  
 Is Section:  Regular or  Irregular  
**If Section is Irregular, locate well from nearest corner boundary.**  
 Section corner used:  NE  NW  SE  SW

**PLAT**

*(Show location of the well and shade attributable acreage for prorated or spaced wells.)*

*(Show footage to the nearest lease or unit boundary line.)*

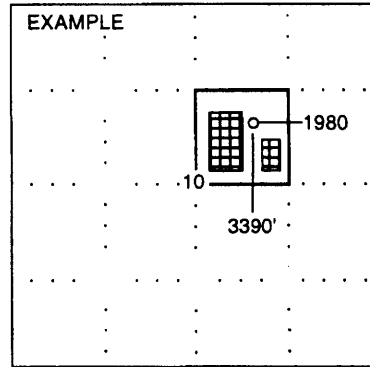
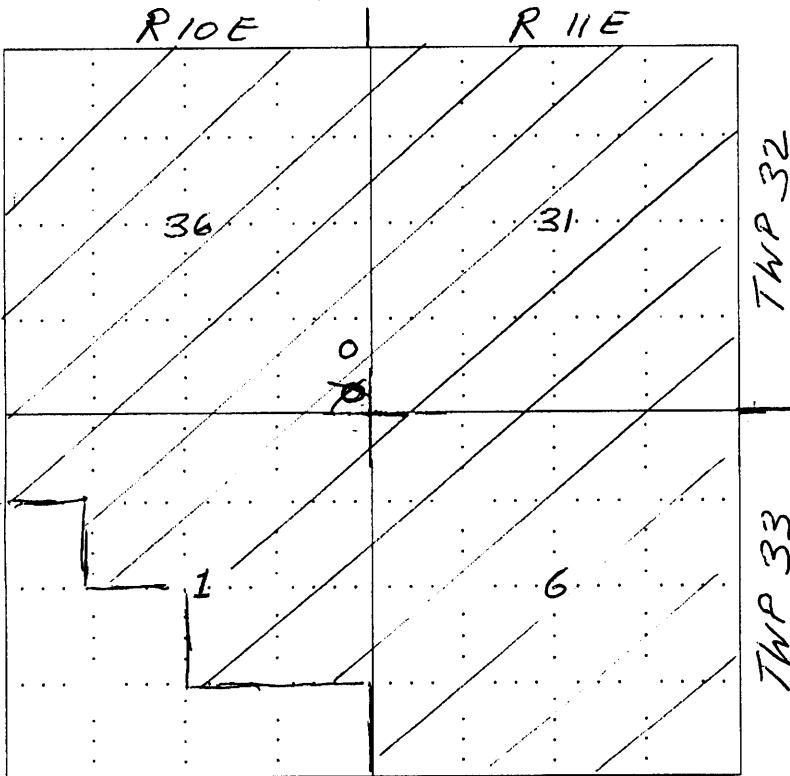

**NOTE: In all cases locate the spot of the proposed drilling location.**

**In plotting the proposed location of the well, you must show:**

1. The manner in which you are using the depicted plat by identifying section lines, i.e. 1 section, 1 section with 8 surrounding sections, 4 sections, etc.
2. The distance of the proposed drilling location from the section's south / north and east / west.
3. The distance to the nearest lease or unit boundary line.
4. If proposed location is located within a prorated or spaced field a certificate of acreage attribution plat must be attached: (CO-7 for oil wells; CG-8 for gas wells).