

KCC OIL/GAS REGULATORY OFFICES

Date: 06/08/16

District: 02

Case #: _____

- New Situation
- Response to Request
- Follow-Up

- Lease Inspection
- Complaint
- Field Report

Operator License No: 8748

API Well Number: 15-169-19046

Op Name: Sheldon Brothers Agency

Spot: S2 SE SE Sec 7 Twp 14 S Rng 2 E W

Address 1: PO Box 1100

330 Feet from N S Line of Section

Address 2: _____

660 Feet from E W Line of Section

City: Salina

GPS: Lat: 38.84253 Long: 97.57781 Date: _____

State: Ks Zip Code: 67402 -1100

Lease Name: Sheldon Well #: 3 SWD

Operator Phone #: (913) 825-1561

County: Saline DOCKET # E-17237

Reason for Investigation:

Follow up ; Request from Central office to verify well location

Problem:

Investigate if well still is in existence

Persons Contacted:

Findings:

The well is under the parking lot of the Kansas State Patrol offices in Salina Kansas, Visual Inspection of the area as well as verification with GPS

JERRY ALSO CONTACTED SCOTT'S WELL SERVICE WHO HAD PERFORMED WORK ON THE WELL FOR SHELDON BROS. SCOTT'S WELL SERVICE DID NOT FIND ANY FURTHER INFORMATION REGARDING THE WELL. HE ASSUMES IT WAS PLUGGED ALONG WITH OTHER WELL(S) ON THE LEASE, AND NOW UNDER THE PARKING LOT OF KANSAS ARMY PATROL.

JK

Action/Recommendations:

Follow Up Required Yes No

Date: _____

NONE- Close Case

Verification Sources:

Photos Taken: NO

- | | | |
|--|--|-------------------------------------|
| <input checked="" type="checkbox"/> RBDMS | <input checked="" type="checkbox"/> KGS | <input type="checkbox"/> TA Program |
| <input type="checkbox"/> T-I Database | <input checked="" type="checkbox"/> District Files | <input type="checkbox"/> Courthouse |
| <input checked="" type="checkbox"/> Other: <u>Google Earth Pro</u> | | |

By: Jerry Sparling
Environmental Compliance Regulatory Specialist

Retain 1 Copy District Office
 Send 1 Copy to Conservation Division

Form: _____

JK

CASING MECHANICAL INTEGRITY TEST

COPY

38.8425347
-97.5778138 DOCKET # E-17-237

Disposal Enhanced Recovery:

SW SE SE, Sec 7, T 14S, R 2W E/W

Repressuring
Flood
Tertiary

330 Feet from South Section Line
660 Feet from East Section Line

Date injection started
API #15 - Nov-73

Lease Sheldon B #3 Well # 6 WD
County Saxline

Operator: Sheldon Bros Agency
Name &
Address 81-1179

Operator License # 8748 PCA 1998?
Contact Person Don Sims

Salemite 67402

Phone 913-826-0371

Max. Auth. Injection Press. 12 psi; Max. Inj. Rate 500 bbl/d;
 If Dual Completion - Injection above production _____ Injection below production _____

Conductor	Surface	Production	Liner	Tubing
Size _____	<u>8 7/8</u>	<u>5 1/2" (60 seals)</u>	_____	Size <u>2 3/8"</u>
Set at _____	<u>203</u>	<u>3169</u>	_____	Set at <u>3130</u>
Cement Top _____	<u>0</u>	<u>2869</u>	_____	Type <u>stab</u>
" Bottom _____	<u>203</u>	<u>3169</u>	_____	
DV/Perf. _____		<u>(D) and plug back</u>	<u>3171</u>	ft. depth _____
Packer type <u>annular</u>		Size <u>5 1/2" x 2 3/8"</u>		Set at <u>3130</u>
Zone of injection <u>3160</u> ft. to ft. <u>3171</u>				Perf. or open hole <u>OH</u>

Type Mit: Pressure Radioactive Tracer Survey Temperature Survey

F Time: Start 10 Min. 20 Min. 30 Min.

I
E Pressures: 130[#] 130[#] 130[#] Set up 1 System Pres. during test 25[#]
 L Set up 2 Annular Pres. during test 130[#]
 D Set up 3 Fluid loss during test 0 bbls.

A T Tested: Casing or Casing - Tubing Annulus

The bottom of the tested zone is shut in with Packer

Test Date 5-8-96 Using Scott's Well Serv Company's Equipment

The operator hereby certifies that the zone between 0 feet and 3130 feet

was the zone tested + Don Sims Signature Pumper Title

The results were Satisfactory , Marginal _____, Not Satisfactory _____

State Agent Ralph Little Title PERT Witness: Yes No _____

REMARKS: Traced water in annulus

Origin. Conservation Div.; KDHE/T; Dist. Office;

Computer Update

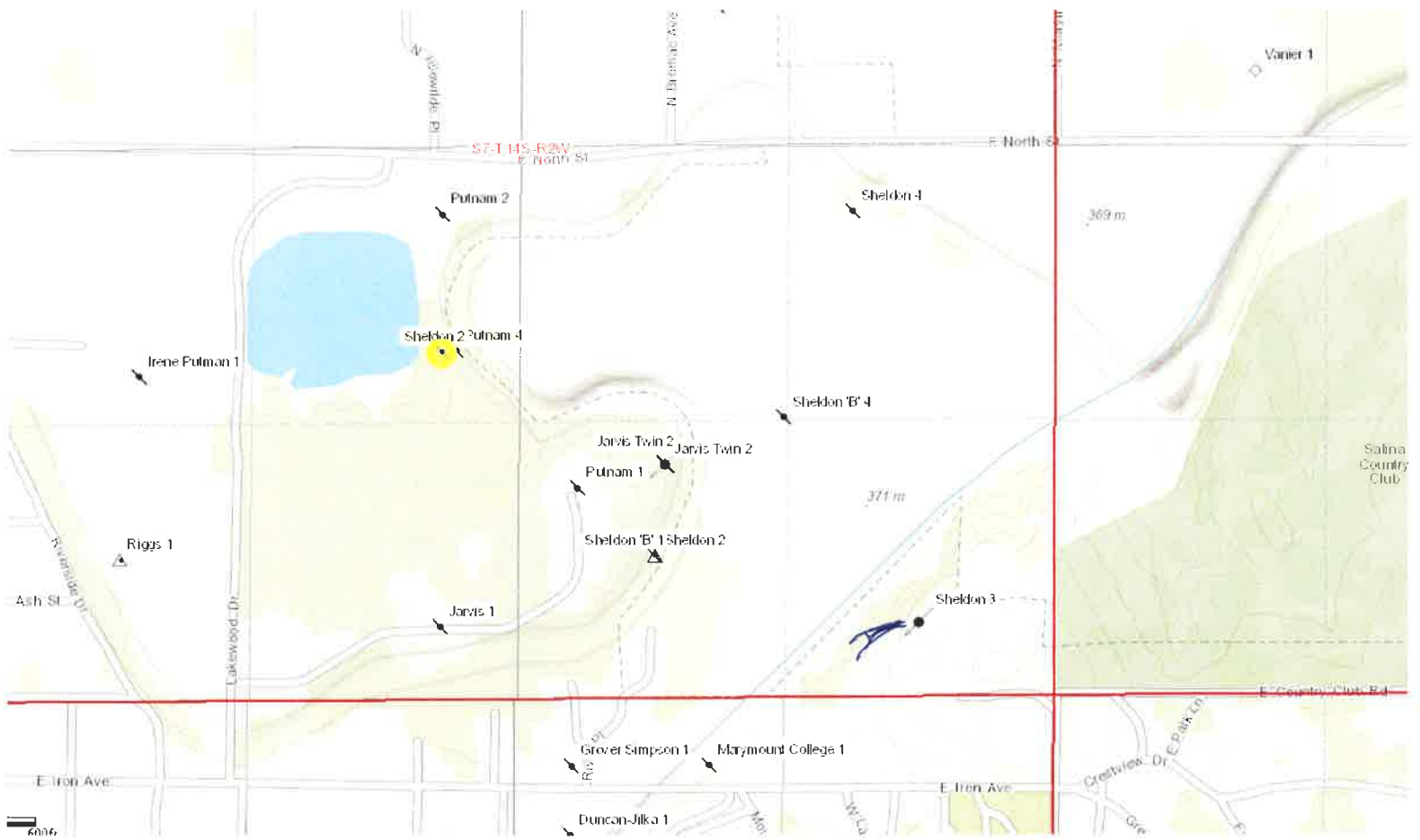

8/1691

Levee Trail System

38.8425347,-97.5778138

E Country Club Rd

N Marymount Rd

W Park Ln

E Iron Ave

Image U.S. Geological Survey

Greenway Rd

Survey

GPS LOCATION OF THE SHELTON #3
PARKING LOT OF THE KS STATE PATROL OFFICES.

