

For KCC Use: 6.2.04
 Effective Date: 3
 District # 3
 SGA? Yes No

KANSAS CORPORATION COMMISSION
 OIL & GAS CONSERVATION DIVISION
NOTICE OF INTENT TO DRILL

Form C-1
 December 2002
Form must be Typed
Form must be Signed
All blanks must be Filled

Must be approved by KCC five (5) days prior to commencing well

Expected Spud Date June 03, 2004
 month day year

OPERATOR: License# 32912 4/30/04
 Name: Carroll Energy, LLC
 Address: 2198 Valley High Dr
 City/State/Zip: Independence, KS 67301
 Contact Person: Terry Carroll
 Phone: (620) 331 7166

CONTRACTOR: License# 33374
 Name: James D. Lorenz L&S Well Service, LLC

Well Drilled For:	Well Class:	Type Equipment:
<input type="checkbox"/> Oil	<input type="checkbox"/> Infield	<input type="checkbox"/> Mud Rotary
<input checked="" type="checkbox"/> Gas	<input checked="" type="checkbox"/> Pool Ext.	<input checked="" type="checkbox"/> Air Rotary
<input type="checkbox"/> OWWO	<input type="checkbox"/> Wildcat	<input type="checkbox"/> Cable
<input type="checkbox"/> Seismic; # of Holes	<input type="checkbox"/> Other	
<input type="checkbox"/> Other		

If OWWO: old well information as follows:
 Operator: N/A
 Well Name: N/A
 Original Completion Date: N/A Original Total Depth: N/A

Directional, Deviated or Horizontal wellbore? Yes No
 If Yes, true vertical depth: N/A
 Bottom Hole Location: N/A
 KCC DKT #: N/A

Spot East
 SW - SW - SW Sec. 6 Twp. 29 S. R. 16 West
360 feet from N / S Line of Section
4920 feet from E / W Line of Section

Is SECTION Regular Irregular?
 County: Wilson
 Lease Name: Norman Eisele Well #: C-2
 Field Name: Fredonia

Is this a Prorated / Spaced Field? Yes No
 Target Formation(s): Coals, Mississippi
 Nearest Lease or unit boundary: 360

Ground Surface Elevation: 904 feet MSL
 Water well within one-quarter mile: Yes No
 Public water supply well within one mile: Yes No

Depth to bottom of fresh water: 100+
 Depth to bottom of usable water: 300+
 Surface Pipe by Alternate: 1 2
 Length of Surface Pipe Planned to be set: 20 ft.
 Length of Conductor Pipe required: None
 Projected Total Depth: 1250 ft.
 Formation at Total Depth: Mississippi

Water Source for Drilling Operations:
 Well Farm Pond Other
 DWR Permit #: N/A

(Note: Apply for Permit with DWR)
 Will Cores be taken? Yes No
 If Yes, proposed zone: N/A

AFFIDAVIT

The undersigned hereby affirms that the drilling, completion and eventual plugging of this well will comply with K.S.A. 55 et. seq.
 It is agreed that the following minimum requirements will be met:

1. Notify the appropriate district office **prior** to spudding of well;
2. A copy of the approved notice of intent to drill **shall be** posted on each drilling rig;
3. The minimum amount of surface pipe as specified below **shall be set** by circulating cement to the top; in all cases surface pipe **shall be set** through all unconsolidated materials plus a minimum of 20 feet into the underlying formation.
4. If the well is dry hole, an agreement between the operator and the district office on plug length and placement is necessary **prior to plugging**;
5. The appropriate district office will be notified before well is either plugged or production casing is cemented in;
6. If an ALTERNATE II COMPLETION, production pipe shall be cemented from below any **usable water to surface** within **120 days** of spud date.
 Or pursuant to Appendix "B" - Eastern Kansas surface casing order #133,891-C, which **applies** to the KCC District 3 area, alternate II cementing must be completed within 30 days of the spud date or the well shall be plugged. **In all cases, NOTIFY district office** prior to any cementing.

I hereby certify that the statements made herein are true and to the best of my knowledge and belief.

Date: 5-27-04 Signature of Operator or Agent: [Signature] Title: Operating Manager

For KCC Use ONLY
 API # 15 - 205-25812-0000
 Conductor pipe required NONE feet
 Minimum surface pipe required 20 feet per Alt. → 2
 Approved by: RJP 5-28-04
 This authorization expires: 11-28-04
 (This authorization void if drilling not started within 6 months of effective date.)
 Spud date: _____ Agent: _____

Remember to:

- File Drill Pit Application (form CDP-1) with Intent to Drill;
- File Completion Form ACO-1 within 120 days of spud date;
- File acreage attribution plat according to field proration orders;
- Notify appropriate district office 48 hours prior to workover or re-entry;
- Submit plugging report (CP-4) after plugging is completed;
- Obtain written approval before disposing or injecting salt water.
- If this permit has expired (See: authorized expiration date) please check the box below and return to the address below.

Well Not Drilled - Permit Expired
 Signature of Operator or Agent: _____
 Date: _____

Mail to: KCC - Conservation Division, 130 S. Market - Room 2078, Wichita, Kansas 67202

6 29 16 E

IN ALL CASES PLOT THE INTENDED WELL ON THE PLAT BELOW

Plat of acreage attributable to a well in a prorated or spaced field

If the intended well is in a prorated or spaced field, please fully complete this side of the form. If the intended well is in a prorated or spaced field complete the plat below showing that the well will be properly located in relationship to other wells producing from the common source of supply. Please show all the wells and within 1 mile of the boundaries of the proposed acreage attribution unit for gas wells and within 1/2 mile of the boundaries of the proposed acreage attribution unit for oil wells.

API No. 15 - _____
 Operator: Carroll Energy, LLC
 Lease: Norman Eisele
 Well Number: C-2
 Field: Fredonia

Number of Acres attributable to well: _____
 QTR / QTR / QTR of acreage: SW - SW - SW

Location of Well: County: Wilson
360 feet from N / S Line of Section
4920 feet from E / W Line of Section
 Sec. 6 Twp. 29 S. R. 16 East West

Is Section: Regular or Irregular

If Section is Irregular, locate well from nearest corner boundary.

Section corner used: NE NW SE SW

PLAT

*(Show location of the well and shade attributable acreage for prorated or spaced wells.)
 (Show footage to the nearest lease or unit boundary line.)*

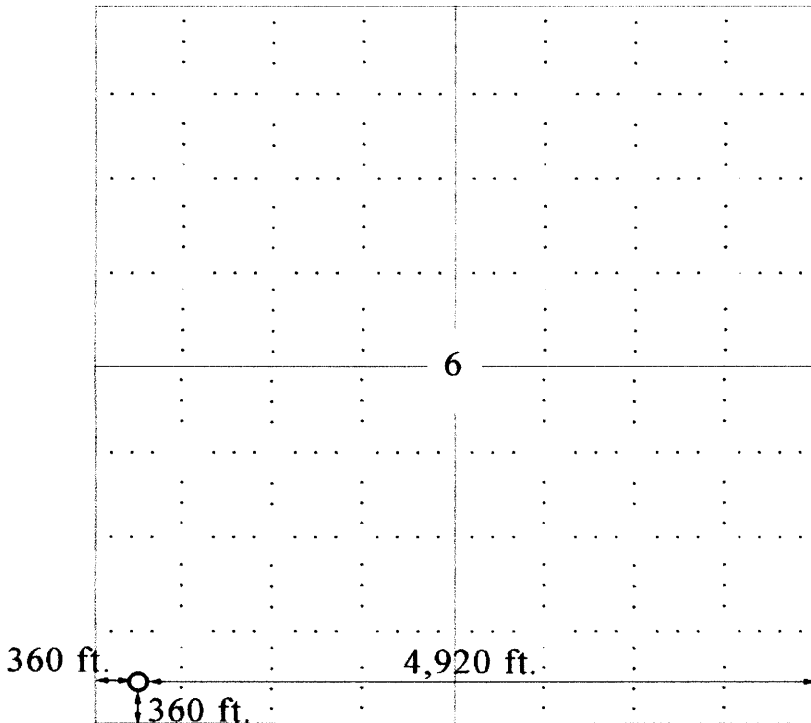

RECEIVED
 MAY 28 2004
 KCC WICHITA

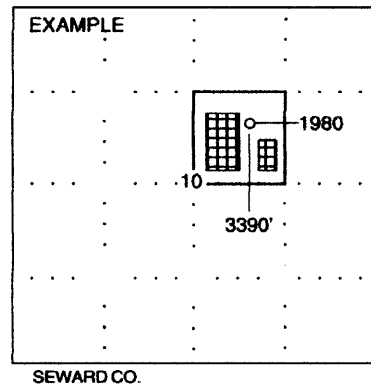

NOTE: In all cases locate the spot of the proposed drilling location.

In plotting the proposed location of the well, you must show:

1. The manner in which you are using the depicted plat by identifying section lines, i.e. 1 section, 1 section with 8 surrounding sections, 4 sections, etc.
2. The distance of the proposed drilling location from the section's south / north and east / west.
3. The distance to the nearest lease or unit boundary line.
4. If proposed location is located within a prorated or spaced field a certificate of acreage attribution plat must be attached: (CO-7 for oil wells; CG-8 for gas wells).