

OWWG

For KCC Use:

Effective Date:

7-4-04

District #

SGA? ☒ Yes ☐ NoKANSAS CORPORATION COMMISSION  
OIL & GAS CONSERVATION DIVISION

## NOTICE OF INTENT TO DRILL

Must be approved by KCC five (5) days prior to commencing well

Form C-1

December 2002

Form must be Typed

Form must be Signed

All blanks must be Filled

Expected Spud Date July 5, 2004  
month day year 70' S 310' E of SE NE Sec. 8 Twp. 35 S. R. 13

\*1962 intent had location at C SE NE

\* Spot APE 12 SE NE

☐ East☒ West

OPERATOR: License# 33168

Name: WOOLSEY OPERATING COMPANY, LLC

Address: 125 N. Market, Suite 1000

City/State/Zip: Wichita, Kansas 67202

Contact Person: Dean Pattison

Phone: 316-267-4379 ext 107

CONTRACTOR: License# 5929

Name: Duke Drilling Co., Inc.

RECEIVED

JUN 25 2004

KCC WICHITA

Well Drilled For:

Well Class:

Type Equipment:

- ☒ Oil ☐ Enh Rec ☒ Infield ☒ Mud Rotary
- ☒ Gas ☐ Storage ☐ Pool Ext. ☐ Air Rotary
- ☒ OWWO ☐ Disposal ☐ Wildcat ☐ Cable
- ☐ Seismic; # of Holes ☐ Other
- ☐ Other

If OWWO: old well information as follows:

Operator: Braden Drilling, Inc.

Well Name: Pierson 1

Original Completion Date: 12/11/62 Original Total Depth: 4989'

Directional, Deviated or Horizontal wellbore?

☐ Yes ☒ No

If Yes, true vertical depth:

Bottom Hole Location:

KCC DKT #:

2050' FNL feet from ☒ N / ☐ S Line of Section  
350' FEL feet from ☒ E / ☐ W Line of SectionIs SECTION ☒ Regular ☐ Irregular?

(Note: Locate well on the Section Plat on reverse side)

County: Barber

Lease Name: Pierson OWWO

Well #: 1

Field Name: Aetna

Is this a Prorated / Spaced Field?

☐ Yes ☒ No

Target Information(s): MISSISSIPPIAN

Nearest Lease or unit boundary: 330'

Ground Surface Elevation: 1596'

feet MSL

Water well within one-quarter mile:

☐ Yes ☒ No

Public water supply well within one mile:

☐ Yes ☒ No

Depth to bottom of fresh water: 150'

Depth to bottom of usable water: 180'

Surface Pipe by Alternate: ☒ 1 ☐ 2Length of Surface Pipe ~~Planned to be set~~ already set at 613'

Length of Conductor Pipe required: NONE

Projected Total Depth: 4989'

Formation at Total Depth: MISSISSIPPIAN

Water Source for Drilling Operations:

☐ Well ☐ Farm Pond Other TO BE HAULED

DWR Permit #:

(Note: Apply for Permit with DWR ☐)

Will Cores be taken?

☐ Yes ☒ No

If Yes, proposed zone:

## AFFIDAVIT

The undersigned hereby affirms that the drilling, completion and eventual plugging of this well will comply with K.S.A. 55 et. seq.

It is agreed that the following minimum requirements will be met:

1. Notify the appropriate district office **prior** to spudding of well;
2. A copy of the approved notice of intent to drill **shall be posted** on each drilling rig;
3. The minimum amount of surface pipe as specified below **shall be set** by circulating cement to the top; in all cases surface pipe **shall be set** through all unconsolidated materials plus a minimum of 20 feet into the underlying formation.
4. If the well is dry hole, an agreement between the operator and the district office on plug length and placement is necessary **prior to plugging**;
5. The appropriate district office will be notified before well is either plugged or production casing is cemented in;
6. If an ALTERNATE II COMPLETION, production pipe shall be cemented from below any usable water to surface within **120 days** of spud date. Or pursuant to Appendix "B" - Eastern Kansas surface casing order #133,891-C, which applies to the KCC District 3 area, alternate II cementing must be completed within 30 days of the spud date or the well shall be plugged. **In all cases, NOTIFY district office** prior to any cementing.

I hereby certify that the statements made herein are true and to the best of my knowledge and belief.

Date: 6/24/04

Signature of Operator or Agent:

Dean Pattison

Title: Operations Manager

For KCC Use ONLY

API # 15 -

007. 01739.00-01

Conductor pipe required NONE feetMinimum surface pipe required 613 feet per Alt. ①Approved by RJP 6-29-04This authorization expires: 12-29-04

(This authorization void if drilling not started within 6 months of effective date.)

Spud date: Agent:

## Remember to:

- File Drill Pit Application (form CDP-1) with Intent to Drill;
- File Completion Form ACO-1 within 120 days of spud date;
- File acreage attribution plat according to field proration orders;
- Notify appropriate district office 48 hours prior to workover or re-entry;
- Submit plugging report (CP-4) after plugging is completed;
- Obtain written approval before disposing or injecting salt water.
- If this permit has expired (See: authorized expiration date) please check the box below and return to the address below.

☐ Well Not Drilled - Permit Expired

Signature of Operator or Agent:

Date:

Mail to: KCC - Conservation Division, 130 S. Market - Room 2078, Wichita, Kansas 67202

8  
35  
134

**IN ALL CASES PLOT THE INTENDED WELL ON THE PLAT BELOW***Plat of acreage attributable to a well in a prorated or spaced field*

**If the intended well is in a prorated or spaced field, please fully complete this side of the form.** If the intended well is in a prorated or spaced field complete the plat below showing that the well will be properly located in relationship to other wells producing from the common source of supply. Please show all the wells and within 1 mile of the boundaries of the proposed acreage attribution unit for gas wells and within 1/2 mile of the boundaries of the proposed acreage attribution unit for oil wells.

API No. 15 - \_\_\_\_\_  
 Operator: WOOLSEY OPERATING COMPANY, LLC  
 Lease: Pierson OWWO  
 Well Number: 1  
 Field: Aetna  
 Number of Acres attributable to well: \_\_\_\_\_  
 QTR / QTR / QTR of acreage: \_\_\_\_\_ - SE - NE

Location of Well: County: Barber  
2050' FNL feet from ☒ N / ☐ S Line of Section  
350' FEL feet from ☒ E / ☐ W Line of Section  
 Sec. 8 Twp. 35 S. R. 13 ☐ East ☒ West

Is Section: ☒ Regular or ☐ Irregular

**If Section is Irregular, locate well from nearest corner boundary.**

Section corner used: ☐ NE ☐ NW ☐ SE ☐ SW

**PLAT**

*(Show location of the well and shade attributable acreage for prorated or spaced wells.)*

*(Show footage to the nearest lease or unit boundary line.)*

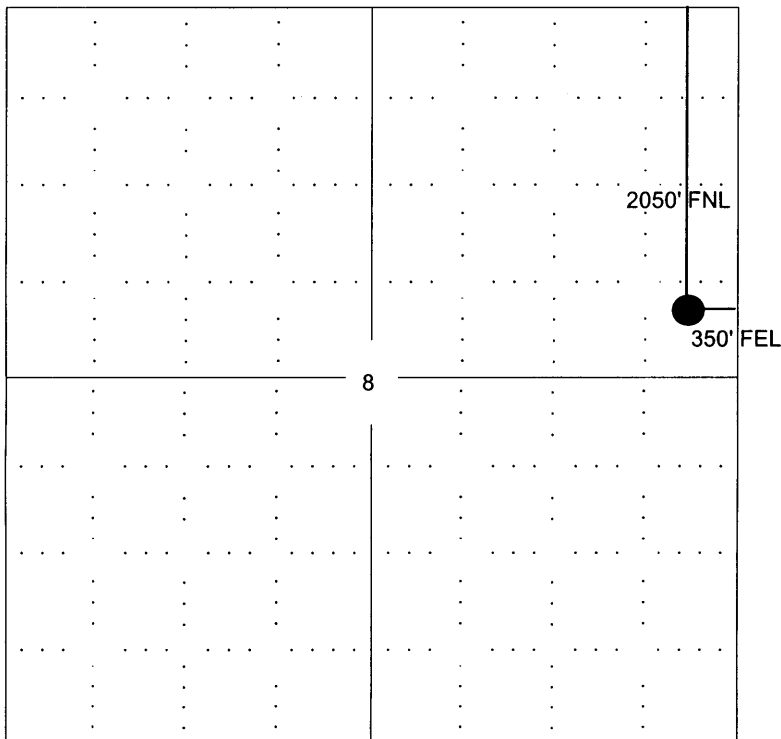

RECEIVED  
 JUN 25 2004  
 KCC WICHITA

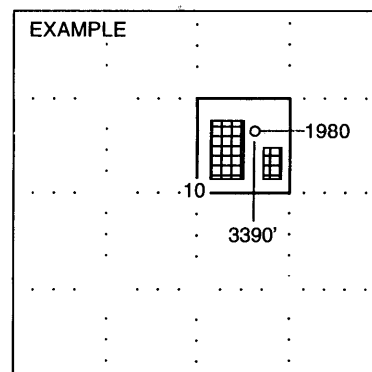

SEWARD CO.

**NOTE: In all cases locate the spot of the proposed drilling location.**

**In plotting the proposed location of the well, you must show:**

1. The manner in which you are using the depicted plat by identifying section lines, i.e. 1 section, 1 section with 8 surrounding sections, 4 sections, etc.
2. The distance of the proposed drilling location from the section's south / north and east / west.
3. The distance to the nearest lease or unit boundary line.
4. If proposed location is located within a prorated or spaced field a certificate of acreage attribution plat must be attached: (CO-7 for oil wells; CG-8 for gas wells).

# KANSAS

CORPORATION COMMISSION

KATHLEEN SEBELIUS, GOVERNOR

BRIAN J. MOLINE, CHAIR

JOHN WINE, COMMISSIONER

ROBERT E. KREHBIEL, COMMISSIONER

June 29, 2004

Mr. Dean Pattisson  
Woolsey Operating Company, LLC  
125 N. Market Ste 1000  
Wichita, KS 67202

RE: Drilling Pit Application  
Pierson OWWO Lease Well No. 1  
NE/4 Sec. 08-35S-13W  
Barber County, Kansas

Dear Mr. Pattisson:

District staff has inspected the above referenced location and has determined that the reserve pit shall be constructed **without slots**, the bottom shall be flat and reasonably level, and the free fluids must be removed. The fluids are to be removed from the reserve pit as soon as practical after drilling operations have ceased.

**If production casing is set all completion fluids shall be removed on a daily basis.**

The fluids should be taken to an authorized disposal well. Please call the District Office at (620) 225-8888 when the fluids have been removed. Also, please file the enclosed CDP-5 form, Surface Pond Waste Transfer, within 30 days of fluid removal.

**A copy of this letter should be posted in the doghouse along with the approved Intent to Drill.** If you have any questions or concerns please feel free to contact the undersigned at the above address.

Sincerely,



Kathleen Haynes

Environmental Protection and Remediation Department

cc: S Durrant