

CARD MUST BE TYPED

State of Kansas  
**NOTICE OF INTENTION TO DRILL**

CARD MUST BE SIGNED

(see rules on reverse side)

135-22,766-00-00

Starting Date: ..... 4-1-84 .....  
month day year

API Number 15-

OPERATOR: License # ..... 9310 Exp. 8601 .....  
Name ..... Bentley Oil & Gas Co. ....  
Address ..... P.O. Box 5012 .....  
City/State/Zip ..... Wichita Falls, Tx 76307 .....  
Contact Person ..... John C. Bentley .....  
Phone ..... (817) 723-0897 .....

E $\frac{1}{2}$  E $\frac{1}{2}$  SE Sec 31 Twp 18 S, Rge 25  East  
(location)  West

1450' ..... Ft North from Southeast Corner of Section  
330 ..... Ft West from Southeast Corner of Section  
(Note: Locate well on Section Plat on reverse side)

CONTRACTOR: License # ..... 6333 .....  
Name ..... DaMac Drilling .....  
City/State .....

Nearest lease or unit boundary line ..... 330' ..... feet.  
County ..... Ness County .....  
Lease Name ..... D.D. Johnson ..... Well# 1 .....

Well Drilled For: Well Class: Type Equipment:  
 Oil  Swd  Infield  Mud Rotary  
 Gas  Inj  Pool Ext.  Air Rotary  
 OWWO  Expl  Wildcat  Cable

Domestic well within 330 feet:  yes  no  
Municipal well within one mile:  yes  no

If OWWO: old well info as follows:  
Operator .....  
Well Name .....  
Comp Date ..... Old Total Depth .....  
Projected Total Depth ..... 4700' ..... feet  
Projected Formation at TD ..... Mississippian .....  
Expected Producing Formations ..... Mississippian, Ft. Scott, Marmaton .....

Depth to Bottom of fresh water ..... 100 ..... feet  
Lowest usable water formation ..... Ogkota .....  
Depth to Bottom of usable water ..... 700 ..... feet  
Surface pipe by Alternate: 1  2   
Surface pipe to be set ..... 700 ..... feet  
Conductor pipe if any required ..... feet  
Ground surface elevation ..... 2405 ..... feet MSL  
This Authorization Expires ..... 7-14-85 .....  
Approved By ..... 1-14-85 ..... *R* .....

I certify that we will comply with K.S.A. 55-101, et seq., plus eventually plugging hole to K.C.C. specifications.

Date ..... 1-10-84 ..... Signature of Operator or Agent

*Kathy Sukasiewicz* Title Agent  
MHC/KOHE 1-14-85

Must be filed with the K.C.C. five (5) days prior to commencing well  
This card void if drilling not started within six (6) months of date received by K.C.C.

RECEIVED  
STATE CORPORATION COMMISSION

Important procedures to follow: JAN 14 1985

A Regular Section of Land  
1 Mile = 5,280 Ft.

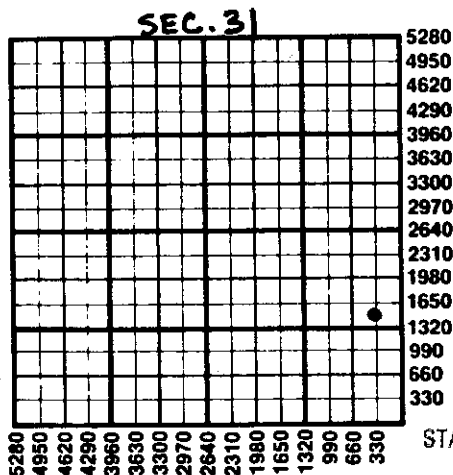

1. Notify District office before setting surface casing.
2. Set surface casing by circulating cement to the top.
3. File completion forms ACO-1 with K.C.C. within 90 days of well completion, following instructions on ACO-1, side 1, and including copies of wireline logs.
4. Notify District office 48 hours prior to old well workover or re-entry.
5. Prior to plugging, prepare a plugging plan, then obtain agreement from the appropriate district office for an approved plugging plan.
6. Submit plugging report (CP-4) to K.C.C. after plugging is completed.
7. Obtain an approved injection docket number before disposing of salt water.
8. Notify K.C.C. within 10 days when injection commences or terminates.
9. If an alternate 2 completion, cement in the production pipe from below any usable water to surface within 120 days of spud date.

CONSERVATION DIVISION  
Wichita, Kansas

RECEIVED  
STATE CORPORATION COMMISSION

State Corporation Commission of Kansas

Conservation Division

200 Colorado Derby Building

Wichita, Kansas 67202

(316) 263-3238

OCT 29 1984

10-29-1984

CONSERVATION DIVISION  
Wichita, Kansas