

*CORRECTION

EFFECTIVE DATE: 7-21-93
DISTRICT # 1
SEAT... Yes... No

State of Kansas
NOTICE OF INTENTION TO DRILL

Must be approved by the K.C.C. five (5) days prior to commencing well

Expected Spud Date month day year

Spot 90' S of E/2 NW NE
..... Sec 2 Twp 18 S, Rg 43 X East West

OPERATOR: License # 30606
Name: MURFIN DRILLING COMPANY, INC.
Address: 250 N. Water, Suite 300
City/State/Zip: Wichita, Ks. 67202
Contact Person: Scott Robinson
Phone: 316-267-3241

CONTRACTOR: License #: 30606
Name: Murfin Drilling Company, Inc.

Well Drilled For: Well Class: Type Equipment:
X Oil ... Enh Rec ... Infield X Mud Rotary
... Gas ... Storage X Pool Ext. ... Air Rotary
... OWD ... Disposal ... Wildcat ... Cable
... Seismic; ... # of Holes ... Other
... Other

If OWD: old well information as follows:
Operator:
Well Name:
Comp. Date: Old Total Depth

Directional, Deviated or Horizontal wellbore? yes no
If yes, true vertical depth:

Bottom Hole Location:
WAS: SE NE NW NE 550' fNL 1400' fEL
550' N.L.B., 3912 Gr Surf El.

The undersigned hereby affirms that the drilling, completion and eventual plugging of this well will be in accordance with the provisions of K.S.A. 55-101, et. seq.

It is agreed that the following minimum requirements will be met:

- 1. Notify the appropriate district office prior to spudding of well;
- 2. A copy of the approved notice of intent to drill shall be posted on each drilling rig;
- 3. The minimum amount of surface pipe as specified below shall be set by circulating cement to the top; in all cases surface pipe shall be set through all unconsolidated materials plus a minimum of 20 feet into the underlying formation;
- 4. If the well is dry hole, an agreement between the operator and the district office on plug length and placement is necessary prior to plugging;
- 5. The appropriate district office will be notified before well is either plugged or production casing is cemented in;
- 6. IF AN ALTERNATE II COMPLETION, PRODUCTION PIPE SHALL BE CEMENTED FROM BELOW ANY USABLE WATER TO SURFACE WITHIN 120 DAYS OF SPUD DATE. IN ALL CASES, NOTIFY DISTRICT OFFICE PRIOR TO ANY CEMENTING.

I hereby certify that the statements made herein are true and to the best of my knowledge and belief.

Date: 12/16/93 Signature of Operator or Agent: Loren Deaver Title: Agent f/Operator

FOR KCC USE:
API # 15- 071-20603-0000
Conductor pipe required None feet
Minimum surface pipe required 200 feet per Alt. X ②
Approved by: D.R. 7-16-93
This authorization expires: 1-16-94
(This authorization void if drilling not started within 6 months of effective date.)
Spud date: _____ Agent: _____

REMEMBER TO:

- File Drill Pit Application (form CDP-1) with Intent to Drill;
- File Completion Form ACO-1 within 120 days of spud date;
- File acreage attribution plat according to field production orders;
- Notify appropriate district office 48 hours prior to workover or re-entry;
- Submit plugging report (CP-4) after plugging is completed;
- Obtain written approval before disposing or injecting salt water.

Mail to: Conservation Division, 200 Colorado Derby Building, 202 W. First St., Wichita, Kansas 67202-1286.

*12-27-93

RECEIVED
KANSAS CORPORATION COMMISSION
12-16-93
DEC 16 1993
CONSERVATION DIVISION
WICHITA, KS

2
18
43

IN ALL CASES PLOT THE INTENDED WELL ON THE PLAT BELOW

PLAT OF ACREAGE ATTRIBUTABLE TO A WELL IN A PRORATED OR SPACED FIELD

If the intended well is in a prorated or spaced field, please fully complete this side of the form. If the intended well is in a prorated or spaced field complete the plat below showing that the well will be properly located in relationship to other wells producing from the common source of supply. Please show all the wells within 1 mile of the boundaries of the proposed acreage attribution unit for gas wells and within 1/2 mile of the boundaries of the proposed acreage attribution unit for oil wells.

API NO. 15- _____
 OPERATOR MURFIN DRILLING COMPANY, INC.
 LEASE BOBCAT
 WELL NUMBER 2-2
 FIELD Moore Johnson Ext.

LOCATION OF WELL: COUNTY Greeley
750 feet from south/north line of section
1650 feet from east/west line of section
 SECTION 2 TWP 18S RG 43W

NUMBER OF ACRES ATTRIBUTABLE TO WELL 80
 QTR/QTR/QTR OF ACREAGE - N/2 - NE

IS SECTION _____ REGULAR or X IRREGULAR
IF SECTION IS IRREGULAR, LOCATE WELL FROM NEAREST CORNER BOUNDARY.

Section corner used: X NE _____ NW _____ SE _____ SW

PLAT

(Show location of the well and shade attributable acreage for prorated or spaced wells.)
 (Show footage to the nearest lease or unit boundary line.)

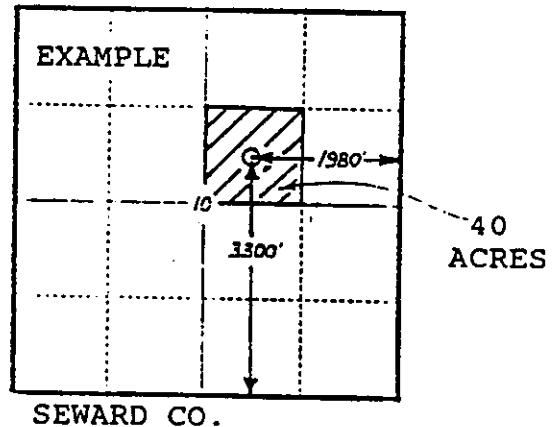
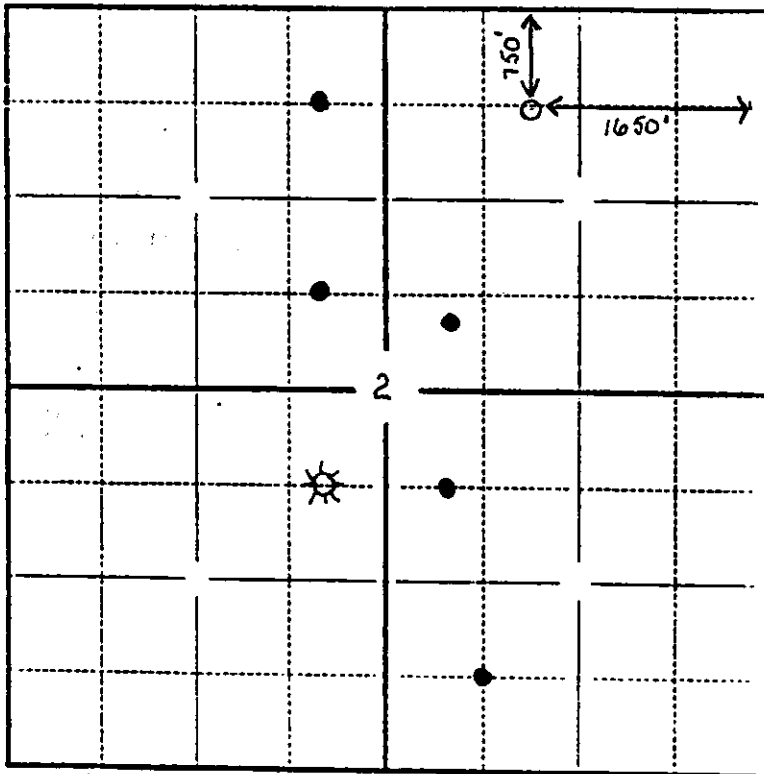

In plotting the proposed location of the well, you must show:

- 1) The manner in which you are using the depicted plat by identifying section lines, i.e. 1 section, 1 section with 8 surrounding sections, 4 sections, etc.;
- 2) the distance of the proposed drilling location from the section's south/north and east/west lines; and
- 3) the distance to the nearest lease or unit boundary line.

**Correction*

EFFECTIVE DATE: 7-21-93

DISTRICT # 1
SEAT... Yes... No

State of Kansas

NOTICE OF INTENTION TO DRILL

Must be approved by the K.C.C. five (5) days prior to commencing well

Expected Spud Date month day year

OPERATOR: License # 30606
Name: Murfin Drilling Company, Inc.
Address: 250 N. Water, Suite 300
City/State/Zip: Wichita, Ks. 67202
Contact Person: Scott Robinson
Phone: 316-267-3241

CONTRACTOR: License #: 30606
Name: Murfin Drilling Company, Inc.

Well Drilled For: Well Class: Type Equipment:
 Oil ... Enh Rec ... Infield Mud Rotary
 Gas ... Storage Pool Ext. ... Air Rotary
 OWWO ... Disposal ... Wildcat ... Cable
 Seismic; ... # of Holes ... Other
 Other

If OWWO: old well information as follows:

Operator:
Well Name:
Comp. Date: Old Total Depth

Directional, Deviated or Horizontal wellbore? yes no
If yes, true vertical depth:

Bottom Hole Location:

X lbs SW NW NE 390' f.n. 1, 2900' f.e.l.
330 N.L.B. 3895' g.s.l.

The undersigned hereby affirms that the drilling, completion and eventual plugging of this well will comply with K.S.A. 55-101, et. seq.

It is agreed that the following minimum requirements will be met:

- 1. Notify the appropriate district office prior to spudding of well;
- 2. A copy of the approved notice of intent to drill shall be posted on each drilling rig;
- 3. The minimum amount of surface pipe as specified below shall be set by circulating cement to the top; in all cases surface pipe shall be set through all unconsolidated materials plus a minimum of 20 feet into the underlying formation;
- 4. If the well is dry hole, an agreement between the operator and the district office on plug length and placement is necessary prior to plugging;
- 5. The appropriate district office will be notified before well is either plugged or production casing is cemented in;
- 6. IF AN ALTERNATE II COMPLETION, PRODUCTION PIPE SHALL BE CEMENTED FROM BELOW ANY USABLE WATER TO SURFACE WITHIN 120 DAYS OF SPUD DATE. IN ALL CASES, NOTIFY DISTRICT OFFICE PRIOR TO ANY CEMENTING.

I hereby certify that the statements made herein are true and to the best of my knowledge and belief.

Date: 11/30/93 Signature of Operator or Agent: Scott Robinson Title: Geological Manager

RECEIVED
KANSAS CORPORATION COMMISSION

NOV 30 1993

CONSERVATION DIVISION
WICHITA, KS

FOR KCC USE:
API # 15- 071-20603
Conductor pipe required NONE feet
Minimum surface pipe required 200' feet per Alt.
Approved by: DR. 7-16-93
This authorization expires: 1-16-94
(This authorization void if drilling not started within 6 months of effective date.)
Spud date: _____ Agent: _____

REMEMBER TO:

- File Drill Pit Application (form CDP-1) with Intent to Drill;
- File Completion Form ACO-1 within 120 days of spud date;
- File acreage attribution plat according to field proration orders;
- Notify appropriate district office 48 hours prior to workover or re-entry;
- Submit plugging report (CP-4) after plugging is completed;
- Obtain written approval before disposing or injecting salt water.

Mail to: Conservation Division, 200 Colorado Derby Building, 202 W. First St., Wichita, Kansas 67202-1286.

12-3-93

AFFIDAVIT

X lbs senewne 550 N.L.B. & f.n. 1400' f.e.l. 3912 g.s.l.

2
18
43

IN ALL CASES PLOT THE INTENDED WELL ON THE PLAT BELOW

PLAT OF ACREAGE ATTRIBUTABLE TO A WELL IN A PRORATED OR SPACED FIELD

If the intended well is in a prorated or spaced field, please fully complete this side of the form. If the intended well is in a prorated or spaced field complete the plat below showing that the well will be properly located in relationship to other wells producing from the common source of supply. Please show all the wells within 1 mile of the boundaries of the proposed acreage attribution unit for gas wells and within 1/2 mile of the boundaries of the proposed acreage attribution unit for oil wells.

API NO. 15- _____
 OPERATOR Murfin/DCX /
 LEASE Bobcat #2-2
 WELL NUMBER 2-2
 FIELD Moore-Johnson Ext

LOCATION OF WELL: COUNTY Greeley
550 feet from south/north line of section
1400 feet from east/west line of section
 SECTION 2 TWP 18S RG 43W

NUMBER OF ACRES ATTRIBUTABLE TO WELL 80
 QTR/QTR/QTR OF ACREAGE - N/2 - NE

IS SECTION REGULAR or IRREGULAR
IF SECTION IS IRREGULAR, LOCATE WELL FROM NEAREST CORNER BOUNDARY.

Section corner used: NE NW SE SW
PLAT

(Show location of the well and shade attributable acreage for prorated or spaced wells.)
 (Show footage to the nearest lease or unit boundary line.)

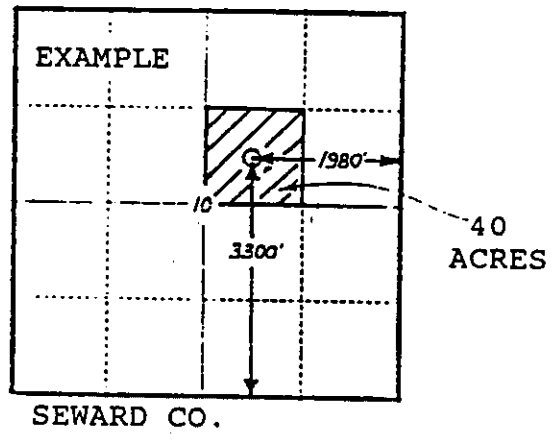
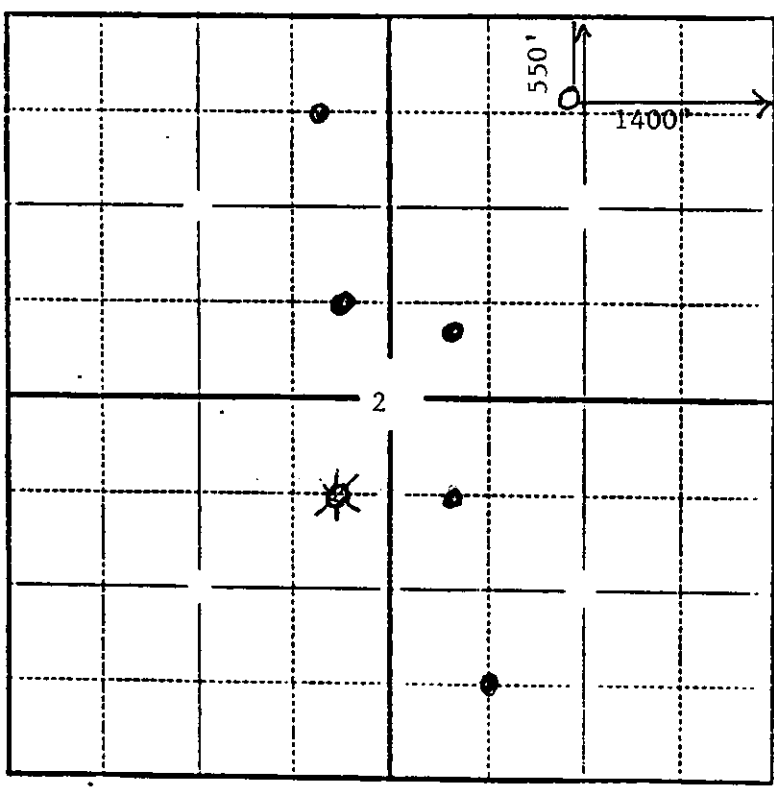

In plotting the proposed location of the well, you must show:

- 1) The manner in which you are using the depicted plat by identifying section lines, i.e. 1 section, 1 section with 8 surrounding sections, 4 sections, etc.;
- 2) the distance of the proposed drilling location from the section's south/north and east/west lines; and
- 3) the distance to the nearest lease or unit boundary line.