

EFFECTIVE DATE: 8-28-93
DISTRICT # 1
ISAT Yes No

*** Correction**
State of Kansas

FORM MUST BE TYPED
FORM MUST BE SIGNED
ALL BLANKS MUST BE FILLED

NOTICE OF INTENTION TO DRILL

Must be approved by the K.C.C. five (5) days prior to commencing well

Expected Spud Date 10 15 92 W2072 NE NW Sec 2 Twp 18 S. Rg 43 East
month day year **(APPROX)** West

OPERATOR: License # 30605
Name: HGB Oil Co., Edwin C. Schuett & Sharp Eng.
Address: 1707 South Jasmine
City/State/Zip: Denver, CO, 80224
Contact Person: H. Gordon Beamguard
Phone: 303-782-9443

660' feet from ~~Section~~ / North line of Section
3150' feet from East / ~~Section~~ line of Section
IS SECTION REGULAR IRREGULAR?

(NOTE: Locate well on the Section Plat on Reverse Side)
County: Greeley
Lease Name: Witt "A" Well #: 1
Field Name: Moore-Johnson
Is this a Prorated/Spaced Field? yes no

CONTRACTOR: License #: 8241
Name: Emphasis Oil Operations

Target Formation(s): Morrow Sandstone
Nearest lease or unit boundary: 510'
Ground Surface Elevation: 3893' feet MSL

Well Drilled For: Well Class: Type Equipment:
 Oil Enh Rec Infield Mud Rotary
 Gas Storage Pool Ext. Air Rotary
 OUVVO Disposal Wildcat Cable
 Seismic; # of Holes Other

Water well within one-quarter mile: yes no
Public water supply well within one mile: yes no
Depth to bottom of fresh water: 180'
Depth to bottom of usable water: 1700' ~~1700'~~

If OUVVO: old well information as follows:
Operator: _____
Well Name: _____
Comp. Date: _____ Old Total Depth _____

Surface Pipe by Alternate: 1 2
Length of Surface Pipe Planned to be set: (650') 200'
Length of Conductor pipe required: None

Directional, Deviated or Horizontal wellbore? yes no
If yes, true vertical depth: _____
Bottom Hole Location: _____

Projected Total Depth: 5250'
Formation at Total Depth: Lower Morrow
Water Source for Drilling Operations: well farm pond other
DWR Permit #: _____
Will Cores Be Taken?: yes no
If yes, proposed zone: _____

*** Was api # 15-065-22723**

*** AFFIDAVIT Is api # 15-071-20609**

The undersigned hereby affirms that the drilling, completion and eventual plugging of this well will comply with K.S.A. 55-101, et. seq.
It is agreed that the following minimum requirements will be met:

1. Notify the appropriate district office prior to spudding of well;
2. A copy of the approved notice of intent to drill shall be posted on each drilling rig;
3. The minimum amount of surface pipe as specified below shall be set by circulating cement to the top. In all cases surface pipe shall be set through all unconsolidated materials plus a minimum of 20 feet into the lying formation;
4. If the well is dry hole, an agreement between the operator and the district office on plug length and placement is necessary prior to plugging;
5. The appropriate district office will be notified before well is either plugged or production casing is cemented in;
6. IF AN ALTERNATE IS COMPLETED, PRODUCTION PIPE SHALL BE CEMENTED FROM BELOW ANY USABLE WATER TO SURFACE WITHIN 120 DAYS OF SPUD DATE. IN ALL CASES, NOTIFY DISTRICT OFFICE PRIOR TO ANY CEMENTING.

I hereby certify that the statements made herein are true and to the best of my knowledge and belief.
Date: 8/16/93 Signature of Operator or Agent: Edwin C. Schuett Title: Agent for HGB Oil Co.

FOR ECC USE:
API # 15- 071-20609-0000
Conductor pipe required None feet
Minimum surface pipe required 200' feet per Alt. (2)
Approved by: CB 8-23-93

This authorization expires: 2-23-94
(This authorization void if drilling not started within 6 months of effective date.)
Spud date: _____ Agent: _____

REMEMBER TO:

- File Drill Pit Application (form CDP-1) with Intent to Drill;
- File Completion Form ACO-1 within 120 days of spud date;
- File acreage attribution plat according to field prorotation orders;
- Notify appropriate district office 48 hours prior to workover or re-entry;
- Submit plugging report (CP-4) after plugging is completed;
- Obtain written approval before disposing or injecting salt water.

Mail to: Conservation Division, 200 Colorado Derby Building, 202 W. First St., Wichita, Kansas 67202-1286.

RECEIVED
STATE CORPORATION COMMISSION
AUG 23 1993
8-23-93
CONSERVATION DIVISION
Wichita, Kansas

IN ALL CASES PLOT THE INTENDED WELL ON THE PLAT BELOW

PLAT OF ACREAGE ATTRIBUTABLE TO A WELL IN A PRORATED OR SPACED FIELD

If the intended well is in a prorated or spaced field, please fully complete this side of the form. If the intended well is in a prorated or spaced field complete the plat below showing that the well will be properly located in relationship to other wells producing from the common source of supply. Please show all the wells within 1 mile of the boundaries of the proposed acreage attribution unit for gas wells and within 1/2 mile of the boundaries of the proposed acreage attribution unit for oil wells.

API NO. 15- _____
 OPERATOR HGB Oil Co., Edwin C. Schuett & Sharp LOCATION OF WELL: COUNTY Greeley
 LEASE Witt "A" Engineering _____ 660 feet from ~~XXXXX~~ north line of section
 WELL NUMBER 1 3150 feet from east ~~XXXXX~~ line of section
 FIELD Moore-Johnson SECTION 2 TWP 18S RG 43W

NUMBER OF ACRES ATTRIBUTABLE TO WELL 53 IS SECTION _____ REGULAR or x IRREGULAR
 QTR/QTR/QTR OF ACREAGE _____ N/2 - NW/4 IF SECTION IS IRREGULAR, LOCATE WELL FROM NEAREST
 CORNER BOUNDARY.

Section corner used: x NE _____ NW _____ SE _____ SW

PLAT

(Show location of the well and shade attributable acreage for prorated or spaced wells.)

(Show footage to the nearest lease or unit boundary line.)

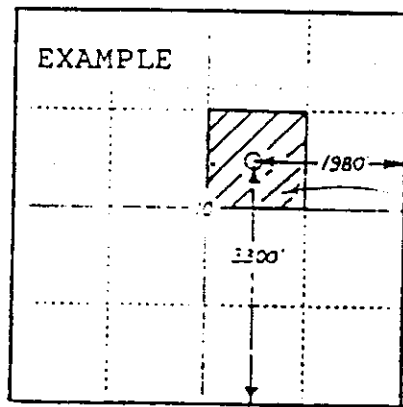
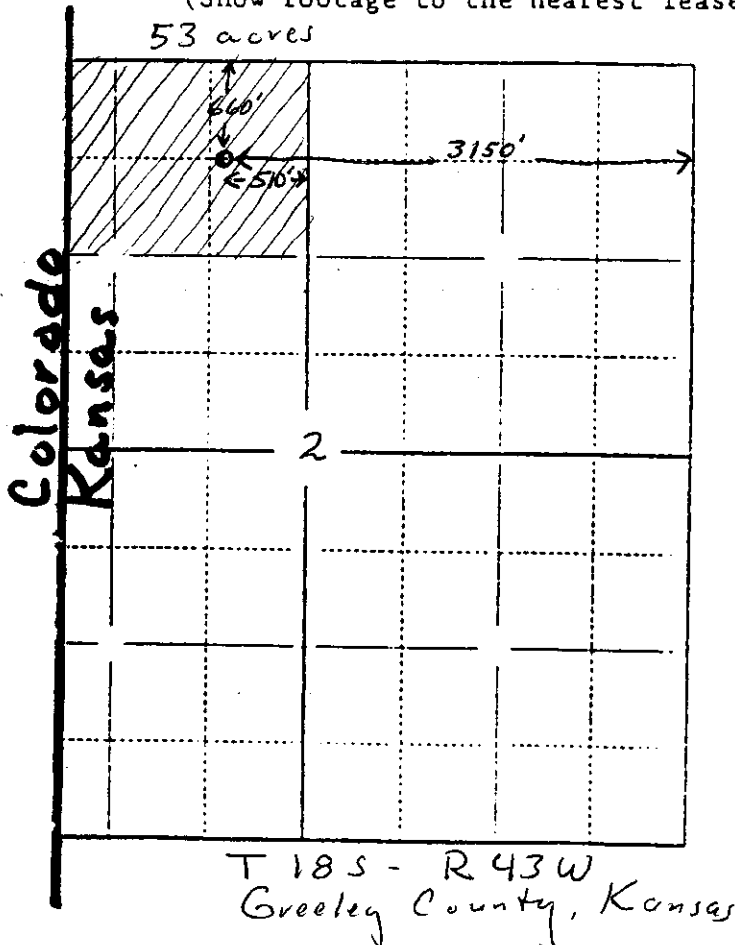

40
ACRES

In plotting the proposed location of the well, you must show:

- 1) The manner in which you are using the depicted plat by identifying section lines, i.e. 1 section, 1 section with 8 surrounding sections, 4 sections, etc.;
- 2) the distance of the proposed drilling location from the section's south/north and east/west lines; and
- 3) the distance to the nearest lease or unit boundary line.

EFFECTIVE DATE: 8-28-93
DISTRICT # 1
15A7 Yes No

State of Kansas
NOTICE OF INTENTION TO DRILL

Must be approved by the K.C.C. five (5) days prior to commencing well

Expected Spud Date 10 15 92 wyze/2 NE NW Sec 2 Top 18 S. Rg 43 X East
month day year (APP) West

OPERATOR: License # 30605
Name: HGB Oil Co., Edwin C. Schuett & Sharp Eng.
Address: 1707 South Jasmine
City/State/Zip: Denver, CO 80224
Contact Person: H. Gordon Beamguard
Phone: 303-782-9443

660' feet from ~~XXXX~~ / North line of Section
3150' feet from East / ~~XXXX~~ line of Section

IS SECTION REGULAR X IRREGULAR?

(NOTE: Locate well on the Section Plat on Reverse Side)
County: Greeley

Lease Name: Witt "A" Well #: 1

Field Name: Moore-Johnson

Is this a Prorated/Spaced Field? X yes no

Target Formation(s): Morrow Sandstone

Nearest lease or unit boundary: 510'

Ground Surface Elevation: 3893' feet MSL

Water well within one-quarter mile: no

Public water supply well within one mile: no

Depth to bottom of fresh water: 180'

Depth to bottom of usable water: 1700' 1700' ~~1700'~~

Surface Pipe by Alternate: 1 X 2

Length of Surface Pipe Planned to be set: (650') 200'

Length of Conductor pipe required: None

Projected Total Depth: 5250'

Formation at Total Depth: Lower Morrow

Water Source for Drilling Operations:
X well no farm pond no other

DWR Permit #: no

Will Cores Be Taken?: no

If yes, proposed zone: no

CONTRACTOR: License #: 8241
Name: Emphasis Oil Operations

Well Drilled For:	Well Class:	Type Equipment:
<input checked="" type="checkbox"/> Oil	<input type="checkbox"/> Enh Rec	<input type="checkbox"/> Infield <input checked="" type="checkbox"/> Mud Rotary
<input type="checkbox"/> Gas	<input type="checkbox"/> Storage	<input checked="" type="checkbox"/> Pool Ext. <input type="checkbox"/> Air Rotary
<input type="checkbox"/> OUVU	<input type="checkbox"/> Disposal	<input type="checkbox"/> Wildcat <input type="checkbox"/> Cable
<input type="checkbox"/> Seismic;	<input type="checkbox"/> # of Holes	<input type="checkbox"/> Other
<input type="checkbox"/> Other		

If OUVU: old well information as follows:
Operator: _____
Well Name: _____
Comp. Date: _____ Old Total Depth _____

Directional, Deviated or Horizontal wellbore? no X yes
If yes, true vertical depth: _____
Bottom Hole Location: _____

X Was 15-065-22723

AFFIDAVIT #15 - 071 - 20609-0000

The undersigned hereby affirms that the drilling, completion and eventual plugging of this well will comply with K.S.A. 55-101, et. seq.
It is agreed that the following minimum requirements will be met:

1. Notify the appropriate district office prior to spudding of well;
2. A copy of the approved notice of intent to drill shall be posted on each drilling rig;
3. The minimum amount of surface pipe as specified below shall be set by circulating cement to the top. In all cases surface pipe shall be set through all unconsolidated materials plus a minimum of 20 feet into the underlying formation;
4. If the well is dry hole, an agreement between the operator and the district office on plug length and placement is necessary prior to plugging;
5. The appropriate district office will be notified before well is either plugged or production casing is cemented in;
6. IF AN ALTERNATE II COMPLETION, PRODUCTION PIPE SHALL BE CEMENTED FROM BELOW ANY USABLE WATER TO SURFACE WITHIN 120 DAYS OF SPUD DATE. IN ALL CASES, NOTIFY DISTRICT OFFICE PRIOR TO ANY CEMENTING.

I hereby certify that the statements made herein are true and to the best of my knowledge and belief.
Date: 8/16/93 Signature of Operator or Agent: Edwin C. Schuett Title: Agent for HGB Oil Co.

FOR KCC USE:
API # 15- 065-22723
Conductor pipe required None feet
Minimum surface pipe required 200' feet per Alt. X (2)
Approved by: CS 8-23-93

This authorization expires: 2-23-94
(This authorization void if drilling not started within 6 months of effective date.)
Spud date: _____ Agent: _____

REMEMBER TO:

- File Drill Pit Application (form CDP-1) with Intent to Drill;
- File Completion Form ACD-1 within 120 days of spud date;
- File acreage attribution plat according to field prorotation orders;
- Notify appropriate district office 48 hours prior to workover or re-entry;
- Submit plugging report (CP-4) after plugging is completed;
- Obtain written approval before disposing or injecting salt water.

Mail to: Conservation Division, 200 Colorado Derby Building, 202 W. First St., Wichita, Kansas 67202-1286.

RECEIVED
STATE CORPORATION COMMISSION

AUG 23 1993

CONSERVATION DIVISION
Wichita, Kansas

IN ALL CASES PLOT THE INTENDED WELL ON THE PLAT BELOW

PLAT OF ACREAGE ATTRIBUTABLE TO A WELL IN A PRORATED OR SPACED FIELD

If the intended well is in a prorated or spaced field, please fully complete this side of the form. If the intended well is in a prorated or spaced field complete the plat below showing that the well will be properly located in relationship to other wells producing from the common source of supply. Please show all the wells within 1 mile of the boundaries of the proposed acreage attribution unit for gas wells and within 1/2 mile of the boundaries of the proposed acreage attribution unit for oil wells.

API NO. 15- _____
 OPERATOR HGB Oil Co., Edwin C. Schuett & Sharp LOCATION OF WELL: COUNTY Greeley
 LEASE Witt "A" Engineering 660 feet from ~~section~~ north line of section
 WELL NUMBER 1 3150 feet from east ~~section~~ line of section
 FIELD Moore-Johnson SECTION 2 TWP 18S RG 43W

NUMBER OF ACRES ATTRIBUTABLE TO WELL 53 IS SECTION _____ REGULAR or x IRREGULAR
 QTR/QTR/QTR OF ACREAGE _____ N/2 - NW/4 IF SECTION IS IRREGULAR, LOCATE WELL FROM NEAREST
CORNER BOUNDARY.
 Section corner used: x NE _____ NW _____ SE _____ SW

PLAT

(Show location of the well and shade attributable acreage for prorated or spaced wells.)
 (Show footage to the nearest lease or unit boundary line.)

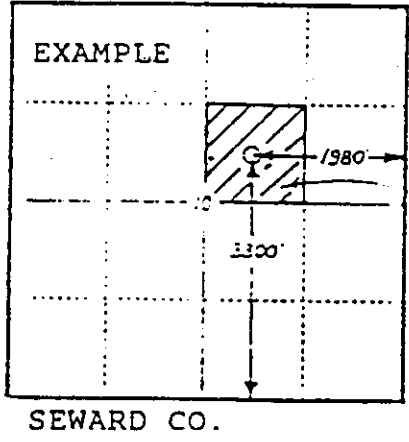
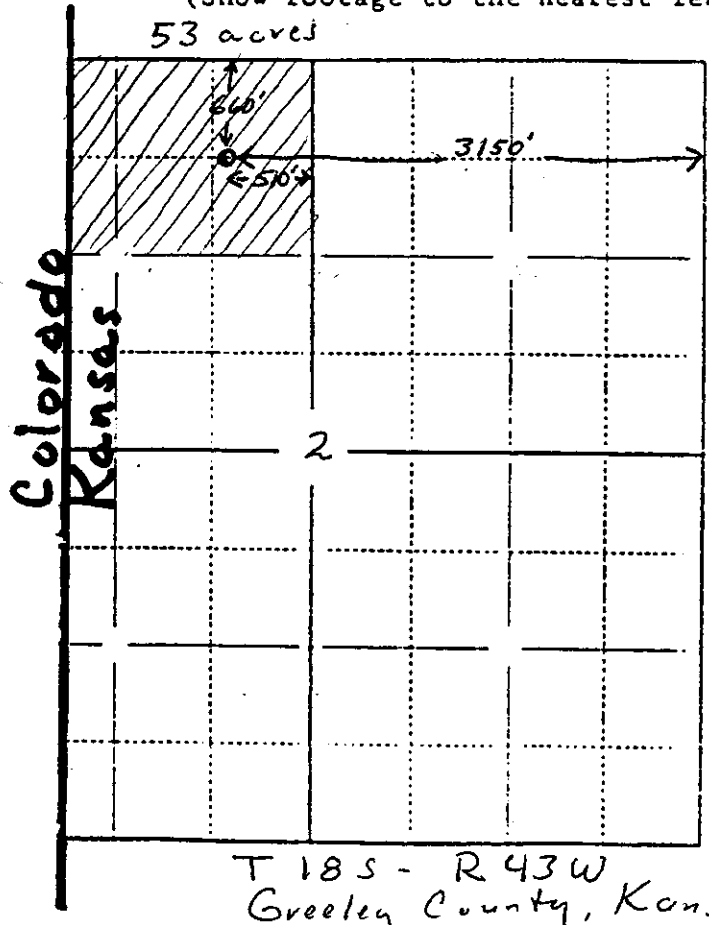

In plotting the proposed location of the well, you must show:

- 1) The manner in which you are using the depicted plat by identifying section lines, i.e. 1 section, 1 section with 8 surrounding sections, 4 sections, etc.;
- 2) the distance of the proposed drilling location from the section's south/north and east/west lines; and
- 3) the distance to the nearest lease or unit boundary line.