

IN ALL CASES PLOT THE INTENDED WELL ON THE PLAT BELOW

PLAT OF ACREAGE ATTRIBUTABLE TO A WELL IN A PRORATED OR SPACED FIELD

If the intended well is in a prorated or spaced field, please fully complete this side of the form. If the intended well is in a prorated or spaced field complete the plat below showing that the well will be properly located in relationship to other wells producing from the common source of supply. Please show all the wells within 1 mile of the boundaries of the proposed acreage attribution unit for gas wells and within 1/2 mile of the boundaries of the proposed acreage attribution unit for oil wells.

API NO. 15-

OPERATOR HGB Oil Co., Edwin C. Schuet & Sharp LOCATION OF WELL: COUNTY Greeley
 LEASE Witt "B" Eng. *1980 feet from south/~~XXXX~~ line of section
 WELL NUMBER 1 *2970 feet from east/~~XXXX~~ line of section
 FIELD Moore-Johnson SECTION 2 TWP 18S RG 43W

NUMBER OF ACRES ATTRIBUTABLE TO WELL 104* IS SECTION REGULAR or x IRREGULAR
 QTR/QTR/QTR OF ACREAGE SW IF SECTION IS IRREGULAR, LOCATE WELL FROM NEAREST CORNER BOUNDARY.

Section corner used: NE NW x SE SW

PLAT

(Show location of the well and shade attributable acreage for prorated or spaced wells.)
 (Show footage to the nearest lease or unit boundary line.)

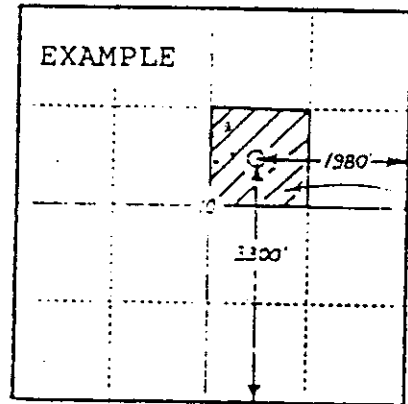
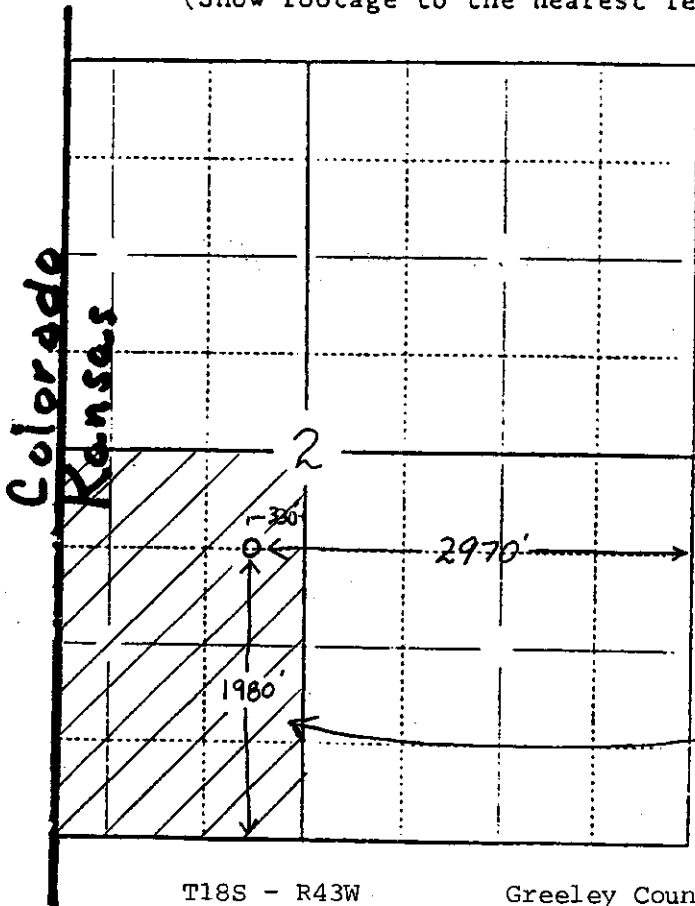

40 ACRES

104 ACRES

T18S - R43W Greeley County

In plotting the proposed location of the well, you must show:

- 1) The manner in which you are using the depicted plat by identifying section lines, i.e. 1 section, 1 section with 8 surrounding sections, 4 sections, etc.;
- 2) the distance of the proposed drilling location from the section's south/north and east/west lines; and
- 3) the distance to the nearest lease or unit boundary line.