

FOR KCC USE:

Correction

FORM C-1 7/91

FORM MUST BE TYPED

FORM MUST BE SIGNED

ALL BLANKS MUST BE FILLED

EFFECTIVE DATE:

State of Kansas

DISTRICT #

NOTICE OF INTENTION TO DRILL

SSAT Yes No

Must be approved by the K.C.C. five (5) days prior to commencing well

* Expected Spud Date November 1 1992
month day year

Spot NW-NE Sec 11, Twp 18 S, Rg 43 XX East West

OPERATOR: License # 30689
Name: Marathon Oil Company
Address: P. O. Box 2690
City/State/Zip: Cody, WY 82414
Contact Person: Randy Meabon
Phone: (307) 587-4961

510 feet from South / North line of Section 1950
1950 feet from East / West line of Section
IS SECTION REGULAR X IRREGULAR? (1/4 Sec. Reg.)

(NOTE: Locate well on the Section Plat on Reverse Side)

County: Greeley
Lease Name: Norma Wendelburg Well #: Z-11
Field Name: Moore-Johnson

CONTRACTOR: License # 5382
Name: Cheyenne Drilling

Is this a Pretested/Spaced Field? X yes no

Target Formation(s): Morrow

Nearest lease or unit boundary: 510' 3912'

Ground Surface Elevation: feet MSL

Water well within one-quarter mile: yes X no

Public water supply well within one mile: yes X no

Depth to bottom of fresh water: 110'

Depth to bottom of usable water: 1600'

Surface Pipe by Alternate: 1 X 250'

Length of Surface Pipe Planned to be set: None

Length of Conductor pipe required: 5300'

Projected Total Depth: Morrow

Formation at Total Depth: Morrow

Water Source for Drilling Operations: well farm pond other

DWR Permit #: Water Source From Colorado Farm Pond

Will Cores Be Taken?: yes X no

If yes, proposed zone:

| Well Drilled For: | Well Class: | Type | Equipment: |
|-------------------|-------------|-----------|--------------|
| X Oil | Enh Rec | Infield | X Mud Rotary |
| Gas | Storage | Pool Ext. | Air Rotary |
| GWMO | Disposal | Wildcat | Cable |
| Seismic: | # of Holes | Other | |
| Other | | | |

10/27/92 cor date

If GWMO: old well information as follows:
Operator:
Well Name:
Comp. Date: Old Total Depth

Directional, Deviated or Horizontal wellbore? yes no
If yes, true vertical depth:
Bottom Hole Location: Same as surface

* was 1980' F. @ 1. & 3910' G.S.E.

AFFIDAVIT * 15 1950' F. @ 1. & 3912' G.S.E

The undersigned hereby affirms that the drilling, completion and eventual plugging of this well will comply with K.S.A. 55-101, et. seq.
It is agreed that the following minimum requirements will be met:

1. Notify the appropriate district office prior to spudding of well;
2. A copy of the approved notice of intent to drill shall be posted on each drilling rig;
3. The minimum amount of surface pipe as specified below shall be set by circulating cement to the top; in all cases surface pipe shall be set through all unconsolidated materials plus a minimum of 20 feet into the underlying formation;
4. If the well is dry hole, an agreement between the operator and the district office on plug length and placement is necessary prior to plugging;
5. The appropriate district office will be notified before well is either plugged or production casing is cemented in;
6. IF AN ALTERNATE IS COMPLETION, PRODUCTION PIPE SHALL BE CEMENTED FROM BELOW ANY USABLE WATER TO SURFACE WITHIN 120 DAYS OF SPUD RATE. IN ALL CASES, NOTIFY DISTRICT OFFICE PRIOR TO ANY CEMENTING.

I hereby certify that the statements made herein are true and to the best of my knowledge and belief.

Date: October 23, 1992 Signature of Operator or Agent: R.P.M. Title: Regulator Coordinator

FOR KCC USE:
 API # 15- 071-20580-0000
 Conductor pipe required None feet
 Minimum surface pipe required 200' feet per Alt. X (2)
 Approved by: C.B. 10-592
 This authorization expires: 4-5-92
 (This authorization void if drilling not started within 6 months of effective date.)
 Spud date: Agent:

RECEIVED
KANSAS CORPORATION COMMISSION
OCT 26 1992
CONSERVATION DIVISION
WICHITA, KS

- REMEMBER TO:
- File Drill Pit Application (form CDP-1) with Intent to Drill;
 - File Completion Form ACD-1 within 120 days of spud date;
 - File acreage attribution plat according to field proration orders;
 - Notify appropriate district office 48 hours prior to workover or re-entry;
 - Submit plugging report (CP-4) after plugging is completed;
 - Obtain written approval before disposing or injecting salt water.

Mail to: Conservation Division, 200 Colorado Derby Building, 202 W. First St., Wichita, Kansas 67202-1286.

IN ALL CASES PLOT THE INTENDED WELL ON THE PLAT BELOW

PLAT OF ACREAGE ATTRIBUTABLE TO A WELL IN A PRORATED OR SPACED FIELD

If the intended well is in a prorated or spaced field, please fully complete this side of the form. If the intended well is in a prorated or spaced field complete the plat below showing that the well will be properly located in relationship to other wells producing from the common source of supply. Please show all the wells within 1 mile of the boundaries of the proposed acreage attribution unit for gas wells and within 1/2 mile of the boundaries of the proposed acreage attribution unit for oil wells.

API NO. 15- _____
 OPERATOR _____ LOCATION OF WELL: COUNTY _____
 LEASE _____ feet from south/north line of section
 WELL NUMBER _____ feet from east/west line of section
 FIELD _____ SECTION _____ TWP _____ RG _____

NUMBER OF ACRES ATTRIBUTABLE TO WELL _____ IS SECTION _____ REGULAR or _____ IRREGULAR
 QTR/QTR/QTR OF ACREAGE _____ - _____ - _____ IF SECTION IS IRREGULAR, LOCATE WELL FROM NEAREST CORNER BOUNDARY.

Section corner used: _____ NE _____ NW _____ SE _____ SW

PLAT

(Show location of the well and shade attributable acreage for prorated or spaced wells.)
 (Show footage to the nearest lease or unit boundary line.)

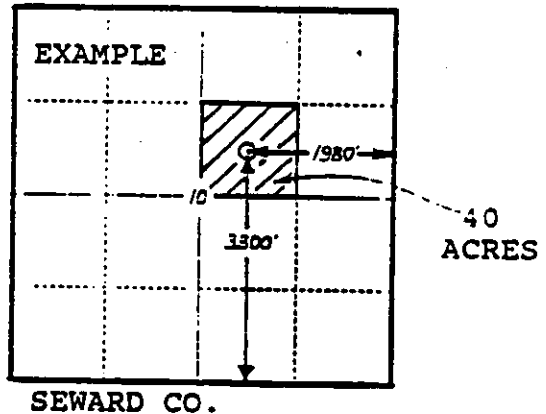

In plotting the proposed location of the well, you must show:

- 1) The manner in which you are using the depicted plat by identifying section lines, i.e. 1 section, 1 section with 8 surrounding sections, 4 sections, etc.;
- 2) the distance of the proposed drilling location from the section's south/north and east/west lines; and
- 3) the distance to the nearest lease or unit boundary line.