

STATE CORPORATION COMMISSION OF KANSAS  
OIL & GAS CONSERVATION DIVISION  
WELL COMPLETION OR RECOMPLETION FORM  
ACO-1 WELL HISTORY  
DESCRIPTION OF WELL AND LEASE

Operator: License # 6006  
Name Molz Oil Co.  
Address R.R. # 2, Box 54  
City/State/Zip Kiowa, KS 67070

Purchaser

Operator Contact Person  
Phone

Contractor: License # 548  
Name Allen Drilling Co. Wichita, Kansas

Wellsite Geologist Gordon W. Keen  
Phone 405-789-0178

Designate Type of Completion

New Well  Re-Entry  Workover  
 Oil  SWD  Temp Abd  
 Gas  Inj  Delayed Comp.  
 Dry  Other (Core, Water Supply etc.)

If OWVO: old well info as follows:

Operator  
Well Name  
Comp. Date  
Old Total Depth

WELL HISTORY

Drilling Method:

Mud Rotary  Air Rotary  Cable

5-1-89 5-9-89 P&A 5-10-89  
Spud Date Date Reached TD Completion Date

4380'  
Total Depth PBTD

Amount of Surface Pipe Set and Cemented at 302 feet  
Multiple Stage Cementing Collar Used? Yes No  
If yes, show depth set...feet  
If alternate 2 completion, cement circulated from...feet depth to...w/...SX cmt  
Cement Company Name  
Invoice # A-I DGA

API NO. 15-007-22,238-00-00  
County Barber  
N/2 NE NE Sec. 35 Twp. 32 Rge. 12 East West  
4900' Ft North from Southeast Corner of Section  
845' Ft West from Southeast Corner of Section  
(Note: Locate well in section plat below)

Lease Name SHAW Well # 1

Field Name Toni-Mike Ext

Producing Formation DRY

Elevation: Ground 1434 KB 1439

Section Plat

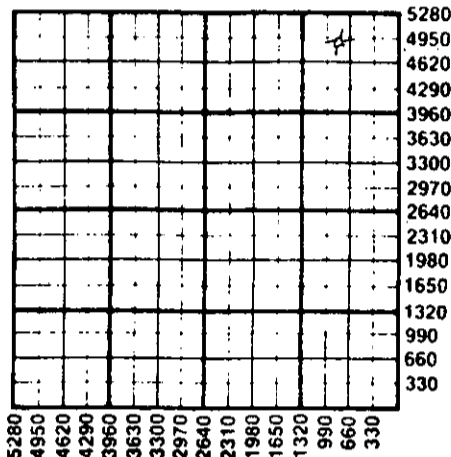

WATER SUPPLY INFORMATION

Disposition of Produced Water: Disposal  
Docket # Repressuring

Questions on this portion of the ACO-1 call:  
Water Resources Board (913) 296-3717

Source of Water:  
Division of Water Resources Permit #

Groundwater...Ft North from Southeast Corner  
(Well) ...Ft West from Southeast Corner of  
Sec Twp Rge East West

Surface Water...Ft North from Southeast Corner  
(Stream, pond etc)...Ft West from Southeast Corner  
Sec Twp Rge East West

Other (explain)  
(purchased from city, R.W.D. #)

INSTRUCTIONS: This form shall be completed in triplicate and filed with the Kansas Corporation Commission, 200 Colorado Derby Building, Wichita, Kansas 67202, within 120 days of the spud date of any well. Rule 82-3-130, 82-3-107 and 82-3-106 apply.

Information on side two of this form will be held confidential for a period of 12 months if requested in writing and submitted with the form. See rule 82-3-107 for confidentiality in excess of 12 months. One copy of all wireline logs and drillers time log shall be attached with this form. Submit CP-4 form with all plugged wells. Submit CP-111 form with all temporarily abandoned wells.

All requirements of the statutes, rules and regulations promulgated to regulate the oil and gas industry have been fully complied with and the statements herein are complete and correct to the best of my knowledge.

Signature

Title Pres Date 5-26-89

Subscribed and sworn to before me this 26 day of May 1989

Notary Public B. Ann Leader

Date Commission Expires 4-12-93

K.C.C. OFFICE USE ONLY  
F Letter of Confidentiality Attached  
C Wireline Log Received  
C Drillers Timelog Received  
Distribution  
KCC SWD/Rep NGPA  
KGS Plug Other  
(Specify)  
5-31-89  
Form ACO-1 (5-86)

Sec. 35 Twp. 32 Rge. 12 W

B. ANN LEADER  
NOTARY PUBLIC  
STATE OF KANSAS  
My Appt. Exp. 4-12-93

Operator Name Molz Oil Co. Lease Name Shaw Well #

Sec. 35 Twp. 32 Rge. 12 East West County Barber

WELL LOG

INSTRUCTIONS: Show important tops and base of formations penetrated. Detail all cores. Report all drill stem tests giving interval tested, time tool open and closed, flowing and shut-in pressures, whether shut-in pressure reached static level, hydrostatic pressures, bottom hole temperature, fluid recovery, and flow rates if gas to surface during test. Attach extra sheet if more space is needed. Attach copy of log.

Drill Stem Tests Taken [X] Yes [ ] No
Samples Sent to Geological Survey [X] Yes [ ] No
Cores Taken [ ] Yes [X] No

Formation Description [X] Log [ ] Sample

Table with 3 columns: Name, Top, Bottom. Rows include Indian Cave s.s., Elgin s.s., Heebner sh., Snyder Ville s.s., Lansing, SWOPE, Basal Penn. Cong. with various DST and GTS data.

65' GCM IF 81-81#, ICIP 1358#, FF 91-91#, FCIP 1277#, G27,320CFGPO/60"

New [ ] Used [ ]
ace, intermediate, production, etc.

Gt Guns Logs DIL\_DCPL

Table with 4 columns: Setting Depth, Type of Cement, #Sacks Used, Type and Percent Additives.

PERFORATION RECORD table with columns: Shots Per Foot, Specify Footage of Each Interval Perforated, Acid, Fracture, Shot, Cement Squeeze Record (Amount and Kind of Material Used), Depth.

TUBING RECORD table with columns: Size, Set At, Packer at, Liner Run [ ] Yes [ ] No.

Date of First Production Producing Method [ ] Flowing [ ] Pumping [ ] Gas Lift [ ] Other (explain).....

Table for Estimated Production Per 24 Hours with columns: Oil (Bbls), Gas (MCF), Water (Bbls), Gas-Oil Ratio (CFPB), Gravity.

METHOD OF COMPLETION Production Interval

Disposition of gas: [ ] Vented [ ] Sold [ ] Used on Lease [ ] Open Hole [ ] Perforation [ ] Other (Specify) [ ] Dually Completed [ ] Commingled

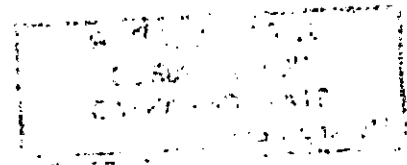

Amended

SIDE TWO

Operator Name Molz Oil Company Lease Name Shaw Well # 1

Sec. 35 Twp. 32 Rge. 12 East West County Barber

WELL LOG

INSTRUCTIONS: Show important tops and base of formations penetrated. Detail all cores. Report all drill stem tests giving interval tested, time tool open and closed, flowing and shut-in pressures, whether shut-in pressure reached static level, hydrostatic pressures, bottom hole temperature, fluid recovery, and flow rates if gas to surface during test. Attach extra sheet if more space is needed. Attach copy of log.

Drill Stem Tests Taken [ ] Yes [ ] No
Samples Sent to Geological Survey [ ] Yes [ ] No
Cores Taken [ ] Yes [ ] No

Formation Description [ ] Log [ ] Sample

Name Top Bottom

CASING RECORD [ ] New [ ] Used

Report all strings set-conductor, surface, intermediate, production, etc.

Table with 8 columns: Purpose of String, Size Hole Drilled, Size Casing Set (in O.D.), Weight Lbs/Ft., Setting Depth, Type of Cement, #Sacks Used, Type and Percent Additives. Row 1: Surface, 12-1/4", 8-5/8", 23#, 302', 60/40 Poz, 175.

PERFORATION RECORD

Acid, Fracture, Shot, Cement Squeeze Record

Table with 4 columns: Shots Per Foot, Specify Footage of Each Interval Perforated, (Amount and Kind of Material Used), Depth.

TUBING RECORD

Size Set At Packer at Liner Run [ ] Yes [ ] No

Date of First Production Producing Method [ ] Flowing [ ] Pumping [ ] Gas Lift [ ] Other (explain)

Table with 6 columns: Oil, Gas, Water, Gas-Oil Ratio, Gravity. Row 1: Estimated Production Per 24 Hours, Bbls, MCF, Bbls, CFPB.

METHOD OF COMPLETION

Production Interval

Disposition of gas: [ ] Vented [ ] Sold [ ] Used on Lease [ ] Open Hole [ ] Perforation [ ] Other (Specify) [ ] Dually Completed [ ] Conmingled

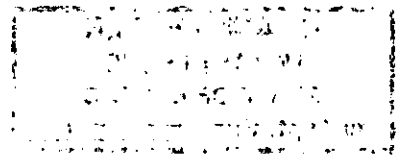

STATE CORPORATION COMMISSION OF KANSAS  
OIL & GAS CONSERVATION DIVISION  
WELL COMPLETION OR RECOMPLETION FORM  
ACO-1 WELL HISTORY  
DESCRIPTION OF WELL AND LEASE

API NO. 15-007-22,238  
County Barber  
C.... NE... NE. Sec. 35. Twp. 32. Rge. 12. X East West

Operator: License # 6006  
Name Molz Oil Company  
Address R.R. #2  
Box 54  
City/State/Zip Kiowa KS 67070

4900 Ft North from Southeast Corner of Section  
845 Ft West from Southeast Corner of Section  
(Note: Locate well in section plat below)

Purchaser.....

Lease Name Shaw Well # 1

Operator Contact Person Jim Molz  
Phone (316) 296-4558

Field Name.....

Producing Formation.....

Contractor: License # 5418  
Name Allen Drilling Company

Elevation: Ground 1434 KB 1439

Wellsite Geologist Gordon Keen  
Phone.....

Designate Type of Completion  
X New Well Re-Entry Workover

X Oil SWD Temp Abd  
Gas Inj Delayed Comp.  
X Dry plugged Other (Core, Water Supply etc.)

If ONNO: old well Info as follows:  
Operator.....  
Well Name.....  
Comp. Date.....Old Total Depth.....

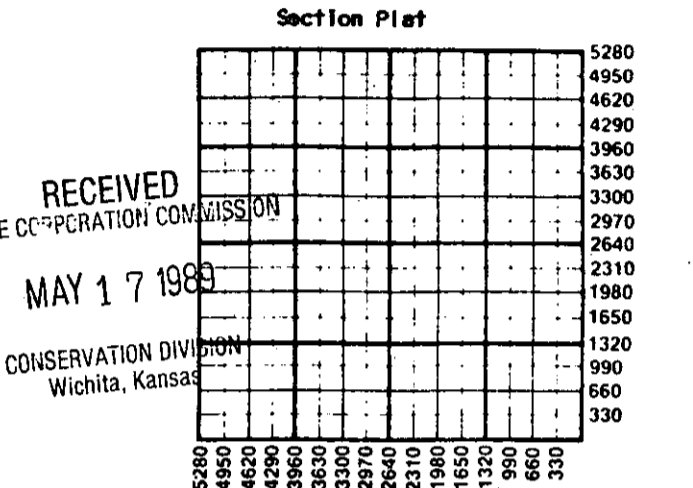

WATER SUPPLY INFORMATION  
Disposition of Produced Water: Disposal  
Docket # ..... Repressuring

WELL HISTORY  
Drilling Method:  
X Mud Rotary Air Rotary Cable

5/1/89 5/9/89 5-10-89  
Spud Date Date Reached TD Completion Date

4380'  
Total Depth PBDT

Amount of Surface Pipe Set and Cemented at 302 feet  
Multiple Stage Cementing Collar Used? Yes No  
If yes, show depth set.....feet  
If alternate 2 completion, cement circulated from.....feet depth to.....w/.....SX cmt  
Cement Company Name.....  
Invoice #.....

Questions on this portion of the ACO-1 call:  
Water Resources Board (913) 296-3717  
Source of Water:  
Division of Water Resources Permit #.....  
Groundwater.....Ft North from Southeast Corner (Well) .....Ft West from Southeast Corner of Sec Twp Rge East West  
Surface Water.....Ft North from Southeast Corner (Stream, pond etc).....Ft West from Southeast Corner Sec Twp Rge East West  
Other (explain).....  
(purchased from city, R.W.D. #)

INSTRUCTIONS: This form shall be completed in triplicate and filed with the Kansas Corporation Commission, 200 Colorado Derby Building, Wichita, Kansas 67202, within 120 days of the spud date of any well. Rule 82-3-130, 82-3-107 and 82-3-106 apply. Information on side two of this form will be held confidential for a period of 12 months if requested in writing and submitted with the form. See rule 82-3-107 for confidentiality in excess of 12 months. One copy of all wireline logs and drillers time log shall be attached with this form. Submit CP-4 form with all plugged wells. Submit CP-111 form with all temporarily abandoned wells.

All requirements of the statutes, rules and regulations promulgated to regulate the oil and gas industry have been fully complied with and the statements herein are complete and correct to the best of my knowledge.

Signature [Signature]  
Title [Signature] Date 5-16-89

Subscribed and sworn to before me this 16 day of May 1989  
Notary Public B. Ann Leader

Date Commission Expires 4-12-93

B. ANN LEADER  
NOTARY PUBLIC  
STATE OF KANSAS  
My Appt. Exp. 4-12-93

K.C.C. OFFICE USE ONLY  
F Letter of Confidentiality Attached  
C Wireline Log Received  
C Drillers Timelog Received  
Distribution  
KCC SWD/Rep NGPA  
KGS Plug Other (Specify)

Sec. 35 Twp. 32 Rge. 12 W

FORM MUST BE TYPED  
FORM C-1 12/88

State of Kansas  
NOTICE OF INTENTION TO DRILL

FORM MUST BE SIGNED  
ALL BLANKS MUST BE FILLED

Must be approved by the K.C.C. five (5) days prior to commencing well

Expected Spud Date May 1 89  
month day year

APPROX-  
C-NE-NE Sec 35 Twp 32 S, Rg 12 East  
 West

OPERATOR: License # 6006  
Name: Molz Oil Company  
Address: R.R. #2, Box 54  
City/State/Zip: Kiowa, KS 67070  
Contact Person: Jim Molz  
Phone: 316-296-4558

4900 feet from South line of Section  
845 feet from East line of Section  
(Note: Locate well on Section Plat Below)

CONTRACTOR: License # 5418  
Name: Allen Drilling Co.

County: Barber  
Lease Name: Shaw Well #: 1  
Field Name: \_\_\_\_\_

Well Drilled For: Well Class: Type Equipment:

- Oil ... Inj ... Infield  Mud Rotary
- Gas ... Storage ... Pool Ext. ... Air Rotary
- ... G.P.O. ... Disposal ... Wildcat ... Cable
- ... Seismic; ... # of Holes

Is this a Prorated Field? ... yes ..X.. no  
 Target Formation(s): Jansing  
 Nearest lease or unit boundary: 380'  
 Ground Surface Elevation: 1434 feet HSL  
 Domestic well within 330 feet: ... yes X.. no  
 Municipal well within one mile: ... yes X.. no  
 Depth to bottom of fresh water: 200' 180'  
 Depth to bottom of usable water: 80' 180'  
 Surface Pipe by Alternate:  1 ... 2  
 Length of Surface Pipe Planned to be set: 300'  
 Length of Conductor pipe required: 4200' none  
 Projected Total Depth: \_\_\_\_\_  
 Formation at Total Depth: K-C  
 Water Source for Drilling Operations: \_\_\_\_\_  
 ... well ... farm pond ..X.. other

If OWAQ: old well information as follows:  
Operator: \_\_\_\_\_  
Well Name: \_\_\_\_\_  
Comp. Date: \_\_\_\_\_ Old Total Depth \_\_\_\_\_

DWR Permit #: \_\_\_\_\_  
Will Cores Be Taken?: ... yes ..X.. no  
If yes, proposed zone: \_\_\_\_\_

Directional, Deviated or Horizontal wellbore? ... yes ..X.. no  
If yes, total depth location: \_\_\_\_\_

Spud 5-1-89 10:00 AM  
Permit water 300' 8:51

AFFIDAVIT  
200' Alt. I Req.

PUSHER Vince Schrepel  
 TD 4380 FORMATION MISS  
 SURFACE PIPE 8 5/8" @ 302'  
 ANHYDRITE 1750' ? ELEVATION 1750'  
 STARTING TIME & DATE 8:00am 5-10-89  
 COMPLETION TIME & DATE 10:00am 5-10-89  
 1st PLUG @ 730 FT. W/ 40 SX  
 2nd PLUG @ 330 FT. W/ 40 SX  
 3rd PLUG @ 40 FT. W/ 10 SX  
 4th PLUG @ \_\_\_\_\_ FT. W/ \_\_\_\_\_ SX  
 RAT HOLE CIRCULATED W/ 15 SX  
 MOUSE HOLE CIRCULATED W/ \_\_\_\_\_ SX  
 WATER WELL PLUGGED W/ \_\_\_\_\_ SX  
 CEMENT COMPANY BT Titan  
 TECHNICIAN D.K. gave orders  
 I called the Tool Pusher and 1750' was his pick for Any. Base. He will find it on log when ran. I would guess about 450'

RECEIVED  
STATE CORPORATION COMMISSION  
MAY 15 1989  
CONSERVATION DIVISION  
Wichita, Kansas

1980	
1650	
1320	
990	
660	
330	
4950	
4620	
4290	
3960	
3630	
3300	
2970	
2640	
2310	
1980	
1650	
1320	
990	
660	
330	

CONSERVATION DIVISION  
Wichita, Kansas

Spud date: \_\_\_\_\_ Agent: \_\_\_\_\_

- REMEMBER TO:
- File Drill Pit Application (form CDP-1) with Intent to Drill;
  - File Completion Form ACO-1 within 120 days of spud date;
  - File acreage attribution plat according to field proration orders;
  - Notify appropriate district office 48 hours prior to workover or re-entry;
  - Submit plugging report (CP-4) after plugging is completed;
  - Obtain written approval before disposing or injecting salt water.