

STATE CORPORATION COMMISSION OF KANSAS
OIL & GAS CONSERVATION DIVISION
WELL COMPLETION OR RECOMPLETION FORM
ACO-1 WELL HISTORY
DESCRIPTION OF WELL AND LEASE

5

API NO. 15-007-21,955-00-01

County Barber
T10' N & 155' E
of NW SE NW Sec. 35 Twp. 32S Rge. 12 East West

Operator: License # 5087
Name Texas Energies, Inc.
Address P.O. Box 947
City/State/Zip Pratt, KS 67124

3740 Ft North from Southeast Corner of Section
3475 Ft West from Southeast Corner of Section
(Note: Locate well in section plat below)

Purchaser KP&L
Box 889 Topeka, KS 66601

Lease Name Ash Well # 2-35

Field Name Toni-Mike NE

Operator Contact Person Mark P. Stevenson
Phone (316) 672-7514

Producing Formation Elgin Sand

Elevation: Ground 1489 KB 1502

Contractor (for recompletion)
Name Pratt Well Service

Wellsite Geologist
Phone

Designate Type of Completion
New Well Re-Entry Workover
Oil SWD Temp Abd
 Gas Inj Delayed Comp.
Dry Other (Core, Water Supply etc.)

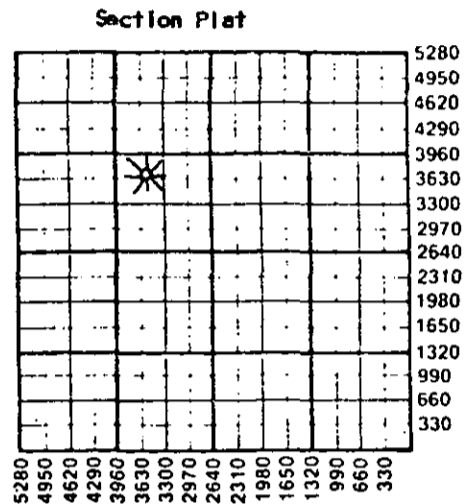

If O.W.O.: old well info as follows:
Operator
Well Name
Comp. Date
Old Total Depth

WATER SUPPLY INFORMATION

Disposition of Produced Water: Disposal
Docket # Repressuring

WELL HISTORY
Drilling Method: (original)
 Mud Rotary Air Rotary Cable

Questions on this portion of the ACO-1 call:
Water Resources Board (913) 296-3717

.J2-29-84.. ..1-09-85.... ..1-24-85....
Spud Date Date Reached TD Completion Date
.....4800....3912..... (Re-completion)
Total Depth PBTB (Date: 08-04-87)
Recompletion PBTB: 3650
Amount of Surface Pipe Set and Cemented at 299 feet
Multiple Stage Cementing Collar Used? Yes No
If yes, show depth set.....feet
If alternate 2 completion, cement circulated
from.....feet depth to.....w/.....SX cmt
Cement Company Name
Invoice #

Source of Water:
Division of Water Resources Permit #
Groundwater.....Ft North from Southeast Corner
(Well)Ft West from Southeast Corner of
Sec Twp Rge East West
Surface Water.....Ft North from Southeast Corner
(Stream, pond etc).....Ft West from Southeast Corner
Sec Twp Rge East West
 Other (explain) DeMar Ash (landowner).....
(purchased from city, R.W.D. #)

INSTRUCTIONS: This form shall be completed in triplicate and filed with the Kansas Corporation Commission, 200 Colorado Derby Building, Wichita, Kansas 67202, within 120 days of the spud date of any well. Rule 82-3-130, 82-3-107 and 82-3-106 apply. Information on side two of this form will be held confidential for a period of 12 months if requested in writing and submitted with the form. See rule 82-3-107 for confidentiality in excess of 12 months. One copy of all wireline logs and drillers time log shall be attached with this form. Submit CP-4 form with all plugged wells. Submit CP-111 form with all temporarily abandoned wells.

All requirements of the statutes, rules and regulations promulgated to regulate the oil and gas industry have been fully complied with and the statements herein are complete and correct to the best of my knowledge.

Signature Mark P. Stevenson
Title Operations Superintendent Date 08-25-87

Subscribed and sworn to before me this 25th day of August 1987
Notary Public Stephanie Johnson
Date Commission Expires 3-30-91



K.C.C. OFFICE USE ONLY
F Letter of Confidentiality Attached
C Wireline Log Received
C Drillers Timelog Received
Distribution
 KCC SWD/Rep NGPA
 KGS Plug Other
(Specify)
RECEIVED
CORPORATION COMMISSION
AUG 26 1987
Form ACO-1 (5-86)

Sec. 32 Twp. 32 Rge. 12 W

Operator Name Texas Energies, Inc. Lease Name Ash Well # 2-35

Sec. 35 Twp. 32S Rge. 12 County Barber

East
 West

WELL LOG

INSTRUCTIONS: Show important tops and base of formations penetrated. Detail all cores. Report all drill stem tests giving interval tested, time tool open and closed, flowing and shut-in pressures, whether shut-in pressure reached static level, hydrostatic pressures, bottom hole temperature, fluid recovery, and flow rates if gas to surface during test. Attach extra sheet if more space is needed. Attach copy of log.

Drill Stem Tests Taken Yes No
 Samples Sent to Geological Survey Yes No
 Cores Taken Yes No

Formation Description
 Log Sample

DST #1 3448-3491 (Elgin Sd). Time 30-45-45-60. IHP 1755; IFP 171-257; ISIP 1485; FFP 293-330; FSIP 1473; FHP 1744. Gas to surface in 10 min. 1st opening - gauged 1.123 mcfg to 295 mcfg. 2nd opening gauged 893 mcfg to 196 mcfg and stabilized. Rec. 160' drilling mud.

Name	Top	Bottom
Chase	1786	(-284)
Co. Grove	2176	(-674)
Onaga Sh	2618	(-1116)
Stotler	2831	(-1329)
Elgin Sd	3465	(-1963)
Heebner	3590	(-2088)
Lansing	3779	(-2277)
B/KC	4230	(-2728)
Miss.	4365	(-2863)
Kinderhook	4538	(-3036)
Viola	4649	(-3147)
Simpson Sh	4738	(-3236)
L.T.D.	4801	(-3299)

DST #2 3775-3805 (Lansing) Time 30-45-45-60. IHP 1943; IFP 232-159; ISIP 1426; FFP 159-159; FSIP 1426; FHP 1920. Gas to surface in 12 min. 1st opening - gauged 725 mcfg to 319 mcfg. 2nd opening gauged 472 mcfg to 283 mcfg and stabilized. Rec. 40' slightly water cut mud, 30' water mud, 30' muddy water, 120' water.

CASING RECORD <input checked="" type="checkbox"/> New <input type="checkbox"/> Used							
Report all strings set-conductor, surface, intermediate, production, etc.							
Purpose of String	Size Hole Drilled	Size Casing Set (in O.D.)	Weight Lbs/Ft.	Setting Depth	Type of Cement	#Sacks Used	Type and Percent Additives
..Surface.....	..12.1/4..8.5/8..23.....	..299..	Class.A.	..175..	2% Gel. 3% CC.
..Production...	..7.7/8..4.1/2..10.5..	..3952..	Lite.....	..25..
					Common	150	Latex
PERFORATION RECORD				Acid, Fracture, Shot, Cement Squeeze Record			
Shots Per Foot	Specify Footage of Each Interval Perforated			(Amount and Kind of Material Used)		Depth	
.....4.....	..3784-3788.....			500 gal. .15% mud acid.....		3784-88..	
**.....2.....	..3448-50...3459-61...3466-67.....			**cast. iron bridge plug.....		3650.....	
TUBING RECORD		Size	Set At	Packer at	Liner Run	<input type="checkbox"/> Yes <input type="checkbox"/> No	
		2 3/8	3581	--			
Date of First Production re-completion:		Producing Method					
8-09-87		<input type="checkbox"/> Flowing <input checked="" type="checkbox"/> Pumping <input type="checkbox"/> Gas Lift <input type="checkbox"/> Other (explain).....					
Estimated Production Per 24 Hours		Oil	Gas	Water	Gas-Oil Ratio	Gravity	
		0 Bbls	150 MCF	0 Bbls	CFPB		

METHOD OF COMPLETION

Production Interval

Disposition of gas: Vented
 Sold
 Used on Lease

Open Hole Perforation
 Other (Specify).....
 Dually Completed
 Comingled

..3448-3467.0A...

** recompletion 8-04-87