

EFFECTIVE DATE: 3-13-94

State of Kansas

NOTICE OF INTENTION TO DRILL

Must be approved by the K.C.C. five (5) days prior to commencing well

DISTRICT # 1

SEAL Yes No

Expected Spud Date March 15th 1994

Spot C NW SW Sec 29 Twp 30 S Rg 13W West

OPERATOR: License # 5506
Name: Woolsey Petroleum Corporation
Address: 107 N Market Ste 600
City/State/Zip: Wichita KS 67202-1807
Contact Person: I Wayne Woolsey
Phone: (316) 267-4379

1980' FSL feet from South / North line of Section
660' FWL feet from East / West line of Section
IS SECTION REGULAR X IRREGULAR?

(NOTE: Locate well on the Section Plat on Reverse Side)
County: Barber
Lease Name: Edwin Lenkner Well #: 1
Field Name: Unnamed

CONTRACTOR: License # 5929
Name: Duke Drilling Co Inc

Is this a Prorated/Spaced Field? yes X no
Target Formation(s): Arbuckle
Nearest lease or unit boundary: 660'

Well Drilled For: Well Class: Type Equipment:
X Oil Enh Rec Infield X Mud Rotary
Gas Storage Pool Ext Air Rotary
OWVO Disposal Wildcat Cable
Seismic # of Holes Other

Ground Surface Elevation: 1921 feet MSL
Water well within one-quarter mile: yes X no
Public water supply well within one mile: yes X no

If OWVO: old well information as follows:
Operator: n/a
Well Name:
Comp. Date: Old Total Depth

Depth to bottom of fresh water: 80'
Depth to bottom of usable water: 180'
Surface Pipe by Alternate: X 1 2

Directional, Deviated or Horizontal wellbore? yes X no
If yes, true vertical depth:
Bottom Hole Location:

Length of Surface Pipe Planned to be set: 200'
Length of Conductor pipe required: none
Projected Total Depth: 4870'
Formation at Total Depth: Arbuckle

Water Source for Drilling Operations:
... well ... farm pond X other
DWR Permit #: n/a
Will Cores Be Taken?: yes X no
If yes, proposed zone:

AFFIDAVIT

The undersigned hereby affirms that the drilling, completion and eventual plugging of this well will comply with K.S.A. 55-101, et. seq.
It is agreed that the following minimum requirements will be met:

- 1. Notify the appropriate district office prior to spudding of well;
2. A copy of the approved notice of intent to drill shall be posted on each drilling rig;
3. The minimum amount of surface pipe as specified below shall be set by circulating cement to the top; in all cases surface pipe shall be set through all unconsolidated materials plus a minimum of 20 feet into the underlying formation;
4. If the well is dry hole, an agreement between the operator and the district office on plug length and placement is necessary prior to plugging;
5. The appropriate district office will be notified before well is either plugged or production casing is cemented in;
6. IF AN ALTERNATE II COMPLETION, PRODUCTION PIPE SHALL BE CEMENTED FROM BELOW ANY USABLE WATER TO SURFACE WITHIN 120 DAYS OF SPUD DATE. IN ALL CASES, NOTIFY DISTRICT OFFICE PRIOR TO ANY CEMENTING.

I hereby certify that the statements made herein are true and to the best of my knowledge and belief.
Date: 03/01/94 Signature of Operator or Agent: I Wayne Woolsey Title: President

FOR KCC USE-
API # 15- 007-22436-00-00
Conductor pipe required NONE feet
Minimum surface pipe required 200 feet per Alt. (1) X
Approved by: CB 3-8-94
This authorization expires: 9-8-94
(This authorization void if drilling not started within 6 months of effective date.)
Spud date: Agent:

REMEMBER TO:

- File Drill Pit Application (form CDP-1) with intent to Drill;
- File Completion Form ACO-1 within 120 days of spud date;
- File acreage attribution plat according to field proration orders;
- Notify appropriate district office 48 hours prior to workover or re-entry;
- Submit plugging report (CP-4) after plugging is completed;
- Obtain written approval before disposing or injecting salt water.

Mail to: Conservation Division, 200 Colorado Derby Building, 202 W. First St., Wichita, Kansas 67202-1286

RECEIVED STATE CORPORATION COMMISSION

MAR 07 1994

CONSERVATION DIVISION Wichita, KS

29 30

IN ALL CASES PLOT THE INTENDED WELL ON THE PLAT BELOW

PLAT OF ACREAGE ATTRIBUTABLE TO A WELL IN A PRORATED OR SPACED FIELD

If the intended well is in a prorated or spaced field, please fully complete this side of the form. If the intended well is in a prorated or spaced field complete the plat below showing that the well will be properly located in relationship to other wells producing from the common source of supply. Please show all the wells within 1 mile of the boundaries of the proposed acreage attribution unit for gas wells and within 1/2 mile of the boundaries of the proposed acreage attribution unit for oil wells.

API NO. 15- 007-22425
 OPERATOR Woolsey Petroleum Corporation LOCATION OF WELL: COUNTY Barber
 LEASE Edwin Lenkner **1980' FSL feet from south/north line of section
 WELL NUMBER 1 ** 660' FWL feet from east/west line of section
 FIELD _____ SECTION 29 TWP 30S RG 13W

NUMBER OF ACRES ATTRIBUTABLE TO WELL _____ IS SECTION _____ REGULAR or XX IRREGULAR
 QTR/QTR/QTR OF ACREAGE _____ IF SECTION IS IRREGULAR, LOCATE WELL FROM NEAREST
CORNER BOUNDARY.

Section corner used: NE NW SE XX SW
 PLAT

(Show location of the well and shade attributable acreage for prorated or spaced wells.)
 (Show footage to the nearest lease or unit boundary line.)

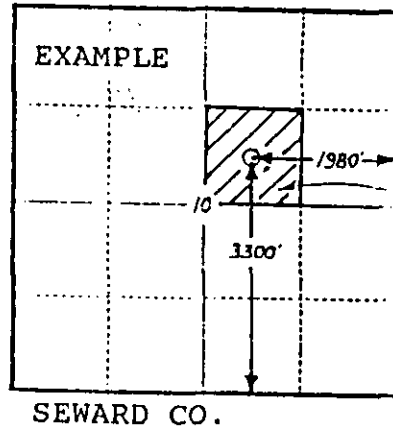
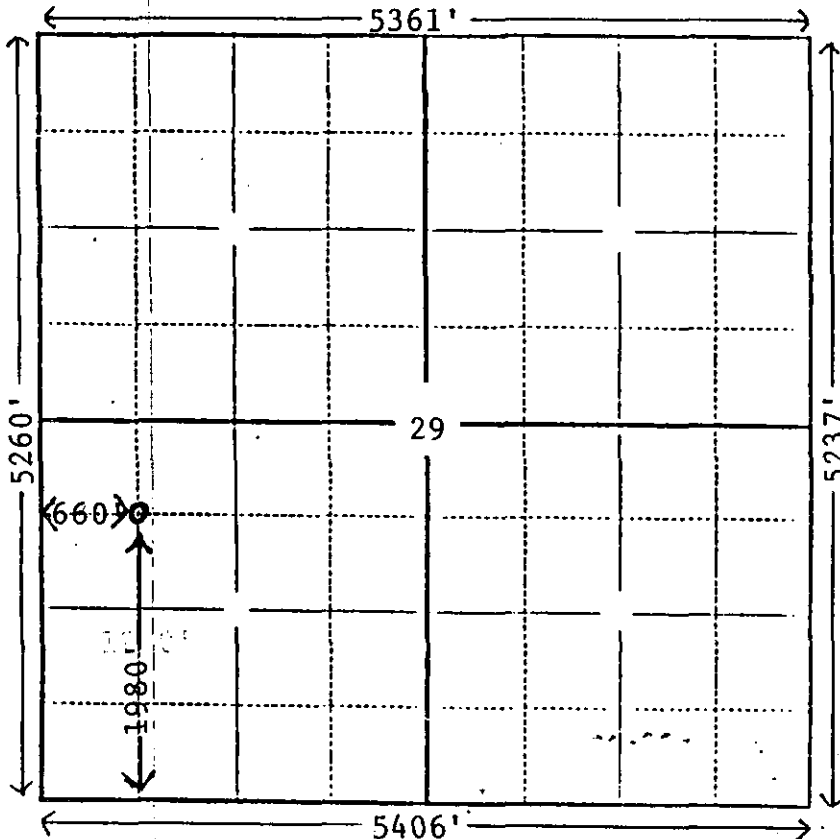

In plotting the proposed location of the well, you must show:

- 1) The manner in which you are using the depicted plat by identifying section lines, i.e. 1 section, 1 section with 8 surrounding sections, 4 sections, etc.;
- 2) the distance of the proposed drilling location from the section's south/north and east/west lines; and
- 3) the distance to the nearest lease or unit boundary line.