

EFFECTIVE DATE: 3-23-94
DISTRICT 1
SEAT: Yes No

State of Kansas
NOTICE OF INTENTION TO DRILL

FORM MUST BE 5
ALL BLANKS MUST BE F

Must be approved by the K.C.C. five (5) days prior to commencing well

Expected Spud Date March 21 1994
month day year

Spot
C NW NE Sec 13 Twp 32 S, Rg 11 X

OPERATOR: License # 05050
Name: Hummon Corporation
Address: 200 W. Douglas, #1020
City/State/Zip: Wichita, KS 67202
Contact Person: Joyce Cochran
Phone: 263-8521

4620' feet from South ~~1/4~~th line of Se
1980' feet from East ~~1/4~~th line of Se
IS SECTION X REGULAR _____ IRREGULAR?

(NOTE: Locate well on the Section Plat on Reverse
County: Barber
Lease Name: McGuire A. Well #: 1
Field Name: McGuire-Goemann NW

CONTRACTOR: License # 5822
Name: VAL Energy, Inc.

Is this a Prorated/Spaced Field? yes X no
Target Formation(s): Mississippian
Nearest lease or unit boundary: 660'
Ground Surface Elevation: unknown

Well Drilled For: Well Class: Type Equipment:
X. Oil ... Enh Rec ... Infield X. Mud Rotary
... Gas ... Storage ... Pool Ext. ... Air Rotary
... OUVVO ... Disposal X. Wildcat ... Cable
... Seismic: ... # of Holes ... Other

Water well within one-quarter mile: yes
Public water supply well within one mile: yes
Depth to bottom of fresh water: 80'
Depth to bottom of usable water: 180'

If OUVVO: old well information as follows:
Operator: _____
Well Name: _____
Comp. Date: _____ Old Total Depth: _____

Surface Pipe by Alternate: X 1 2
Length of Surface Pipe Planned to be set: 300'
Length of Conductor pipe required: none
Projected Total Depth: 4400'
Formation at Total Depth: Mississippian
Water Source for Drilling Operations:
X well farm pond

Directional, Deviated or Horizontal wellbore? yes no
If yes, true vertical depth: _____
Bottom Hole Location: _____

DWR Permit #: _____
Will Cores Be Taken? yes X no
If yes, proposed zone: _____

AFFIDAVIT

RECEIVED
KANSAS CORPORATION COMMISSION

The undersigned hereby affirms that the drilling, completion and eventual plugging of this well will comply with K.S.A. 101, et. seq.
It is agreed that the following minimum requirements will be met:

MAR 17 1994
3-1-94

1. Notify the appropriate district office prior to spudding of well;
2. A copy of the approved notice of intent to drill shall be posted on each drilling rig;
3. The minimum amount of surface pipe as specified below shall be set by circulating cement to the stop; in all surface pipe shall be set through all unconsolidated materials plus a minimum of 20 feet into the underlying formation;
4. If the well is dry hole, an agreement between the operator and the district office on plug length and placement necessary prior to plugging;
5. The appropriate district office will be notified before well is either plugged or production testing is cemented;
6. IF AN ALTERNATE IS COMPLETION, PRODUCTION PIPE SHALL BE CEMENTED FROM BELOW ANY USABLE WATER TO SURFACE WITHIN 120 DAYS OF SPUD DATE. IN ALL CASES, NOTIFY DISTRICT OFFICE PRIOR TO ANY CEMENTING.

I hereby certify that the statements made herein are true and to the best of my knowledge and belief.
Date: 3-16-94 Signature of Operator or Agent: Joyce Cochran Title: Secretary

FOR KCC USE:
API # 15- 007-22438-0000
Conductor pipe required NONE feet
Minimum surface pipe required 300' feet per Alt. 0 X
Approved by: CB 3-18-94
This authorization expires: 9-18-94
(This authorization void if drilling not started within 6 months of effective date.)
Spud date: _____ Agent: _____

MAILED

MAR 18 1994
3-18-94
CONSERVATION DIVISION
Wichita, Kansas

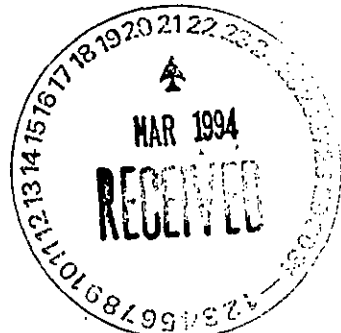

REMEMBER TO:

- File Drill Pit Application (form COP-1) with Intent to Drill;
- File Completion Form ACO-1 within 120 days of spud date;
- File acreage attribution plat according to field proration orders;
- Notify appropriate district office 48 hours prior to workover or re-entry;
- Submit plugging report (CP-4) after plugging is completed;
- Obtain written approval before disposing or injecting salt water.

Mail to: Conservation Division, 200 Colorado Derby Building, 202 W. First St., Wichita, Kansas 67202-1286.

PLAT OF ACREAGE ATTRIBUTABLE TO A WELL IN A PRORATED OR SPACED FIELD

If the intended well is in a prorated or spaced field, please fully complete this side of the form. If the intended well is in a prorated or spaced field complete the plat below showing that the well will be properly located in relationship to other wells producing from the common source of supply. Please show all the wells within 1 mile of the boundaries of the proposed acreage attribution unit for gas wells and within 1/2 mile of the boundaries of the proposed acreage attribution unit for oil wells.

API NO. 15- _____
 OPERATOR Hummon Corporation
 LEASE McGuire A
 WELL NUMBER #1
 FIELD McGuire - Goemann NW

LOCATION OF WELL: COUNTY Barber
4620 feet from south/north line of section
1980 feet from east/west line of section
 SECTION 13 TWP 32S RG 11W

NUMBER OF ACRES ATTRIBUTABLE TO WELL _____
 QTR/QTR/QTR OF ACREAGE _____

IS SECTION X REGULAR or _____ IRREGULAR
IF SECTION IS IRREGULAR, LOCATE WELL FROM NEAREST CORNER BOUNDARY.

Section corner used: _____ NE _____ NW (SE) SW
PLAT

(Show location of the well and shade attributable acreage for prorated or spaced wells.)
 (Show footage to the nearest lease or unit boundary line.)

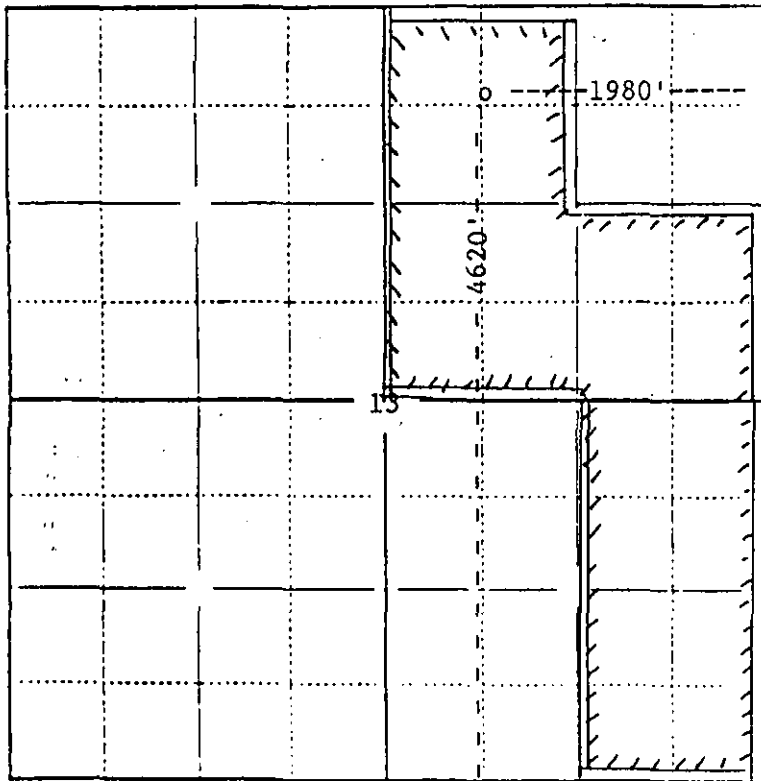

lease Description: W/2NE, SE/4NE/4,
 E/2SE/4 13-32S-11W

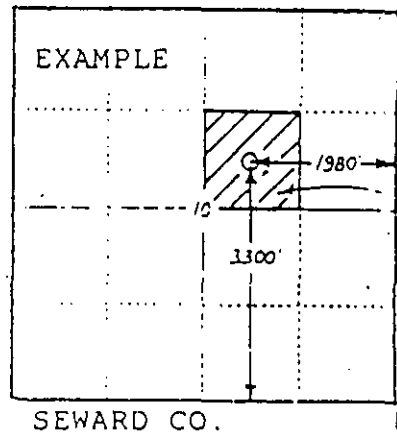

40
 ACRES
 RECEIVED
 1997/09-2 P 1:33
 4-297

In plotting the proposed location of the well, you must show:

- 1) The manner in which you are using the depicted plat by identifying section lines, i.e. 1 section, 1 section with 8 surrounding sections, 4 sections, etc.;
- 2) the distance of the proposed drilling location from the section's south/north and east/west lines; and
- 3) the distance to the nearest lease or unit boundary line.