

FOR KCC USE:

FORM C-1 7/91

EFFECTIVE DATE: 10-4-95
DISTRICT # 1
SGA? Yes No

State of Kansas
NOTICE OF INTENTION TO DRILL

FORM MUST BE TYPED
FORM MUST BE SIGNED
ALL BLANKS MUST BE FILLED

Must be approved by the K.C.C. five (5) days prior to commencing well.

Expected Spud Date: October 2nd 1995
month day year

Spot
C... W2... NE. Sec .4. Twp .34. S. Rg .13W XX East West

OPERATOR: License # 5506
Name: Woolsey Petroleum Corporation
Address: 107 North Market, Suite 600
City/State/Zip: Wichita, Kansas 67202-1807
Contact Person: Debra K. Clingan
Phone: (316) 267-4379

1320' FNL... feet from South North line of Section
1980' FEL... feet from East West line of Section
IS SECTION REGULAR XX IRREGULAR?
(NOTE: Locate well on the Section Plat on Reverse Side)

CONTRACTOR: License #: 5929
Name: Duke Drilling Co., Inc.

County: Barber
Lease Name: Falen... Well #: A-2 "OWWO"
Field Name:
Is this a Prorated/Spaced Field? yes X no

Well Drilled For: Well Class: Type Equipment:
Oil Erh Rec Infield X Mud Rotary
Gas Storage Pool Ext. Air Rotary
X OWWO Disposal Wildcat Cable
Seismic: # of Holes Other

Target Formation(s):
Nearest lease or unit boundary:
Ground Surface Elevation: 1749' feet MSL
Water well within one-quarter mile: yes X no
Public water supply well within one mile: yes X no

If OWWO: old well information as follows:
Operator: TXO Production Corporation
Well Name: Falen A-2
Comp. Date: 11/19/1989. Old Total Depth: 5096' LTD.

Depth to bottom of fresh water: 100'
Depth to bottom of usable water: 180'
Surface Pipe by Alternate: X 1 2
Length of Surface Pipe Planned to be set: has 391'
Length of Conductor pipe required: n/a
Projected Total Depth: proposed re-entry to 4250'
Formation at Total Depth:
Water Source for Drilling Operations:
well farm pond XX other

Directional, Deviated or Horizontal wellbore? yes XX no
If yes, true vertical depth:
Bottom Hole Location:

Will Cores Be Taken? yes XX no
If yes, proposed zone:

AFFIDAVIT

The undersigned hereby affirms that the drilling, completion and eventual plugging of this well will comply with K.S.A. 55-101, et. seq.
It is agreed that the following minimum requirements will be met:

- 1. Notify the appropriate district office prior to spudding of well;
- 2. A copy of the approved notice of intent to drill shall be posted on each drilling rig;
- 3. The minimum amount of surface pipe as specified below shall be set by circulating cement to the top; in all cases surface pipe shall be set through all unconsolidated materials plus a minimum of 20 feet into the underlying formation;
- 4. If the well is dry hole, an agreement between the operator and the district office on plug length and placement is necessary prior to plugging;
- 5. The appropriate district office will be notified before well is either plugged or production casing is cemented in;
- 6. IF AN ALTERNATE II COMPLETION, PRODUCTION PIPE SHALL BE CEMENTED FROM BELOW ANY USABLE WATER TO SURFACE WITHIN 120 DAYS OF SPUD DATE. IN ALL CASES, NOTIFY DISTRICT OFFICE PRIOR TO ANY CEMENTING.

I hereby certify that the statements made herein are true and to the best of my knowledge and belief.

Date: 09/27/1995 Signature of Operator or Agent Mark P. Stevenson Title: V.P. - Operations

FOR KCC USE:
API # 15- 007- 72273 0001
Conductor pipe required NONE feet
Minimum surface pipe required 391' feet per Alt. 1 X
Approved by: JK 9-29-95
This authorization expires: 3-29-96
(This authorization void if drilling not started within 6 months of effective date.)
Spud date: Agent:

REMEMBER TO:

- File Drill Pit Application (form CDP-1) with Intent to Drill;
- File Completion Form ACO-1 within 120 days of spud date;
- File acreage attribution plat according to field prorations orders;
- Notify appropriate district office 48 hours prior to workover or re-entry;
- Submit plugging report (CP-4) after plugging is completed;
- Obtain written approval before disposing or injecting salt water.

Mail to: KCC - Conservation Division, 130 S. Market - Room 2078, Wichita, Kansas 67202.

4
34
1305

IN ALL CASES PLOT THE INTENDED WELL ON THE PLAT BELOW

PLAT OF ACREAGE ATTRIBUTABLE TO A WELL IN A PRORATED OR SPACED FIELD

If the intended well is in a prorated or spaced field, please fully complete this side of the form. If the intended well is in a prorated or spaced field complete the plat below showing that the well will be properly located in relationship to other wells producing from the common source of supply. Please show all the wells within 1 mile of the boundaries of the proposed acreage attribution unit for gas wells and within 1/2 mile of the boundaries of the proposed acreage attribution unit for oil wells.

API NO. 15-
 OPERATOR Woolsey Petroleum Corporation LOCATION OF WELL: BARBER COUNTY
 LEASE Falen 1320 FNL feet from ~~south~~ north line of section
 WELL NUMBER A-2 "OWWO" 1980 FEL feet from ~~east~~ west line of section
 FIELD _____ SECTION 4 TWP 34S RGE 13W

NUMBER OF ACRES ATTRIBUTABLE TO WELL _____ IS SECTION _____ REGULAR or X IRREGULAR
 QTR/QTR/QTR OF ACREAGE _____ **IF SECTION IS IRREGULAR, LOCATE WELL FROM NEAREST CORNER BOUNDARY.**

Section corner used: X NE _____ NW _____ SE _____ SW

PLAT

(Show location of the well and shade attributable acreage for prorated or spaced wells.)
 (Show footage to the nearest lease or unit boundary line.)

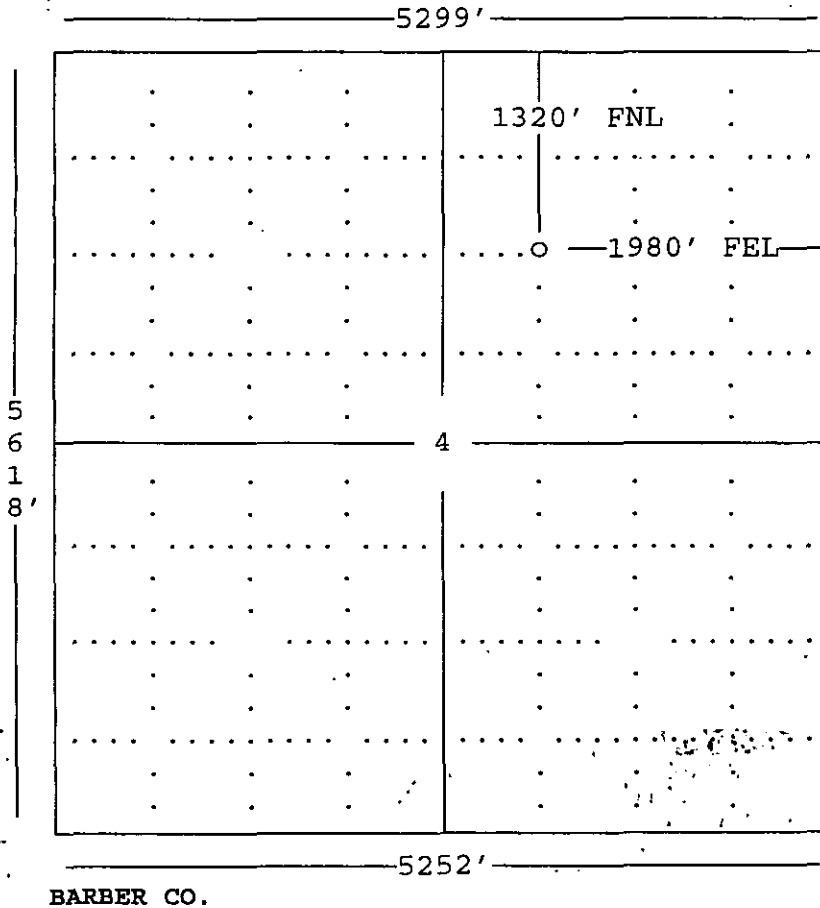

RECEIVED
 KANSAS CORPORATION COMMISSION

SEP 27 1995

CONSERVATION DIVISION
 WICHITA, KS

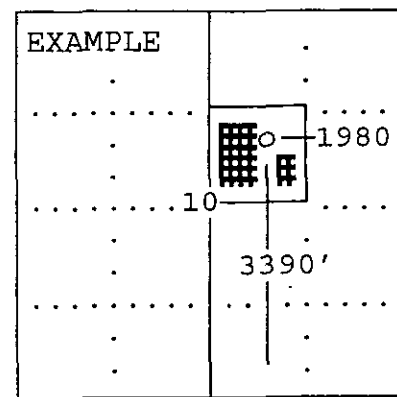

In plotting the proposed location of the well, you must show:

- 1) The manner in which you are using the depicted plat by identifying section lines, i.e. 1 section, 1 section with 8 surrounding sections, 4 sections, etc.;
- 2) the distance of the proposed drilling location from the section's south/north and east/west; and
- 3) the distance to the nearest lease or unit boundary line.