

EFFECTIVE DATE: 1-31-93
DISTRICT # 1
SEAL Yes No

State of Kansas
NOTICE OF INTENTION TO DRILL

FORM MUST BE SIGNED
ALL BLANKS MUST BE FILLED

Must be approved by the K.C.C. five (5) days prior to commencing well

Expected Spud Date January 29, 1993
month day year

Spot S/2 SW NW Sec 11 Twp 30 S, Rg 13W East West

OPERATOR: License # 5056
Name: F. G. Holl Company
Address: P.O. Box 780167
City/State/Zip: Wichita, Ks. 67278-0167
Contact Person: Elwyn H. Nagel
Phone: (316) 684-8481

2070' FSL feet from South / North line of Section
 4620' FEL feet from East / West line of Section
IS SECTION REGULAR IRREGULAR

CONTRACTOR: License # 5142
Name: Sterling Drilling

(NOTE: Locate well on the Section Plat on Reverse Side)
County: Barber
Lease Name: JAWRENZ Well #: 1-11
Field Name: Wildcat
Is this a Prorated/Spaced Field? ... yes no
Target Formation(s): Miss. Viola, Simpson Sand
Nearest lease or unit boundary: 660'
Ground Surface Elevation: 1840' est. feet MSL
Water well within one-quarter mile: ... yes no
Public water supply well within one mile: ... yes no
Depth to bottom of fresh water: 130'
Depth to bottom of usable water: 180'
Surface Pipe by Alternate: ... 1 ... 2
Length of Surface Pipe Planned to be set: 200'
Length of Conductor pipe required: NA
Projected Total Depth: 4750'
Formation at Total Depth: Arbuckle
Water Source for Drilling Operations:
X well ... farm pond ... other
DWR Permit # (Applied for by Sterling Drlg.)
Will Cores Be Taken?: ... yes no
If yes, proposed zone:

Well Drilled For: Well Class: Type Equipment:
X Oil Enh Rec ... Infield X Mud Rotary
X Gas Storage ... Pool Ext. ... Air Rotary
... GWVO ... Disposal X Wildcat ... Cable
... Seismic; ... # of Holes ... Other
If GWVO: old well information as follows:
Operator: ...
Well Name: ...
Comp. Date: ... Old Total Depth ...
Directional, Deviated or Horizontal wellbore? ... yes no
If yes, true vertical depth: ...
Bottom Hole Location: ...

AFFIDAVIT

The undersigned hereby affirms that the drilling, completion and eventual plugging of this well will comply with K.S.A. 55-101, et. seq.
It is agreed that the following minimum requirements will be met:

1. Notify the appropriate district office prior to spudding of well;
2. A copy of the approved notice of intent to drill shall be posted on each drilling rig;
3. The minimum amount of surface pipe as specified below shall be set by circulating cement to the top; in all cases surface pipe shall be set through all unconsolidated materials plus a minimum of 20 feet into the underlying formation;
4. If the well is dry hole, an agreement between the operator and the district office on plug length and placement is necessary prior to plugging;
5. The appropriate district office will be notified before well is either plugged or production casing is cemented in;
6. IF AN ALTERNATE II COMPLETION, PRODUCTION PIPE SHALL BE CEMENTED FROM BELOW ANY USABLE WATER TO SURFACE WITHIN 120 DAYS OF SPUD DATE. IN ALL CASES, NOTIFY DISTRICT OFFICE PRIOR TO ANY CEMENTING.

I hereby certify that the statements made herein are true and to the best of my knowledge and belief.
Date: 1/25/93 Signature of Operator or Agent: [Signature] Title: Exploration Manager

FOR KCC USE:
API # 15- 007-22412-00-00
Conductor pipe required None feet
Minimum surface pipe required 200' feet per Alt.
Approved by: CB 1-26-93
This authorization expires: 7-26-93
(This authorization void if drilling not started within 6 months of effective date.)
Spud date: _____ Agent: _____

MAILED

JUL 29 1993

CONSERVATION DIVISION
Wichita, Kansas

REMEMBER TO:

- File Drill Pit Application (form CDP-1) with Intent to Drill;
- File Completion Form ACO-1 within 120 days of spud date;
- File acreage attribution plat according to field proration orders;
- Notify appropriate district office 48 hours prior to workover or re-entry;
- Submit plugging report (CP-4) after plugging is completed;
- Obtain written approval before disposing or injecting salt water.

Mail to: Conservation Division, 200 Colorado Derby Building, 202 W. First St., Wichita, Kan. 67202-1286.

RECEIVED
KANSAS CORPORATION COMMISSION
JAN 25 1993
CONSERVATION DIVISION
WICHITA, KS

11
30
13

IN ALL CASES PLOT THE INTENDED WELL ON THE PLAT BELOW

PLAT OF ACREAGE ATTRIBUTABLE TO A WELL IN A PRORATED OR SPACED FIELD

If the intended well is in a prorated or spaced field, please fully complete this side of the form. If the intended well is in a prorated or spaced field complete the plat below showing that the well will be properly located in relationship to other wells producing from the common source of supply. Please show all the wells within 1 mile of the boundaries of the proposed acreage attribution unit for gas wells and within 1/2 mile of the boundaries of the proposed acreage attribution unit for oil wells.

API NO. 15- _____
OPERATOR F. G. Holl Company
LEASE Lawrenz
WELL NUMBER 1-11
FIELD Wildcat

LOCATION OF WELL: COUNTY Barber
2970' FSL feet from south/north line of section
4620' FEL feet from east/west line of section
SECTION 11 TWP 30S RG 13W

NUMBER OF ACRES ATTRIBUTABLE TO WELL NA
QTR/QTR/QTR OF ACREAGE _____

IS SECTION X REGULAR or _____ IRREGULAR
IF SECTION IS IRREGULAR, LOCATE WELL FROM NEAREST CORNER BOUNDARY.

Section corner used: NE NW SE SW

PLAT

(Show location of the well and shade attributable acreage for prorated or spaced wells.)
(Show footage to the nearest lease or unit boundary line.)

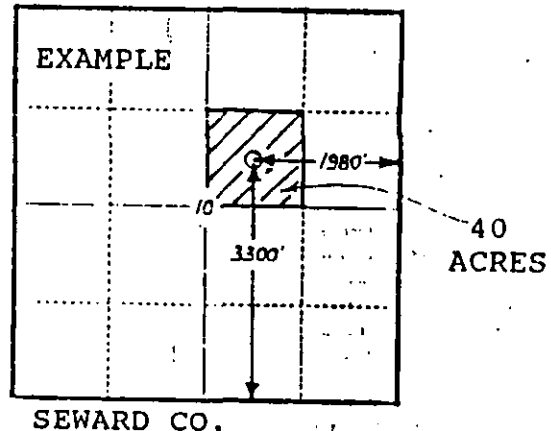
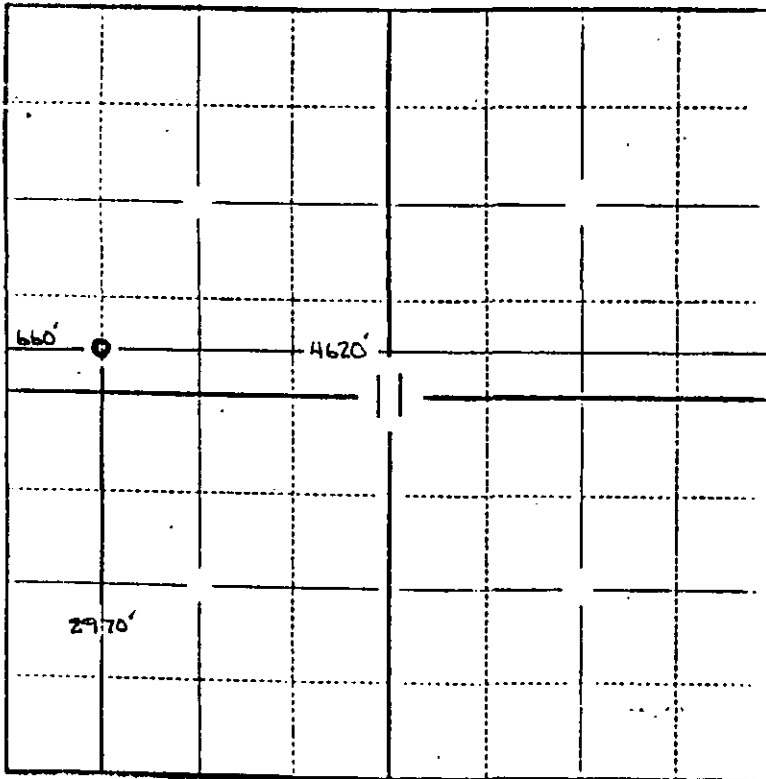

In plotting the proposed location of the well, you must show:

- 1) The manner in which you are using the depicted plat by identifying section lines, i.e. 1 section, 1 section with 8 surrounding sections, 4 sections, etc.;
- 2) the distance of the proposed drilling location from the section's south/north and east/west lines; and
- 3) the distance to the nearest lease or unit boundary line.