

STATE CORPORATION COMMISSION OF KANSAS  
OIL & GAS CONSERVATION DIVISION

WELL COMPLETION OR RECOMPLETION FORM  
ACO-1 WELL HISTORY

DESCRIPTION OF WELL AND LEASE

Operator: License # 4139  
Name HJ Energy Company  
Address 2401 Nowata Place, Suite 104  
City/State/Zip Bartlesville, Ok. 74006

Purchaser Fairway Crude  
Chanute, Ks.

Operator Contact Person Harry R. Johnson  
Phone (918) 333-9393

Contractor: License # 5492  
Name Central Plains Drilling

Wellsite Geologist Loren D. Schmidt  
Phone (918) 333-9393

Designate Type of Completion  
 New Well  Re-Entry  Workover  
 Oil  SWD  Temp Abd  
 Gas  Inj  Delayed Comp.  
 Dry  Other (Core, Water Supply etc.)

If OWWO: old well info as follows:  
Operator  
Well Name  
Comp. Date Old Total Depth

WELL HISTORY

Drilling Method:  
 Mud Rotary  Air Rotary  Cable  
5/24/87 6/3/87 6/17/87  
Spud Date Date Reached TD Completion Date  
1184  
Total Depth PBTD  
Amount of Surface Pipe Set and Cemented at 40 feet  
Multiple Stage Cementing Collar Used?  Yes  No  
If yes, show depth set feet  
If alternate 2 completion, cement circulated from 40 feet depth to Surface 140 SX cmt

API NO. 15-207-25-517 0980  
County Woodson  
NW NE SW Sec. 16 Twp. 26 Rge. 16  East  West  
2450 Ft North from Southeast Corner of Section  
3650 Ft West from Southeast Corner of Section  
(Note: Locate well in section plat below)  
Lease Name Young "A" Well # 22  
Field Name East Rose Unit  
Producing Formation Cattleman Ss.  
Elevation: Ground 1040 KB

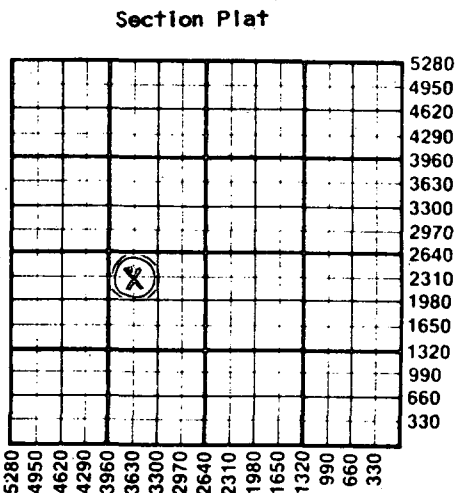

Section Plat  
WATER SUPPLY INFORMATION  
Disposition of Produced Water:  Disposal  Repressuring  
Docket #

Questions on this portion of the ACO-1 call:  
Water Resources Board (913) 296-3717  
Source of Water:  
Division of Water Resources Permit #  
 Groundwater Ft North from Southeast Corner (Well) Ft West from Southeast Corner of Sec Twp Rge  East  West  
 Surface Water Ft North from Southeast Corner (Stream, pond etc) Ft West from Southeast Corner Sec Twp Rge  East  West  
 Other (explain) Purchased from Chanute, Ks. (purchased from city, R.W.D. #)

INSTRUCTIONS: This form shall be completed in duplicate and filed with the Kansas Corporation Commission, 200 Colorado Derby Building, Wichita, Kansas 67202, within 90 days after completion or recompletion of any well. Rule 82-3-130 and 82-3-107 apply.  
Information on side two of this form will be held confidential for a period of 12 months if requested in writing and submitted with the form. See rule 82-3-107 for confidentiality in excess of 12 months.  
One copy of all wireline logs and drillers time log shall be attached with this form. Submit CP-4 form with all plugged wells. Submit CP-111 form with all temporarily abandoned wells.

All requirements of the statutes, rules and regulations promulgated to regulate the oil and gas industry have been fully complied with and the statements herein are complete and correct to the best of my knowledge.

Signature Harry R. Johnson  
Title President Date 07/14/87

Subscribed and sworn to before me this 14th day of July 1987  
Notary Public Sarah J. McCl...

Date Commission Expires 4-18-89 JUL 20 1987

07-20-87  
CONSERVATION DIVISION  
Wichita, Kansas

K.C.C. OFFICE USE ONLY  
F  Letter of Confidentiality Attached  
C  Wireline Log Received  
C  Drillers Timelog Received  
Distribution  
 KCC  SWD/Rep  NGPA  
 KGS  Plug  Other  
(Specify)

Sec 16, Twp 26, Rge 16 E

SIDE TWO

Operator Name HJ Energy Company Lease Name Young "A" Well # 22

Sec. 16 Twp. 26S Rge. 16  East  West County Woodson

WELL LOG

INSTRUCTIONS: Show important tops and base of formations penetrated. Detail all cores. Report all drill stem tests giving interval tested, time tool open and closed, flowing and shut-in pressures, whether shut-in pressure reached static level, hydrostatic pressures, bottom hole temperature, fluid recovery, and flow rates if gas to surface during test. Attach extra sheet if more space is needed. Attach copy of log.

Drill Stem Tests Taken  Yes  No  
 Samples Sent to Geological Survey  Yes  No  
 Cores Taken  Yes  No

Formation Description  
 Log  Sample

Name	Top	Bottom
Douglas Gp.	0	170
Lansing Gp.	170	431
Kansas City Gp.	431	616
Pleasanton Sh.	616	722
Lenapah Ls.	722	728
Shale	728	750
Altamont Ls.	750	762
Shale	762	848
Pawnee Ls.	848	876
Shale	876	900
Ft. Scott Ls.	900	926
Cherokee	926	
Shale	926	969
L. Squirrel Ss.	969	988
Shale	988	1026
Verdigris Ls.	1026	1029
Shale	1029	1110
Cattleman Ss.	1110	1154
Shale	1154	1184 T.D.

CASING RECORD <input type="checkbox"/> New <input checked="" type="checkbox"/> Used							
Report all strings set-conductor, surface, intermediate, production, etc.							
Purpose of String	Size Hole Drilled	Size Casing Set (in O.D.)	Weight Lbs/Ft.	Setting Depth	Type of Cement	#Sacks Used	Type and Percent Additives
Surf	10 1/2	8 5/8	-	40	Portland	7	-
Production	6 1/2	4 1/2	9.5	1164	50/50 pozmix	140	-
PERFORATION RECORD				Acid, Fracture, Shot, Cement Squeeze Record			
Shots Per Foot	Specify Footage of Each Interval Perforated			(Amount and Kind of Material Used)		Depth	
1	1110 - 1131			Frac w/3200# 12/20 bulk		1110	
				Frac sand Cross-Link			
				Polymer Gel			
TUBING RECORD				Liner Run <input type="checkbox"/> Yes <input checked="" type="checkbox"/> No			
Date of First Production		Producing Method					
06/27/87		<input type="checkbox"/> Flowing <input checked="" type="checkbox"/> Pumping <input type="checkbox"/> Gas Lift <input type="checkbox"/> Other (explain)					
Estimated Production Per 24 Hours		Oil	Gas	Water	Gas-Oil Ratio	Gravity	
2 Bbls		NA	MCF	80 Bbls	NA	28	

METHOD OF COMPLETION

Disposition of gas:  Vented  Open Hole  Perforation  
 Sold  Other (Specify) .....  
 Used on Lease  Dually Completed  Commingled

Production Interval 1110-1154