

ORIGINAL

S

9/14/80

RELEASED

SIDE ONE

STATE CORPORATION COMMISSION OF KANSAS
OIL & GAS CONSERVATION DIVISION
WELL COMPLETION FORM
ACO-1 WELL HISTORY
DESCRIPTION OF WELL AND LEASE

API NO. 15-007-22,255-00-00 OCT 9 1980

County Barber FROM CONFIDENTIAL

NW SW NE Sec. 23 Twp. 30 Rge. 11 X West

3630 Ft. North from Southeast Corner of Section

2310 Ft. West from Southeast Corner of Section

(NOTE: Locate well in section plat below.)

Lease Name DOUTHETT "A" Well # 1

Field Name Wildcat

Producing Formation D & A

Elevation: Ground 1802 KB 1807

Total Depth 4520 PBDT --

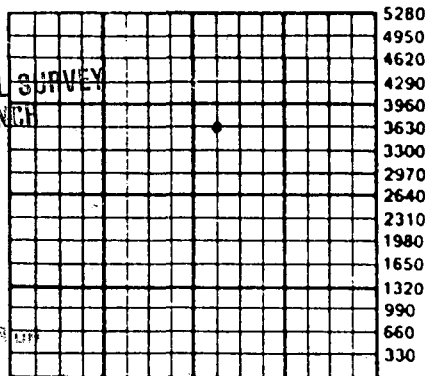

KANSAS GEOLOGICAL SURVEY
WICHITA BRANCH

SEP 26 1980

RECEIVED

SEP 14 1980

ACT 1
DIA

Operator: License # 3667

Name: SOURCE PETROLEUM

Address 200 W. Douglas, Suite 820
Wichita, KS 67202

City/State/Zip

Purchaser: D & A

Operator Contact Person: John D. Howard, Jr.

Phone (316) 262-7397

Contractor: Name: ALLEN DRILLING COMPANY

License: 5418

Wellsite Geologist: Randall L. Lilak

Designate Type of Completion

New Well Re-Entry Workover

Oil SWD Temp. Abd.

Gas Inj Delayed Comp.

Dry Other (Core, Water Supply, etc.)

STATE CORPORATION COMMISSION

If OWMO: old well info as follows:

Operator:

Well Name:

Comp. Date Old Total Depth

Drilling Method:

Mud Rotary Air Rotary Cable

8/15/89 8/23/89 8/24/89

Spud Date Date Reached TD Completion Date

Amount of Surface Pipe Set and Cemented at 288' Feet

Multiple Stage Cementing Collar Used? Yes No

If yes, show depth set Feet

If Alternate II completion, cement circulated from

feet depth to w/ sx cmt.

INSTRUCTIONS: This form shall be completed in triplicate and filed with the Kansas Corporation Commission, 200 Colorado Derby Building, Wichita, Kansas 67202, within 120 days of the spud date of any well. Rule 82-3-130, 82-3-107 and 82-3-106 apply. Information on side two of this form will be held confidential for a period of 12 months if requested in writing and submitted with the form. See rule 82-3-107 for confidentiality in excess of 12 months. One copy of all wireline logs and drillers time log shall be attached with this form. ALL CEMENTING TICKETS MUST BE ATTACHED. Submit CP-4 form with all plugged wells. Submit CP-111 form with all temporarily abandoned wells. Any recompletion, workover or conversion of a well requires filing of ACO-2 within 120 days from commencement date of such work.

All requirements of the statutes, rules and regulations promulgated to regulate the oil and gas industry have been fully complied with and the statements herein are complete and correct to the best of my knowledge.

Signature John D. Howard, Jr.

Title General Manager Date 9/13/89

Subscribed and sworn to before me this 13th day of September, 19 89.

Notary Public Virginia S. Fabian

Date Commission Expires August 5, 1991

K.C.C. OFFICE USE ONLY

Letter of Confidentiality Attached

Wireline Log Received

Drillers Timelog Received

Distribution

KCC SWD/Rep NGPA

KGS Plug Other (Specify)

ORIGINAL

91

Operator Name SOURCE PETROLEUM Lease Name DOUTHETT "A" Well # 1
 Sec. 23 Twp. 30 Rge. 11 East West
 County Barber

INSTRUCTIONS: Show important tops and base of formations penetrated. Detail all cores. Report all drill stem tests giving interval tested, time tool open and closed, flowing and shut-in pressures, whether shut-in pressure reached static level, hydrostatic pressures, bottom hole temperature, fluid recovery, and flow rates if gas to surface during test. Attach extra sheet if more space is needed. Attach copy of log.

Drill Stem Tests Taken Yes No
 (Attach Additional Sheets.)
 Samples Sent to Geological Survey Yes No
 Cores Taken Yes No
 Electric Log Run Yes No
 (Submit Copy.)

Name	Formation Description	
	Top	Bottom
Winfield	2008	2058
Red Eagle	2598	2615
Indian Cave	2730	2759
Topeka	3154	3693
Heebner	3693	3695
Douglas	3697	3880
Lansing-KC	3895	4305
Mississippian	4436	4517
Total Depth	4517	

DST's attached

CASING RECORD <input type="checkbox"/> New <input checked="" type="checkbox"/> Used							
Report all strings set-conductor, surface, intermediate, production, etc.							
Purpose of String	Size Hole Drilled	Size Casing Set (In O.D.)	Weight Lbs./Ft.	Setting-Depth	Type of Cement	# Sacks Used	Type and Percent Additives
surface	12-1/4"	8-5/8"	25#	288'	60/40 poz	175	3%cc, 2%gel
PERFORATION RECORD				Acid, Fracture, Shot, Cement Squeeze Record			
Shots Per Foot	Specify Footage of Each Interval Perforated			(Amount and Kind of Material Used)		Depth	
TUBING RECORD				Liner Run <input type="checkbox"/> Yes <input type="checkbox"/> No			
Date of First Production		Producing Method <input type="checkbox"/> Flowing <input type="checkbox"/> Pumping <input type="checkbox"/> Gas Lift <input type="checkbox"/> Other (Explain)					
Estimated Production Per 24 Hours	Oil Bbls.	Gas Mcf	Water Bbls.	Gas-Oil Ratio	Gravity		

Disposition of Gas: Vented Sold Used on Lease (If vented, submit ACO-18.)

METHOD OF COMPLETION: Open Hole Perforation Dually Completed Commingled Other (Specify) _____

Production Interval _____

ORIGINAL

ATTACHED TO ACO-1

ORIGINAL

Source Petroleum
Douthett "A" #1
NW SW NE, 23-30S-11W
Barber County, Kansas

RELEASED

OCT 9 1990

FROM CONFIDENTIAL

DST #1 3700-3805'
Douglas Ss
30-30 15-15
1st Blow weak, died in 30 min
2nd blow initial surge, died
Rec. 5' mud
IHP: 1862 FHP: 1842
IFP: 111 FFP: 111
ISIP: 111 FSIP: 111
BHT 116°
Pipe strap 4.78' long to board

DST #2 4230-4250'
K Zone
45-45 90-90
1st blow building slow to 3" in 15 min;
still building slowly
2nd blow 6" blow building off bottom of bucket in 45 min
Rec 430' water
chl 60,000
IHP: 2560 FHP: 2145
IFP: 71-132 FFP: 193-264
ISIP: 1560 FSIP: 1560
BHT 120°

DST #3 4437-4449'
Mississippi
45-45 45-45
1st blow weak built to 9" in 15 min,
still building to 10", weak 1" blowback
2nd blow weak to 1" and steady
Rec 5' mud w/specks of oil
IHP: 2277 FHP: 2257
IFP: 71-71 FFP: 71-71
ISIP: 71 FSIP: 71
BHT 121°

DST #4 4416-4460'
Mississippi
60-60 15-60
1st blow slow to 1" in 15 min, dropping to 1/2"
after 40 min
2nd blow, no blow
Rec 25' drlg mud
IHP: 2277 FHP: 2257
IFP: 81-81 FFP: 101-101
ISIP: 193 FSIP: 162
BHT 121°

RECEIVED
STATE COMMISSION

SEP 14 1989

COPIES
Wanda, Kansas

COPY

NOTICE OF INTENTION TO DRILL 007-22, 255-00-06

ALL BLANKS MUST BE FILLED

Must be approved by the K.C.C. five (5) days prior to commencing well

Expected Spud Date: 8 month, 9 day, 1989 year

NW * SW NE Sec 23, Twp 30 S, Rg 11 X East West

3630 feet from South line of Section
2310 feet from East line of Section

(Note: Locate well on Section Plat Below)

OPERATOR: License # 3667
Name: Source Petroleum
Address: 200 W. Douglas, Ste. 820
City/State/Zip: Wichita, Kansas 67202
Contact Person: John D. Howard, Jr.
Phone: (316) 262-7397

County: Barber
Lease Name: Douthett "A" Well #: 1
Field Name: Wildcat

CONTRACTOR: License #: 5418
Name: Allen Drilling Company

Is this a Prorated Field? yes X no

Well Drilled For: Well Class: Type Equipment:

Target Formation(s): Mississippian

X Oil Inj Infield X Mud Rotary
Gas Storage Pool Ext. Air Rotary
AAAO Disposal X Wildcat Cable
Seismic: # of Holes

Hearst lease or unit boundary: 330'

Ground Surface Elevation: * 1802 feet MSL

Domestic well within 330 feet: yes X no

Municipal well within one mile: yes X no

Depth to bottom of fresh water: 200' (80')

Depth to bottom of usable water: 250' (80')

Surface Pipe by Alternate: X 1 2

Length of Surface Pipe Planned to be set: * 275'

Length of Conductor pipe required: NONE

Projected Total Depth: * 4900'

formation at Total Depth: Arbuckle

Water Source for Drilling Operations:

well farm pond other

LR Permit #:

Will Cores Be Taken? yes X no

If yes, proposed zone:

200' Alt. I Req.

MAILED

If (AAAO) old well information as follows:

Operator:

Well Name:

Comp. Date: Old Total Depth:

Directional, Deviated or Horizontal wellbore? yes X no

If yes, total depth location:

WAS: NW-SE-NE; G.L. EST. 1805'
Surface pipe @ 300'; LTD 4800'

AFFIDAVIT

PUSHER: Wood Schepel
TD: 4520 FORMATION
SURFACE PIPE: 8 7/8 @ 288'
ANHYDRITE: 720 ELEVATION 1802
STARTING TIME & DATE: 8 AM 8-24
COMPLETION TIME & DATE: 5:05 AM
1st PLUG @ Flat FT. W/ 50 SX
2nd PLUG @ 7 5/8 FT. W/ 50 SX
3rd PLUG @ 320 FT. W/ 40 SX
4th PLUG @ 60 FT. W/ 10 SX
RAT HOLE CIRCULATED W/ 15 SX
MOUSE HOLE CIRCULATED W/ 15 SX
WATER WELL PLUGGED W/ filled SX
CEMENT COMPANY: B/T
TECHNICIAN:

SPUD
8-15-89
275-1-8 5/8
Yes WW

RECEIVED
STATE CORPORATION COMMISSION

AUG 28 1989

1650
1320
990
660
330
0
330
660
990
1320
1650

Agent: CONSERVATION DIVISION WICHITA, KANSAS

- REMEMBER TO:
- File Drilling Pit Application (Form CFP-1) with Intent to Drill;
 - File Completion Form A-1 with a 120 days of spud date;
 - File acreage allocation plan according to field production orders;
 - Notify appropriate district office 48 hours prior to workover or re-entry;
 - Submit plugging report 10 days after plugging is completed;
 - Obtain written approval before disposing or injecting salt water.