

FOR KCC USE:

FORM C-1 7/91
FORM MUST BE TYPED
FORM MUST BE SIGNED
ALL BLANKS MUST BE FILLED

EFFECTIVE DATE: 9-25-95

State of Kansas

DISTRICT # 1

NOTICE OF INTENTION TO DRILL

SGA? Yes... No

Must be approved by the K.C.C. five (5) days prior to commencing well.

Spot
Appx SW SW NW... Sec .20.. Twp .34.. S, Rg .13.. XX West East

Expected Spud Date: ..September.....23.....1995.....
month day year

* ..2280' FNL..... feet from South North line of Section
* ...540' FWL..... feet from East West line of Section
IS SECTION _____ REGULAR XX IRREGULAR?

OPERATOR: License # 5506.....
Name:Woolsey Petroleum Corporation.....
Address:107 North Market, Suite 600.....
City/State/Zip: ..Wichita, Kansas 67202-1807.....
Contact Person: ..Debra K. Clingan.....
Phone:(316) 267-4379.....

(NOTE: Locate well on the Section Plat on Reverse Side)
County: ..Barber.....
Lease Name: ..Meyer "B"..... Well #: ..5.....
Field Name:

CONTRACTOR: License #: ..5929.....
Name: ..Duke Drilling Co., Inc.....

Is this a Prorated/Spaced Field? yes .XX. no
Target Formation(s): ..Arbuckle.....

Well Drilled For: Well Class: Type Equipment:

... Oil ... Enh Rec .X. Infield .X. Mud Rotary
.X. Gas ... Storage ... Pool Ext. ... Air Rotary
... OWWO ... Disposal ... Wildcat ... Cable
... Seismic: ... # of Holes ... Other
... Other

* Nearest lease or unit boundary: ..540'.....
Ground Surface Elevation: ..1650'..... feet MSL
Water well within one-quarter mile: yes no
Public water supply well within one mile: yes no
Depth to bottom of fresh water: ...140'.....
Depth to bottom of usable water: ..180'.....
Surface Pipe by Alternate: ..XX. 1 2
Length of Surface Pipe Planned to be set: ..200'.....
Length of Conductor pipe required: ..n/a.....
Projected Total Depth: ..5450'.....
Formation at Total Depth: ..Arbuckle.....
Water Source for Drilling Operations:
.... well farm pond .XX. other

If OWWO: old well information as follows:

Operator: ..n/a.....
Well Name: ..
Comp. Date: Old Total Depth

Will Cores Be Taken?: yes .XX. no
If yes, proposed zone:

Directional, Deviated or Horizontal wellbore? yes .XX. no
If yes, true vertical depth:.....
Bottom Hole Location.....

X WAS: 2390' FNL 400' FWL
IS: 2280' FNL 540' FWL

AFFIDAVIT

The undersigned hereby affirms that the drilling, completion and eventual plugging of this well will comply with K.S.A. 55-101, et. seq.

It is agreed that the following minimum requirements will be met:

X NEAREST LEASE WAS: 400' IS: 540'

1. Notify the appropriate district office prior to spudding of well;
2. A copy of the approved notice of intent to drill shall be posted on each drilling rig;
3. The minimum amount of surface pipe as specified below shall be set by circulating cement to the top; in all cases surface pipe shall be set through all unconsolidated materials plus a minimum of 20 feet into the underlying formation;
4. If the well is dry hole, an agreement between the operator and the district office on plug length and placement is necessary prior to plugging;
5. The appropriate district office will be notified before well is either plugged or production casing is cemented in;
6. IF AN ALTERNATE II COMPLETION, PRODUCTION PIPE SHALL BE CEMENTED FROM BELOW ANY USABLE WATER TO SURFACE WITHIN 120 DAYS OF SPUD DATE. IN ALL CASES, NOTIFY DISTRICT OFFICE PRIOR TO ANY CEMENTING.

I hereby certify that the statements made herein are true and to the best of my knowledge and belief.

Date: ..01/19/1996..... Signature of Operator or Agent: Debra K. Clingan Title: ..Production Secretary.....
Debra K. Clingan

FOR KCC USE:
API # 15-007-224830000
Conductor pipe required NONE feet
Minimum surface pipe required 200' feet per Alt. (1) X
Approved by: JK 1-22-96 / DRIG. 9-20-95

This authorization expires: 3-20-96
(This authorization void if drilling not started within 6 months of effective date.)
Spud date: _____ Agent: _____

80
RECEIVED
KANSAS CORPORATION COMMISSION
34
JAN 19 1996

REMEMBER TO:

- File Drill Pit Application (form CDP-1) with Intent to Drill;
- File Completion Form ACO-1 within 120 days of spud date;
- File acreage attribution plat according to field prorations orders;
- Notify appropriate district office 48 hours prior to workover or re-entry;
- Submit plugging report (CP-4) after plugging is completed;
- Obtain written approval before disposing or injecting salt water.

CONSERVATION DIVISION
WICHITA, KS
1302

IN ALL CASES PLOT THE INTENDED WELL ON THE PLAT BELOW

PLAT OF ACREAGE ATTRIBUTABLE TO A WELL IN A PRORATED OR SPACED FIELD

If the intended well is in a prorated or spaced field, please fully complete this side of the form. If the intended well is in a prorated or spaced field complete the plat below showing that the well will be properly located in relationship to other wells producing from the common source of supply. Please show all the wells within 1 mile of the boundaries of the proposed acreage attribution unit for gas wells and within 1/2 mile of the boundaries of the proposed acreage attribution unit for oil wells.

API NO. 15-007-224830000
 OPERATOR Woolsey Petroleum Corporation LOCATION OF WELL: BARBER COUNTY
 LEASE Meyer * 2280' FNL feet from south/north line of section
 WELL NUMBER B-5 * 540' FWL feet from east/west line of section
 FIELD _____ SECTION 20 TWP 34 RGE 13W

NUMBER OF ACRES ATTRIBUTABLE TO WELL _____ IS SECTION _____ REGULAR or XX IRREGULAR
 QTR/QTR/QTR OF ACREAGE _____ **IF SECTION IS IRREGULAR, LOCATE WELL FROM NEAREST CORNER BOUNDARY.**

Section corner used: NE X NW SE SW

PLAT

(Show location of the well and shade attributable acreage for prorated or spaced wells.)
 (Show footage to the nearest lease or unit boundary line.)

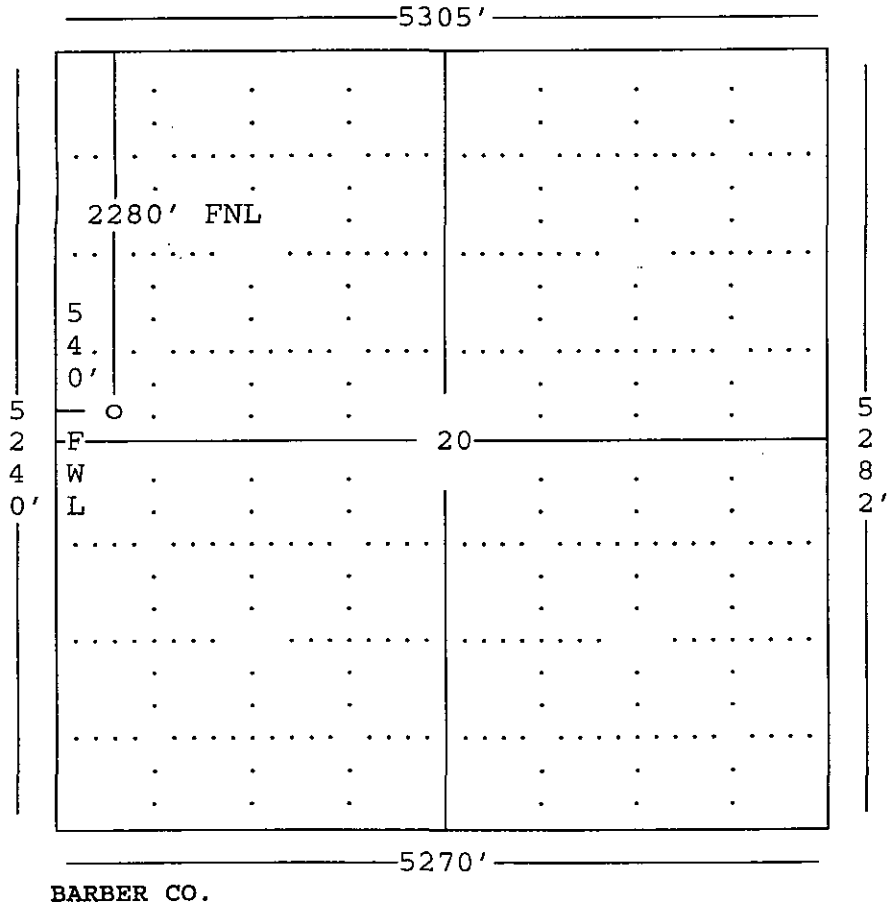

RECEIVED
 KANSAS CORPORATION COMMISSION
 JAN 19 1996
 CONSERVATION DIVISION
 WICHITA, KS

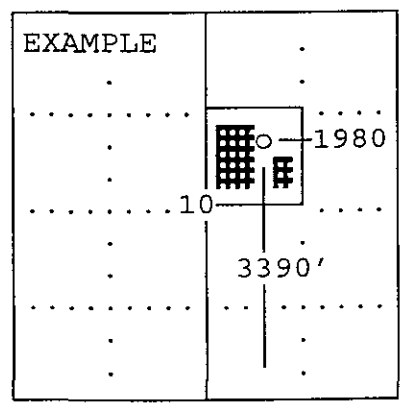

- In plotting the proposed location of the well, you must show:**
- 1) The manner in which you are using the depicted plat by identifying section lines, i.e. 1 section, 1 section with 8 surrounding sections, 4 sections, etc.;
 - 2) the distance of the proposed drilling location from the section's south/north and east/west; and
 - 3) the distance to the nearest lease or unit boundary line.