

Fixed
CORRECTED

OWWO

For KCC Use:
Effective Date: 4-24-2001
District # _____
SGA? Yes No

KANSAS CORPORATION COMMISSION
OIL & GAS CONSERVATION DIVISION

Form C-1
September 1999
Form must be Typed
Form must be Signed
All blanks must be Filled

NOTICE OF INTENT TO DRILL

Must be approved by KCC five (5) days prior to commencing well

Expected Spud Date April 23, 2001
month day year

Spot East
E/2-NE-SW Sec. 1 Twp. 31 S. R. 10 West
1980 feet from S / N (circle one) Line of Section
2310 feet from E / W (circle one) Line of Section
Is SECTION xx Regular Irregular?

OPERATOR: License# 32798
Name: Hart Energies, L.L.C.
Address: 11051 So. Memorial, #200
City/State/Zip: Tulsa, OK 74133
Contact Person: William G. Hart
Phone: 918-369-3315

(Note: Locate well on the Section Plat on reverse side)

County: Barber
Lease Name: Lauterbach Well #: 1
Field Name: Wildcat

CONTRACTOR: License# 4346 5893
Name: Pratt Well Service

Is this a Prorated / Spaced Field? Yes No
Target Information(s): Cherokee / Mississippian

Well Drilled For: Well Class: Type Equipment:
 Oil Enh Rec Infield Mud Rotary
 Gas Storage Pool Ext. Air Rotary
 OWWO Disposal Wildcat Cable
 Seismic; # of Holes Other
 Other

Nearest Lease or unit boundary: 660'
Ground Surface Elevation: 1719KB feet MSL

Water well within one-quarter mile: Yes No
Public water supply well within one mile: Yes No

Depth to bottom of fresh water: 60'
Depth to bottom of usable water: 180'

Surface Pipe by Alternate: X 1 / 2
Length of Surface Pipe Planned to be set: 206'

Length of Conductor Pipe required: none
Projected Total Depth: 4641'

Producing Formation Target: Cherokee / Mississippian
Water Source for Drilling Operations:
Well Farm Pond Other: X

If OWWO: old well information as follows:
Operator: Aylward Drlg
Well Name: Rankin #1
Original Completion Date: 9-22-61 Original Total Depth: 4641'

DWR Permit #: _____
(Note: Apply for Permit with DWR).

Directional, Deviated or Horizontal wellbore? Yes No

Will Cores be taken? Yes No

If Yes, true vertical depth: _____
Bottom Hole Location: _____
KCC DKT #: _____

X WAS: 1980 FWL IS 2310 FWL
X WAS: NE-SW. E2 E/2-NE-SW

RECEIVED
STATE CORPORATION COMMISSION

AFFIDAVIT

The undersigned hereby affirms that the drilling, completion and eventual plugging of this well will comply with K.S.A. 55-101, et. seq. It is agreed that the following minimum requirements will be met:

MAR 19 2001
3-19-01
CONSERVATION DIVISION
Wichita, Kansas

1. Notify the appropriate district office prior to spudding of well;
2. A copy of the approved notice of intent to drill shall be posted on each drilling rig;
3. The minimum amount of surface pipe as specified below shall be set by circulating cement to the top; in all cases surface pipe shall be set through all unconsolidated materials plus a minimum of 20 feet into the underlying formation.
4. If the well is dry hole, an agreement between the operator and the district office on plug length and placement is necessary prior to plugging;
5. The appropriate district office will be notified before well is either plugged or production casing is cemented in;
6. If an ALTERNATE II COMPLETION, production pipe shall be cemented from below any usable water to surface within 120 days of spud date. In all cases, NOTIFY district office prior to any cementing.

I hereby certify that the statements made herein are true and to the best of my knowledge and belief.

Date: March 12th, 2001 Signature of Operator or Agent: William G. Hart Title: member
sole member

For KCC Use ONLY
API # 15 - 007-00049-00-01
Conductor pipe required NONE feet
Minimum surface pipe required 206 feet per Alt. (1) X
Approved by: JK 4-19-2001 / RJP 5-2-2002
This authorization expires: 10-19-2001
(This authorization void if drilling not started within 6 months of effective date.)
Spud date: _____ Agent: _____

Remember to:

- File Drill Pit Application (form CDP-1) with Intent to Drill;
- File Completion Form ACO-1 within 120 days of spud date;
- File acreage attribution plat according to field proration orders;
- Notify appropriate district office 48 hours prior to workover or re-entry;
- Submit plugging report (CP-4) after plugging is completed;
- Obtain written approval before disposing or injecting salt water.

1
31
10W

IN ALL CASES PLOT THE INTENDED WELL ON THE PLAT BELOW

Plat of acreage attributable to a well in a prorated or spaced field

If the intended well is in a prorated or spaced field, please fully complete this side of the form. If the intended well is in a prorated or spaced field complete the plat below showing that the well will be properly located in relationship to other wells producing from the common source of supply. Please show all the wells and within 1 mile of the boundaries of the proposed acreage attribution unit for gas wells and within 1/2 mile of the boundaries of the proposed acreage attribution unit for oil wells.

API No. 15 - _____

Operator: Hart Energies, L.L.C.

Lease: Lauterbach

Well Number: #1

Field: wildcat

Location of Well: County: Barber

1980 feet from (S) / N (circle one) Line of Section

2310 feet from E / (W) (circle one) Line of Section

Sec. 1 Twp. 31 S. R. 10 East West

Number of Acres attributable to well: 320

QTR / QTR / QTR of acreage: _____

Is Section XX Regular or _____ Irregular

If Section is Irregular, locate well from nearest corner boundary.

Section corner used: NE NW SE SW

E/2 SW/4 & W/2 SE/4 Sec 1-31-10W and
E/2 NE/4 Sec 11-31-10W and
W/2 NW/4 Sec 12-31-10W

AMENDED

PLAT

(Show location of the well and shade attributable acreage for prorated or spaced wells.)

(Show footage to the nearest lease or unit boundary line.)

R 10 W

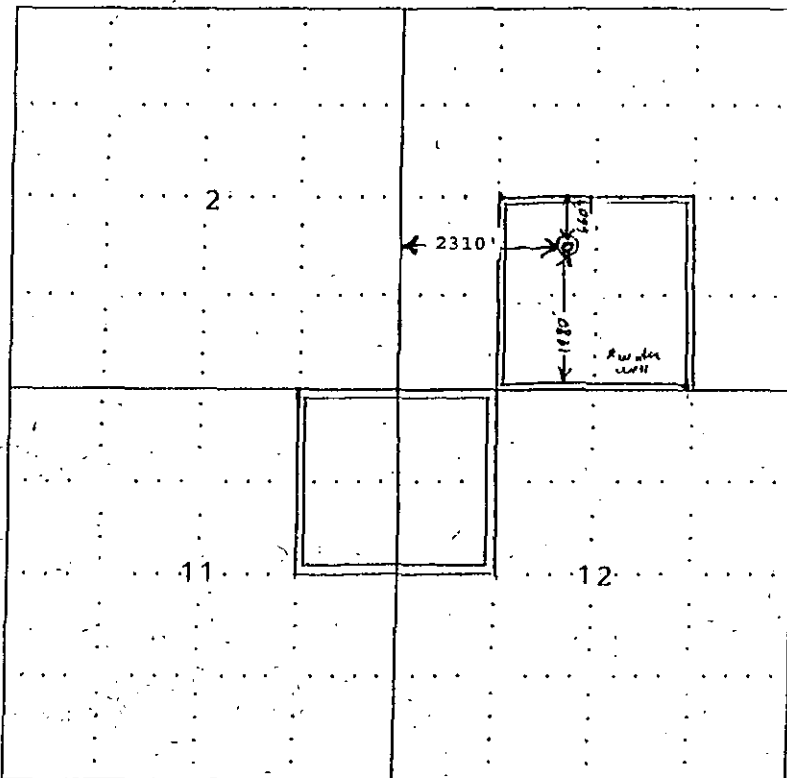

non-PRORATED
non-SPACED

T
31
S

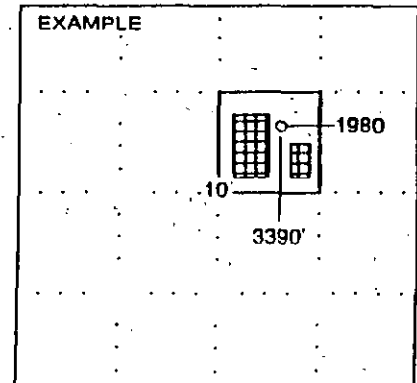

SEWARD CO.

Barber Co.

NOTE: In all cases locate the spot of the proposed drilling location.

In plotting the proposed location of the well, you must show:

1. The manner in which you are using the depicted plat by identifying section lines, i.e. 1 section, 1 section with 8 surrounding sections, 4 sections, etc.
2. The distance of the proposed drilling location from the section's south / north and east / west.
3. The distance to the nearest lease or unit boundary line.
4. If proposed location is located within a prorated or spaced field a certificate of acreage attribution plat must be attached: (CO-7 for oil wells; CG-8 for gas wells).