

STATE OF KANSAS
STATE CORPORATION COMMISSION

WELL PLUGGING RECORD

Give All Information Completely
Make Required Affidavit
Mail or Deliver Report to
Conservation Division
State Corporation Comm.
245 North Water
Wichita, KS 67202

Seward County, Sec. 33 Twp. 32S Rge. 34 E/W
Location as "NE/CNW $\frac{1}{4}$ SW $\frac{1}{4}$ " or footage from lines _____

C NE NE
Lease Owner ANADARKO PRODUCTION COMPANY
Lease Name HITCH "C" Well No. 2

Office Address P. O. BOX 351, LIBERAL, KANSAS 67901
Character of Well (Completed as Oil, Gas or Dry Hole)

Dry Hole

Date Well completed 3/29 1978

Application for plugging filed verbally 3/29 1978

Application for plugging approved verbally 3/29 1978

Plugging commenced 3/29 1978

Plugging completed 3/29 1978

Reason for abandonment of well or producing formation

Dry Hole

If a producing well is abandoned, date of last production

19

Was permission obtained from the Conservation Division or its agents before plugging was commenced? Yes

Name of Conservation Agent who supervised plugging of this well Mr. Clarence Thomas

Producing formation _____ Depth to top _____ Bottom _____ Total Depth of Well 6355'

Show depth and thickness of all water, oil and gas formations.

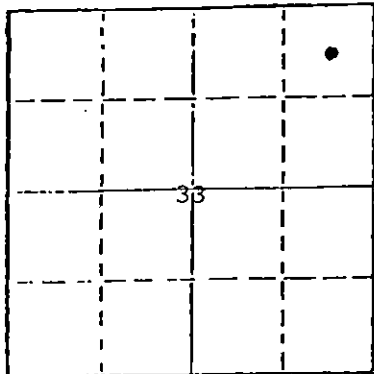

Locate well correctly on above Section Plot

OIL, GAS OR WATER RECORDS

CASING RECORD

FORMATION	CONTENT	FROM	TO	SIZE	PUT IN	PULLED OUT
				8-5/8"	1673'	None

Describe in detail the manner in which the well was plugged, indicating where the mud fluid was placed and the method or methods used in introducing it into the hold. If cement or other plugs were used, state the character of same and depth placed, from _____ feet to _____ feet for each plug set.

Spotted 40 sxs cmt 2800'

Spotted 40 sxs cmt 2400'

Spotted 50 sxs cmt 1700' to 1600'

Spotted 20. sxs cmt 40' to surface

RECEIVED
STATE CORPORATION COMMISSION
MAY 23 1978

(If additional description is necessary use BACK of this sheet)

Name of Plugging Contractor Lohmann-Johnson Drilling Co., Inc.

STATE OF KANSAS COUNTY OF SEWARD, ss.
Paul Campbell (employee of owner) or ~~XXXXXXXXXXXXXXXXXXXX~~

of the above-described well, being first duly sworn on oath, says: That I have knowledge of the facts, statements, and matters herein contained and the log of the above-described well as filed and that the same are true and correct. So help me God

LEONA FERNE CORNELSEN
STATE NOTARY PUBLIC
Seward County, Kansas
My Appointment Expires June 23, 1980

(Signature) Paul Campbell

Paul Campbell, Div. Prod. Mgr. (Address)

P. O. Box 351, Liberal, Kansas 67901

SUBSCRIBED AND SWORN TO before me this 18th day of May, 1978

Leona Ferne Cornelisen
Notary Public.

My commission expires June 23, 1980

15-175-20351-0000

KANSAS DRILLERS LOG

S. 33 T. 32S R. 34 ^{NE} W

API No. 15 — 175 — 20,351
County Number

Loc. C NE NE

County Seward

Operator
ANADARKO PRODUCTION COMPANY

Address
P. O. BOX 351, LIBERAL, KANSAS 67901

Well No. 2 Lease Name HITCH "C"

Footage Location
660 feet from (N) line 660 feet from (E) line

Principal Contractor Lohmann-Johnson Drilling Co. Geologist Joe Blair

Spud Date March 16, 1978 Total Depth 6355' P.B.T.D.

Date Completed March 29, 1978 Oil Purchaser

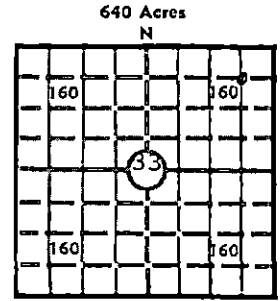

Elev.: Gr. 2909.0'

DF _____ KB _____

CASING RECORD

Report of all strings set — surface, intermediate, production, etc.

Purpose of string	Size hole drilled	Size casing set (in O.D.)	Weight lbs/ft.	Setting depth	Type cement	Sacks	Type and percent additives
Surface	12-1/4"	8-5/8"	24#	1673'	Pozmix Common	600 200	2% cc 2% cc

LINER RECORD

PERFORATION RECORD

Top, ft.	Bottom, ft.	Sacks cement	Shots per ft.	Size & type	Depth interval

TUBING RECORD

Size	Setting depth	Packer set at

ACID, FRACTURE, SHOT, CEMENT SQUEEZE RECORD

Amount and kind of material used	Depth interval treated

STATE CORPORATION COMMISSION
MAY 23 1978
CONSERVATION DIVISION
Wichita, Kansas

INITIAL PRODUCTION

Date of first production	Producing method (flowing, pumping, gas lift, etc.)				
RATE OF PRODUCTION PER 24 HOURS	Oil	Gas	Water	Gas-oil ratio	
	bbls.	MCF	bbls.	CFPB	
Disposition of gas (vented, used on lease or sold)			Producing interval(s)		

INSTRUCTIONS: As provided in KCC Rule 82-2-125, within 90 days after completion of a well, one completed copy of this Drillers Log shall be transmitted to the State Geological Survey of Kansas, 4150 Monroe Street, Wichita, Kansas 67209. Copies of this form are available from the Conservation Division, State Corporation Commission, 3830 So. Meridian (P.O. Box 17027), Wichita, Kansas 66217. Phone AC 316-522-2206. If confidential custody is desired, please note Rule 82-2-125. Drillers Logs will be on an open file in the Oil and Gas Division, State Geological Survey of Kansas, Lawrence, Kansas 66044.

Operator
ANADARKO PRODUCTION COMPANY

DESIGNATE TYPE OF COMP.: OIL, GAS, DRY HOLE, SWDW, ETC.:
DRY HOLE

Well No. 2 Lease Name HITCH "C"

S 33 T 32S R 34 W

WELL LOG

Show all important zones of porosity and contents thereof; cored intervals, and all drill-stem tests, including depth interval tested, cushion used, time tool open, flowing and shut-in pressures, and recoveries.

SHOW GEOLOGICAL MARKERS, LOGS RUN, OR OTHER DESCRIPTIVE INFORMATION.

FORMATION DESCRIPTION, CONTENTS, ETC.	TOP	BOTTOM	NAME	DEPTH
Sand	0'	40'		
Redbed & Sand	40'	1676'		
Redbed & Shale	1676'	2371'		
Lime & Shale	2371'	6355'		
TOTAL DEPTH		6355'		

DST #1 4570-4608 (KC) 20-40-40-120, op 20 min w/wk blo, op 40 min, no blo, rec 110', DM, NS. IFP 32-64, ISIP 1396 (40), FFP 64-128, FSIP 1380 (120), HP 2237-2381, sample chamber press 0, rec 2240 cc DM, CI 4000, RW .23 72', pit sample CI 3000, RW .45 72'.

USE ADDITIONAL SHEETS, IF NECESSARY, TO COMPLETE WELL RECORD.

Date Received

Paul Campbell
Signature
Paul Campbell, Division Production Manager
Title
May 18, 1978
Date