

STATE CORPORATION COMMISSION OF KANSAS
OIL & GAS CONSERVATION DIVISION
WELL COMPLETION OR RECOMPLETION FORM
ACO-1 WELL HISTORY
DESCRIPTION OF WELL AND LEASE

Operator: License # 04677
Name Cara Ventures, Inc.
Address Rt. 2, Box 150
City/State/Zip Attica, Kansas 67009

Purchaser N/A

Operator Contact Person Paul C. Caragianis
Phone 316-254-7579/316-264-4921

Contractor: License # 30141
Name Summit Drilling Company

Wellsite Geologist Paul C. Caragianis
Phone 316-264-4921

Designate Type of Completion
 New Well Re-Entry Workover

 Oil SWD Temp Abd
 Gas Inj Delayed Comp.
 Dry Other (Core, Water Supply etc.)

If **OWO**: old well info as follows:
Operator
Well Name
Comp. Date Old Total Depth.....

WELL HISTORY

Drilling Method:
 Mud Rotary Air Rotary Cable
12/5/89 12/10/89 12/10/89
.....
Spud Date Date Reached TD Completion Date

...2770..... N/A.....
Total Depth PBD

Amount of Surface Pipe Set and Cemented at 222' feet
Multiple Stage Cementing Collar Used? Yes No
If yes, show depth set.....feet
If alternate 2 completion, cement circulated 232' surface 213'
from.....feet depth to.....w/.....SX cmt
Cement Company Name Allied Cement
Invoice # 55408

API NO. 15-095-21,625-6000
County Kingman
C... SW SE Sec 1 Twp 29S Rge 10 East West

660' Ft North from Southeast Corner of Section
1980 Ft West from Southeast Corner of Section
(Note: Locate well in section plat below)

Lease Name Albers-Eck Well # 1

Field Name Komarek

Producing Formation Indian Cave

Elevation: Ground 1748 1753 KB

Section Plat

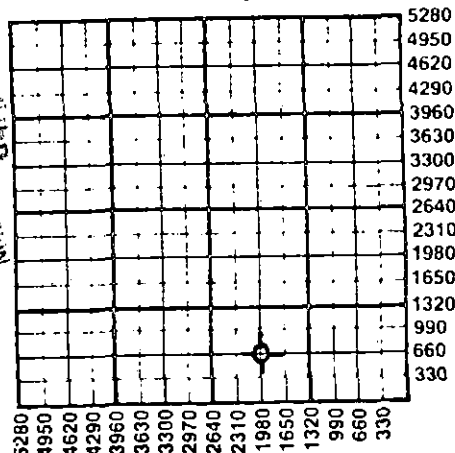

WATER SUPPLY INFORMATION

Disposition of Produced Water: N/A Disposal
Docket # Repressuring

Questions on this portion of the ACO-1 call:

Water Resources Board (913) 296-3717

Source of Water: N/A
Division of Water Resources Permit #.....

Groundwater.....Ft North from Southeast Corner
(Well)Ft West from Southeast Corner of
Sec Twp Rge East West

Surface Water.....Ft North from Southeast Corner
(Stream, pond etc).....Ft West from Southeast Corner
Sec Twp Rge East West

Other (explain) Purchased from Nicholas Water Svc.
Zenda, Kansas
(purchased from city, R.W.D. #)

RECEIVED
STATE CORPORATION COMMISSION
WICHITA, KANSAS
MAY 28 1990

3-28-90

INSTRUCTIONS: This form shall be completed in duplicate and filed with the Kansas Corporation Commission, 200 Colorado Derby Building, Wichita, Kansas 67202, within 90 days after completion or recompleton of any well. Rule 82-3-130 and 82-3-107 apply.

Information on side two of this form will be held confidential for a period of 12 months if requested in writing and submitted with the form. See rule 82-3-107 for confidentiality in excess of 12 months. One copy of all wireline logs and drillers time log shall be attached with this form. Submit CP-4 form with all plugged wells. Submit CP-111 form with all temporarily abandoned wells.

All requirements of the statutes, rules and regulations promulgated to regulate the oil and gas industry have been fully complied with and the statements herein are complete and correct to the best of my knowledge.

Signature Paul C. Caragianis
Title President Date 3/6/90

Subscribed and sworn to before me this 19th day of MARCH
1990
Notary Public Elizabeth Resha
ELIZABETH RESHA

Date Commission Expires 10-30-93



K.C.C. OFFICE USE ONLY
F Letter of Confidentiality Attached
C Wireline Log Received
C Drillers Time Log Received
Distribution
 KCC SWD/Rep NGPA
 KGS Plug Other
(Specify)

Operator Name Cara Ventures, Inc. Lease Name Albers, Ek Well # 1

Sec. 1 Twp. 29S Rge. 10 East West County Kingman

WELL LOG

INSTRUCTIONS: Show important tops and base of formations penetrated. Detail all cores. Report all drill stem tests giving interval tested, time tool open and closed, flowing and shut-in pressures, whether shut-in pressure reached static level, hydrostatic pressures, bottom hole temperature, fluid recovery, and flow rates if gas to surface during test. Attach extra sheet if more space is needed. Attach copy of log.

Drill Stem Tests Taken Yes No
 Samples Sent to Geological Survey Yes No
 Cores Taken Yes No

Formation Description
 Log Sample

Name	Top	Bottom
Indian Cave	2503(-751)	
Wabaunsee	2554(-801)	
Tarkio	2706(-953)	
RTD	2770(-1027)	
LTD	2773(-1030)	

CASING RECORD <input checked="" type="checkbox"/> New <input type="checkbox"/> Used							
Report all strings set-conductor, surface, intermediate, production, etc.							
Purpose of String	Size Hole Drilled	Size Casing Set (in O.D.)	Weight Lbs/Ft.	Setting Depth	Type of Cement	#Sacks Used	Type and Percent Additives
Surface	12 1/2	8 5/8		222'	60/40	213	2% gel 3% CC
PERFORATION RECORD				Acid, Fracture, Shot, Cement Squeeze Record			
Shots Per Foot	Specify Footage of Each Interval Perforated			Amount and Kind of Material Used		Depth	
TUBING RECORD				Liner Run <input type="checkbox"/> Yes <input type="checkbox"/> No			
Date of First Production	Producing Method <input type="checkbox"/> Flowing <input type="checkbox"/> Pumping <input type="checkbox"/> Gas Lift <input type="checkbox"/> Other (explain).....						
Estimated Production Per 24 Hours	Oil	Gas	Water	Gas-Oil Ratio	Gravity		
	Bbls	MCF	Bbls	CFPB			

METHOD OF COMPLETION

Production Interval

Disposition of gas: Vented Open Hole Perforation
 Sold Other (Specify) D&A
 Used on Lease

Dually Completed
 Commingled

