

STATE CORPORATION COMMISSION OF KANSAS  
OIL & GAS CONSERVATION DIVISION  
WELL COMPLETION OR RECOMPLETION FORM  
ACO-1 WELL HISTORY  
DESCRIPTION OF WELL AND LEASE

API NO. 15-095-21598-00-00  
County... Kingman  
NE NE NW Sec. 12 Twp. 30S Rge. 7 East  
X West

Operator: License # 5238  
Name Petroleum, Inc.  
Address 301 N. Main, Suite 900  
City/State/Zip Wichita, KS 67202

4950 Ft North from Southeast Corner of Section  
2970 Ft West from Southeast Corner of Section  
(Note: Locate well in section plat below)

Purchaser Texaco Trading & Trans  
Peoples Natural Gas

Lease Name Crumley 'B' Well # 2  
Field Name Messenger 10 Package

Operator Contact Person Terry Naylor  
Phone (316) 793-8471

Producing Formation Mississippi  
Elevation: Ground 1442 KB 1447

Contractor: License # 5418  
Name Allen Drilling Company

Wellsite Geologist Morris Korphage  
Phone 316/262-3573

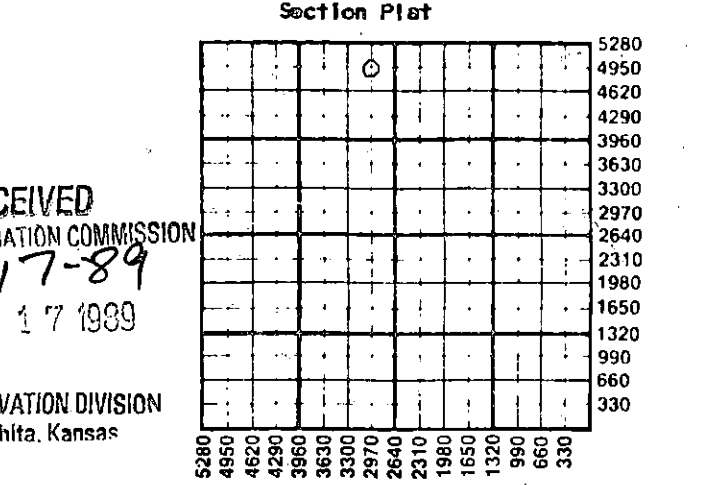

RECEIVED  
STATE CORPORATION COMMISSION  
2-17-89  
FEB 17 1989  
CONSERVATION DIVISION  
Wichita, Kansas

Designate Type of Completion  
X New Well Re-Entry Workover  
X Oil SWD Temp Abd  
X Gas Inj Delayed Comp.  
Dry Other (Core, Water Supply etc.)  
If OWO: old well info as follows:  
Operator  
Well Name  
Comp. Date Old Total Depth

WATER SUPPLY INFORMATION  
Disposition of Produced Water: X Disposal  
Docket # C-14,356 Repressuring

WELL HISTORY  
Drilling Method: X Mud Rotary Air Rotary Cable  
12/19/88 12/30/88 1/20/89  
Spud Date Date Reached TD Completion Date  
4195' 4146'  
Total Depth PBTB  
Amount of Surface Pipe Set and Cemented at 277 feet  
Multiple Stage Cementing Collar Used? Yes X No  
If yes, show depth set...feet  
If alternate 2 completion, cement circulated from...feet depth to...w/...SX cmt  
Cement Company Name  
Invoice #

Questions on this portion of the ACO-1 call:  
Water Resources Board (913) 296-3717  
Source of Water:  
Division of Water Resources Permit #  
X Groundwater...Ft North from Southeast Corner (Well) ...Ft West from Southeast Corner of Sec Twp Rge East West  
Surface Water...Ft North from Southeast Corner (Stream, pond etc)...Ft West from Southeast Corner Sec Twp Rge East West  
Other (explain) (purchased from city, R.W.D. #)

INSTRUCTIONS: This form shall be completed in triplicate and filed with the Kansas Corporation Commission, 200 Colorado Derby Building, Wichita, Kansas 67202, within 120 days of the spud date of any well. Rule 82-3-130, 82-3-107 and 82-3-106 apply. Information on side two of this form will be held confidential for a period of 12 months if requested in writing and submitted with the form. See rule 82-3-107 for confidentiality in excess of 12 months. One copy of all wireline logs and drillers time log shall be attached with this form. Submit CP-4 form with all plugged wells. Submit CP-111 form with all temporarily abandoned wells.

All requirements of the statutes, rules and regulations promulgated to regulate the oil and gas industry have been fully complied with and the statements herein are complete and correct to the best of my knowledge.

Signature R. G. Julius  
Title Superintendent of Production Date 2/15/89

Subscribed and sworn to before me this 15th day of February 1989  
Notary Public Laura A. Miller  
Date Commission Expires May 11, 1989



K.C.C. OFFICE USE ONLY  
F Letter of Confidentiality Attached  
C Wireline Log Received  
C Drillers Timelog Received  
Distribution  
KCC SWD/Rep NGPA  
KGS Plug Other (Specify)  
2-17-89  
Form ACO-1 (5-86)

Sec 12, Twp. 30S, Rge. 7E

Operator Name ..... Petroleum, Inc. .... Lease Name..... Crumley 'B' ..... Well #..... 2

Sec..... 12 ..... Twp..... 30S ..... Rge..... 7 .....  East  West County..... Kingman .....

WELL LOG

INSTRUCTIONS: Show important tops and base of formations penetrated. Detail all cores. Report all drill stem tests giving interval tested, time tool open and closed, flowing and shut-in pressures, whether shut-in pressure reached static level, hydrostatic pressures, bottom hole temperature, fluid recovery, and flow rates if gas to surface during test. Attach extra sheet if more space is needed. Attach copy of log.

Drill Stem Tests Taken  Yes  No  
 Samples Sent to Geological Survey  Yes  No  
 Cores Taken  Yes  No

Formation Description  
 Log  Sample

DST #1; 4086' - 4099'. 15-30-60-120. GTS in 7 mins. stabilized! 211 MCFD. Rec. 60' HGCM, no wtr. IH 2137; IF 41-62, FF 52-62; ISIP 733, FSIP 733, FH 2106.

Name	Top	Bottom
Heebner Shale	3030	(-1583)
Lansing	3254	(-1807)
Kansas City	3548	(-2101)
Stark Shale	3696	(-2249)
B/KC	3796	(-2349)
Cherokee Shale	3951	(-2504)
Miss. Chert	4084	(-2637)
Miss. Limestone	4106	(-2659)
LTD	4194	

DST #2, 4099' - 4114'. 15-30-60-120. GTS @ end of 1st open. Final open gauged 78 MCFD. Rec. 45' GCM, no wtr. IH 2115; IF 41-41, FF 41-52; ISIP 754, FSIP 754; FH 2075.

DST #3, 4114' - 4148'. 1st open S.B. 2nd open GTS @ end of period TSTM. Rec. 115' HGCM w/trace oil and 60' SOCWM (2% oil, 18% water). IF 52-41, FF 72-93; SIP 568-754. 130° F.

CASING RECORD <input checked="" type="checkbox"/> New <input type="checkbox"/> Used							
Report all strings set-conductor, surface, intermediate, production, etc.							
Purpose of String	Size Hole Drilled	Size Casing Set (in O.D.)	Weight Lbs/Ft.	Setting Depth	Type of Cement	#Sacks Used	Type and Percent Additives
Surface	12-1/4"	8-5/8"	20#	277'	60/40 Poz	180	2% gel, 3%cc
Production	7-7/8"	5-1/2"	14#	4194'	60/40 Poz	65	2% gel, 3%cc
PERFORATION RECORD				Acid, Fracture, Shot, Cement Squeeze Record (Amount and Kind of Material Used)			
Shots Per Foot	Specify Footage of Each Interval Perforated						Depth
4	4088'-4101'			1000 gallons 7% HCl			4088-4101
				Frac with 20,000 gallons 2% gelled acid with 13,500# 20/40 sand and 6500# 12/20 sand			4088-4101
TUBING RECORD				Liner Run <input type="checkbox"/> Yes <input checked="" type="checkbox"/> No			
Date of First Production		Producing Method <input checked="" type="checkbox"/> Flowing <input type="checkbox"/> Pumping <input type="checkbox"/> Gas Lift <input type="checkbox"/> Other (explain).....					
Estimated Production Per 24 Hours		Oil	Gas	Water	Gas-Oil Ratio	Gravity	
6.72 Bbls		1076 MCF	162 Bbls	160,119 CFPB			

METHOD OF COMPLETION

Production Interval

Disposition of gas:  Vented  Open Hole  Perforation  
 Sold  Other (Specify) ..... 4088-4101'  
 Used on Lease  Dually Completed .....  
 Conmingled