

15-009-30311-8990

WELL PLUGGING RECORD

Give All Information Completely
Make Required Affidavit
Mail or Deliver Report to:
Conservation Division
State Corporation Commission
211 No. Broadway
Wichita, Kansas

BARTON County, Sec. 3 Twp. 16s Rge. 21 (X) (W)

Location as "NE/CNW&SW" or footage from lines APPROX. S/2 NW NE

Lease Owner PETROLEUM, INC.,

Lease Name WEBER "K" Well No. 1

Office Address R.R. #2, GREAT BEND, KANSAS

Character of Well (completed as Oil, Gas or Dry Hole) DRY HOLE

Date well completed APRIL 26, 1965

Application for plugging filed APRIL 26, 1965

Application for plugging approved APRIL 26, 1965

Plugging commenced APRIL 26, 1965

Plugging completed APRIL 26, 1965

Reason for abandonment of well or producing formation NO PRODUCIBLE ZONE

If a producing well is abandoned, date of last production - 19

Was permission obtained from the Conservation Division or its agents before plugging was commenced? YES

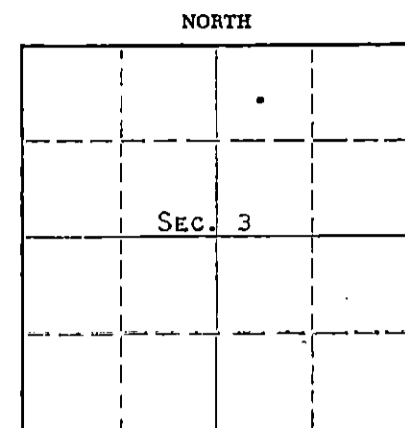

Locate well correctly on above Section Plat

Name of Conservation Agent who supervised plugging of this well DONALD TRUAN

Producing formation - - - Depth to top - - - Bottom - - - Total Depth of Well 3405 Feet

Show depth and thickness of all water, oil and gas formations.

OIL, GAS OR WATER RECORDS

CASING RECORD

FORMATION	CONTENT	FROM	TO	SIZE	PUR IN	PULLED OUT
				8-5/8"	424'	NONE

Describe in detail the manner in which the well was plugged, indicating where the mud fluid was placed and the method or methods used in introducing it into the hole. If cement or other plugs were used, state the character of same and depth placed, from feet to feet for each plug set.

MUDDED UP WITH HEAVY MUD THROUGH DRILL PIPE TO 420', FOLLOWED BY WOODEN PLUG AND 25 SACKS CEMENT, MUDDED UP WITH HEAVY MUD TO 40', FOLLOWED BY A WOODEN PLUG AND 10 SACKS CEMENT AND 1/2 SACK HULLS TO BASE OF CELLAR. PLUGGED RAT HOLE W/2 SACKS CEMENT.

RECEIVED
STATE CORPORATION COMMISSION

MAY 12 1965

05-12-65

CONSERVATION DIVISION
Wichita, Kansas

(If additional description is necessary, use BACK of this sheet)

Name of Plugging Contractor GARVEY DRLG. CO.

Address ROUTE #2, GREAT BEND, KANSAS

STATE OF KANSAS, COUNTY OF BARTON, ss.

MONTE CHADD (employee of owner) or (owner) of the above-described

well, being first duly sworn on oath, says: That I have knowledge of the facts, statements, and matters herein contained and the log of the above-described well as filed and that the same are true and correct. So help me God. MONTE CHADD, DIST. PROD. SUPT.

(Signature)

ROUTE #2, GREAT BEND, KANSAS

(Address)

SUBSCRIBED AND SWORN to before me this 11 day of MAY, 1965

My commission expires APRIL 14, 1967

Archers J. Miles
Notary Public.

WELL LOG

COMPANY Petroleum, Inc.

SEC. 3 T. 16S R. 12W

FARM Weber

NO. K-1

LOG. App. S/1/2 NW NE

TOTAL DEPTH 3405'

COUNTY Barton

COMM. 4-20-65

COMP. 4-26-65

CONTRACTOR Garvey Drilling Company

CASING 8 5/8" @ 424' w/200 sx

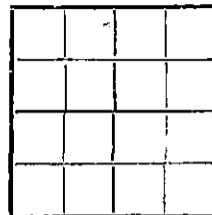

ELEVATION 1893' DF

PRODUCTION D & A

FIGURES INDICATE BOTTOM OF FORMATIONS

70' Clay and Post Rock
130' Sand
425' Shale
510' Shale and Shells
776' Shale and Red Bed
804' Anhydrite
1010' Shale and Shells
1500' Shale
1785' Lime and Shale
1980' Shale and Lime
2868' Lime and Shale
3045' Shale and Lime
3155' Lime and Shale
3315' Lime
3367' Lime and Shale
3405' Lime
3405' RTD

RECEIVED
STATE CORPORATION COMMISSION

MAY 12 1965

CONSERVATION DIVISION
Wichita, Kansas

State of Kansas }
County of Barton } ss

I, Sam N. Stephens of Garvey Drilling Company

upon oath state the above and foregoing is a true and correct copy of the log of the Weber K-1 well.

Sam N. Stephens

Subscribed and sworn to before me this 3rd day of May 19 65

My Commission Expires: April 14, 1967

Arthur J. Wiles
NOTARY PUBLIC