



Operator Name: _____ Lease Name: _____ Well #: _____

Sec. _____ Twp. _____ S. R. _____ East West County: _____

INSTRUCTIONS: Show important tops of formations penetrated. Detail all cores. Report all final copies of drill stems tests giving interval tested, time tool open and closed, flowing and shut-in pressures, whether shut-in pressure reached static level, hydrostatic pressures, bottom hole temperature, fluid recovery, and flow rates if gas to surface test, along with final chart(s). Attach extra sheet if more space is needed.

Final Radioactivity Log, Final Logs run to obtain Geophysical Data and Final Electric Logs must be emailed to kcc-well-logs@kcc.ks.gov. Digital electronic log files must be submitted in LAS version 2.0 or newer AND an image file (TIFF or PDF).

Drill Stem Tests Taken <input type="checkbox"/> Yes <input type="checkbox"/> No <i>(Attach Additional Sheets)</i> Samples Sent to Geological Survey <input type="checkbox"/> Yes <input type="checkbox"/> No Cores Taken <input type="checkbox"/> Yes <input type="checkbox"/> No Electric Log Run <input type="checkbox"/> Yes <input type="checkbox"/> No List All E. Logs Run: _____	<input type="checkbox"/> Log Formation (Top), Depth and Datum <input type="checkbox"/> Sample Name Top Datum
--------------------------------------------------------------------------------------------------------------------------------------------------------------------------------------------------------------------------------------------------------------------------------------------------------------------------------------------------------------------------------------------------------------------	---------------------------------------------------------------------------------------------------------------------

CASING RECORD <input type="checkbox"/> New <input type="checkbox"/> Used							
Report all strings set-conductor, surface, intermediate, production, etc.							
Purpose of String	Size Hole Drilled	Size Casing Set (In O.D.)	Weight Lbs. / Ft.	Setting Depth	Type of Cement	# Sacks Used	Type and Percent Additives

ADDITIONAL CEMENTING / SQUEEZE RECORD				
Purpose:	Depth Top Bottom	Type of Cement	# Sacks Used	Type and Percent Additives
<input type="checkbox"/> Perforate <input type="checkbox"/> Protect Casing <input type="checkbox"/> Plug Back TD <input type="checkbox"/> Plug Off Zone				

Did you perform a hydraulic fracturing treatment on this well? Yes No *(If No, skip questions 2 and 3)*
 Does the volume of the total base fluid of the hydraulic fracturing treatment exceed 350,000 gallons? Yes No *(If No, skip question 3)*
 Was the hydraulic fracturing treatment information submitted to the chemical disclosure registry? Yes No *(If No, fill out Page Three of the ACO-1)*

Shots Per Foot	PERFORATION RECORD - Bridge Plugs Set/Type Specify Footage of Each Interval Perforated	Acid, Fracture, Shot, Cement Squeeze Record <i>(Amount and Kind of Material Used)</i>	Depth

TUBING RECORD: Size: _____ Set At: _____ Packer At: _____ Liner Run: Yes No

Date of First, Resumed Production, SWD or ENHR. _____ Producing Method:
 Flowing Pumping Gas Lift Other *(Explain)* _____

Estimated Production Per 24 Hours	Oil Bbls.	Gas Mcf	Water Bbls.	Gas-Oil Ratio	Gravity

DISPOSITION OF GAS: <input type="checkbox"/> Vented <input type="checkbox"/> Sold <input type="checkbox"/> Used on Lease <i>(If vented, Submit ACO-18.)</i>	METHOD OF COMPLETION: <input type="checkbox"/> Open Hole <input type="checkbox"/> Perf. <input type="checkbox"/> Dually Comp. <input type="checkbox"/> Commingled <i>(Submit ACO-5)</i> <input type="checkbox"/> Other <i>(Specify)</i> _____ <i>(Submit ACO-4)</i>	PRODUCTION INTERVAL: _____ _____
--------------------------------------------------------------------------------------------------------------------------------------------------------------------------	-------------------------------------------------------------------------------------------------------------------------------------------------------------------------------------------------------------------------------------------------------------------------------------	-----------------------------------------------

Summary of Changes

Lease Name and Number: Kohl 1-33H

API/Permit #: 15-195-22951-01-00

Doc ID: 1251183

Correction Number: 1

Approved By: NAOMI JAMES

Field Name	Previous Value	New Value
Approved Date	02/16/2015	04/29/2015
Date of First or Resumed Production or SWD or Enhr Production - Barrels Oil	02/12/2015	02/22/2015
		23
Production - Barrels of Water		83
Save Link	../..kcc/detail/operatorEditDetail.cfm?docID=1238610	../..kcc/detail/operatorEditDetail.cfm?docID=1251183



Confidentiality Requested:

Yes No

KANSAS CORPORATION COMMISSION 1238610
OIL & GAS CONSERVATION DIVISION

Form ACO-1
August 2013

Form must be Typed
Form must be Signed
All blanks must be Filled

CONFIDENTIAL WELL COMPLETION FORM
WELL HISTORY - DESCRIPTION OF WELL & LEASE

OPERATOR: License # _____

Name: _____

Address 1: _____

Address 2: _____

City: _____ State: _____ Zip: _____ + _____

Contact Person: _____

Phone: (_____) _____

CONTRACTOR: License # _____

Name: _____

Wellsite Geologist: _____

Purchaser: _____

Designate Type of Completion:

- New Well Re-Entry Workover
- Oil WSW SWD SIOW
- Gas D&A ENHR SIGW
- OG GSW Temp. Abd.
- CM (Coal Bed Methane)
- Cathodic Other (Core, Expl., etc.): _____

If Workover/Re-entry: Old Well Info as follows:

Operator: _____

Well Name: _____

Original Comp. Date: _____ Original Total Depth: _____

- Deepening Re-perf. Conv. to ENHR Conv. to SWD
- Plug Back Conv. to GSW Conv. to Producer
- Commingled Permit #: _____
- Dual Completion Permit #: _____
- SWD Permit #: _____
- ENHR Permit #: _____
- GSW Permit #: _____

Spud Date or Recompletion Date	Date Reached TD	Completion Date or Recompletion Date
-----------------------------------	-----------------	-----------------------------------------

API No. 15 - _____

Spot Description: _____

_____ - _____ - _____ Sec. _____ Twp. _____ S. R. _____ East West

_____ Feet from North / South Line of Section

_____ Feet from East / West Line of Section

Footages Calculated from Nearest Outside Section Corner:

- NE NW SE SW

GPS Location: Lat: _____, Long: _____
(e.g. xx.xxxxx) (e.g. -xxx.xxxxx)

Datum: NAD27 NAD83 WGS84

County: _____

Lease Name: _____ Well #: _____

Field Name: _____

Producing Formation: _____

Elevation: Ground: _____ Kelly Bushing: _____

Total Vertical Depth: _____ Plug Back Total Depth: _____

Amount of Surface Pipe Set and Cemented at: _____ Feet

Multiple Stage Cementing Collar Used? Yes No

If yes, show depth set: _____ Feet

If Alternate II completion, cement circulated from: _____

feet depth to: _____ w/ _____ sx cmt.

Drilling Fluid Management Plan

(Data must be collected from the Reserve Pit)

Chloride content: _____ ppm Fluid volume: _____ bbls

Dewatering method used: _____

Location of fluid disposal if hauled offsite: _____

Operator Name: _____

Lease Name: _____ License #: _____

Quarter _____ Sec. _____ Twp. _____ S. R. _____ East West

County: _____ Permit #: _____

AFFIDAVIT

I am the affiant and I hereby certify that all requirements of the statutes, rules and regulations promulgated to regulate the oil and gas industry have been fully complied with and the statements herein are complete and correct to the best of my knowledge.

Submitted Electronically

KCC Office Use ONLY

- Confidentiality Requested
Date: _____
- Confidential Release Date: _____
- Wireline Log Received
- Geologist Report Received
- UIC Distribution
- ALT I II III Approved by: _____ Date: _____

Operator Name: _____ Lease Name: _____ Well #: _____

Sec. _____ Twp. _____ S. R. _____ East West County: _____

INSTRUCTIONS: Show important tops of formations penetrated. Detail all cores. Report all final copies of drill stems tests giving interval tested, time tool open and closed, flowing and shut-in pressures, whether shut-in pressure reached static level, hydrostatic pressures, bottom hole temperature, fluid recovery, and flow rates if gas to surface test, along with final chart(s). Attach extra sheet if more space is needed.

Final Radioactivity Log, Final Logs run to obtain Geophysical Data and Final Electric Logs must be emailed to kcc-well-logs@kcc.ks.gov. Digital electronic log files must be submitted in LAS version 2.0 or newer AND an image file (TIFF or PDF).

Drill Stem Tests Taken <input type="checkbox"/> Yes <input type="checkbox"/> No <i>(Attach Additional Sheets)</i> Samples Sent to Geological Survey <input type="checkbox"/> Yes <input type="checkbox"/> No Cores Taken <input type="checkbox"/> Yes <input type="checkbox"/> No Electric Log Run <input type="checkbox"/> Yes <input type="checkbox"/> No Geologist Report / Mud Logs <input type="checkbox"/> Yes <input type="checkbox"/> No List All E. Logs Run:	<input type="checkbox"/> Log Formation (Top), Depth and Datum <input type="checkbox"/> Sample Name Top Datum
------------------------------------------------------------------------------------------------------------------------------------------------------------------------------------------------------------------------------------------------------------------------------------------------------------------------------------------------------------------------------------------------------------------------------------------------------------------------------------------------------	---------------------------------------------------------------------------------------------------------------------

CASING RECORD <input type="checkbox"/> New <input type="checkbox"/> Used							
Report all strings set-conductor, surface, intermediate, production, etc.							
Purpose of String	Size Hole Drilled	Size Casing Set (In O.D.)	Weight Lbs. / Ft.	Setting Depth	Type of Cement	# Sacks Used	Type and Percent Additives

ADDITIONAL CEMENTING / SQUEEZE RECORD				
Purpose:	Depth Top Bottom	Type of Cement	# Sacks Used	Type and Percent Additives
<input type="checkbox"/> Perforate <input type="checkbox"/> Protect Casing <input type="checkbox"/> Plug Back TD <input type="checkbox"/> Plug Off Zone				

1. Did you perform a hydraulic fracturing treatment on this well? Yes No *(If No, skip questions 2 and 3)*
2. Does the volume of the total base fluid of the hydraulic fracturing treatment exceed 350,000 gallons? Yes No *(If No, skip question 3)*
3. Was the hydraulic fracturing treatment information submitted to the chemical disclosure registry? Yes No *(If No, fill out Page Three of the ACO-1)*

Date of first Production/Injection or Resumed Production/Injection:	Producing Method: <input type="checkbox"/> Flowing <input type="checkbox"/> Pumping <input type="checkbox"/> Gas Lift <input type="checkbox"/> Other <i>(Explain)</i> _____			
Estimated Production Per 24 Hours	Oil Bbls.	Gas Mcf	Water Bbls.	Gas-Oil Ratio Gravity

DISPOSITION OF GAS: <input type="checkbox"/> Vented <input type="checkbox"/> Sold <input type="checkbox"/> Used on Lease <i>(If vented, Submit ACO-18.)</i>	METHOD OF COMPLETION: <input type="checkbox"/> Open Hole <input type="checkbox"/> Perf. <input type="checkbox"/> Dually Comp. <input type="checkbox"/> Commingled <i>(Submit ACO-5)</i> <i>(Submit ACO-4)</i>	PRODUCTION INTERVAL: Top Bottom
-------------------------------------------------------------------------------------------------------------------------------------------------------------------	---------------------------------------------------------------------------------------------------------------------------------------------------------------------------------------------------------------------	------------------------------------

Shots Per Foot	Perforation Top	Perforation Bottom	Bridge Plug Type	Bridge Plug Set At	Acid, Fracture, Shot, Cementing Squeeze Record <i>(Amount and Kind of Material Used)</i>

TUBING RECORD:	Size:	Set At:	Packer At:	
----------------	-------	---------	------------	--

Form	ACO1 - Well Completion
Operator	Cholla Production, LLC
Well Name	Kohl 1-33H
Doc ID	1238610

Perforations

Shots Per Foot	Perforation Record	Material Record	Depth
		See attached sheet	

ALLIED OIL & GAS SERVICE, LLC 063903

Federal Tax I.D. # 20-8651475

REMIT TO P.O. BOX 93999
SOUTHLAKE, TEXAS 76092

SERVICE POINT:
Great Bend KS

DATE <u>10-24-14</u>	SEC <u>33</u>	TWP. <u>11</u>	RANGE <u>22</u>	CALLED OUT	ON LOCATION <u>100 Am</u>	JOB START <u>10:00 AM</u>	JOB FINISH <u>11:00 AM</u>
LEASE <u>Kohl</u>		WELL # <u>1-33</u>		LOCATION <u>Ogalla north to yield sign 2</u>		COUNTY <u>Neogo</u>	STATE <u>KS</u>
OLD OR NEW (Circle one)			<u>West north 3/4 East side</u>				

CONTRACTOR <u>HWD #6</u>		OWNER
TYPE OF JOB <u>surface</u>		CEMENT
HOLE SIZE <u>12 1/4</u>	TD	AMOUNT ORDERED <u>350 sis AMD + 4% gel + 2% Gyc + 2% meta + 2% cc + 1/4 flo</u>
CASING SIZE <u>9 5/8</u>	DEPTH <u>1861.66</u>	<u>300 sis class A + 3% cc + 1/4 flo</u>
TUBING SIZE	DEPTH	
DRILL PIPE	DEPTH	
TOOL	DEPTH	
PRES. MAX	MINIMUM	COMMON <u>300</u> @
MEAS. LINE	SHOE JOINT	POZMIX @
CEMENT LEFT IN CSG. <u>42.29</u>		GEL @
PERFS.		CHLORIDE <u>8.46</u> @
DISPLACEMENT		ASC @

EQUIPMENT		
PUMP TRUCK # <u>597</u>	CEMENTER <u>Kevin Eddy</u>	FLU SEAL <u>88</u> @
	HELPER <u>Ben Jewell</u>	<u>Allied materials</u> @
BULK TRUCK # <u>870/899</u>	DRIVER <u>Jacqueline Barnett (TWS)</u>	<u>Materials to</u>
BULK TRUCK #	DRIVER <u>Dan Cooper</u>	<u>Dia</u>
		<u>Servi</u>
		HANDLING <u>720.37</u> @

REMARKS:

on location Rigup - Held safety meeting - Rig
Ran 1361-4657 9 5/8 casing - Broke C/C w/ Rig
mid - Pump 5 RBIs added mix 350 sis AMD 4%
Calc 2% Gyc + 2% meta + 2% cc + 1/4 flo mixed
300 sis class A + 3% cc + 1/4 flo, shut down
Release Plug - Displace 140.63 RBIs Fresh 1420
Good Plug @ PST. Cemented lid circ
Rig Down

DEPTH OF JOB	
PUMP TRUCK CHARGE	
EXTRA FOOTAGE	@
MILEAGE <u>Heavy</u>	<u>35</u> @
MANIFOLD <u>Light</u>	<u>35</u> @
<u>Drays for Product 131.65</u>	@
<u>4 hours of wait Time</u>	@

CHARGE TO: Cholla Productions
STREET _____
CITY _____ STATE _____ ZIP _____

THANK YOU!

To: Allied Oil & Gas Services, LLC.
You are hereby requested to rent cementing equipment and furnish cementer and helper(s) to assist owner or contractor to do work as is listed. The above work was done to satisfaction and supervision of owner agent or contractor. I have read and understand the "GENERAL TERMS AND CONDITIONS" listed on the reverse side.

PRINTED NAME John Johnson
SIGNATURE [Signature]

PLUG & FLOATED

Guide shoe	<u>1</u>
API Flapper float collar	<u>1</u> @
Thread lock	<u>2</u> @
Cement Basket	<u>2</u> @
Centralizer	<u>5</u> @
Rubber Plug	<u>1</u> @

SALES TAX _____
TOTAL CH _____
DISCOUNT _____

ALLIED OIL & GAS SERVICES, LLC 055573

Federal Tax I.D.# 20-5975804

REMIT TO P.O. BOX 31
RUSSELL, KANSAS 67665

SERVICE POINT:
Russell KS

DATE <u>11-24-14</u>	SEC. <u>33</u>	TWP. <u>11</u>	RANGE <u>22</u>	CALLED OUT <u>8:30</u>	ON LOCATION <u>11:00</u>	JOB START <u>1:30</u>	JOB FINISH <u>4:30</u>
LEASE <u>Kona</u>	WELL# <u>1-33H</u>	LOCATION <u>Oballah Exit North To</u>			COUNTY <u>Trigo</u>	STATE <u>KS</u>	
OLD OF <u>NEW</u> (Circle one)		Well Sign. Western IN-E Into					

CONTRACTOR Hwpb OWNER Cholla

TYPE OF JOB L.S. 5 1/2"

HOLE SIZE 7 7/8 T.D. 8348 CEMENT AMOUNT ORDERED 200 sks Common w/ Additives

CASING SIZE 5 1/2 17# DEPTH 8343 650 sks Common w/ Additives

TUBING SIZE DEPTH

DRILL PIPE DEPTH

TOOL DEPTH

PRES. MAX MINIMUM COMMON 200

MEAS. LINE SHOE JOINT POZMIX

CEMENT LEFT IN CSG. 1 bkc GEL 1222

PERFS. CHLORIDE

DISPLACEMENT 193.5 ASC

EQUIPMENT Common 650

PUMP TRUCK CEMENTER Steve O De Sommer 153

477 HELPER Robert V 500 ton mixer 1468

BULK TRUCK # 603 DRIVER Steve S 5 micron reducer 123

BULK TRUCK # 712 DRIVER 858 6.5 onite 1301

858 CE-L160 489

REMARKS: see log Materials 35781.27 8945.31 TON 139822.75 TOT.

Service

DEPTH OF JOB 8001-9

PUMP TRUCK CHARGE

EXTRA FOOTAGE @

MILEAGE 35 @

MANIFOLD @

Heavy Mileage 105 @

Cholla Productions

Street Alia 2787.68

CITY STATE ZIP

PLUG & FLOAT EC

Thread Lock Kit 4

Blue 5 1/2" Bucket @

5/8" Hatch Down Pipe @

MJ Surger 58 @

Allied Spacer 4000 @

To: Allied Oil & Gas Services, LLC.

You are hereby requested to rent cementing equipment and furnish cementer and helper(s) to assist owner or contractor to do work as is listed. The above work was done to satisfaction and supervision of owner agent or contractor. I have read and understand the "GENERAL TERMS AND CONDITIONS" listed on the reverse side.

PRINTED NAME John Johnston

SIGNATURE John Johnston

SALES TAX TOTAL CH DISCOUNT 36 Discount @ other 5



Cholla Production MWD: Kolby Davis , Philip Spoonemor
 Kohl 1-33H DIRECTIONAL DRILLERS: Billy Spurgen / Tony
 HWD # 6 Magnetic Declination: 6.57
 Trego co, KS Job #: Dr 1410216
 Minimum Curvature Calculation Vertical Section Azimuth 7.45

No.	Survey Depth	INC	AZM	TVD	N-S	E-W	Vertical Section	DLS/100	BUR	WR
Tie	0	0.00	0.00	0.00	0.00	0.00	0.00	0.00	0	0.00
1	2097	0.80	233.30	2096.93	-8.75	-11.74	-10.20	0.04	0.04	6.04
2	2525	1.00	242.80	2524.88	-12.24	-17.46	-14.40	0.06	0.05	2.22
3	2951	0.60	236.80	2950.84	-15.16	-22.63	-17.97	0.10	-0.09	-1.41
4	3178	0.10	259.70	3177.83	-15.85	-23.82	-18.80	0.22	-0.22	10.09
5	3223	0.90	359.90	3222.83	-15.50	-23.86	-18.46	2.05	1.78	222.67
6	3268	3.70	1.90	3267.79	-13.70	-23.81	-16.67	6.22	6.22	-4.44
7	3313	6.70	359.20	3312.60	-9.62	-23.80	-12.62	6.69	6.67	6.00
8	3358	10.20	1.90	3357.10	-3.01	-23.70	-6.06	7.83	7.78	-6.00
9	3403	13.60	5.70	3401.13	6.24	-23.04	3.20	7.75	7.56	8.44
10	3448	17.50	9.50	3444.48	18.18	-21.40	15.25	8.95	8.67	8.44
11	3493	20.90	9.50	3486.97	32.77	-18.96	30.04	7.56	7.56	0.00
12	3538	24.50	8.90	3528.47	49.92	-16.19	47.39	8.02	8.00	-1.33
13	3583	28.00	9.20	3568.83	69.57	-13.06	67.29	7.78	7.78	0.67
14	3628	30.90	7.80	3608.01	91.45	-9.80	89.40	6.62	6.44	-3.11
15	3673	32.30	8.50	3646.34	114.79	-6.45	112.98	3.22	3.11	1.56
16	3718	36.00	9.50	3683.57	139.73	-2.49	138.23	8.32	8.22	2.22
17	3763	39.40	9.50	3719.17	166.87	2.05	165.72	7.56	7.56	0.00
18	3807	42.30	8.70	3752.45	195.28	6.59	194.49	6.70	6.59	-1.82
19	3852	45.10	8.80	3784.98	226.01	11.32	225.57	6.22	6.22	0.22
20	3897	47.40	8.60	3816.10	258.14	16.24	258.06	5.12	5.11	-0.44
21	3942	49.80	8.40	3845.85	291.52	21.23	291.81	5.34	5.33	-0.44
22	3987	52.20	8.30	3874.17	326.12	26.31	326.78	5.34	5.33	-0.22
23	4032	54.80	8.50	3900.94	361.90	31.59	362.94	5.79	5.78	0.44
24	4077	58.70	7.80	3925.60	399.15	36.92	400.56	8.76	8.67	-1.56
25	4122	63.30	7.40	3947.41	438.15	42.12	439.91	10.25	10.22	-0.89
26	4167	68.20	8.10	3965.89	478.79	47.66	480.93	10.98	10.89	1.56
27	4212	74.20	8.20	3980.39	520.94	53.69	523.50	13.33	13.33	0.22
28	4254	79.70	8.10	3989.87	561.43	59.49	564.40	13.10	13.10	-0.24
29	4299	81.80	8.00	3997.10	605.40	65.71	608.81	4.67	4.67	-0.22
30	4344	81.90	7.50	4003.48	649.54	71.72	653.35	1.12	0.22	-1.11
31	4389	82.70	7.60	4009.51	693.75	77.58	697.95	1.79	1.78	0.22
32	4434	83.40	7.20	4014.95	738.04	83.33	742.62	1.79	1.56	-0.89
33	4479	87.00	6.90	4018.72	782.54	88.83	787.45	8.03	8.00	-0.67
34	4524	87.50	7.10	4020.88	827.15	94.31	832.40	1.20	1.11	0.44
35	4569	88.00	7.20	4022.64	871.77	99.91	877.36	1.13	1.11	0.22
36	4614	88.30	7.40	4024.10	916.38	105.62	922.34	0.80	0.67	0.44
37	4659	88.80	6.70	4025.24	961.02	111.14	967.32	1.91	1.11	-1.56
38	4703	89.40	7.80	4025.93	1004.67	116.69	1011.32	2.85	1.36	2.50



Cholla Production MWD: Kolby Davis , Philip Spoonemor
 Kohl 1-33H DIRECTIONAL DRILLERS: Billy Spurgen / Tony
 HWD # 6 Magnetic Declination: 6.57
 Trego co, KS Job #: Dr 1410216
 Minimum Curvature Calculation Vertical Section Azimuth 7.45

No.	Survey Depth	INC	AZM	TVD	N-S	E-W	Vertical Section	DLS/100	BUR	WR
39	4752	89.30	8.00	4026.48	1053.20	123.43	1060.31	0.46	-0.20	0.41
40	4796	88.60	8.30	4027.29	1096.75	129.67	1104.30	1.73	-1.59	0.68
41	4841	88.10	8.90	4028.58	1141.22	136.39	1149.27	1.74	-1.11	1.33
42	4886	87.60	8.40	4030.27	1185.68	143.15	1194.23	1.57	-1.11	-1.11
43	4931	88.80	8.20	4031.69	1230.18	149.65	1239.20	2.70	2.67	-0.44
44	4976	89.20	7.60	4032.47	1274.75	155.83	1284.19	1.60	0.89	-1.33
45	5021	89.70	7.20	4032.90	1319.37	161.63	1329.19	1.42	1.11	-0.89
46	5066	89.40	7.60	4033.26	1364.00	167.42	1374.19	1.11	-0.67	0.89
47	5110	88.70	7.60	4033.99	1407.60	173.24	1418.18	1.59	-1.59	0.00
48	5155	89.00	7.90	4034.89	1452.18	179.31	1463.17	0.94	0.67	0.67
49	5200	89.40	7.90	4035.52	1496.75	185.49	1508.17	0.89	0.89	0.00
50	5245	89.20	6.90	4036.07	1541.37	191.29	1553.16	2.27	-0.44	-2.22
51	5290	90.10	7.40	4036.34	1586.02	196.89	1598.16	2.29	2.00	1.11
52	5335	91.10	8.60	4035.87	1630.58	203.15	1643.16	3.47	2.22	2.67
53	5380	91.10	8.40	4035.01	1675.08	209.80	1688.14	0.44	0.00	-0.44
54	5425	89.50	8.60	4034.77	1719.58	216.45	1733.13	3.58	-3.56	0.44
55	5489	90.60	8.00	4034.72	1782.91	225.69	1797.12	1.96	1.72	-0.94
56	5534	91.60	8.00	4033.85	1827.46	231.95	1842.11	2.22	2.22	0.00
57	5579	91.20	7.30	4032.75	1872.05	237.94	1887.10	1.79	-0.89	-1.56
58	5623	90.40	7.20	4032.14	1915.69	243.49	1931.09	1.83	-1.82	-0.23
59	5668	89.80	6.50	4032.06	1960.37	248.86	1976.09	2.05	-1.33	-1.56
60	5713	91.40	6.80	4031.59	2005.06	254.07	2021.08	3.62	3.56	0.67
61	5758	91.20	7.20	4030.57	2049.72	259.55	2066.07	0.99	-0.44	0.89
62	5803	90.50	6.80	4029.90	2094.38	265.04	2111.06	1.79	-1.56	-0.89
63	5848	92.40	7.50	4028.76	2139.01	270.64	2156.04	4.50	4.22	1.56
64	5893	93.30	7.50	4026.52	2183.57	276.50	2200.99	2.00	2.00	0.00
65	5938	92.50	8.20	4024.25	2228.09	282.64	2245.93	2.36	-1.78	1.56
66	5983	91.00	8.10	4022.87	2272.61	289.02	2290.90	3.34	-3.33	-0.22
67	6028	89.10	7.80	4022.83	2317.18	295.24	2335.90	4.27	-4.22	-0.67
68	6073	87.60	7.20	4024.13	2361.77	301.11	2380.88	3.59	-3.33	-1.33
69	6118	87.40	7.50	4026.09	2406.36	306.86	2425.83	0.80	-0.44	0.67
70	6163	86.90	7.30	4028.33	2450.93	312.65	2470.78	1.20	-1.11	-0.44
71	6208	89.80	7.70	4029.63	2495.52	318.52	2515.76	6.51	6.44	0.89
72	6253	90.80	7.00	4029.39	2540.15	324.28	2560.75	2.71	2.22	-1.56
73	6298	89.80	6.90	4029.15	2584.82	329.72	2605.75	2.23	-2.22	-0.22
74	6342	89.30	6.90	4029.50	2628.50	335.01	2649.75	1.14	-1.14	0.00
75	6387	90.20	5.10	4029.70	2673.25	339.71	2694.73	4.47	2.00	-4.00
76	6432	90.00	5.30	4029.62	2718.06	343.79	2739.70	0.63	-0.44	0.44



Cholla Production
 Kohl 1-33H
 HWD # 6
 Trego co, KS
 Minimum Curvature Calculation

MWD: Kolby Davis , Philip Spoonemor
 DIRECTIONAL DRILLERS: Billy Spurgen / Tony
 Magnetic Declination: 6.57
 Job #: Dr 1410216
 Vertical Section Azimuth 7.45

No.	Survey Depth	INC	AZM	TVD	N-S	E-W	Vertical Section	DLS/100	BUR	WR
77	6477	88.90	4.80	4030.05	2762.89	347.75	2784.65	2.69	-2.44	-1.11
78	6522	89.00	4.60	4030.87	2807.73	351.44	2829.59	0.50	0.22	-0.44
79	6567	89.30	4.40	4031.54	2852.58	354.97	2874.53	0.80	0.67	-0.44
80	6612	88.50	4.60	4032.41	2897.44	358.50	2919.46	1.83	-1.78	0.44
81	6657	91.40	6.60	4032.45	2942.21	362.89	2964.43	7.83	6.44	4.44
82	6702	91.50	6.90	4031.31	2986.89	368.18	3009.41	0.70	0.22	0.67
83	6747	91.00	6.60	4030.32	3031.57	373.46	3054.40	1.30	-1.11	-0.67
84	6792	90.20	6.10	4029.85	3076.29	378.44	3099.39	2.10	-1.78	-1.11
85	6837	90.30	6.30	4029.66	3121.02	383.30	3144.38	0.50	0.22	0.44
86	6882	90.50	9.30	4029.34	3165.60	389.41	3189.37	6.68	0.44	6.67
87	6924	91.40	10.70	4028.65	3206.96	396.70	3231.32	3.96	2.14	3.33
88	6969	90.90	10.60	4027.74	3251.17	405.01	3276.24	1.13	-1.11	-0.22
89	7014	88.90	9.40	4027.82	3295.48	412.83	3321.19	5.18	-4.44	-2.67
90	7058	88.40	9.20	4028.86	3338.89	419.94	3365.16	1.22	-1.14	-0.45
91	7103	89.60	10.10	4029.64	3383.25	427.48	3410.12	3.33	2.67	2.00
92	7148	89.90	8.80	4029.84	3427.64	434.87	3455.09	2.96	0.67	-2.89
93	7192	89.60	8.00	4030.03	3471.16	441.29	3499.08	1.94	-0.68	-1.82
94	7234	90.60	7.50	4029.96	3512.78	446.96	3541.08	2.66	2.38	-1.19
95	7276	90.50	7.50	4029.56	3554.42	452.44	3583.08	0.24	-0.24	0.00
96	7320	90.00	6.70	4029.36	3598.08	457.88	3627.08	2.14	-1.14	-1.82
97	7365	90.40	6.70	4029.21	3642.77	463.13	3672.07	0.89	0.89	0.00
98	7410	90.50	6.60	4028.85	3687.47	468.34	3717.07	0.31	0.22	-0.22
99	7455	90.10	6.40	4028.62	3732.18	473.43	3762.06	0.99	-0.89	-0.44
100	7500	89.50	6.00	4028.77	3776.91	478.29	3807.05	1.60	-1.33	-0.89
101	7545	91.00	7.80	4028.58	3821.59	483.70	3852.04	5.21	3.33	4.00
102	7589	91.30	8.20	4027.70	3865.15	489.82	3896.03	1.14	0.68	0.91
103	7634	90.40	7.40	4027.03	3909.73	495.93	3941.02	2.68	-2.00	-1.78
104	7679	89.50	7.20	4027.07	3954.36	501.65	3986.02	2.05	-2.00	-0.44
105	7723	88.50	6.80	4027.83	3998.03	507.01	4030.01	2.45	-2.27	-0.91
106	7768	88.60	7.10	4028.97	4042.68	512.45	4075.00	0.70	0.22	0.67
107	7813	90.60	8.30	4029.29	4087.27	518.48	4119.99	5.18	4.44	2.67
108	7858	91.80	9.00	4028.35	4131.75	525.25	4164.97	3.09	2.67	1.56
109	7903	91.30	8.40	4027.13	4176.21	532.05	4209.95	1.74	-1.11	-1.33
110	7948	91.10	7.70	4026.19	4220.76	538.35	4254.93	1.62	-0.44	-1.56
111	7993	89.90	7.70	4025.79	4265.35	544.38	4299.93	2.67	-2.67	0.00
112	8038	87.80	6.40	4026.70	4310.00	549.90	4344.92	5.49	-4.67	-2.89
113	8083	87.70	7.20	4028.46	4354.65	555.22	4389.88	1.79	-0.22	1.78
114	8128	87.50	7.20	4030.35	4399.25	560.86	4434.84	0.44	-0.44	0.00



Cholla Production						MWD: Kolby Davis , Philip Spoonemor					
Kohl 1-33H				DIRECTIONAL DRILLERS:		Billy Spurgen / Tony					
HWD # 6				Magnetic Declination:		6.57					
Trego co, KS				Job #:		Dr 1410216					
Minimum Curvature Calculation				Vertical Section Azimuth		7.45					
Survey						Vertical		DLS/			
No.	Depth	INC	AZM	TVD	N-S	E-W	Section	100	BUR	WR	
115	8173	87.60	7.00	4032.27	4443.87	566.42	4479.80	0.50	0.22	-0.44	
116	8218	88.90	6.00	4033.65	4488.56	571.51	4524.77	3.64	2.89	-2.22	
117	8263	88.50	6.70	4034.67	4533.27	576.48	4569.75	1.79	-0.89	1.56	

Cholla Kohl 1-33H

BHI Stage #	Entry Point	Depth	Total BBIs of Clean Frac Fluid	Total lbs of Sand	Total MSCF N2	Cum MSCF N2	Comments
1	Perforations	8276'-8282'	468	44723	555873	555873	
2	Optiport Sleeve 1	8234	409	37807	376105	931978	
3	Optiport Sleeve 2	8157	12.2	0	33572	965550	Aborted Stage Early
4	Optiport Sleeve 3	8091					Stage Abandoned
4	Sand Jet	8016	505	40303	368011	1333561	
5	Optiport Sleeve 4	6975	387	37595	383940	1717501	
6	Optiport Sleeve 5	6909	354	36195	445053	2162554	
7	Optiport Sleeve 6	6811	357	39734	365080	2527634	
8	Optiport Sleeve 7	6745	316	36507	416597	2944231	
9	Optiport Sleeve 8	6668	319	40450	368476	3312707	
10	Optiport Sleeve 9	6421	314	38094	369069	3681776	
11	Optiport Sleeve 10	6344	205	41981	353897	4035673	
12	Optiport Sleeve 11	6267	570	41067	370801	4406474	
13	Optiport Sleeve 12	6169	329	40493	386687	4793161	
14	Optiport Sleeve 13	5827	461	39732	383680	5176841	
15	Optiport Sleeve 14	5733	309	39231	350435	5527276	
16	Optiport Sleeve 15	5629	316	39377	342772	5870048	
17	Optiport Sleeve 16	5536	301	39545	337550	6207598	
18	Optiport Sleeve 17	5446	325	39575	336700	6544298	
19	Optiport Sleeve 18	5111	136	11134	176682	6720980	Screen Out
20	Optiport Sleeve 19	5037	404	41327	552046	7273026	
21	Optiport Sleeve 20	4962	347	52180	447431	7720457	

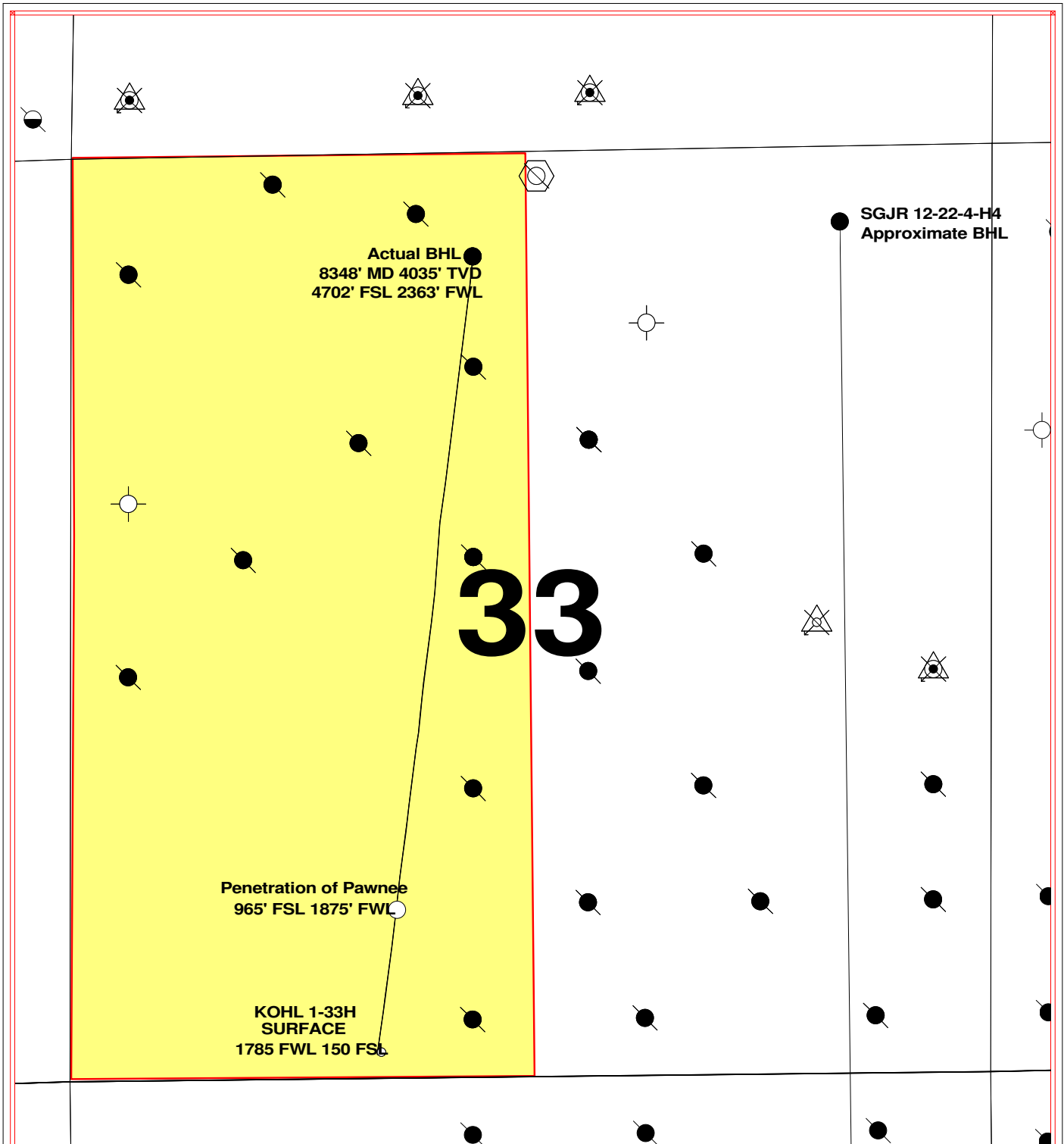

CHOLLA PRODUCTION, LLC		
KOHL #1-33H SECTION 33-11S-22W TREGO CO.		
ehg		2/12/2015
Scale 1:10000.		

Scale 1:10000.

